

Ray

Rea

Wray

Ray

Rhea

Rey

^{1/2} MARLIN

GILLESPIE

Book 25 page 668: On Feb. 22 1801, Elizabeth Tutrow (as the will of her deceased husband, Balser Tutrow bequeathed her son land during her life, & made her & David Tutrow the executors), binds herself to Thomas Ray for her rights in the estate on Bear Creek & elsewhere, for \$150.00 on Jan. 30 1819, witnessed by Samuel Auston, Brice W. Dumas & James Wray & proved by the last named in Feb. 1820.

Book 27 page 62: Sept. 10 1821, Thomas Wray--no wife signs--lets James Renshaw (both of Rowan Co. N.C.) have 282 acres on Bear Creek next said Wray, Godfrey Clement, Alexander Smoot, Jonathan Jarvis & Jacob Helfer, for \$1000.00, witnessed by Reuben Ellis & D. McGuire & proved by the latter in May 1822. (This was formerly owned by Balser Tutrow).

Miss Dora Anna Scribner of Ocean Park, Maine, wants information of the Wray or Ray & Fox families. Says Michael Fox married Mary Moved to Shelbyville Co. Indiana where he died in 1826 (both buried there). Their son Balser Fox married Abigail Frazier & had a daughter, Belinda, who married Hardy Ray, whose daughter Mary Erminia Ray married John Woodbury Scribner of New Hampshire (these being the parents of Miss Dora Anna).

Book 22 page 817 or 917 (numbered twice): April 9 1794, John Setzer--no wife signs--lets John Goodman (both of Rowan Co. N.C.) have 100 acres on Beaver Dam Creek next James McCarley, John McLean, John Johnston & John Patterson, for 50 pounds, witnessed by ? & John Follie & proved by the latter in Nov. 1813. (This is part of a large State Grant to William Wray who let Sarah Marshall have, who let Charles Price have on June 7 1791, who let said Setzer have it).

Book 12 page 374: Feb. 5 1788, William Wray--no wife signs--lets John Johnston (both of Rowan Co. N.C.) have 100 acres on Withrows Creek next Widow Marshal, for 50 pounds, witnessed by Henry Fleming & David Crawford & proved by the latter in May 1791. (Part of the grant sold by the State to said Wray in 1783)

John Ray of Georgia.

Seek Ancestry of Pioneer Georgian

QUERY 1,019

RAY - MARTIN - HOLCOMBE - LAMB (a)—Ancestry desired of John Ray, settler in Georgia, 1737, "in charge of Indian affairs," "Representative from Augusta and St. Paul Parish in Colonial Assembly," "deacon of first Baptist Church ever established in Georgia," "gets many thousand acres of land," etc. He owned 80 slaves and had a large family. He married Susan Vance, of the North Carolina line. He was probably son of Alexander and Anne (Salisbury) Ray, who lived in North Carolina in 1702. Proof desired. John and Susan had: Joseph, Elizabeth, married (1) Griffin, (2) Ragan; Ambrose (my South Carolina and Georgia ancestor, Revolutionary soldier, who died 1799, married about 1770, Elizabeth —? who was born 1748, died March 11, 1831, and is buried at Padgett's Creek churchyard, Union County, S. C.); Zachary (Zacharia), John, Jr.; James, Sarah Vickers, Agnes and Mary Ayers. What were the last names of the Elizabeths who married John and Ambrose (perhaps a Martin, Holcombe or Lamb)?

McGLAMORY (b) — Ancestry desired of Hester McGlamory (McGlemmery, Maglemery, Meglemmery, Meglemere, etc.) who was wife of Mathias McGlamory, of Kentucky? What issue had they? Who were the children of John McGlamory (born about 1754 in Sussex County, Virginia, married about 1776 Isabella McKittrick, and received a land grant in Lee County, Georgia, in 1842 for Revolutionary service?) He was then living in Warren County, Adams district. Hester was born 1778 in Sussex County, Virginia, and died in Hardeman County, Tennessee, in 1847. She married (1797) Thomas Northcross (son of Richard and Jane), who was born in Sussex County in 1776. With kindred families (Oakes, Marshalls, Keiths, Rust, Bailey, Porter, Newsom, Thomas, Richardson, Larsson, Nelms, Key and Davis) they left Sussex County, Virginia, via the Carolinas, Georgia and Alabama, and settled in East Tennessee near McMinnville and in Eastern Kentucky.

LAMB (c)—Ancestry, etc., desired of Mary Lamb, born December 25, 1777; died in Mississippi, November 4, 1856; married January 24, 1796, Hosea Ray (son of Ambrose, son of John, above); born 1776, died 1860, and both buried at Padgett's Creek churchyard, Union County, South Carolina. She was (?) daughter of Colonel Gideon Lamb and wife

Mary (Gregory, of Burgess), of North Carolina. Who were Mary's brothers and sisters? Bible, tomb and court records desired. Will correspond.

RAMAGE-ROBERTS (d)—Ancestry, etc., desired of Mary Ramage, born about 1757, died between 1783 and 1799; married in 1774, James Major Dillard (captain in Revolution); born 1755 in Culpeper County, Virginia; died in Laurens County, South Carolina, in 1836. He was son of George Dillard and Priscilla (daughter of Constance) Major, of Culpeper County, Virginia. Mary's mother was (?) Elizabeth Roberts and her father Joseph Ramage, who served with South Carolina troops, who were the children of Benjamin and Elender Ramage, of Laurens, who died after 1811? Names of wife and children desired of Joseph, of Laurens County, whose estate was administered by John Ramage, 1825. If a Roberts, then her Roberts line is desired.—CLARA NORTHCROSS RAY, Corinth, Mississippi.

Book 26 page 233: On Oct. 20 1818, John Smith--no wife signs--lets Hutson Ray (both of Rowan Co. N.C.) have 35 acres on Bear Creek, being part of a tract upon which Thomas Ray now lives, next Jacob Helper & Samuel Doyal for \$140.00, witnessed by James Wray & Elijah Benschaw & proved by the latter in Feb. 1821.

Book 26 page 224: On Feb. 23 1819, John Smith--no wife signs--lets James Hay (both of Rowan Co. N.C.) have 110 acres on Bear Creek next Jacob Helper, Alexander Smoot & James McGuire, for \$500.00, witnessed by Hutson Wray & Thomas Wray & proved by the latter in Feb. 1821.

Francis Ray to Deborah Ervin Oct. 4 1786 signed by William Ervin.
Alexander Rea to ---iner Douthit Oct. 15 1819 ' ' Joel Chepman.

Book 23 page 929: March 11 1816, Jacob Fetter--no wife signs--lets Alexander Rea (both of Rowan Co. N.C.) have 202 1/2 acres on the north side of the main road from Clemmons town to Middle Ferry beyond the Yadkin River, for \$325.00, witnessed by William Douthit & John Clemmons & proved by the latter in Nov. 1816.

Marriage bonds: James Ray to Elizabeth Johnson Sept. 29 1763 signed by Edward Parnell & William Nassery while her father, Gideon Johnson writes his consent.
Margaret Ray to Henry Fleming Aug. 1 1784 signed by Andrew Kennedy

Philip Wray to Sally Jones April 12 1813 signed by Coleman Rice.
Mary Ray to Robert Pinkerton Sept. 6 1800 signed by James Whitaker
Barney Wray to Liddy Travitt Sept. 10 1822 signed by Thomas Wray.

Book 21 page 849: Oct. 10 1809, John Dotts of Maury Co. Tenn. & John McCracken of Williamson Co. Tenn. (as executors of the will of deceased Alexander Dotts of Rowan Co. N.C.) appoint their trusty friend, Joseph Roland of Warran Co. Kentucky, their attorney to sell 257 acres on Bear Creek next Gasper's old tract where Andrew Mock lived in 1795, next George Tanner, alsoer Dutrow & Jacob Kellar, witnessed by James Hicks & Samuel Peckins in Williamson Co. Tenn. acknowledged on Oct. 10 1809.

Lieutenant John Ray of Maryland. 2nd
N.C.D.A.R. Register of 1947, page 135: Mrs. Thos. S. George, (Catherine Ridgely), gave her Supplemental Fine as Lieutenant John Ray of Maryland.
Page 83: Mrs. Thos. S. George (Catherine Ridgely), as # 124592, from the services of Lieutenant Archibald McCurdy of North Carolina, is listed among the former members 1890-1947.

Page 79: Mrs. W. D. Dorsett (Blanche Hurley), as # 190951, from the services of Captain Beverly Ray of Virginia, is listed among the former members 1890-1947.

Page 33: Mrs. S. P. Ray (Bessie Clark), as # 270064, from the services of Ensign George Taylor of Virginia, joined the "George Reynolds Chapter" (organized Feb. 14, 1924), of Statesville, N.C.

Page 109: Mrs. Ralph Ray (Ethel Jay), as # 190955, from the services of William Royals, a Private of South Carolina, is listed among the former members 1890-1947.

Page 145: Mrs. Ralph Ray (Ethel Jay), gave her Supplemental Fine as George Sullisvan, a Private of South Carolina.

Page 35: Mrs. Frank O. Ray, (Elinor B. Edmondson), as # 138660, from the services of Robert Sims a Justice of the Peace of North Carolina, joined the "David Williams Chapter" (organized Oct. 29, 1914), of Goldsboro, N.C.

Jacksonburg, N.C.



SONGS & BONDS
D. J. CASKILL



D.A.R. Lineage Vol. 65 page 6; Mrs. E. Russell Johnson (Gertrude Byerly) born in Green Valley, Ind., joined as #64016 from Thomas Ray born in Wake Co. N.C. died 1829 in Shelby Co. Ind., served 1777 in Second & Sixth Va. Regiment, in the First N.C. Regiment in 1779 & was in the battle of Eutaw Springs.

Julia Moore
married Alexander C. Byerly

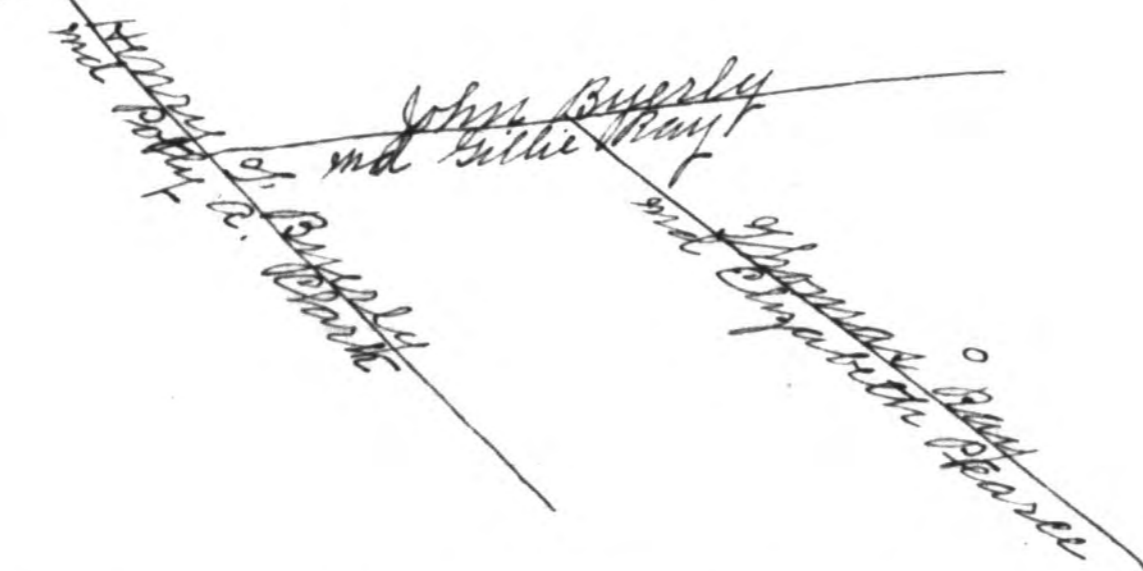

Page 109: Mrs. H. J. Ray, (Mary Perrett), as #255341, from the services of Artie Sgt. Lieutenant, Ensign & Captain of North Carolina, is listed among the "Former Members 1890-1947"

NC D.A.R. Register of 1947 page 109: Miss H. Ethel Ray, as #45132, from the services of Colonel Joseph Williams of North Carolina Provincial Congress, is listed among the "Former Members 1890-1947"

Page 109: Mrs. J. E. Ray (Mary Stringfield), as #45131, from the services of Colonel Joseph Williams of North Carolina, is listed among the "Former Members 1890-1947"

Page 109: Mrs. C. E. Ray Jr. (Sallie Taylor), as #261007, from the services of Sallie Taylor a Private & Justice of the Peace of North Carolina, is listed among the "Former Members 1890-1947"

Page 109: Mrs. C. D. Ray (Lizzie Marsh), as #192627, from the services of Major John Birdsong of North Carolina, is listed among the "Former Members 1890-1947"

Robert Rea of Pennsylvania + N. Carolina + Indiana.

D.A.R. Lineage, Vol. 64 page 86: Mrs. Robert Right Rea, (Laura J. Rea), born at Madison, Indiana, joined as #67235, from the service of Robert Rea (1761-1832), born in Penn., moved to N.C. & died at Madison Ind., a Private in 1777 in North Carolina under Captains James Harris Wiley, Thomas Shelby, William Hutchinson + Samuel Martin + Colonels Henderson + William Polk, & was placed on the N.C. Pension Roll in 1833.

She is the daughter of, (he):

- | | | | |
|-------------------------|------------|------------------|---------------------|
| (1). Andrew J. Rea, () | married in | Elizabeth Dillon | (both were
sons) |
| (2). John M. Rea, | " " | Margaret Swan | |
| (3). Robert Rea | " " | Agnes Patton | |

Captain John Rea of Pennsylvania.

Page 914 of the Sons of the American Revolution:
Charles S. Rea of Pittsburg, Pa., as #624, joined the
Pennsylvania Society in the service of Colonel Sam-
uel Culbertson of the Cumberland Co. Pennsylvania
Associators. * & of

- He was the son of, (i.e.):
- (1) Charles Rea married Elizabeth Cochran;
 - (2) * John Rea " Elizabeth Culbertson;
 - (3) Samuel Culbertson "

* Captain John Rea of the Cumberland Co. Penn-
sylvania Associators. (Carelessly omitted, A.S. &c.)

Dr. Andrew Reay

Surgeon Andrew Reay was an Original Member of the
Society of the Cincinnati of Virginia - see page 307 of the
Kentucky Year Book of 1913, which contains a list.

Ray or Rhea etc

Page 376 of "Newberry County South Carolina" (by George Seland Summer, Sr., in 1900): "Both the Rhea and the Ray families (sometimes spelled 'Wray'), lived in Pennsylvania and Virginia in early Colonial times. Later, many drifted down into the Carolinas, to Tennessee and other States. Rev. Joseph Ray, or Rhea, a grandson of Matthew Rhea, came to America in 1769, with his wife, Elizabeth. They had the following children: John, Matthew, William, Joseph, Samuel, Margaret, Elizabeth.

"Turner Ray came from Virginia to Ninety Six District before the Rev. War. He married Nancy..... and had children: John, James, Mary (wife of David Hill), Anne (wife of John De), Sarah (wife of Alfred Miller), Cynthia (married Sebastian Wesson), and Nancy. John (son of Turner) died about 1830, leaving widow, Polly, and children: John, Samuel, Elizabeth (wife of John Johnston), Nancy (wife of Elias Bist), Patsy (wife of Nathan B. Chisolm), Charles, Eleanor (wife of John Anderson). James (son of Turner) died and left no family.

"Margaret Ray married John Carratt, and had children: Abigail (wife of Daniel Marchant), John Jr., and Jane.

"Thomas Ray made will September 19, 1788, and died about 1792, in Abbeville District, leaving widow, Susannah, and some small children."

Rev. Joseph Rhea of Ireland + Tennessee + William " " " "

D.A.R. Lineage, Vol. 80, page 80: Miss Hattie King, ^{Owen,} born at Bristol, Tenn., as #19261, joined on the services of Reverend Joseph Rhea, (1715-1799), born in Ireland, died at Piney Creek, Maryland, who served as Chaplain under Col. William Christian in 1776 - see also #61647;

William Rhea, (1760-1836) born in Ireland died in Sullivan Co. Tennessee, who served as a Private in the company of Capt. Hugh Gaston in the Northampton Co. Pennsylvania militia in 1783;

George Hartzell, (1718-1812), born at Upper Saucon, died at Bethlehem, Pennsylvania, who served as a Private in Capt. John Senter's company of the second battalion of the Northampton Co., Pennsylvania in 1781;

David Owen, (1713-1790), born near Philadelphia, died in Pennsylvania who served as a Private in the first battalion of the Chester Co. Pennsylvania militia under Capt. James Dennis - see also #77703;

Joseph Owen, (1760-1807), born in Pennsylvania, died in Sullivan Co. Tennessee, who served as a Private in the second legion of the Continental line of Lieutenant-Colonel Lee;

Lieutenant Samuel Woods, (1735-1826), born + died in Albemarle Co., Virginia, who served as Lieutenant in the Virginia militia under Col. James Woods;

Thomas Lanier, (1750-1801), born in Virginia, died in Surry Co., North Carolina, who served as a Private in Capt. Robert Bollman's company of the Virginia militia;

Micajah Watkins, (1745-1780), born + died in Halifax Co., Virginia who was a member of the Virginia Convention in 1776;

John Wetherland, (1739-1803), born in Brookland Co., died in Powhatan Co., Virginia, who served as a member of the Committee of Safety of the Cumberland Co. - see also #49491;

Robert Williams, (1740-1834), born in Hanover Co., died in Suffolk Co., Virginia, who served as a Private in the company of Capt. Andrew Wallace of the Virginia regiment of Col. Abraham Buford in 1779 + was considered for wounds in Buford's

Regt - see also #61647; + of Colonel James King (1752-1825), born in England, died in Bristol, Tennessee, who commanded a Regiment at Princeton where he was held a Prisoner + held for over a year; after his release he was appointed commander of the fort where

(over)

Rev. Joseph Rhea of Ireland of Maryland
 + William " " " Tennessee.

Nashville now stands - see also #79632.

She was the daughter of (etc.):

- | | |
|--|--|
| (1) Joseph W. Owen, (1836-1907), married 1889, Jimmie King, (born 1856); | (2) 1834, Frances Buckley, (1812-1845); |
| (2) Jesse Owen, (1796-1840), | " 1830, Harriet Retherford, (1832-1882); |
| + John King, (1823-1889), | " 1791, Susanna Hartwell, (1761-1843); |
| (3) Joseph Owen | " 1812, Wm. M. Watkins, (1795-1866); |
| James King, Jr., (1791-1867), | " 1828, Margaret Rhea, (1797-1864); |
| Samuel Woods Retherford (1832), | " Sarah Owen, (born 1724); |
| (4) David Owen | " 1736, Habromah — |
| George Hartwell | " Sarah Woodson, (died 1806); |
| James King | " 1794, Sarah Williams; |
| Micajah Watkins, (1765-1795) | " Margaret Woods (1768-1841); |
| Richard Retherford (1765-1832), | " Elizabeth Preston (1766-1835); |
| William Rhea - see #79215- | " Margaret —; |
| (5) Samuel Woods | " — Mosby; |
| John Retherford | " Sarah Gardier (born 1748); |
| Robert Williams | " 1764, Mary Boyd; |
| Micajah Watkins | " 1743, Elizabeth Hicks. |
| (6) Thomas Lanier | |

Vol Mrs. J. G. Bailey, (Sarah E. Preston),
 born in Washington Co. Va., as #79215, joined on the service of
 the Reverend Joseph Rhea, (as in 79267), being the daughter of (etc.):

- | | |
|---|---|
| (1) John Fairman Preston, (1871-1875), married 1857, Jane Nancy Rhea (1819-1876); | |
| (2) Samuel Rhea, (1769-1843), | " Nancy Preston (1700-1835); |
| (3) Rev. Joseph Rhea | " 1757, Elizabeth McSwaine, (1720-1781) |

Ray

J. A. R. Lineage, Vol. 65, page 6: Mrs. E. Russell Johnson,
 (Gertrude Byerly), born in Green Valley, Indiana,
 joined as #64096 from the services of:

Thomas Ray (born in Wake Co. N.C., died in 1829 in
 Shelby Co. Indiana), served in the 2nd + 6th Virginia
 Regiments in 1777; in the 1st S.C. Regiment in 1779
 + was in the battle of Eutaw Springs.

She is the daughter of Alexander Byerly ()
 who married Julia Moore (); grand-
 daughter of Henry G. Byerly () married
 in Polly A. Clark (); great-grand-
 daughter of John Byerly () married in
 Follie Ray (); great-great-granddaugh-
 ter of Thomas Ray who married in Elizabeth
 Pearce ().

Ray

Marriage bonds:

Mary Ray to Robert Pinkerton Sept. 6 1800 signed by James Whitaker

Book 22 page 917; April 9, 1794, John Setzer--no wife signed--let John Goodman, (both of Rowan Co., N.C.), have 101 acres on Beaver Dam Creek next James McGarley?, John McLean, John Johnston & John Patterson, beginning at a white oak & going north 77 chains to a pine, west 13 chains to an oak, south 77 chains to a stake, then east 13 chains to the beginning, for 50 pounds, witnessed by two Germans(?) & proved by John Follie in Nov. court of 1813. (The State granted this to William Wray, then to Sarah Marshal, then to Charles Price, who indentured it to the said John Setzer on June 7, 1791).

Book 45 page 43: Dec.22 1871, S.W.Rea & W.H.Kestler--no wives sign-owing M.A.Bringie (all of Rowan Co.N.C.) \$900.00, let him have their interests in the National Hotel including buildings, fixtures &c, acknowledged on the same day.

Tryon & Lincoln County Marriage Bonds (Curtis Bynum):

George W.Ray to Rosannah Smith Feb.9 1832 signed by John Gilbert, and Hoyl & Eli Hoyl

William Wray to Sally Warlick May 3 1825 signed by Andrew Dickson

" " " Amelia C.Ramsour July 31 1866 (married same day by Rev.J.Ingold)

Jean Ray to Thomas Neill May 27 1819 signed by Thomas Dickson & Jacob Carpenter J.P.

My Ancestry page 179 (F.A.Sondley); John Davidson married Widow Morrison (who was of wealthy Irish parentage & was disinherited when she married Morrison who died soon leaving an unborn child) whom he had met on the ship coming to America & by whom he had eleven children. (This is one of the 3 brothers who came to America the others being

He was pack-horse-general of the Revolution, member of Rowan Safety Committee

His children were: William & Samuel (twins), George, Thomas, one-eyed John, James, Benjamin, Rachel (married John Alexander), Elizabeth (married Ephraim McLean), Rebecca (married William Young) & Margaret or "Peggy" (married James Smith)--of the boys George died in Tenn., Thomas died in S.C., James & Benjamin died on Davidsons River in Transylvania Co.N.C., John married Nancy Brevard, (murdered by Indians but one of their children, Sarah escaped & married Lambert Clayton as she was visiting her grandfather John Brevard).

My Ancestry (F.A.Sondley) page 126; Harriet Alexander in her 16th year (Dec.17 1832) married Elisha Ray & lived at mouth of Beaverdam Creek five miles north of Asheville. Elisha died June 21 1844 so she returned to her father with her five children and after eleven years of widowhood, married Oct.17 1855, Richard Sondley of Columbia S.C.,

Children by 1st marriage: John Edwin Ruthven Ray born Nov.8 1833 died

Frances Ann Elizabeth Ray born July 6 1836 died May 29 1923

James Mitchel Ray born Nov.15 1838 died Feb.22 1923;

Susan Eliza Ray born Sept.21 1840 died Oct.26 1860, died unmarried

Josephine E.Ray born Aug.14 1843 married D.T.Millard

William Wray (Lamboths Creek)

Book 10 page 6: Nov. 2 1784, William Wray--no wife signs--lets Lambird Clayton (both of Rowan Co. N.C.) have 300 acres on both sides Lamboths Creek waters of Old House Creek next the mill-pond of --- Byar's on said Lamboths Creek next John Oliphant, Solomon Douglas & George Clayton, for 70 pounds, witnessed & proved by John Brevard in Nov. 1784. (This was granted Wm. Wray on Oct. 10 1783).

Book 10 page 193: Oct. 10 1783, The State grants (#6 at 50 shillings the 100 acres) to William Wray 300 acres on Lamboths & Old House Creek on ^{waters of} both sides Byars Mill-pond, next John Oliphant, Solomon Douglas, Arthur Travers & George Clayton. This begins on the south side of said pond at a hickory & goes west 550 poles with the line of said Byars & line of John Oliphant & Solomon Douglass to a black oak, east 90 poles to a black oak on the corner of Arthur Travis, south with his line & the line of George Clayton 550 poles to a red oak on the corner of said Clayton, then west to the beginning.

James Wray (Third Creek)

Book 11 page 342: Aug. 9 1787, The State grants (#1536 at 50 shillings the 100 acres) to James Wray 286 acres on Third Creek next James Watts, Widow Steele & William Waugh. This begins on the line of James Watts at a black oak, goes with his line south 292 poles to a post oak on the corner of ---Steele, west with her line 276 poles to a black oak on the corner of ---Waugh, north 35 degrees east 285 poles to a white oak on the corner of ---Waugh, then north with the line of said Waugh 30 degrees east 30 poles to the beginning.

Rea

Book 8 page 523: Aug. 27 1777, Moses Potts--no wife signs--lets James Potts Jr. (both of Rowan Co. N.C.) have 150 acres on a branch next George Davidson, for 5 pounds, witnessed by James Purviance & John McClelen & acknowledged in Aug. 1779. (Earl Granville let George Davidson have this who let William Ray have it on Dec. 15 1755 who let Moses Potts have it on Oct. 13 1763).

Book 3 page 215: Dec. 15 1755, George Davison Sr. & wife Margaret let William Rea--all of Rowan Co. N.C.--have 320 acres on both sides Fourth Creek, for 5 shillings, (the release price being 40 pounds on the next day), witnessed by William Smith, William Drew & Andrew Berry & proved by the last named on Jan. 28 1756. (This is $\frac{1}{2}$ of 640 acres entered by Esq. Andrew Berry)

Book 5 page 354: Oct. 13 1763, William Rea of Orange Co. N.C.--no wife signs--lets Moses Potts of Rowan Co. N.C., have 320 acres on both sides Fourth Creek, for 40 pounds, witnessed by John Bräly & Francis Locke & acknowledged in Oct. 1763. (This is $\frac{1}{2}$ of 640 acres which Earl Granville let George Davison have & he let William Rea have on Dec. 15 1755)

Fox-Wray.

The will of Thomas Fox (Book C page 138) made while 'very Weak in body' on Sept. 25 1753. Daughter Elizabeth (& her daughter, the household goods). The other children have had their shares. Witnesses: Benjamin & Mary Ward.

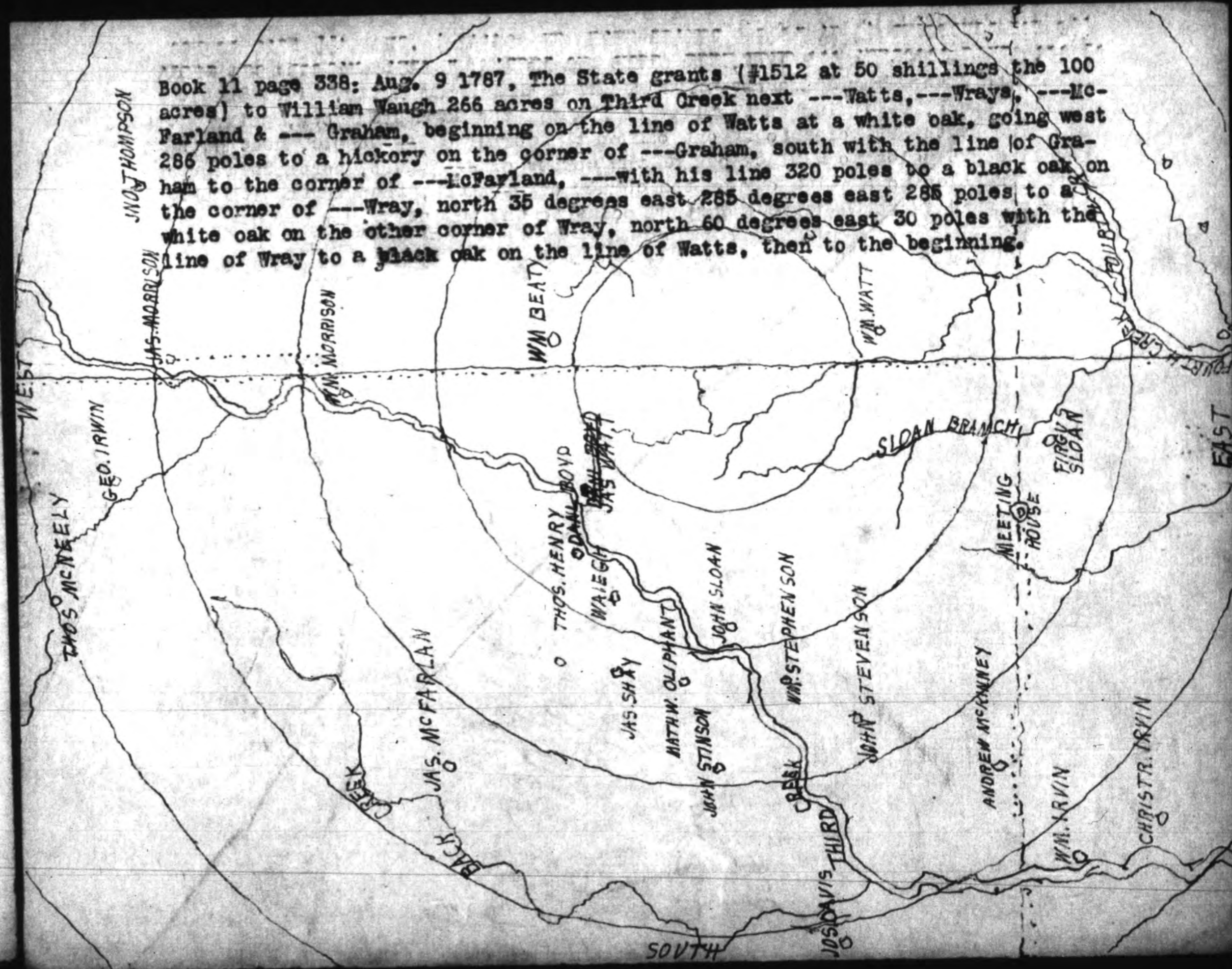

Thomas Ray (Old Field Creek)

Book 6 page 113; Jan. 8 1761, John McGowan & wife Ann let Samuel Waggoner--both men planters of Rowan Co., N.C.,--have 320 acres on both sides of Old Field Creek, beginning at a post oak, going north 80 chains to the center of three hickories, east 40 chains to a stake, south 80 chains to a pine, then west 40 chains to the beginning, for 5 shillings--the release price being 45 pounds Virginia money--^{on the next day} witnessed by William Hall & William Wagener & proved by the latter before Maurice Moore on March 27 1765.

Book 4 page 369; Jan. 17 1761, James McKeine & wife Sarah let John McGowan (both men planters of Rowan Co., N.C.), have 320 acres on both sides of Old Field Creek, beginning at a red oak, going north 80 chains to the center of three hickories, east 40 chains to a stake, south 80 chains to a pine, then west 40 chains to the beginning, for 5 shillings--the release price being 45 pounds on the next day, witnessed by William Buis & William Simmons & recorded in Jan. court of 1761.

: Lease & release from James & Sarah McKeine to John McGowan for 320 acres Jan. 17 1761

Book 4 page 468; Nov. 6 1755, Earl Granville lets James McKeine of Orange Co., N.C., have 320 acres in Orange Co., N.C., on both sides of Old Field Creek, as in the preceding deed, for 10 shillings sterling, with the yearly rent of 12 shillings & 10 pence (which is at the rate of 5 shillings sterling the 100 acres), witnessed by John Hay & Thomas Haywood & acknowledged on Nov. 12 1756. (This is marked delivered to his messenger, Henry Boner.)

William Wray (Lamboths Creek, Old House Creek & Byars' Mill Pond)

Book 10 page 193; Oct. 10 1783, The State grants (#654 at 50 shillings the 100 acres) to William Wray 300 acres on the waters of Lamboths' & Old House Creek & both sides of Byars' mill-pond, beginning on the south side of said pond at a hickory, going north 550 poles with Byars, John Oliphant & Solomon Douglas's line to a black oak, east 90 poles to a post oak on the corner of Arthur Travers, south with his line & that of George Clayton 550 poles to a red oak on the corner of said Clayton, then west to the beginning.

Nov. 6, 1784; Deed from Wm. Wray to Lambert Claiten for 300 acres Nov. 2 1784 proved by John Brevard Jr.

Book 10 page : Nov. 2 1784, William Wray--no wife signed--let Lambird Clayton (both of Rowan Co., N.C.), have 300 acres on the waters of Lambeth Creek & Old House Creek on both sides of Byars Mill-pond, next John Oliphant, Solomon Douglas

Book 11 page 342; Aug. 9 1787, The State grants (#1536 at 50 shillings the 100 acres) to James Wray 286 acres on Third Creek next James Watts, Widow Steele & William Vaugh, beginning on the line of James Watts at a black oak, going with his line south 292 poles to a post oak on the corner of ---Steele, west with her line 276 poles to a black oak on the corner of --- Vaugh, north 35 degrees east 285 poles to a white oak on the corner of ---Vaugh, then north with the line of said Vaugh 30 degrees east 30 poles to the beginning.

Alexander H. Ray

Book 152 page 197; Feb. 15 1919, Lawrence Anderson & wife Willie let Adolphus & Mattie McCanly--all of Rowan Co.N.C.--have the vacant lot #5 (in the Lowery Estate map made by C.M. Miller) in the south ward of town, fronting Shaver St. & about half way between Washington & Concord streets, next lots #4, 5 & 6, for \$195.00, witnessed by W.L. Ray & acknowledged on the same day. (Alexander H. Ray let Lawrence Anderson have this--see book 145 page 87).

James Ray

Iredell Co.N.C., book D page 178; Jan. 26 1796, Drury Tucker--no wife signs--lets James Ray (both of Iredell Co.N.C.) have 40 acres by the field of James McEwen, for 50 pounds, witnessed by Thomas McEwen & George Allen & proved by the latter in Feb. 1801. (This is part of the State Grant to Joseph McEwen on Oct. 8 1783, who let said Tucker have this 40 acres on March 26 1792).

Joseph Ray (Nankins Branch)

Iredell Co.N.C., book F page 116; April 13 1804, Joseph Ray of Wake Co.N.C.--no wife signs--lets James Patterson of Iredell Co.N.C., have 150 acres next Samuel White, James Patterson, Edward Griffith, at the mouth of Nankins Branch & up it, for \$445.00, proved by Polly Bruce in Feb. 1806. (This is part of a tract formerly owned by James Patterson who let William Butram have on Aug. 15 1795, who deeded it to Joseph Ray in 1800.)

Iredell Co.N.C., book D page 418; Sept. 1 1801, William Butram Sr.--no wife signs--lets Joseph Ray (both of Iredell Co.N.C.) have 150 acres at the mouth of Nankins Branch next William Blankenship, James Patterson, Edward Griffith & the South Yadkin, for 150 pounds, witnessed by Thomas Blankenship & Arnold Bruce & proved by the latter in Nov. 1801. (This is part of a Grant to James Patterson on Oct. 10 1783).

James T. Ray

Book 45 page 375; Oct. 19 1869, John C. Gillespie & wife Harriet E., James T. Ray & wife Margaret A. let William T. Marlin--all of Rowan Co.N.C.--have 192 acres next C. Rice, ---Elliott, the schoolhouse, J.L. Morrison & John C. Benson, for \$350.00, acknowledged on Nov. 4 1869.
Marriage bonds: John C. Gillespie to Harriet Marlin Jan. 17 1849 signed by Thomas J. Gillespie.

Married April 5 1866; James T. Ray to Margaret A. Correll by James F. Cuthrell

Buried at Ebenezer Church not far from Bear Poplar; James T. Ray born July 16 1835 died Jan. 26 1891 aged 56 yrs. 6 mos. & 10 days;

The Marlin Bible in possession of Thomas Leroy Gillespie of Mill Bridge, Rowan Co.N.C. gives the Woodleaf set of Marlin's; S. Marlin born Sept. 17 1821; William Theodore Marlin was born Oct. 10 1831; Jane Elizabeth Marlin was born July 5 1829; Margaret Asenath Marlin was born June 29 1836 Mr. T.L. Gillespie says Samuel Marlin had a daughter, who first married a Correll, then Thomas Ray, then Newberry Hall (and he thinks her daughter, Ida, married Joseph Hall of Salisbury, N.C.)

John Freeze (Second Creek) Thomas Ray

Book 54 page 401; Feb. 26 1878, Samuel J. Hinsdale of Fayetteville, Cumberland Co.N.C., out of love for his nephew & namesake, Samuel H. Wetmore, & \$1.00, gives him 52 $\frac{1}{2}$ acres on Second Creek & the plank road, next the bridge, ---Lyerly (formerly Thomas Rays'), witnessed by B.E. Reabern & acknowledged in Cumberland County on March 1 1878. (The said Hinsdale on Sept. 28 1863 had requested George B. Wetmore of Rowan Co.N.C. to buy this of John Freeze & transfer it).

James T. Ray

Book 43 page 575; May 28 1868, Luceo M. Gillespie of Davie Co. N.C. (he doesn't sign) lets or gets from James T. Ray of Rowan Co. N.C., 262 1/2 acres next ---McCoy, James C. McCaughy, ---Cowan, ---Wallen, ---Lyerly, the plank-road, John Freeze & Polly Dobins, for \$1500.00, witnessed & proved by Albert C. Kelly in June 1868.

Margaret A. Ray. (Sills Creek)

Book 71 page 98: May 21 1889, Ferdinand L. Correll & wife A.J. let Margaret A. Ray--all of Rowan Co. N.C.--have 100 acres next ---Harrison & ---Boyd, for \$600.00, acknowledged on the same day. (This is the land of William Correll apportioned by Ida E. & S.J. Hall to Ferdinand L. Correll--see commissioner's deed of John M. Horah in book 72 page 344).

Book 72 page 344: Dec. 3 1863, John M. Horah as Clerk of Court (in the action where F.L. Correll, Ida E. Hall & J.S. Hall were plaintiffs against J.F. & Leslie Stansill by his guardian ad litem, F.M. Woodson, Walter Stansill & Jane Graige & in Feb. term of Court of 1889 it was decreed by his honor, Judge Honor G.M. Brown that said Clerk of Court make another deed from William & Jesse & Jessie F. Stansill to William Correll as the other deed had been lost) so they let William Correll--all of Rowan Co. N.C.--have 196 acres next J.C. Gillespie, lowgrounds of Sills Creek, ---Harrison, Archibald Henderson, near a stone foarding, crossing the creek next ---Boyd & Henderson, for \$4116.00, witnessed by W.K. Hauck & proved on May 21 1889.

Ray
N.C. D.A.R. Register of 1947, page 135: Mrs. E.R. Yancey (Antia Ray) as # 170766. Among the services of Alexander Rankin, a Soldier of Virginia, is listed among the former members 1890-1947."

Anna
D.A.R. Vol. 68 page 66: Mrs. Laura J. (Anna) Ray born Anderson, Ind. wife of Robert Light Ray # 67238 Robert Ray 1761-1852 born in Pa. moved to S.C. died Anderson, Ind. served as a private 1777-81 from S.C. under Captain James Harris, Riley, Thomas Shelby, William Hutchinson & Samuel Snartin (Colonel); Anderson & William Polk) & placed on S.C. pension roll in 1893. She was daughter of Anderson, Ind. & Margaret Ann

Wray

A.C.D.A.R. Record of 1947 page 125: Mrs. R. B. Wray, (Louise Johnston), as #266083, from the services of Surgeon General Johnston of North Carolina, is listed among the former members 1890-1947."

Page 125: Mrs. J. P. Wray, (Stella Banks), as #131171, from the services of Walter Bank, a Private of Virginia, is listed among the former members 1890-1947."

Captain John Rea of Pennsylvania.

Page 52: Mrs. W. E. White, (Katherine Wilson), as #318573, from the services of Captain John Rea of Pennsylvania, joined the "Major General Robert Howe Chapter," (organized Nov. 26, 1935), of Whiteville, N.C.

Page 20: Mrs. W. J. Elkins, (Aunt Wilson), as #354523 from the services of Captain John Rea of Pennsylvania, joined the "Battle of Elizabeth Town Chapter," (organized Jan. 25, 1934), of Elizabeth Town, N.C.

Wray

Page 135: Mrs. J. S. Wray, (Oeland Barnett), as #303071, from the services of His Majesty William Simpson of Virginia, is listed among the Former Members 1890-1947.

Gen. & Captain John Rea of Pennsylvania.

50
N.E.S.A.R. Register of 1947, page 124: Mrs. W. G. Wilson, (Louisa Rea), as #186450, from John Rea, Captain & General of Pennsylvania, is listed among the Former Members 1890-1947.