

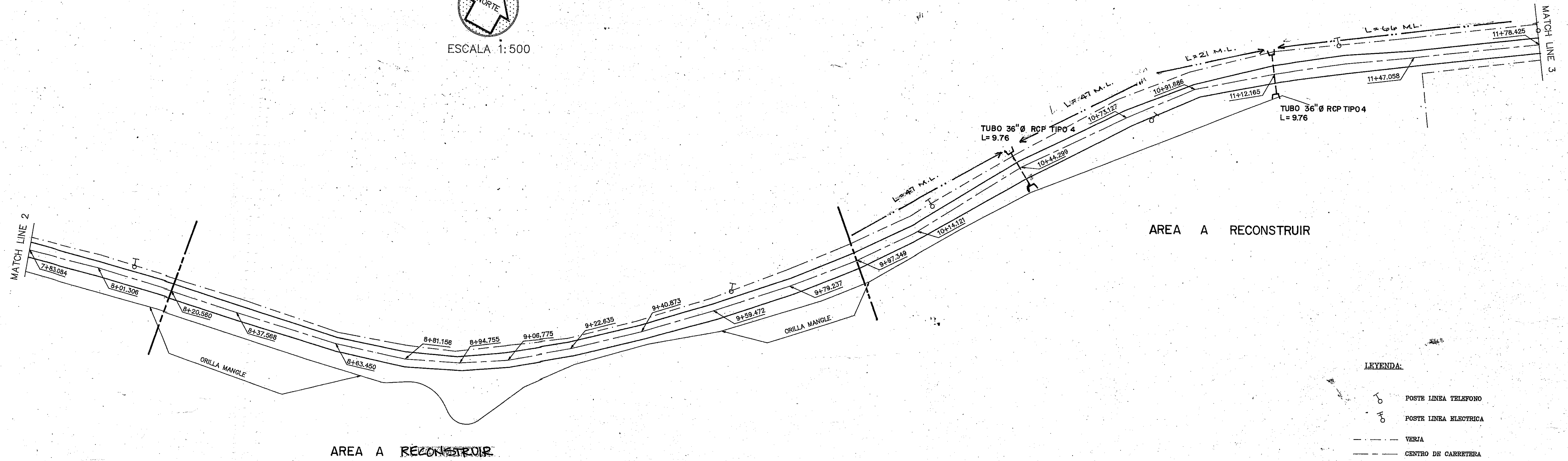





ESCALA 1:500



AREA A RECONSTRUIR

AREA A RECONSTRUIR

LEYENDA:

-  POSTR LINEA TELEFONO
-  POSTR LINEA ELECTRICA
-  VERJA
-  CENTRO DE CARRETERA
-  ORILLA CARRETERA
-  ZANJA EN HORMIGON 1.81 M.L.

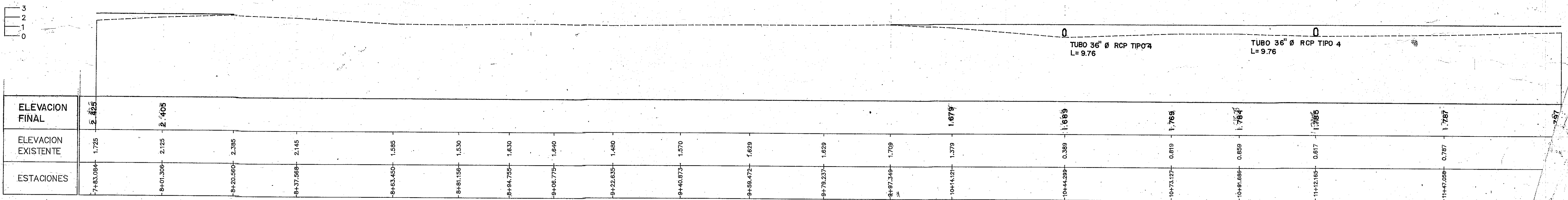

PERFILES DE LA ESTACION 7+83.084 A LA ESTACION 11+78.425

HOR: 1:500  
VER: 1:200

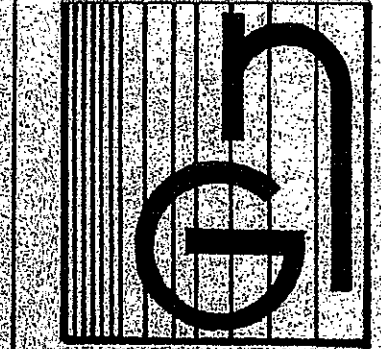

**GIL R. NIEVES**  
INGENIERO CIVIL  
LIC. 98.74  
CALLE 17 - NUM. 51 - COLINA  
RIO GRANDE, PUERTO RICO