

Inventory of the Old Jonesborough Cemetery, 1995

To remedy the absence of any detailed inventory of the Old Jonesborough Cemetery, a cataloguing of grave markers was performed in July, 1995. The inventory was initiated and designed by Dr. Gary Burkett and conducted by high school students who were participating in the Governor's School for Tennessee Heritage at ETSU's Center for Appalachian Studies and Services. The group of students who did this work were those participating in the "Historic Preservation" module of this program and were under the direction of Mr. Joe Spence, a high school teacher in Lenoir City. Mr. Spence and the students worked at the cemetery on July 10, 11 and 12. The Governor's School students, who worked diligently under the hot sun, were:

Rebecca Holbrook
Tonia Moore
Beth Dahl
Meighan Lenihan
Catie Martin

Brian McLean
Amanda Luke
Constanza Saravia
Michael Hogan

Lori Owen, a counselor with the program, and Mr. Spence also enthusiastically helped to catalogue the cemetery. Mr. Joe Spence is owed special gratitude for lending his expertise, as well as his hard work, to this effort.

Mr. Spence is contemplating having next year's Governor's School students produce a descriptive booklet about the Old Jonesborough Cemetery.

METHOD

Location Indicator

A technique was devised to describe the location of each grave marker.

1. The cemetery was divided into 13 "sections" (labeled A through M) as indicated on the attached map. The measurements provided on the map would enable future reconstruction of these sections. Sections were marked using stakes, string, and signs.
2. Within each section students were instructed to assign "rows," beginning with the grave markers closest to the front (west side) of the cemetery. Since the markers are not actually always in neat rows, a row sometimes consists of a single stone.
3. Within each row students were instructed to assign individual "numbers" for markers beginning with the marker closest to the south side of the cemetery.

Each grave marker, therefore, has a unique location indicator consisting of a combination of section, row, and number.

Information Collected

Each student was provided with a packet of forms to be used to record the information from each grave marker. The form, a copy of which is attached, had been designed based on suggestions from the book, A Gravestone Preservation Primer, by Lynette Strangstad.

Students were assigned to work by pairs in sections. In order to facilitate deciphering grave markers which were difficult or impossible to read, they used flour and/or chalk to highlight the inscriptions. Students often spent long periods of time attempting to read a single stone.

I have entered the information from the forms into a computer data base, which facilitates sorting and examining this information, and which I plan to update as more is discovered. I plan to check the accuracy of this information as time permits.

If anyone reviewing this information should discover mistakes that need correction or knows of additional information that should be added to these records, I would much appreciate hearing about it.

Working on this project is an ongoing process. There are scattered grave stones yet to be read and, perhaps, others to be discovered in the woods. Most importantly, the entire section of the cemetery commonly called by some "the colored cemetery" still needs to be inventoried. If others would like to help it would be welcomed.

Gary L. Burkett

**Old Jonesborough Cemetery
INDIVIDUAL MARKER RECORD**

1. Master Record Number				2. Location		Section	Row	Number
3. Date of Record			4. Name of Recorder					
5. Marker Type 1. Head 2. Foot 3. Family 4. Other:								
6. Material 1. Marble 2. Granite 3. Slate 4. Sandstone 5. Fieldstone 6. Other:								
7. Condition of Marker (circle all that apply) 1. Sound 2. Chipped 3. Cracked 4. Crumbled 5. Eroded 6. Broken 7. Tilted 8. Flat on ground 9. Part missing								
8. Direction marker faces: E SE S SW W NW N NE								
9. Maker of marker (if known):								
10. Number of people commemorated:								
a. Name				b:		d:		
b. Name				b:		d:		
c. Name				b:		d:		
d. Name				b:		d:		
e. Name				b:		d:		
f. Name				b:		d:		
11. Decorative carving motif: (Describe if other than lettering)					<input type="checkbox"/> Lettering only			
12. Inscription/Epitaph:								
13. Condition of inscription 1. Mint 2. Easily legible 3. Legible but worn 4. Partially illegible 5. Illegible								
14. Recorder's comments:								

Old Jonesborough Cemetery

SURVEY PLAN MAP

July, 1995

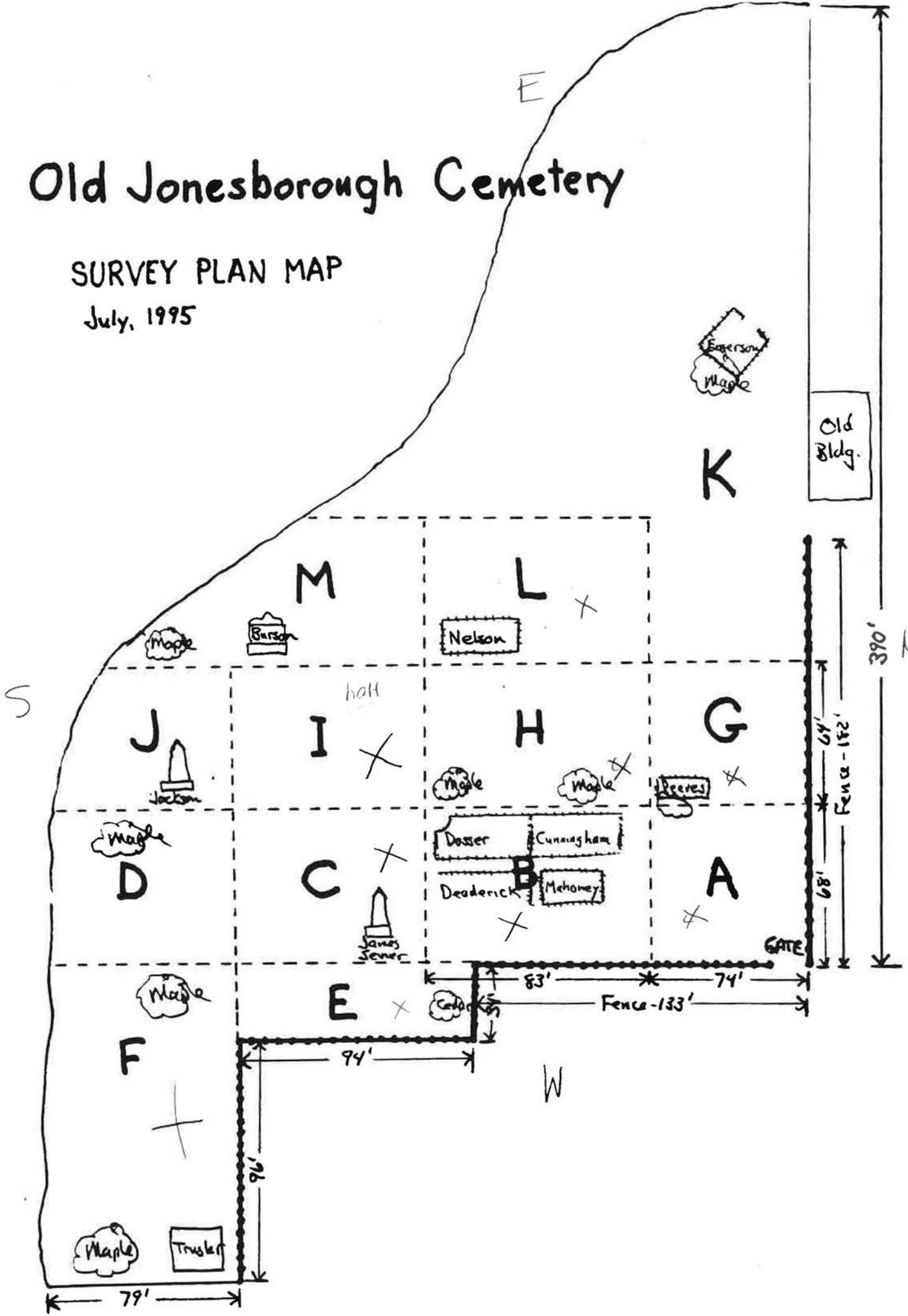

Name index

Sec. Row No.

Name

Born

Died

Age

A 1 11

A 2 1

A 2 2

A 2 3

A 2 4

A 3 4

?

?

?

D 6 1 (missing)

8/7 1870 56

Friday, July 28, 1995

Page 2

Sec. Row No. Name

Born

Died

Age

D 3 3 ?

?

L 6 3 ?

M 5 1 ?

H 8 3 A.C.

(initials only)

B 2 10 A.M.H.

?

?

?

J 5 1 Aiken

Amanda M.

4/20 1818

9/9 1857

39

<u>Sec.</u>	<u>Row No.</u>	<u>Name</u>	<u>Born</u>	<u>Died</u>	<u>Age</u>		
D	5	1	Aiken	Col. Matthew	3/27 1775	10/6 1860	85
			Aiken	Blanche B.	10/21 1789	11/28 1862	73
			Oecil	Blanche Aiken	2/13 1820	12/13 1862	42
			Aiken	Caroline J.	11/3 1828	5/5 1861	32
			Aiken	Robert S.	5/15 1818	12/1 1891	73
			Aiken	Margaretta H.	9/20 1831	9/4 1867	35
			Brown	Shepherd	1/26 1801	2/2 1883	82
			Mathews	Fannie E.	8/26 1821	7/24 1891	69
D	2	2	Allison	Mary Chester	1810	1887	77
D	6	2	Allison	Malvina Mathews	4/30 1854	12/27 1915	61
D	2	4	Allison	George W.	9/13 1849	2/11 1929	79
D	2	5	Allison	Robert Guy	6/20 1870	8/8 1937	67
E	2	6	Anderson	Roy Alexander	6/25 1874	2/27 1897	24
E	2	4	Anderson	Frank Deaderick	1/14 1876	5/1 1901	25

<u>Sec.</u>	<u>Row No.</u>	<u>Name</u>	<u>Born</u>	<u>Died</u>	<u>Age</u>	
E	2	5 Anderson	Mrs. Fannie Deaderick	1/4 1840	2/11 1909	69
F	5	2 Armstrong	Pvt. 1st Cl Wm. E. S.	?	?	?
F	5	1 Armstrong	Dr. E.P.	2/26 1812	2/17 1894	81
		Armstrong	Margaret C.	6/15 1832	12/21 1892	60
F	4	1 ✓Armstrong	John A.	?	5/8 1916	?
F	4	2 ✓Armstrong	Marie	?	5/19 1917	?
F	4	4 ✓Armstrong	John N.	3/13 1881	5/9 1950	69

<u>Sec.</u>	<u>Row No.</u>	<u>Name</u>	<u>Born</u>	<u>Died</u>	<u>Age</u>
H	3	1	Atkinson	Jas. J.	? ? ?
H	3	2	Atkinson	Margaret Elizabeth Williams	6/9 1841 3/7 1921 79
A	1	10	Bachman	Sarah Jane	6/14 1836 7/26 1864 28
E	2	13	Bachman	Howell	10/3 1890 11/30 1890 1 mo.
L	2	3	Baxter	Elbridge J.	9/2 1860 2/26 1937 76
L	2	4	Baxter	Eleanor L.	7/18 1864 7/18 1957 93
L	2	5	Baxter	Martha Lampson	4/22 1894 8/30 1990 96

<u>Sec.</u>	<u>Row No.</u>	<u>Name</u>	<u>Born</u>	<u>Died</u>	<u>Age</u>
I	5 1	Blair Sarah Ellen Polk	4/6-7 1844	3/14 1849	4
I	6 3	Blair Mary E.	1/1	3/11 1853	36?
I	5 2	Blair John	9/13 1790	3/22 1863	72
		Blair Mary H. Chester	5/12 1797	11/11 1872	75
I	1 1	Blair Robert L.	1802	5/12 1885	83
I	1 2	Blair Martha Roe	1810	12/21 1889	79
I	4 1	Blair Nathan Gammon	1/1 1859	6/6 1899	4 mo.
K	6 3	Breaseale Maria L.	1830	9/2 1839	9

Friday, July 28, 1995

Page 7

<u>Sec.</u>	<u>Row No.</u>	<u>Name</u>	<u>Born</u>	<u>Died</u>	<u>Age</u>		
K	3	1	Brigdon?	Belle	2/10 1825	12/3 1829	4
K	9	1	Brown	Sarah Ellen	1813	11/7 1813	9 mo.
K	10	1	Brown	Thomas C.	6/4 1833	10/26 1833	4 mo.
C	8	4	Brown	Caroline M.	6/31 1850	7/31 1853	3
C	3	2	Brown	Ann Rebecca	1/7 1799	2/6 1855	56
M	8	1	Brown	James Floyd	9/4 1850	3/10 1859	8
C	8	6	Brown	James	3 1802	2/23 1863	60

<u>Sec.</u>	<u>Row No.</u>	<u>Name</u>	<u>Born</u>	<u>Died</u>	<u>Age</u>		
C	9	1	Brown	Ellen	12/13 1849	3/26 1870	20
K	11	1	Brown	Rachel C.	1848	4/22 1875	27
C	3	1	Brown	Enoch	1806	9/15 1878	72
C	8	3	Brown	Joseph N.	1859	1896	37
C	8	5	Brown	George L.	8/18 1856	12/25 1897	41
C	8	1	Brown	Margaret R.	6/10 1901	12/22 1901	6 mos.
C	8	2	Brown	Love	12/17 1856	11/10 1902	45

<u>Sec.</u>	<u>Row No.</u>	<u>Name</u>	<u>Born</u>	<u>Died</u>	<u>Age</u>		
H	7	1	Broyles	(Father)	?	?	?
			Broyles	(Mother)	?	?	?
			Broyles	Jacob F.	12/10 1804	11/2 1896	94
			Broyles	Lucinda	9/14 1804	10/4 1891	87
A	4	5	Broyles	Jas. V.	4/8 1837	12/21 1864	27
A	3	8	Broyles	James Henry	5/18 1861	8/15 1865	4
A	4	4	Broyles	Bettie M.	2/18 1850	9/27 1868	18
A	3	6	Broyles	Andrew C.	1831	1927	96
			Broyles	Louesa A.E. Hunt	1838	1906	68
M	1	19	Burson	Z.L.B. (initials only)			
M	2	1	Burson	S. B. (initials only)			

<u>Sec.</u>	<u>Row No.</u>	<u>Name</u>	<u>Born</u>	<u>Died</u>	<u>Age</u>
M	1	14 Burson	Zachariah Whitfield	7/12 1851	6 mo.
M	1	13 Burson	Reason E.	7/12 1852 7/19 1852	7 days
M	3	4 Burson	Sarah A.W.	1787 10/12 1854	67
M	1	12 Burson	Susanna	2/14 1826 2/17 1856	30
M	1	15 Burson	Charlie Thomas	2/21 1858 8/5 1859	1
M	1	17 Burson	Little Eddie	1/21 1863 2/20 1864	1
M	1	18 Burson	Walter Murry	1/18 1867 5/18 1869	2

<u>Sec.</u>	<u>Row No.</u>	<u>Name</u>	<u>Born</u>	<u>Died</u>	<u>Age</u>		
M	3	5	Burson	William Cate	6/20 1855	5/20 1869	13
M	3	6	Burson	Robert Sidney	8/22 1868	5/12 1870	1
M	3	7	Burson	Sue Dungan	6/2 1872	6/2 1872	1 day
M	3	8	Burson	infant son	5/7 1873	5/8 1873	1 day
B	7	2	Burson	Roscoe	11/28 1890	7/10 1891	7 mo.
M	1	11	Burson	Z.L.	12/5 1817	9/11 1894	77
M	1	16	Burson?	Mary Lyle	10/2 1859	3/27 1862	2

<u>Sec.</u>	<u>Row No.</u>	<u>Name</u>	<u>Born</u>	<u>Died</u>	<u>Age</u>		
G	5	2	Burton	Thomas	11/14 1810	2/21 1886	75
G	5	1	Burton	Minerva Jane	12/10 1831	3/30 1910	79
K	1	1	Byers	Elizabeth	7/23 1812	10/19	?
G	4	3	C.E.R.	(initials only)	?	?	?
M	2	2	Campbell Campbell	Mittie J. infant daughter	5/21 1848	9/2 1876 1876	28
I	1	6	Carr	Isaac A.	2/28 1852	11/28 1854	2
I	3	2	Carr	Ida	10/8 1858	10/30 1858	22 days

<u>Sec.</u>	<u>Row No.</u>	<u>Name</u>	<u>Born</u>	<u>Died</u>	<u>Age</u>	
I	3	1 Carr	David Jobe	1/8 1816	2/13 1890	74
		Carr	Eliza Fain	3/7 1826	9/12 1890	64
A	3	1 Cate	Rev. William	6/17 1807	2/2 1860	52
A	3	2 Cate	Mary C.	6/20 1809	12/20 1872	63
G	4	10 Chester	Wm. Patterson	7/1 1825	10/9 1855	30
D	2	1 Chester	Mary Greer	1774	1860	86
M	1	1 Cooke	Ethel Panhorst	7/30 1885	12/4 1984	99
J	7	2 Correll	William H.	1852	1913	61

<u>Sec.</u>	<u>Row No.</u>	<u>Name</u>	<u>Born</u>	<u>Died</u>	<u>Age</u>		
J	7	1	Correll	Sarah N.	1853	1937	84
B	2	3	Cox	Sophia E. (infant)			infant
B	2	8	Cox	W.H.	?	?	?
B	2	9	Cox	A.L.	?	?	?
B	2	4	Cox	Hugh Aiken	4/20 1854	10/1 1855	5 mo.
B	2	5	Cox	Adelaide Louisa	12/28 1856	3/25 1857	3 mo.
B	2	2	Cox	Mrs. Sophia Eliza	8/15 1833	11/16 1858	25

<u>Sec.</u>	<u>Row No.</u>	<u>Name</u>	<u>Born</u>	<u>Died</u>	<u>Age</u>	
B	2	6 Cox	James C.	3/2 1824	7/24 1866	42
B	2	7 Cox	Cadet Wm H. Cox	10/25 1855	4/14 1875	19
F	6	4 Crouch	Elizabeth J.	1/19 1845	?/2 1891	46
C	8	12 Cunningham	Lizzie Alice	no dates		17
B	11	1 Cunningham	Nathaniel B.	10/26 1846	4/23 1849	2
B	11	2 Cunningham	Mary Lyon	12/26 1853	1/19 1856	2
B	11	3 Cunningham	Robert B.	5/24 1851	1/8 1856	4

<u>Sec.</u>	<u>Row No.</u>	<u>Name</u>	<u>Born</u>	<u>Died</u>	<u>Age</u>
B	10 1	Cunningham Dr. Samuel B.	10/9 1797	9/4 1867	69
C	8 11	Cunningham S.B.	1870	1870	infant
B	10 2	Cunningham Mrs. Ann A.D.	11/6 1810	10/21 1894	83
C	8 9	Cunningham Thomas N.	1866	1900	34
C	8 8	Cunningham Samuel A.	1834	1905	71
C	8 7	Cunningham Alice Nelson	1840	1916	76
C	8 10	Cunningham Martha Ellen	1863	1931	68

<u>Sec.</u>	<u>Row No.</u>	<u>Name</u>	<u>Born</u>	<u>Died</u>	<u>Age</u>
L	2	6	D.N.	(initials only)	
B	9	1	Davis	Jane H.	? 1806 1863 57
H	2	1	Davison	William Jefferson	? 11/6 1845 5?
H	2	2	Davison	James K. Polk	5/1 1845 6 mo.
H	2	3	Davison	(infant daughter)	4/13 1846 infant
B	1	3	Deaderick	D.L.	? ? 73
			Deaderick	R.W.	? ? 63
			Deaderick	Lula W.	? ? 22
			Deaderick	Annie G.	? ? 15
			Deaderick	Fannie R.	? ? 3
			Deaderick	May E.	? ? 3 mo.
			Deaderick	Joseph W.	? ? 1
			Deaderick	Mary L. / Rosa	5/3

<u>Sec.</u>	<u>Row</u>	<u>No.</u>	<u>Name</u>		<u>Born</u>	<u>Died</u>	<u>Age</u>
B	4	8	Deaderick	David	no dates	?	?
J	1	5	Deaderick	Adelaide Eliza [Jackson]	12/31 1796	12/9 1817	20
B	7	5	Deaderick	David	10/10 1754	10/20 1823	69
B	4	6	Deaderick	Joseph A.	5/12 1804	10/18 1835	31
B	4	7	Deaderick	Margaret Anderson	5/25 1775	10/21 1857	82
B	7	8	Deaderick	Rebecca L. Williams	8/1 1812	9/7 1857	45
B	7	4	Deaderick	Joseph Williams	10/15 1833	8/5 1861	27

<u>Sec.</u>	<u>Row No.</u>	<u>Name</u>	<u>Born</u>	<u>Died</u>	<u>Age</u>
B	1 1	Deaderick Eva Sackson	3/3 1836	10/9 1874	38
B	3 5	Deaderick May	12/26 1873	4/7 1874	4 mo.
B	3 3	Deaderick Joseph Williams	5/29 1875	6/7 1876	1
B	3 4	Deaderick Fannie Rebecca	9/18 1872	5/3 1876	3
B	1 2	Deaderick W.V.	8/26 1826	9/27 1883	57
B	2 12	Deaderick Rosa	12/23 1880	12/15 1883	3
B	2 13	Deaderick Mary Lanier	3/16 1879	12/7 1883	3

<u>Sec.</u>	<u>Row No.</u>	<u>Name</u>	<u>Born</u>	<u>Died</u>	<u>Age</u>	
B	7	9 Deaderick	J. Franklin	10/21 1806	9/12 1884	77
E	3	5 Deaderick	James William	9/4 1882	3/4 1885	2
E	2	10 Deaderick	J.W.	11/25 1812	10/7 1890	77
B	4	5 Deaderick	Catherine R.	?	9/17 1895	?
B	4	4 Deaderick	Eliza R.	8/3 1845	10/24 1897	52
E	2	11 Deaderick	Adeline McDowell	11/8 1814	2/1 1904	89
E	2	1 Deaderick	Ina Elsie	6/22 1878	5/8 1905	26

<u>Sec.</u>	<u>Row No.</u>	<u>Name</u>	<u>Born</u>	<u>Died</u>	<u>Age</u>
E	2 2	Deaderick David	2/12 1835	1/25 1906	70
E	2 9	Deaderick Alfred S.	9/16 1845	5/21 1907	61
E	2 3	Deaderick Eva Clarkson	1855	1920	65
B	7 3	Deaderick Susan L.	1/1 1838	1/4 1923	85
E	2 8	Deaderick Carter Luster	1/19 1852	4/2 1932	80
E	2 7	Deaderick Adelyn McDowell	9/26 1881	4/17 1967	85

<u>Sec.</u>	<u>Row</u>	<u>No.</u>	<u>Name</u>		<u>Born</u>	<u>Died</u>	<u>Age</u>
B	6	2	Deaderick?	S.A.D. (initials only)	no dates		?
B	7	7	Deaderick?	M.A.D. (initials only)			?
B	7	6	Deaderick?	Little Margaret	7/23 1832	1/11 1833	5 mo.
B	5	1	Deaderick?	Little Louis	11/11 1841	10/3 1843	1
D	9	3	Dillworth	Mary Charlotte	6/6 1802	?	?
D	9	2	Dillworth	James A.	11/7 1797	5/9 1822	25
B	8	2	Dosser	Caroline	8/20 1826	11/10 1853	27

<u>Sec.</u>	<u>Row No.</u>	<u>Name</u>	<u>Born</u>	<u>Died</u>	<u>Age</u>		
D	3	2	Dosser	Virginia Carter	3/16 1859	6/2 1860	1
B	11	6	Dosser Dosser	Jas. Horace Fannie	12/13 1867 8/1 1874	2/16 1869 4/4 1875	1 8 mo.
D	5	2	Dosser	Virginia E. Squibb	8/13 1855	2/26 1875	19
D	4	1	Dosser	William	8/30 1849	10/1 1883	34
B	11	5	Dosser	Juliette	4/16 1888	4/28 1890	2
F	2	6	Dosser	infant		11/6 1890	?
B	9	2	Dosser Dosser	James H. Fannie A.	6/2 1823 11/2 1830	5/26 1891 7/4 1896	67 65

<u>Sec.</u>	<u>Row</u>	<u>No.</u>	<u>Name</u>	<u>Born</u>	<u>Died</u>	<u>Age</u>
D	4	2	Dosser	Mary Wilds	12/7 1851	3/15 1896 44
F	2	3	✓ Dosser	Nellie Fain	10/19 1860	7/4 1901 40
F	2	5	Dosser	Laura B. Brunner infant son	7/7 1868	3/1 1908 39
F	2	4	✓ Dosser	Robert N.	6/1 1856	3/20 1927 70
D	4	3	Dosser	Lilian M.	5/26 1874	4/15 1953 78
B	8	3	Dosser?	J.H.D. (initials only)		?
B	8	4	Dosser?	F.A.D. (initials only)		?

<u>Sec.</u>	<u>Row No.</u>	<u>Name</u>	<u>Born</u>	<u>Died</u>	<u>Age</u>
B	10 3	Duncan Sophie Cunningham	10/29 1848	1/31 1884	35
B	10 4	Duncan Rhea C.	3/6 1883	5/18 1884	1
G	4 2	Elam? Florence L. Bowers	12/13 1854	8/25 1875	20
K	4 1	Emmerson Eliza C.	5/1 1816	6/18 1844	28
K	6 4	Emmerson Catharine	11/19 1789	12/10 1858	69
K	6 1	Emmerson? ?			
K	6 2	Emmerson? ?			

<u>Sec.</u>	<u>Row No.</u>	<u>Name</u>		<u>Born</u>	<u>Died</u>	<u>Age</u>
K	6	6	Emmerson?	?		
K	6	6	Emmerson?	?		
L	4	3	Fain	see L-6-2		
L	4	4	Fain	see L-6-2		
L	3	1	Fain	infant daughter	2/23 1866	2/23 1866 1 day
L	6	2	Fain Fain	John H. Fanny A. Rhea	11/27 1825 3/6 1834	7/5 1873 8/26 1903 47 69
L	4	1	Fain	James Rhea	5/26 1863	6/9 1927 74

<u>Sec.</u>	<u>Row No.</u>	<u>Name</u>	<u>Born</u>	<u>Died</u>	<u>Age</u>		
L	4	2	Fain	Lillian Mary	11/26 1880	5/22 1966	85
A	1	1	French	Anna Maria	9/29 1876	7/1 1878	1
J	3	6	Fuller	Frederick Jackson	3/18 1875	8/21 1959	84
J	3	7	Fuller	Sammie Ward	1/17 1879	11/12 1969	90
B	8	1	Gibson	Harriet E.	1/27 1831	7/11 1852	21
B	11	4	Gibson	Jeremiah	2/23 1786	7/17 1868	82
			Gibson	Phoebe	6/16 1782	5/4 1864	81
			Gibson	Dr. David J.	4/17 1822	4/20 1884	62
			Gibson	Sarah A.	5/24 1832	2/16 1919	86
D	1	1	Gifford	Francis	3 1818	1/13 1855	36

<u>Sec.</u>	<u>Row</u>	<u>No.</u>	<u>Name</u>		<u>Born</u>	<u>Died</u>	<u>Age</u>
F	2	2	Goff	L.B.	10/24 1875	8/7 1898	22
D	1	3	Greer	Allison			?
C	6	1	Grisham	Evalina	12/6 1881	9/5 1882	8 mos.
F	1	1	Hafkemeyer	Bertha	1884	1935	51
F	6	3	Hall	Ellen C.	10/3 1826	11/16 1888	62
G	2	2	✓ Hashbarger	Amanda Virginia	11/25 1847	7/23 1849	1

<u>Sec.</u>	<u>Row No.</u>	<u>Name</u>	<u>Born</u>	<u>Died</u>	<u>Age</u>		
H	8	2	Haworth	David Riley	7/14 1872	7/3 1942	69
			Haworth	Jess Vernon Patton	8/2 1878	7/14 1956	78
			Patton	Landon Hale	4/29 1847	1/13 1924	76
			Patton	Delcenia Ann Brunner	7/12 1859	1/1 1930	70
E	3	4	Holmes	Achsah Evelyn	?	2/25 1942	?
C	5	4	Hoss	Infant son		4/10 1850	infant
A	1	5	Hoss	Henry Sevier	4/20 1857	2/25 1861	3
A	1	4	Hoss	Minerva E.	12/5 1859	7/9 1863	3
A	1	3	Hoss	Henry	10/29 1818	8/6 1885	66
A	1	2	Hoss	Mrs. Anna M.	2/4 1825	7/24 1891	66

<u>Sec.</u>	<u>Row No.</u>	<u>Name</u>	<u>Born</u>	<u>Died</u>	<u>Age</u>
C	5	2 Hoss	L.C.	1/17 1817	2/16 1891 74
C	5	3 Hoss	L.P.	4/12 1825	11/29 1893 68
C	7	1 Hoss	Rowena P.	11/13 1864	10/4 1918 53
C	6	4 Hoss	Carrie L.	8/31 1859	5/10 1927 67
F	3	2 Huff	Chas. A.O.	1830	5/11 1912 82
		Huff	Mrs. Mary E.	12/5 1832	3/12 1901 69
A	3	7 Hunt	Warrington C.	11/2 1809	12/5 1826 17
A	4	2 Hunter	Laura J.	1/2 1863	10/19 1881 18

<u>Sec.</u>	<u>Row No.</u>	<u>Name</u>	<u>Born</u>	<u>Died</u>	<u>Age</u>	
A	4	3 Hunter	Fannie R.	9/7 1841	10/19 1888	47
K	7	1 Irvin	Samuel	12/23 1800	5 1801	5 mo.
H	6	2 Irvin	Mrs. Frances R.	2/1 1807	6/23 1854	47
H	6	1 Irvin	Montgomery	3/14 1802	4/11 1857	55
J	2	1 Jackson				
J	1	4 Jackson	Cordelia Maria	9/30 1857	11/11 1858	1
J	4	1 Jackson	Seraphina Cordelia	1845	1858	13

<u>Sec.</u>	<u>Row</u>	<u>No.</u>	<u>Name</u>		<u>Born</u>	<u>Died</u>	<u>Age</u>
J	3	3	Jackson	Capt. Alfred E.	1843	3/6 1862	18
J	3	4	Jackson	Maj. Nathaniel T.	1830	10/27 1862	32
J	3	2	Jackson	Seraphina C.	1808	10/27 1880	72
J	3	1	Jackson	Gen. A.E.	6/11 1817	10/30 1889	72
J	3	5	Jackson	Henry C.	1847	1914	67
D	7	1	Johnson	Mary Etter	9/15 1856	1/13 1857	3 mo.
G	2	3	Johnson	Elizabeth C.	7/9 1790	9/22 1861	71

<u>Sec.</u>	<u>Row No.</u>	<u>Name</u>	<u>Born</u>	<u>Died</u>	<u>Age</u>		
G	4	9	Kennedy	Thomas R.	1805	1847	42
			Kennedy	Harriet E.	1809	1872	61
			Kennedy	William E.	1835	1838	3
			Kennedy	Mary D.	1837	1843	6
			Kennedy	Charles A.	1846	1889	43
			Gresham	Laura B.	1876	1882	6
G	4	8	Kennedy	Judge John	1766	1856	90
			Kennedy	Katherine Greer	1760	1840	80
G	2	1	Kenney	Minerva Crainer	?	9/26 1861	?
E	2	12	Kitzmiller	Richard Carr	3/2 1831	1/22 1920	88
			Kitzmiller	Eleanor Bachman	11/11 1844	12/13 1921	77
M	1	2	Laird	Daisy Panhorst	2/24 1880	3/19 1970	90
L	7	1	Lampson	infant (see L-6-4)			
L	7	2	Lampson	L. (see L-6-4)			

<u>Sec.</u>	<u>Row No.</u>	<u>Name</u>	<u>Born</u>	<u>Died</u>	<u>Age</u>
L	7	3	Lampson	N.R. (see L-6-4)	
L	6	4	Lampson	Nannie Rhea	3/19 1867
			Lampson	infant	10/27 1862
			Lampson	Lucy L.	
					7/28 1873
					6/22 1869
					3/3 1866
					6
					infant
					3
L	5	1	Lampson	John L.	8/13 1824
			Lampson	Martha E.	2/23 1827
					4/20 1877
					4/12 1882
					52
					55
L	4	5	Lampson	John Lynn	2/7 1858
					11/29 1900
					42
M	3	9	Lloyd	Elizabeth	1781
					9/19 1808
					27
H	7	4	Locke	Arnin V.?	12/13 1879
					2/22 1885
					5
L	2	2	Lucky	?	

<u>Sec.</u>	<u>Row No.</u>	<u>Name</u>	<u>Born</u>	<u>Died</u>	<u>Age</u>	
L	1	3	Lucky Sarah	1806	9/9 1862	56
L	1	2	Lucky Seth J.W.	12/7 1799	4/16 1869	69
L	1	1	Lucky Mrs. Mary	8/27 1817	6/28 1903	85
L	6	1	Lucy John Tho. Ballentine Lucy Marjorie Luikart Fai	1909 1905	1974 6/4 1994	65 89
B	4	1	Mahoney Dr. M.S. Mahoney Margaret	1832 1832	1883 1920	51 88
F	4	3	✓Marcoux Amos J.	4/14 1865	7/19 1944	79
K	2	1	Martin India Birch	1852	7/2 1853	infant

<u>Sec.</u>	<u>Row No.</u>	<u>Name</u>	<u>Born</u>	<u>Died</u>	<u>Age</u>	
C	2	1 Mason James	?	?	?	
H	4	1 Mason Meyer 1872-1873?	Infant Phillip J.	? 1807	? 1872	infant 65
H	8	1 Mason Sue Tyler	6/10 1843	2/14 1875	31	
H	4	1 ✓Mason Archibald G.	1813	1895	82	
		✓Mason Lucinda Ryland	1820	1854	34	
		✓Mason Angelina Cosson Ryland	1829	1909	80	
		✓Mason Martha Ellen	1844	1853	9	
		✓Mason Marietta	1848	1866	18	
		✓Mason Anna B.	1846	1873	27	
		✓Mason Lucinda	1854	1874	20	
		✓Mason Lena D.	1861	1915	54	
M	6	4 Mathes Florence	5/6 1871	4/18 1873	2	
M	6	3 Mathes Little Johnnie Borell	3/24 1874	12/30 1874	9 mo.	
M	4	1 Mathes J.S.	7/5 1876	7/8 1876	3 days	
		Mathes A.A.	7/5 1876	7/8 1876	3 days	

<u>Sec.</u>	<u>Row No.</u>	<u>Name</u>	<u>Born</u>	<u>Died</u>	<u>Age</u>	
M	2	3 Mathes	Geo. Edgar	1877	8/9 1877	7 mo.
M	7	2 Mathes	Annis A. Borell	8/10 1846	3/12 1888	41
M	9	1 Mathes	W.E.	2/13 1836	10/14 1890	54
C	5	1 Maxwell	Hanna	1745	3/18 1811	65
E	1	7 McCall	Wm. P.	1863	1901	38
E	1	6 McCall	Robert M.	10/28 1890	7/17 1948	58
E	1	8 McCall	Anna H.	1863	1962	99

<u>Sec.</u>	<u>Row No.</u>	<u>Name</u>	<u>Born</u>	<u>Died</u>	<u>Age</u>
E	1 9	McCall William Printup	1893	1978	85
M	3 3	McClure Frances Ewing	11/24 1858	8/9 1860	1
M	3 2	McClure Willie Graham	9/29 1860	10/28 1861	1
M	3 1	McClure June Letitia	12/13 1839	3/19 1869	29
F	4 6	✓ McClure John F.	2/14 1884	6/26 1895	11
F	4 5	McClure Sara G. ^{or C}	4/10 1865	2/2 1901	35
I	1 4	McLin C.J.	5/3 1825	1/17 1855	29

<u>Sec. Row No.</u>			<u>Name</u>	<u>Born</u>	<u>Died</u>	<u>Age</u>
I	1	3	McLin Little Katie	2/7 1881	7/10 1881	5 mo.
F	1	6	Metzger Carrie C. Smith	1890	1949	59
F	1	5	Metzger Paul T.	5/22 1891	7/5 1962	71
I	6	1	Munsley Munsley William, D.D. Virginia A. Blair	7/13 1833 7/6 1839	10/23 1877 4/8 1915	44 75
J	1	3	Murphy Wm. Alfred	8/30 1851	5/2 1895	43
J	1	2	Murphy Eugenia	7/10 1851	12/8 1900	49
J	1	1	Murphy Eliza C.	1/31 1831	8/27 1914	83

<u>Sec.</u>	<u>Row No.</u>	<u>Name</u>	<u>Born</u>	<u>Died</u>	<u>Age</u>
J	6	1	Naff	Catharine	2/15 1848 7/26 1852 4
J	6	2	Naff	George Eakin	1849 3/14 1899 50
L	2	8	Nelson	Ann E. (see family mon't)	
L	2	7	Nelson	Mrs. Ann E.	11/9 1816 5/23 1830 13
			Nelson	Alexander W.	1841 1874 33
			Nelson	David M.	1845 1881 36
			Nelson	Helen	1849 1897 48
L	1	4	Nelson	David	2/11 1780 9/2 1850 70
L	1	5	Nelson	A.E.N. (initials only)	11/9 1816 5/23 1850 33
H	1	1	Osborne	O.H.	3/17 1855 3/10? 1879 24

<u>Sec.</u>	<u>Row No.</u>	<u>Name</u>	<u>Born</u>	<u>Died</u>	<u>Age</u>				
A	3	5	Outlaw	Mrs. Margaret E.H.	1818	7/24	1851	33	
			Outlaw	W.m David	1844	12/30	1847	3	
			Outlaw	Frances Mackey		1/21	1846	?	
			Outlaw	twin infants				infants	
M	1	3	Panhorst	Dr. Mari Hendrik Philip	12/27	1847	4/23	1932	85
M	1	4	Panhorst	Katherine Simpson	8/26	1849	6/13	1946	96
B	2	11	Patterson	J.W.	5/25	1854	6/29	1895	41
F	1	4	Patton	Mrs. Lula Smith	11/15	1873	1/4	1928	54
C	1	1	Peoples	Landon C.	10/3	1850	4/13	1887	36
C	1	2	Peoples	Nathan B.	11/9	1862	8/14	1888	25

<u>Sec.</u>	<u>Row No.</u>	<u>Name</u>	<u>Born</u>	<u>Died</u>	<u>Age</u>		
M	1	5	Perkins	Ella Simpson	10/31 1855	10/16 1927	71
F	6	2	Pierce	James A.	8/1 1860	11/17 1896	36
F	6	1	Pierce	Anna Dosser	1/10 1859	7/12 1946	87
M	1	7	Piper	Nellie S.	11/6 1884	7/12 1886	1
F	6	7	Powell	Harriet E. Blackmore	2/7 1827	6/15 1890	63
F	6	8	Powell	William	4/4 1818	1/18 1902	83

<u>Sec.</u>	<u>Row No.</u>	<u>Name</u>	<u>Born</u>	<u>Died</u>	<u>Age</u>
D	1 2	Prichett James L.	?	1/12 1885	65
M	7 1	Pullion Allie May	11/26 1891	8/3 1892	8 mo.
G	1 2	Reeves Julia	8/9 1833	8/29 1878	45
G	1 1	Reeves Reeves? Wm. P. Mary DeVault	12/19 1807 2/7 1808	8/20 1885 11/12 1894	77 86
E	1 3	Reeves Mary Murphy	3/14 1857	10/15 1905	48
E	1 5	Reeves Blannie I.	1847	1928	81
E	1 2	Reeves William Rollin	6/20 1850	5/19 1930	79

<u>Sec.</u>	<u>Row No.</u>	<u>Name</u>	<u>Born</u>	<u>Died</u>	<u>Age</u>		
E	1	1	Reeves	Mary Rosabelle	6/27 1854	6/20 1941	86
F	3	1	Reeves	Anna Claire	1881	1976	95
			Reeves	Mary Lois	3/22 1886	10/16 1911	25
			Reeves	Isaac Edward	5/10 1842	1/21 1899	57
			Reeves	Mary Dosser	10/6 1849	9/12 1931	81
H	6	3	Rhea	John	5/31 1810	8/24 1862	52
I	2	1	Rhea	Margaret Carr	1/13 1893	1/13 1893	1 day
I	1	7	Rhea	William R.	10/20 1840	6/1 1903	62
M	1	6	Riddick	Edward E.	10/21 1880	1/5 1906	25
F	6	5	Rinehart	Eliza J.	8/29 1822	1/20 1889	66

<u>Sec.</u>	<u>Row No.</u>	<u>Name</u>	<u>Born</u>	<u>Died</u>	<u>Age</u>		
B	3	2	Rogan Edward Rogan	Isadore	9/3 1845 6/6 1847	4/6 1910 11/30 1883	66 35
E	3	1	Rogan	Susan T.	4/27 1838	5/25 1920	82
B	4	3	Rogan	Carrie Lanier	?	8/22 1921	?
B	4	2	Rogan	Sue Deaderick	?	8/16 1931	?
G	3	3	Russell	James G.	11/14 1852	?	?
G	3	2	Russell	Caroline E.	4/13 1818	7/10 1898	80
G	4	5	Russell	Lauretta	10/12 1840	6/4 1910	69

<u>Sec.</u>	<u>Row No.</u>	<u>Name</u>	<u>Born</u>	<u>Died</u>	<u>Age</u>
G	4	1	Russell	Lizzie	4/4 1836 1/5 1911 74
G	4	7	Russell	Romeo J.	1/25 1875 11/14 1912 37
G	4	6	Russell	Charles E.	2/24 1856 9/24 1916 60
G	3	5	Russell	William A.	10/20 1838 8/9 1920 81
G	3	1	Russell	Mary V.	1845 1933 88
H	4	2	Ryland	John	1795 1857 62
			Ryland	Rebecca Livens	1797 1866 69
			Johnson	Elizabeth R.	1830 1864 34
			Ryland	Matilda J.	? 1870 ?
			Anderson	Eliza Ryland	1835 1869 34
			Ryland	Fanny	? ? ?
			Ryland	Anna	? ? ?

<u>Sec.</u>	<u>Row No.</u>	<u>Name</u>	<u>Born</u>	<u>Died</u>	<u>Age</u>				
B	2	1	S.E.C.						
D	2	3	Sehrwald	Apphia Allison	12/10 1854	12/13 1935			81
H	5	1	Sensabaugh	L.P.	5/16 1836	5/27 1869			33
G	1	3	Sensabaugh	Mary Leon	8/19 1868	11/7 1902			34
E	1	4	Sensabaugh	Sue. D. Reeves	1835	1918			83
A	1	8	Sevier	Martha Ellen	8/8 1825	4/15 1862			36
A	1	9	Sevier	Samuel Dayton	3/31 1846	4/17 1862			16

<u>Sec.</u>	<u>Row No.</u>	<u>Name</u>	<u>Born</u>	<u>Died</u>	<u>Age</u>	
A	1	7 Sevier	Dr. W.R.	9/7 1822	8/22 1886	63
C	4	1 Sevier	James	3/14 1814	6/4 1888	74
		Sevier	Eva M.	1829	1890	71
A	1	6 Sevier	Lucy Evans	2/11 1840	2/1 1903	72
H	9	1 Sherfy	Jessee J.	?	10/11 1818	36
D	9	1 Shipley	James Edward	7/24 1852	4/18 1872	19
B	7	1 Shipley	Carrie	12/5 1856	11/7 1882	25

<u>Sec.</u>	<u>Row No.</u>	<u>Name</u>	<u>Born</u>	<u>Died</u>	<u>Age</u>
I	8 2	Simpson James	?	?	?
M	1 10	Simpson Mary C.	6/22 1813	2/25 1860	46
M	1 9	Simpson John W.	2/23 1800	6/26 1887	87
M	1 8	Simpson Caroline S.	1817	10/15 1892	75
C	6 2	Slemons Lucile			?
C	6 3	Slemons Lillie	8/29 1883	7/26 1884	11 mos.
H	8 5	Slemons William G.	7/15 1815	2/22 1887	71

<u>Sec.</u>	<u>Row No.</u>	<u>Name</u>	<u>Born</u>	<u>Died</u>	<u>Age</u>		
H	8	4	Slemons	R.M.	1864	1911	47
H	8	6	Slemons	Maria Dosser	7/11 1825	6/12 1912	86
H	8	7	Slemons	Alice Graham	1850	1939	89
G	3	4	Smith	Richard M.	2 1818	6/21 1857	39
F	6	6	Smith	Tommie Lee	6/20 1894	7/30 1895	1
F	1	3	Smith	George L.	9/7 1851	5/23 1920	69
F	1	2	Smith	Caroline Rebecca Wild	6/13 1853	12/11 1937	84

<u>Sec.</u>	<u>Row No.</u>	<u>Name</u>	<u>Born</u>	<u>Died</u>	<u>Age</u>	
K	5	1 Sparks	?	?	?	
J	8	1 Sparks	Horace H.	2/4 1859	6/7 1859	4 mo.
M	2	5 Sparks	Augustus R. (M.D.)	1820	12/10 1870	50
H	7	3 Sparks	William A.	4/4 1849	10/26 1877	28
M	2	4 Sparks	Gus L.	4/14 1875	12/13 1903	28
H	7	2 Sparks	Mary Broyles	5/16 1844	3/28 1922	77
D	3	4 Squibb	Mary E.	6/27 1861	11/6 1877	16

<u>Sec.</u>	<u>Row No.</u>	<u>Name</u>	<u>Born</u>	<u>Died</u>	<u>Age</u>		
L	2	1	Stuart	Samuel Decatur	3/29 1866	11/8 1893	27
			Stuart	Mary Fain	5/11 1868	6/21 1894	26
			Stuart	Samuel D.	8/10 1893	6/22 1894	10 mo.
I	1	5	Tadlock?	Little Bettie	9/9 1861	8/30	infant?
D	3	1	Taylor	Walter	11/4 1861	9/6 1865	3
M	6	2	Thomas	Angeline S. Burson	2/2 1822	8/29 1885	63
M	6	1	Thomas	Joel B.	7/11 1825	11/5 1890	65
F	2	1	Trusler	Robert F.	1/ 1888	4/ 1965	77
			Trusler	Laura Barner	12 1862	1 1946	84
			Trusler	Andrew	8/ 1861	10/ 1939	78
			✓Trusler	Ada Maie	12 1885	3/ 1905	19

<u>Sec.</u>	<u>Row No.</u>	<u>Name</u>	<u>Born</u>	<u>Died</u>	<u>Age</u>
G	1 5	Unknown	?	?	?
G	4 4	Unknown	?	?	?
H	10 1	Unknown	?	?	?
I	4 2	Unknown	?	?	?
I	5 3	Unknown	?	?	?
I	6 2	Unknown	?	?	?

<u>Sec.</u>	<u>Row No.</u>	<u>Name</u>	<u>Born</u>	<u>Died</u>	<u>Age</u>		
I	6	5	Unknown	?	?	?	
K	7	2	Unknown	?			
K	8	2	Unknown				
F	3	3	Ward	infant daughter	10/9 1917	infant	
G	1	4	Watson	?	?	?	
G	3	6	Watson	Jessey Hamett	?	10/30 1883	30
D	8	4	Wells	Thomas Belden	1846	11/6 1846	1 mo.

<u>Sec.</u>	<u>Row No.</u>	<u>Name</u>	<u>Born</u>	<u>Died</u>	<u>Age</u>		
D	8	1	Wells	(infant daughter)	1851	11/29 1851	8 hrs.
D	8	3	Wells	Sarah Ann	1847	8/28 1853	6
D	8	2	Wells	(twin sons)	1856	9/23 1856	11 hrs.
K	8	1	West	Leah M.	1/7 1813	8/11 1835	22
I	6	4	White	Mary Blair	3 1851	6/24 1852	1
A	3	3	Whitlock	John Wesley	1/18 1847	2/13 1886	39
C	9	2	Wild	John A.	11/6 1801	7/6 1883	81

<u>Sec.</u>	<u>Row No.</u>	<u>Name</u>	<u>Born</u>	<u>Died</u>	<u>Age</u>	
I	8	1 Willett	William F.	7/15 1835	11/26 1848	13
I	7	1 Willett	George W.	1808	1856	48
		Willett	Eliza M.	1815	1886	71
		Willett	William F.	1835	1848	13
		Willett	Zed T.	1838	1862	24
		Willett	Sam A.	1844	1863	19
		Frost	Mary A.	1838	1899	61
B	1	4 Williams	Lina	6/20 1847	11/30 1873	26
E	3	3 Williams	Sarah L.	1/30 1814	3/22 1888	74
E	3	2 Williams	Joseph	11/16 1810	2/14 1898	87
B	3	1 unknown		7/21	7/31	?