

OLD JONESBOROUGH

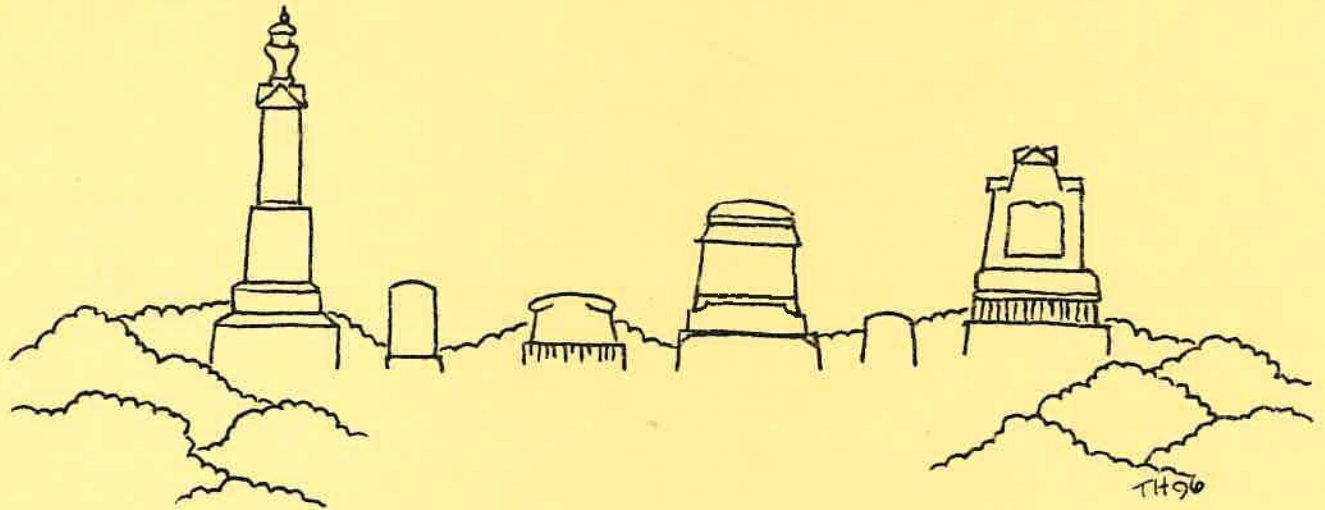

CEMETERY

## Introduction

The Jonesborough Cemetery was catalogued by participants in the Historic Preservation project groups in the 1995 and 1996 Governor's School for Tennessee Heritage. At the request of Dr. Gary Burkett, a detailed catalogue was created to remedy the absence of a complete inventory of the Old Jonesborough Cemetery. This project was conducted by a group of high school students under the direction of Mr. Joe Spence, a high school teacher from Lenoir City, Tennessee. The 1995 project group catalogued the main portion of the Old Jonesborough Cemetery. This section of the cemetery, catalogued on July 10, 11, and 12 of 1995, contains the graves of primarily white persons. In June 1996, a second portion, containing the graves of African-Americans, was uncovered. On June 28 and July 1, the 1996 project group catalogued this section of the cemetery. The Governor's School students who worked diligently, enduring the hot sun, poison ivy, and yellow jackets, are as follows:

### 1995:

Peter Chen  
Beth Dahl  
Michael Hogan  
Rebecca Holbrook  
Meighan Lenihan  
Amanda Luke

Catie Martin  
Brian McLean  
Tonia Moore  
Constanza Saravia  
Counselor Lori  
McCallister

### 1996:

Mark Chen  
Brittney Bae Craft  
Linda Jean Curty  
Trenton Durand Hanner  
Christie Michelle Hayes  
Joshua George Lutz

Josh Mattox  
Kristine Radke  
Jerry Alan Sayers  
Matt Stiggins  
Counselor Marsha  
McReynolds

## METHOD

### Location Indicator

A technique was devised to describe the location of each grave marker.

1. The cemetery was divided into 20 "sections" (labeled A through T) as indicated on the attached map. The measurements provided on the map would enable future reconstruction of these sections. Sections were marked using stakes, string, and signs.
2. Within each section students were instructed to assign "rows," beginning with the grave markers closest to the front (west side) of the cemetery. Since the markers are not actually

always in neat rows, a row sometimes consists of a single stone.

3. Within each row students were instructed to assign individual "numbers" for markers beginning with the marker closest to the south side of the cemetery. Each grave marker, therefore, has a unique location indicator consisting of a combination of section, row, and number.

#### Information Collected

Each student was provided with a packet of forms to be used to record the information from each grave marker. The form, a copy of which is attached, had been designed based on suggestions from the book, *A Gravestone Preservation Primer*, by Lynette Strangstad.

Students were assigned to work by pairs in sections. In order to facilitate deciphering grave markers which were difficult or impossible to read, flour and/or chalk were used to highlight the inscriptions. Students often spent long periods of time attempting to read a single stone.

---

Dr. Gary Burkett has entered the information from the forms into a computer data base, which facilitates sorting and examining this information. He plans to update and check the accuracy of this information as time permits.

If anyone reviewing this information should discover mistakes that need correction or knows of additional information that should be added to these records, we would appreciate hearing about it.

---

Working on this project is an ongoing process. There are scattered grave stones yet to be read and, perhaps, others to be discovered in the woods. Dr. Gary Burkett and Mr. Joe Spence are owed special gratitude for lending their expertise, as well as their hard work, to this effort. We would also like to express our appreciation to David Guy, son of Tennessee History teacher Bob Guy, for drawing the section maps of the cemetery.

Linda Jean Curty  
Christie Michelle Hayes

**Old Jonesborough Cemetery  
INDIVIDUAL MARKER RECORD**

<b>1. Master Record Number</b>				<b>2. Location</b>		<b>Section</b>	<b>Row</b>	<b>Number</b>
<b>3. Date of Record</b>			<b>4. Name of Recorder</b>					
<b>5. Marker Type</b> 1. Head   2. Foot   3. Family   4. Other:								
<b>6. Material</b> 1. Marble   2. Granite   3. Slate   4. Sandstone   5. Fieldstone   6. Other:								
<b>7. Condition of Marker (circle all that apply)</b> 1. Sound   2. Chipped   3. Cracked   4. Crumbled   5. Eroded   6. Broken 7. Tilted   8. Flat on ground   9. Part missing								
<b>8. Direction marker faces:</b> E   SE   S   SW   W   NW   N   NE								
<b>9. Maker of marker (if known):</b>								
<b>10. Number of people commemorated:</b>								
<b>a. Name</b>						<b>b:</b>	<b>d:</b>	
<b>b. Name</b>						<b>b:</b>	<b>d:</b>	
<b>c. Name</b>						<b>b:</b>	<b>d:</b>	
<b>d. Name</b>						<b>b:</b>	<b>d:</b>	
<b>e. Name</b>						<b>b:</b>	<b>d:</b>	
<b>f. Name</b>						<b>b:</b>	<b>d:</b>	
<b>11. Decorative carving motif:</b> (Describe if other than lettering)					<input type="checkbox"/> Lettering only			
<b>12. Inscription/Epitaph:</b>								
<b>13. Condition of inscription</b> 1. Mint      2. Easily legible      3. Legible but worn      4. Partially illegible      5. Illegible								
<b>14. Recorder's comments:</b>								



ABOVE: The William H. Cox grave has one of the most interesting headstones in the cemetery. Cadet Cox accidentally drowned near the U.S. Naval Academy. The headstone depicts an overturned boat, an oar, a cap, and two hands sinking into the water.

RIGHT: The sarcophagus-like tomb is one of the more unique grave-sites in the Old Jonesborough Cemetery.

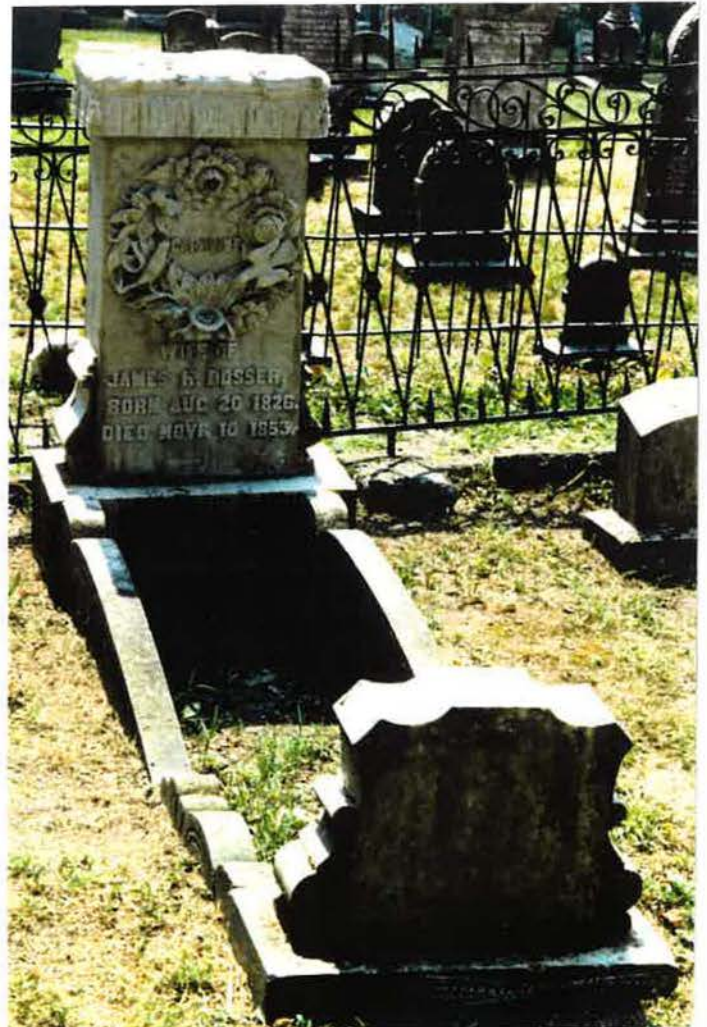

RIGHT: This headstone is interesting not only for the lovely carvings on the top of the marker but also for the inscription that reads, "Her twin babes sleep in her arms."



LEFT: The epitaph reads:  
*"Slain not this urn with sorrows tear  
 Naught God a blighted leaf is here  
 The cherished flower, not fully blown  
 Its opening beauties scarcely known  
 Was severed from its earthly stem  
 To deck an angels diadem."*

# Old Jonesborough Cemetery

SURVEY PLAN MAP

July, 1995

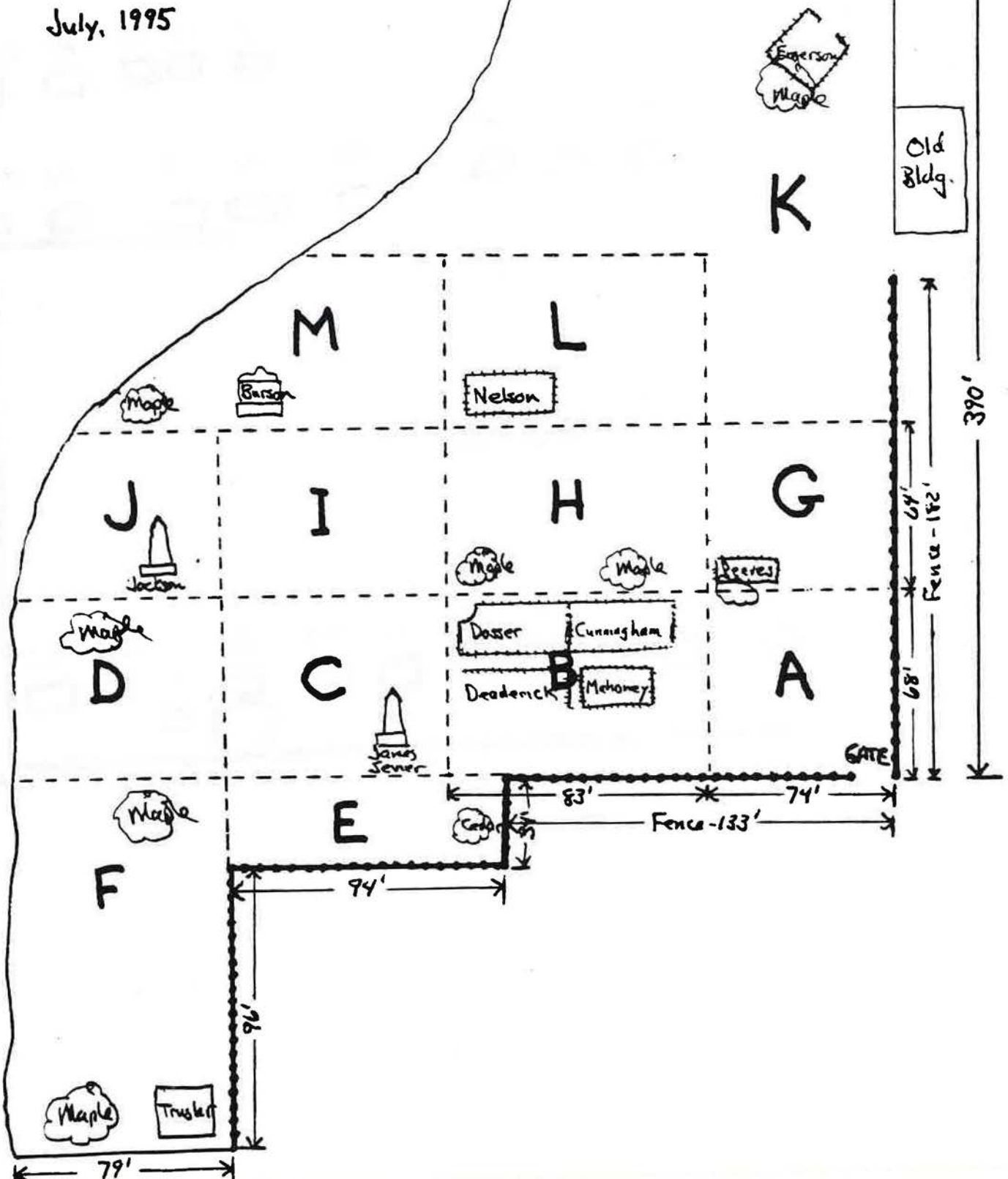

$\frac{4}{5}$   $\frac{4}{4}$   $\frac{4}{3}$   $\frac{4}{2}$   $\frac{3}{5}$



$\frac{3}{8}$   $\frac{3}{7}$   $\frac{3}{6}$   $\frac{3}{5}$   $\frac{3}{4}$

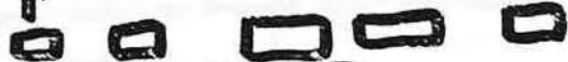

$\frac{3}{3}$   $\frac{3}{2}$   $\frac{3}{1}$



$\frac{2}{4}$   $\frac{2}{3}$   $\frac{2}{2}$   $\frac{2}{1}$



$\frac{1}{11}$   $\frac{1}{10}$   $\frac{1}{9}$   $\frac{1}{8}$   $\frac{1}{7}$   $\frac{1}{6}$   $\frac{1}{5}$   $\frac{1}{4}$   $\frac{1}{3}$   $\frac{1}{2}$   $\frac{1}{1}$





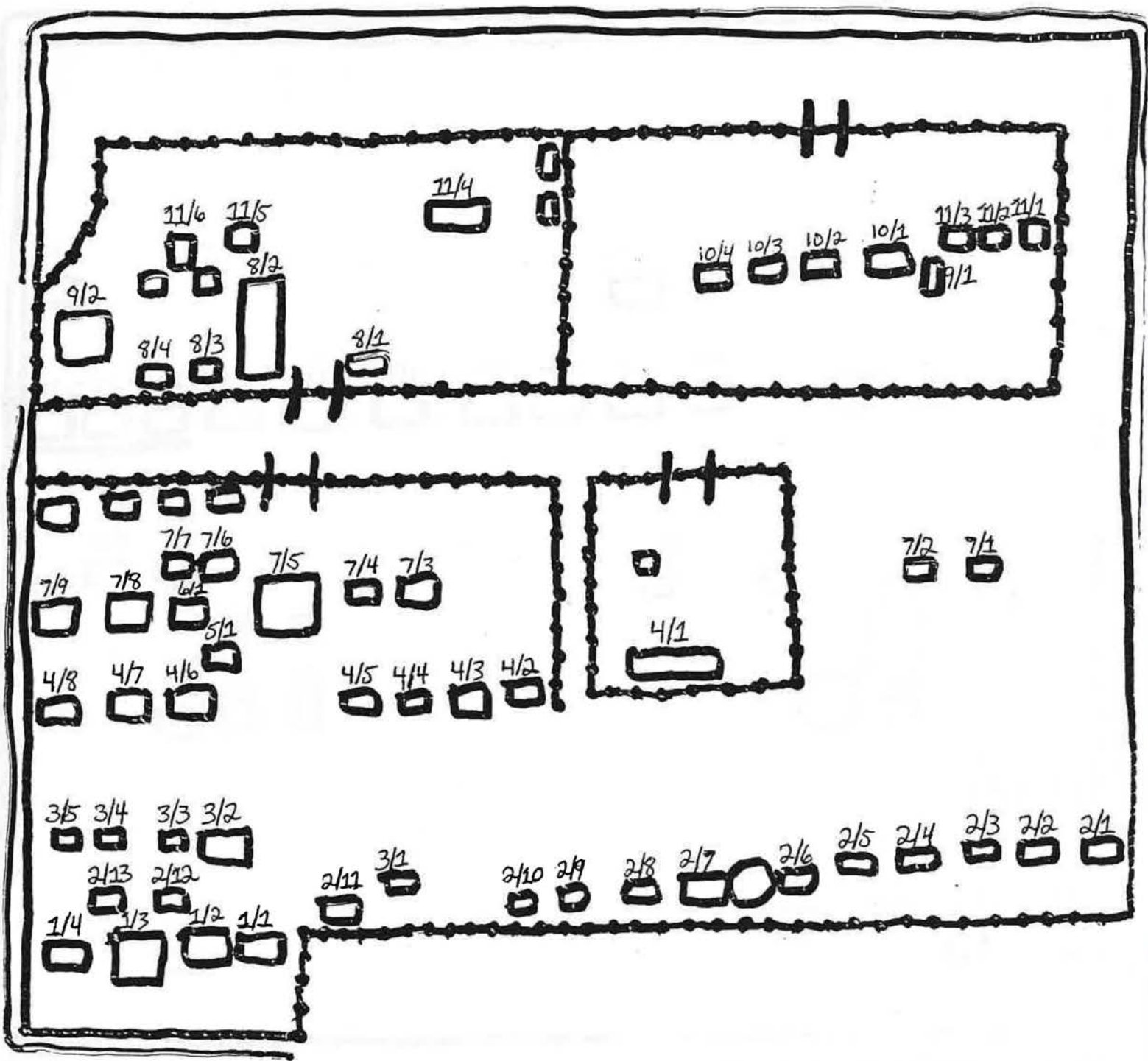

B

9/2  
□

9/2  
□

8/12 8/11 8/10 8/9 8/8 8/7 8/6 8/5 8/4 8/3 8/2 8/1  
□ □ □ □ □ □ □ □ □ □ □ □

6/4  
□

7/2  
□

6/3  
□

6/2  
□

6/1  
□

□ □  
5/4 5/3 5/2  
□ □ □

5/1  
□  
□ □

4/2 4/1  
□ □

2/1  
□

3/2  
□

3/1  
□

1/2  
□

1/1  
□





$9/3$   $9/3$   $9/1$   
□ □ □

$8/4$   $8/3$   $8/2$   $8/1$   
□ □ □ □

$7/1$   
□

$5/2$   $4/3$   $4/2$   $4/1$  □  
□ □ □ □

$5/1$   $6/2$   $6/1$   $3/2$   
□ □ □ □

$3/4$   $3/3$   $3/2$   
□ □ □

$3/1$   
□

$2/5$   $2/4$   $2/3$   $2/2$   $2/1$   
□ □ □ □ □

$1/3$   
□

$1/2$   
□

$1/1$   
□

D

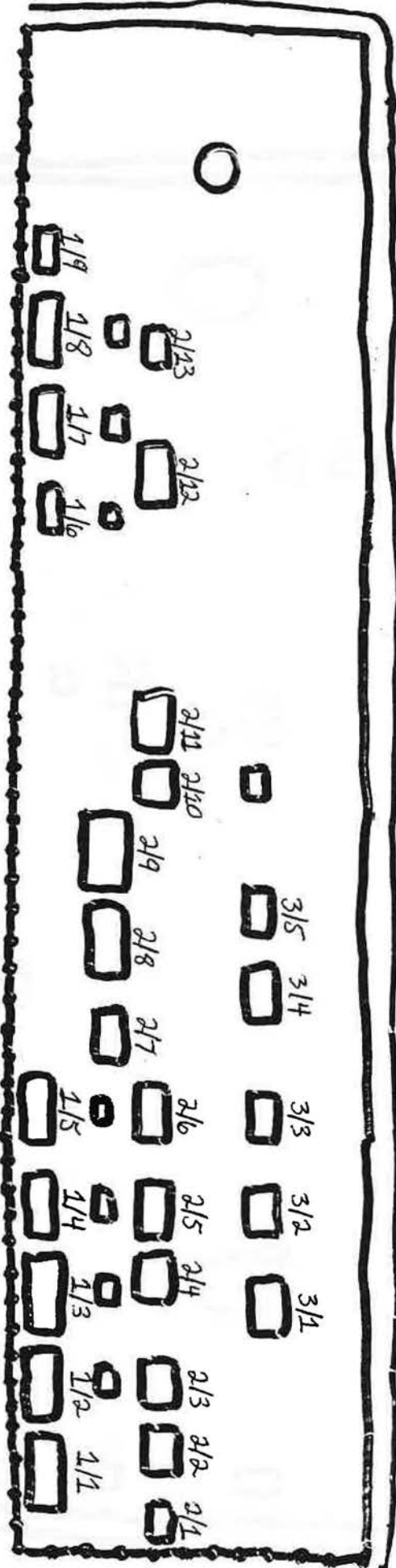

E

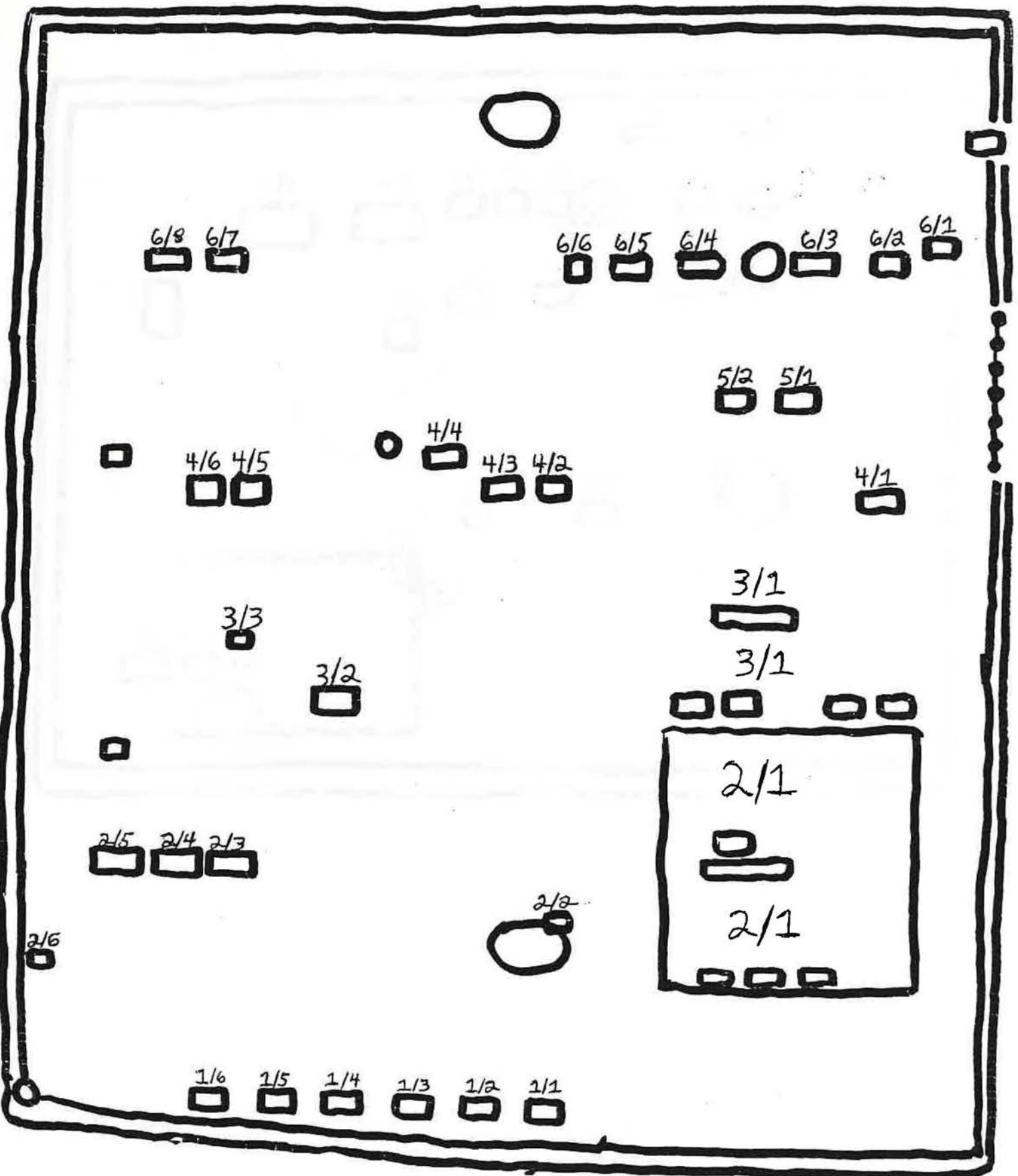

F

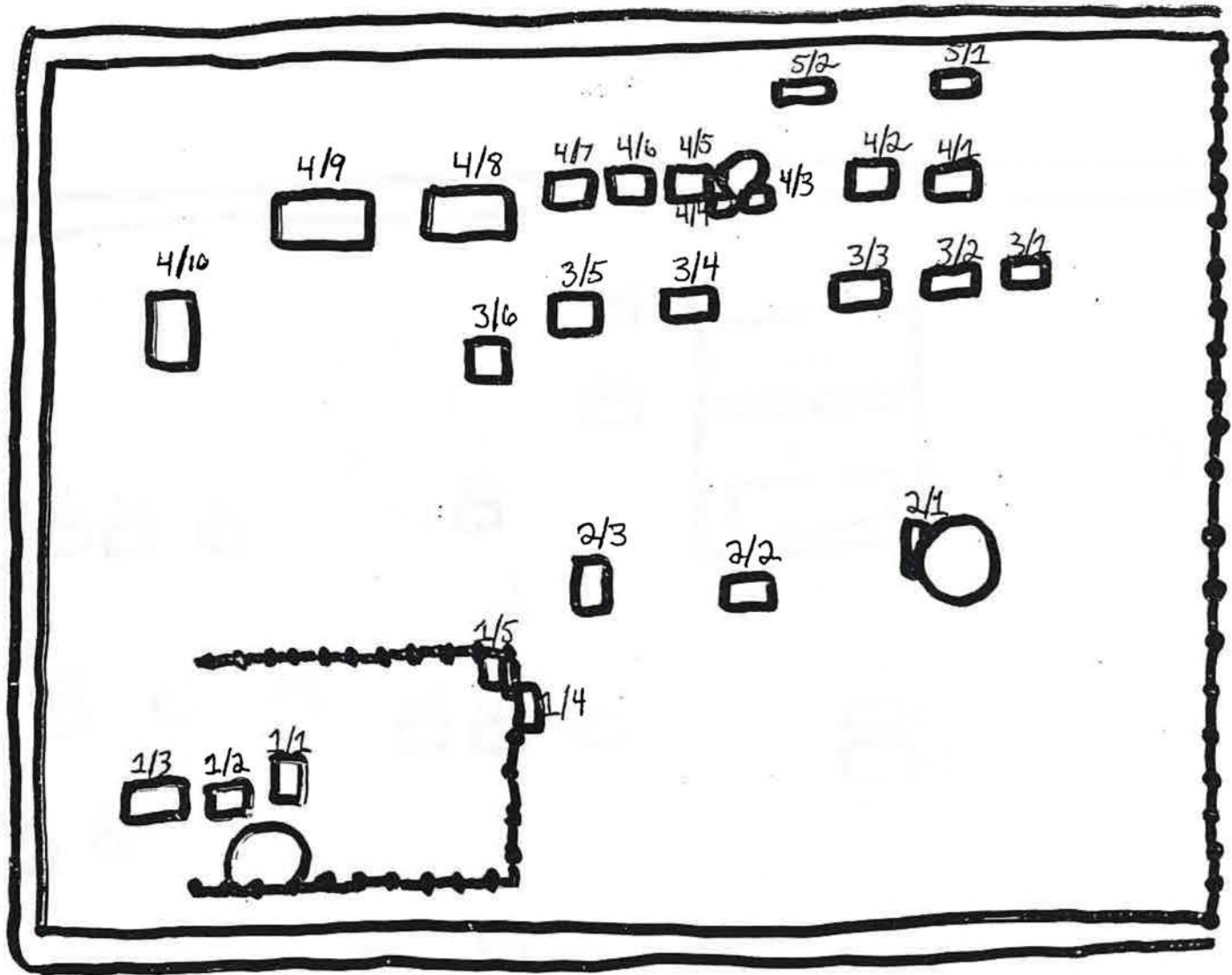

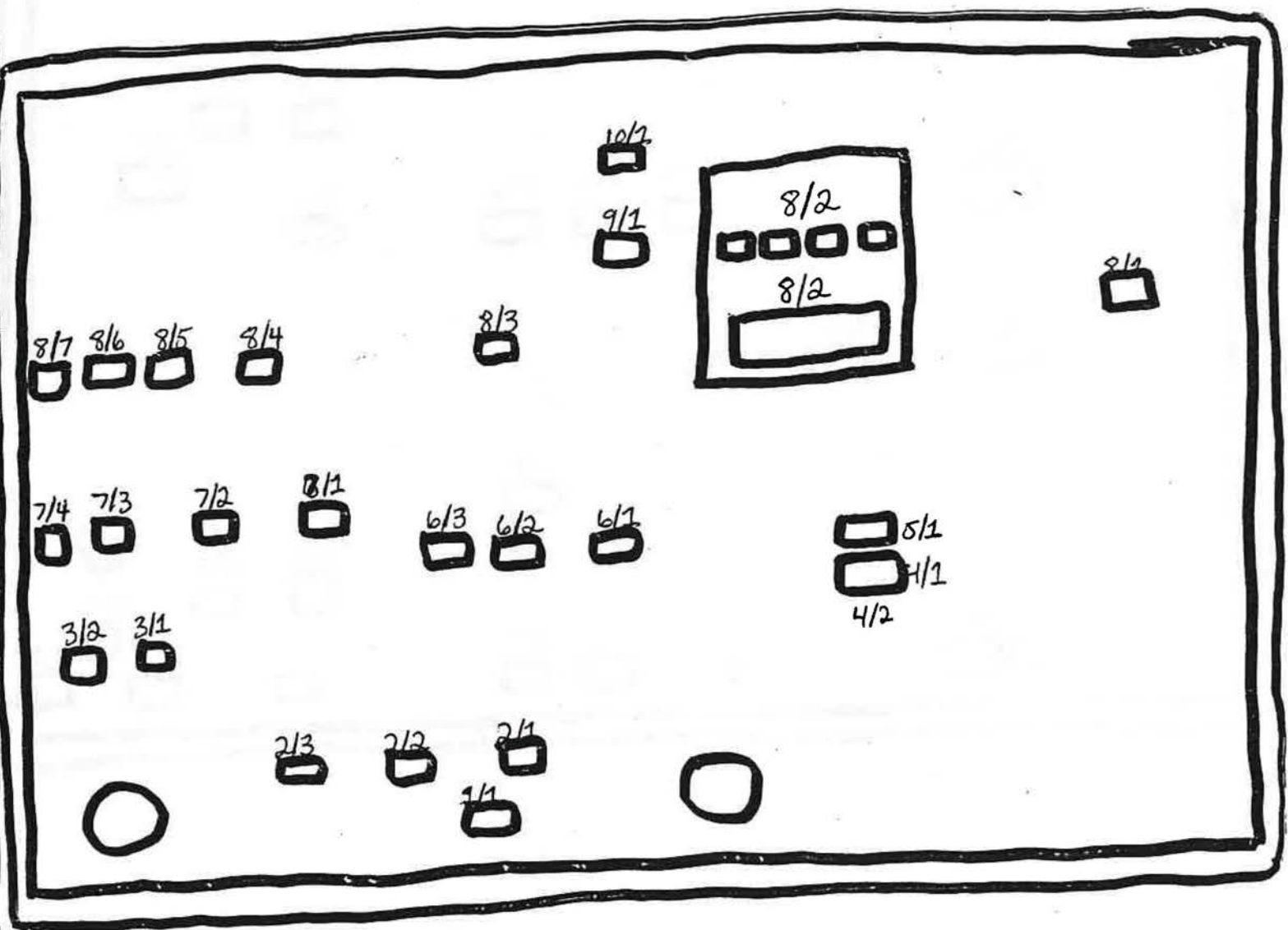

$7/2$   
 $8/2$   
 $8/1$   
 $6/5$

$6/4$   $6/3$   $6/2$

$6/1$

$5/3$   $5/2$   $5/1$

$4/2$

$4/2$   
 $3/2$   $3/1$   
 $2/1$   
 $1/7$   $1/6$

$1/5$   $1/4$   $1/3$

$1/2$   $1/1$

11



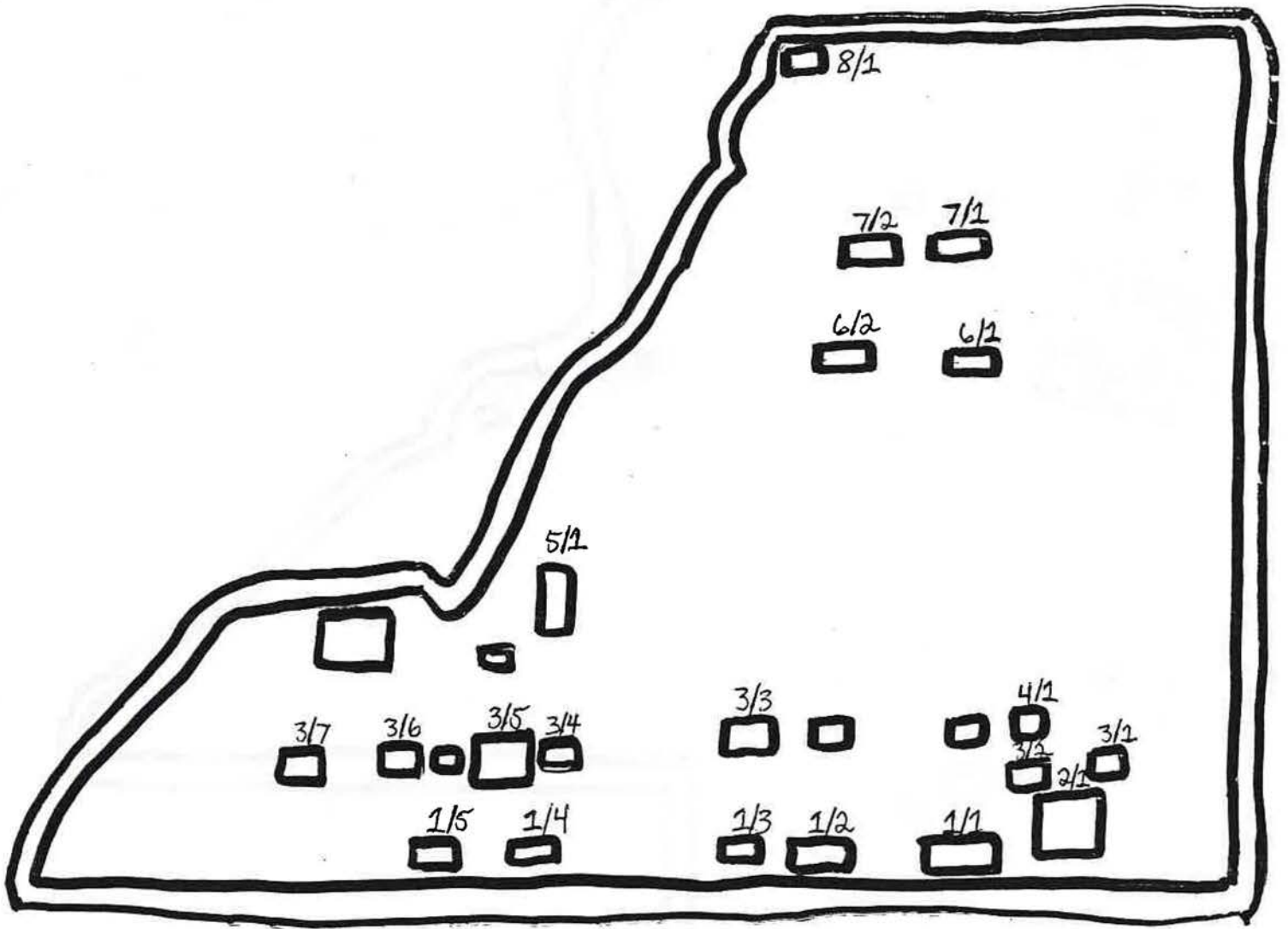

15

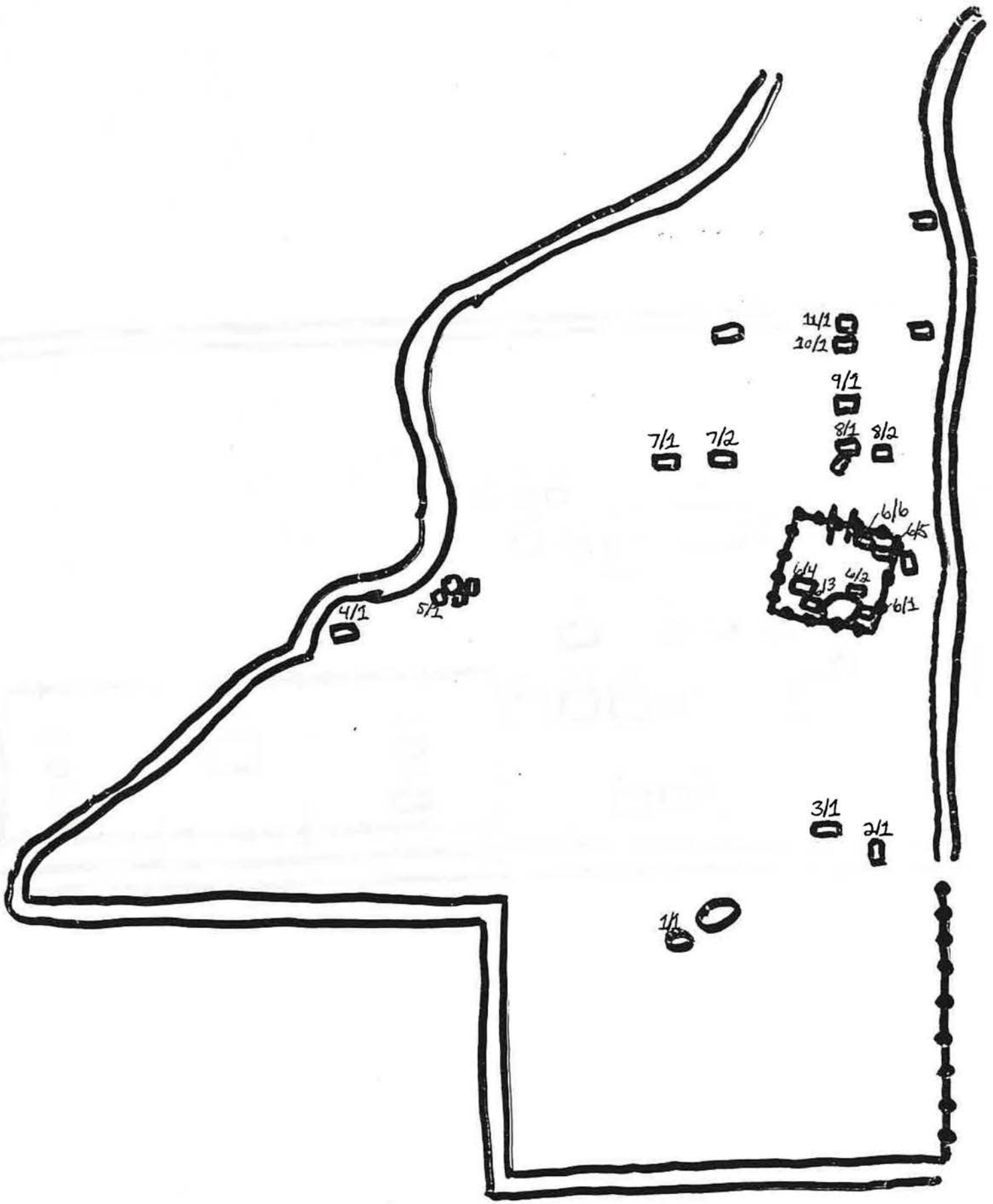

K

$7/3$   $7/2$   $7/1$   
□ □ □  
 $6/4$   $6/3$   $5/1$  □ □  $6/1$   
□ □ □ □ □

$4/5$   $4/4$   $4/3$   $4/2$   $4/1$   
□ □ □ □ □  
 $2/5$   $2/4$   $2/3$   $2/2$   $2/1$   $3/1$   
□ □ □ □ □ □

$1/3$   $1/2$   $1/1$   
□ □ □

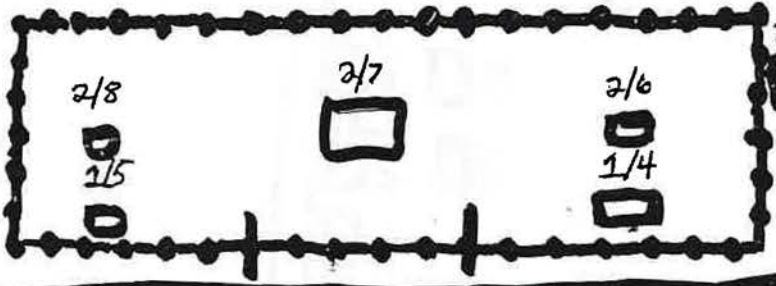

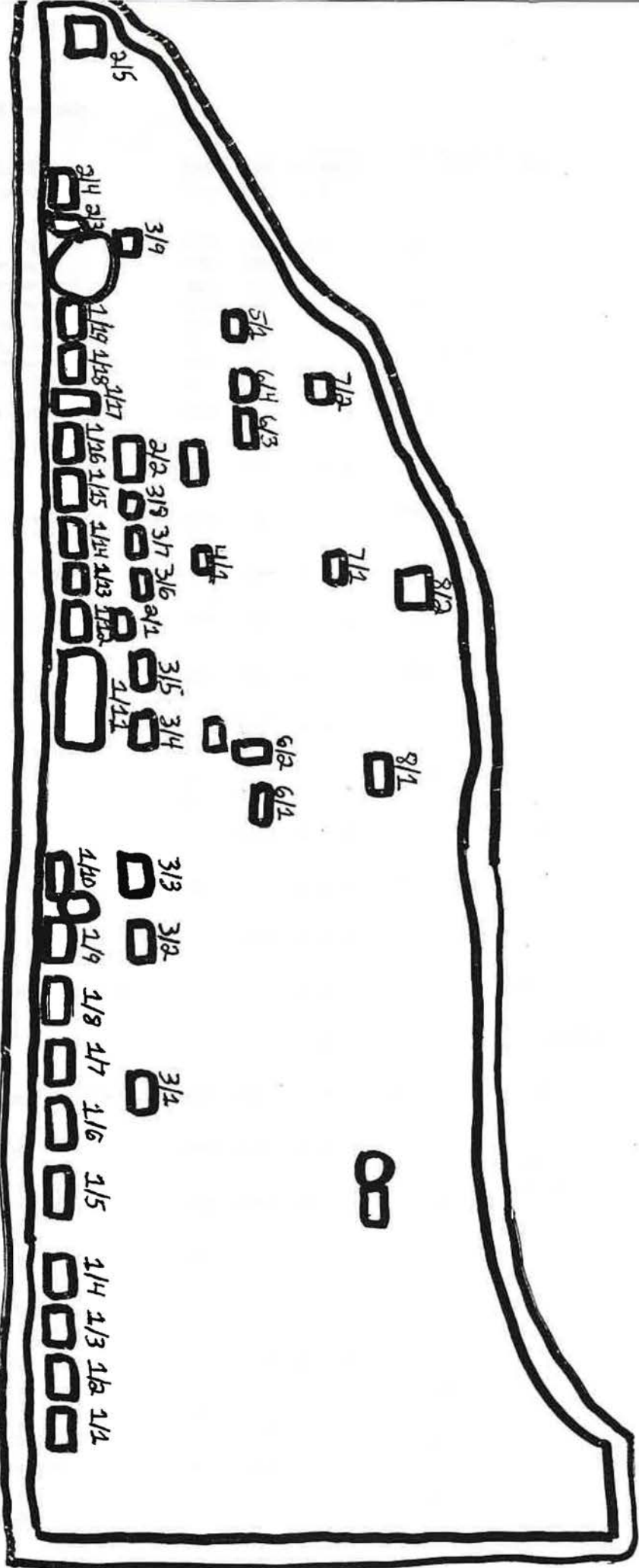

W

Old Jonesborough Cemetery

Name(s) on Marker		Born	Died	Location Sec. Row No.	Name(s) on Marker		Born	Died	Location Sec. Row No.
Last Name	First Name				Last Name	First Name			
Aiken	Amanda M.	1818	1857	J 5 1	Blair	Nathan Gammon	1859	1899	I 4 1
Aiken	Col. Matthew	1775	1860	D 5 1	Blair	Robert L.	1802	1885	I 1 1
Aiken	Blanche B.	1789	1862		Blair	Sarah Ellen Polk	1844	1849	I 5 1
Aiken	Blanche Oecil	1862	1820		Breaseale	Maria L.	1830	1839	K 6 3
Aiken	Caroline J.	1828	1861		Brigdon?	Belle	1825	1829	K 3 1
Aiken	Robert S.	1818	1891		Brown	Ann Rebecca	1799	1855	C 3 2
Aiken	Margaretta H.	1831	1867		Brown	Caroline M.	1850	1853	C 8 4
Brown	Shepherd	1801	1883		Brown	Ellen	1849	1870	C 9 1
Mathews	Fannie E.	1821	1891		Brown	Enoch	1806	1878	C 3 1
Allison	George W.	1849	1929	D 2 4	Brown	George L.	1856	1897	C 8 5
Allison	Malvina Mathews	1854	1915	D 6 2	Brown	James	1802	1863	C 8 6
Allison	Mary Chester	1810	1887	D 2 2	Brown	James Floyd	1850	1859	M 8 1
Allison	Robert Guy	1870	1937	D 2 5	Brown	Joseph N.	1859	1896	C 8 3
Anderson	Frank Deaderick	1876	1901	E 2 4	Brown	Love	1856	1902	C 8 2
Anderson	Mrs. Fannie Deaderick	1840	1909	E 2 5	Brown	Margaret R.	1901	1901	C 8 1
Anderson	Roy Alexander	1874	1897	E 2 6	Brown	Rachel C.	1848	1875	K 11 1
Armstrong	Dr. E.P.	1812	1894	F 5 1	Brown	Sarah Ellen	1813	1813	K 9 1
Armstrong	Margaret C.	1832	1892		Brown	Thomas C.	1833	1833	K 10 1
Armstrong	John A.		1916	F 4 1	Broyles	(Father)			H 7 1
Armstrong	John N.	1881	1950	F 4 4	Broyles	(Mother)			
Armstrong	Marie		1917	F 4 2	Broyles	Jacob F.	1896	1804	
Armstrong	Pvt. 1st Cl Wm. E. S.			F 5 2	Broyles	Lucinda	1804	1891	
Atkinson	Jas. J.			H 3 1	Broyles	Andrew C.	1831	1927	A 3 6
Atkinson	Margaret Elizabeth	1841	1921	H 3 2	Broyles	Louesa A.E. Hunt	1838	1906	
Bachman	Howell	1890	1890	E 2 13	Broyles	Bettie M.	1850	1868	A 4 4
Bachman	Sarah Jane	1836	1864	A 1 10	Broyles	James Henry	1861	1865	A 3 8
Baxter	Elbridge J.	1860	1937	L 2 3	Broyles	Jas. V.	1837	1864	A 4 5
Baxter	Eleanor L.	1864	1957	L 2 4	Burson	Charlie Thomas	1858	1859	M 1 15
Baxter	Martha Lampson	1894	1990	L 2 5	Burson	Mary Lyle	1859	1862	M 1 16
Blair	John	1790	1863	I 5 2					
Blair	Mary H. Chester	1797	1872						
Blair	Martha Roe	1810	1889	I 1 2					
Blair	Mary E.		1853	I 6 3					

Old Jonesborough Cemetery

Name(s) on Marker		Born	Died	Location Sec. Row No.	Name(s) on Marker		Born	Died	Location Sec. Row No.
Last Name	First Name				Last Name	First Name			
Burson	Reason E.	1852	1852	M 1 13	Chester	Wm. Patterson	1825	1855	G 4 10
Burson	Robert Sidney	1868	1870	M 3 6	Cooke	Ethel Panhorst	1885	1984	M 1 1
Burson	Roscoe	1890	1891	B 7 2	Correll	Sarah N.	1853	1937	J 7 1
Burson	S. B.			M 2 1	Correll	William H.	1852	1913	J 7 2
Burson	Sarah A.W.	1787	1854	M 3 4	Cox	A.L.			B 2 9
Burson	Sue Dungan	1872	1872	M 3 7	Cox	Adelaide Louisa	1856	1857	B 2 5
Burson	Susanna	1826	1856	M 1 12	Cox	Cadet Wm H. Cox	1855	1875	B 2 7
Burson	Walter Murry	1867	1869	M 1 18	Cox	Hugh Aiken	1854	1855	B 2 4
Burson	William Cate	1855	1869	M 3 5	Cox	James C.	1824	1866	B 2 6
Burson	Z.L.	1817	1894	M 1 11	Cox	Mrs. Sophia Eliza	1833	1858	B 2 2
Burson	Z.L.B. (initials only)			M 1 19	Cox	Sophia E. (infant)			B 2 3
Burson	Zachariah Whitfield		1851	M 1 14	Cox	W.H.			B 2 8
Burson	infant son	1873	1873	M 3 8	Crouch	Elizabeth J.	1845	1891	F 6 4
Burson?	Little Eddie	1863	1864	M 1 17	Cunningham	Alice Nelson	1840	1916	C 8 7
Burton	Minerva Jane	1831	1910	G 5 1	Cunningham	Dr. Samuel B.	1797	1867	B 10 1
Burton	Thomas	1810	1886	G 5 2	Cunningham	Lizzie Alice			C 8 12
Byers	Elizabeth	1812		K 1 1	Cunningham	Martha Ellen	1863	1931	C 8 10
C.	A. (initials only)			H 8 3	Cunningham	Mary Lyon	1853	1856	B 11 2
C.	S.E. (initials only)			B 2 1	Cunningham	Mrs. Ann A.D.	1810	1894	B 10 2
Campbell Campbell	Mittie J. infant daughter	1848	1876 1876	M 2 2	Cunningham	Nathaniel B.	1846	1849	B 11 1
Carr Carr	David Jobe Eliza Fain	1816 1826	1890 1890	I 3 1	Cunningham	Robert B.	1851	1856	B 11 3
Carr	Ida	1858	1858	I 3 2	Cunningham	S.B.	1870	1870	C 8 11
Carr	Isaac A.	1852	1854	I 1 6	Cunningham	Samuel A.	1834	1905	C 8 8
Cate	Mary C.	1809	1872	A 3 2	Cunningham	Thomas N.	1866	1900	C 8 9
Cate	Rev. William	1807	1860	A 3 1	Davis	Jane H.	1806	1863	B 9 1
Chester	Mary Greer	1774	1860	D 2 1	Davison	(infant daughter)		1846	H 2 3

Old Jonesborough Cemetery

Name(s) on Marker		Born	Died	Location Sec. Row No.	Name(s) on Marker		Born	Died	Location Sec. Row No.
Last Name	First Name				Last Name	First Name			
Davison	James K. Polk		1845	H 2 2	Deaderick	Mary Lanier	1879	1883	B 2 13
Davison	William Jefferson		1845	H 2 1	Deaderick	May	1873	1874	B 3 5
Deaderick	Adelaide Eliza (Jackson)	1796	1817	J 1 5	Deaderick	Rebecca L. Williams	1812	1857	B 7 8
Deaderick	Adeline McDowell	1814	1904	E 2 11	Deaderick	Rosa	1880	1883	B 2 12
Deaderick	Adelyn McDowell	1881	1967	E 2 7	Deaderick	Susan L.	1838	1923	B 7 3
Deaderick	Alfred S.	1845	1907	E 2 9	Deaderick	W.V.	1826	1883	B 1 2
Deaderick	Carter Luster	1852	1932	E 2 8	Deaderick?	Little Louis	1841	1843	B 5 1
Deaderick	Catherine R.		1895	B 4 5	Deaderick?	Little Margaret	1832	1833	B 7 6
Deaderick	D.L.			B 1 3	Deaderick?	M.A.D.			B 7 7
Deaderick	R.W.				Deaderick?	S.A.			B 6 2
Deaderick	Lula W.				Dillworth	James A.	1797	1822	D 9 2
Deaderick	Annie G.				Dillworth	Mary Charlotte	1802		D 9 3
Deaderick	Fannie R.				Dosser	Caroline	1826	1853	B 8 2
Deaderick	May E.				Dosser	James H.	1823	1891	B 9 2
Deaderick	Joseph W.				Dosser	Fannie A.	1830	1896	
Deaderick	Mary L. / Rosa				Dosser	Jas. Horace Fannie	1867 1874	1869 1875	B 11 6
Deaderick	David	1835	1906	E 2 2	Dosser	Juliette	1888	1890	B 11 5
Deaderick	David	1754	1823	B 7 5	Dosser	Laura B. Brunner infant son	1868	1908	F 2 5
Deaderick	David			B 4 8	Dosser	Lilian M.	1874	1953	D 4 3
Deaderick	Eliza R.	1845	1897	B 4 4	Dosser	Mary Wilds	1851	1896	D 4 2
Deaderick	Eva Clarkson	1855	1920	E 2 3	Dosser	Nellie Fain	1860	1901	F 2 3
Deaderick	Eva Sackson	1836	1874	B 1 1	Dosser	Robert N.	1856	1927	F 2 4
Deaderick	Fannie Rebecca	1872	1876	B 3 4	Dosser	Virginia Carter	1859	1860	D 3 2
Deaderick	Ina Elsie	1878	1905	E 2 1	Dosser	Virginia E. Squibb	1855	1875	D 5 2
Deaderick	J. Franklin	1806	1884	B 7 9	Dosser	William	1849	1883	D 4 1
Deaderick	J.W.	1812	1890	E 2 10	Dosser	infant		1890	F 2 6
Deaderick	James William	1882	1885	E 3 5	Dosser?	F.A.D.			B 8 4
Deaderick	Joseph A.	1804	1835	B 4 6					
Deaderick	Joseph Williams	1875	1876	B 3 3					
Deaderick	Joseph Williams	1833	1861	B 7 4					
Deaderick	Margaret Anderson	1775	1857	B 4 7					

Old Jonesborough Cemetery

Name(s) on Marker		Born	Died	Location Sec. Row No.
Last Name	First Name			
Dosser?	J.H.			B 8 3
Duncan	Rhea C.	1883	1884	B 10 4
Duncan	Sophie Cunningham	1848	1884	B 10 3
Elam?	Florence L. Bowers	1854	1875	G 4 2
Emmerson	Catharine	1789	1858	K 6 4
Emmerson	Eliza C.	1816	1844	K 4 1
Emmerson?	?			K 6 1
Emmerson?	?			K 6 2
Emmerson?	?			K 6 6
Emmerson?	?			K 6 6
Fain	James Rhea	1863	1927	L 4 1
Fain	John H.	1825	1873	L 6 2
Fain	Fanny A. Rhea	1834	1903	
Fain	Lillian Mary	1880	1966	L 4 2
Fain	infant daughter	1866	1866	L 3 1
Fain	see L-6-2			L 4 3
Fain	see L-6-2			L 4 4
French	Anna Maria	1876	1878	A 1 1
Fuller	Frederick Jackson	1875	1959	J 3 6
Fuller	Sammie Ward	1879	1969	J 3 7
Gibson	Harriet E.	1831	1852	B 8 1
Gibson	Jeremiah	1786	1868	B 11 4
Gibson	Phoebe	1782	1864	
Gibson	Dr. David J.	1884	1822	
Gibson	Sarah A.	1832	1919	
Gifford	Francis	1818	1855	D 1 1
Goff	L.B.	1875	1898	F 2 2
Greer	Allison			D 1 3
Grisham	Evalina	1881	1882	C 6 1

4

Name(s) on Marker		Born	Died	Location Sec. Row No.
Last Name	First Name			
H.	A.M. (initials only)			B 2 10
Hafkemeyer	Bertha	1884	1935	F 1 1
Hall	Ellen C.	1826	1888	F 6 3
Hashbarger	Amanda Virginia	1847	1849	G 2 2
Haworth	David Riley	1872	1942	H 8 2
Haworth	Jess Vernon Patton	1878	1956	
Patton	Landon Hale	1924	1847	
Patton	Delcenia Ann Brunner	1859	1930	
Holmes	Achsah Evelyn		1942	E 3 4
Hoss	Carrie L.	1859	1927	C 6 4
Hoss	Henry	1818	1885	A 1 3
Hoss	Henry Sevier	1857	1861	A 1 5
Hoss	Infant son		1850	C 5 4
Hoss	L.C.	1817	1891	C 5 2
Hoss	L.P.	1825	1893	C 5 3
Hoss	Minerva E.	1859	1863	A 1 4
Hoss	Mrs. Anna M.	1825	1891	A 1 2
Hoss	Rowena P.	1864	1918	C 7 1
Huff	Chas. A.O.	1830	1912	F 3 2
Huff	Mrs. Mary E.	1832	1901	
Hunt	Warrington C.	1809	1826	A 3 7
Hunter	Fannie R.	1841	1888	A 4 3
Hunter	Laura J.	1863	1881	A 4 2
Irvin	Montgomery	1802	1857	H 6 1
Irvin	Mrs. Frances R.	1807	1854	H 6 2
Irvin	Samuel	1800	1801	K 7 1
Jackson				J 2 1
Jackson	Capt. Alfred E.	1843	1862	J 3 3
Jackson	Cordelia Maria	1857	1858	J 1 4

Old Jonesborough Cemetery

Name(s) on Marker		Born	Died	Location Sec. Row No.
Last Name	First Name			
Jackson	Gen. A.E.	1817	1889	J 3 1
Jackson	Henry C.	1847	1914	J 3 5
Jackson	Maj. Nathaniel T.	1830	1862	J 3 4
Jackson	Seraphina C.	1808	1880	J 3 2
Jackson	Seraphina Cordelia	1845	1858	J 4 1
Johnson	Elizabeth C.	1790	1861	G 2 3
Johnson	Mary Etter	1856	1857	D 7 1
Kennedy	Judge John	1766	1856	G 4 8
Kennedy	Katherine Greer	1760	1840	
Kennedy	Thomas R.	1805	1847	G 4 9
Kennedy	Harriet E.	1809	1872	
Kennedy	William E.	1838	1835	
Kennedy	Mary D.	1837	1843	
Kennedy	Charles A.	1846	1889	
Gresham	Laura B.	1876	1882	
Kenney	Minerva Crainer		1861	G 2 1
Kitzmiller	Richard Carr	1831	1920	E 2 12
Kitzmiller	Eleanor Bachman	1844	1921	
Laird	Daisy Panhorst	1880	1970	M 1 2
Lampson	John L.	1824	1877	L 5 1
Lampson	Martha E.	1827	1882	
Lampson	John Lynn	1858	1900	L 4 5
Lampson	L. (see L-6-4)			L 7 2
Lampson	N.R. (see L-6-4)			L 7 3
Lampson	Nannie Rhea	1867	1873	L 6 4
Lampson	infant		1869	
Lampson	Lucy L.	1866	1862	
Lampson	infant (see L-6-4)			L 7 1
Lloyd	Elizabeth	1781	1808	M 3 9
Locke	Armin V.?	1879	1885	H 7 4
Lucky	?			L 2 2
Lucky	Mrs. Mary	1817	1903	L 1 1
Lucky	Sarah	1806	1862	L 1 3
Lucky	Seth J.W.	1799	1869	L 1 2

5

Name(s) on Marker		Born	Died	Location Sec. Row No.
Last Name	First Name			
Lucy	John Tho. Ballentine	1909	1974	L 6 1
Lucy	Marjorie Luikart Fai	1905	1994	
Mahoney	Dr. M.S.	1832	1883	B 4 1
Mahoney	Margaret	1832	1920	
Marcoux	Amos J.	1865	1944	F 4 3
Martin	India Birch	1852	1853	K 2 1
Mason	Archibald G.	1813	1895	H 4 1
Mason	Lucinda Ryland	1820	1854	
Mason	Angelina	1909	1829	
Mason	Martha Ellen	1844	1853	
Mason	Marietta	1848	1866	
Mason	Anna B.	1846	1873	
Mason	Lucinda	1854	1874	
Mason	Lena D.	1861	1915	
Mason	Infant			H 4 1
Meyer	Phillip J.	1807	1872	
Mason	James			C 2 1
Mason	Sue Tyler	1843	1875	H 8 1
Mathes	Annis A. Borell	1846	1888	M 7 2
Mathes	Florence	1871	1873	M 6 4
Mathes	Geo. Edgar	1877	1877	M 2 3
Mathes	J.S.	1876	1876	M 4 1
Mathes	A.A.	1876	1876	
Mathes	Little Johnnie Borell	1874	1874	M 6 3
Mathes	W.E.	1836	1890	M 9 1
Maxwell	Hanna	1745	1811	C 5 1
McCall	Anna H.	1863	1962	E 1 8
McCall	Robert M.	1890	1948	E 1 6
McCall	William Printup	1893	1978	E 1 9
McCall	Wm. P.	1863	1901	E 1 7
McClure	Frances Ewing	1858	1860	M 3 3
McClure	John F.	1884	1895	F 4 6
McClure	June Letitia	1839	1869	M 3 1
McClure	Sara G.	1865	1901	F 4 5
McClure	Willie Graham	1860	1861	M 3 2

Old Jonesborough Cemetery

Name(s) on Marker		Born	Died	Location	
Last Name	First Name			Sec. Row No.	
McLin	C.J.	1825	1855	I 1 4	
McLin	Little Katie	1881	1881	I 1 3	
Metzger	Carrie C. Smith	1890	1949	F 1 6	
Metzger	Paul T.	1891	1962	F 1 5	
Munsley	William, D.D.	1833	1877	I 6 1	
Munsley	Virginia A. Blair	1839	1915		
Murphy	Eliza C.	1831	1914	J 1 1	
Murphy	Eugenia	1851	1900	J 1 2	
Murphy	Wm. Alfred	1851	1895	J 1 3	
N.	D. (initials only)			L 2 6	
Naff	Catharine	1848	1852	J 6 1	
Naff	George Eakin	1849	1899	J 6 2	
Nelson	A.E.N.	1816	1850	L 1 5	
Nelson	Ann E. (see family)			L 2 8	
Nelson	David	1780	1850	L 1 4	
Nelson	Mrs. Ann E.	1816	1830	L 2 7	
Nelson	Alexander W.	1841	1874		
Nelson	David M.	1881	1845		
Nelson	Helen	1849	1897		
Osborne	O.H.	1855	1879	H 1 1	
Outlaw	Mrs. Margaret E.H.	1818	1851	A 3 5	
Outlaw	W.m David	1844	1847		
Outlaw	Frances	1846			
Outlaw	twin infants				
Panhorst	Dr. Mari Hendrik Philip	1847	1932	M 1 3	
Panhorst	Katherine Simpson	1849	1946	M 1 4	
Patterson	J.W.	1854	1895	B 2 11	
Patton	Mrs. Lula Smith	1873	1928	F 1 4	
Peoples	Landon C.	1850	1887	C 1 1	
Peoples	Nathan B.	1862	1888	C 1 2	
Perkins	Ella Simpson	1855	1927	M 1 5	

Name(s) on Marker		Born	Died	Location	
Last Name	First Name			Sec. Row No.	
Pierce	Anna Dosser	1859	1946	F 6 1	
Pierce	James A.	1860	1896	F 6 2	
Piper	Nellie S.	1884	1886	M 1 7	
Powell	Harriet E. Blackmore	1827	1890	F 6 7	
Powell	William	1818	1902	F 6 8	
Prichett	James L.		1885	D 1 2	
Pullion	Allie May	1891	1892	M 7 1	
R.	C.E. (initials only)			G 4 3	
Reeves	Anna Claire	1881	1976	F 3 1	
Reeves	Mary Lois	1886	1911		
Reeves	Isaac Edward	1899	1842		
Reeves	Mary Dosser	1849	1931		
Reeves	Blannie I.	1847	1928	E 1 5	
Reeves	Julia	1833	1878	G 1 2	
Reeves	Mary Murphy	1857	1905	E 1 3	
Reeves	Mary Rosabelle	1854	1941	E 1 1	
Reeves	William Rollin	1850	1930	E 1 2	
Reeves	Wm. P.	1807	1885	G 1 1	
Reeves?	Mary DeVault	1808	1894		
Rhea	John	1810	1862	H 6 3	
Rhea	Margaret Carr	1893	1893	I 2 1	
Rhea	William R.	1840	1903	I 1 7	
Riddick	Edward E.	1880	1906	M 1 6	
Rinehart	Eliza J.	1822	1889	F 6 5	
Rogan	Carrie Lanier		1921	B 4 3	
Rogan	Edward	1845	1910	B 3 2	
Rogan	Isadore	1847	1883		
Rogan	Sue Deaderick		1931	B 4 2	
Rogan	Susan T.	1838	1920	E 3 1	
Russell	Caroline E.	1818	1898	G 3 2	

Old Jonesborough Cemetery

Name(s) on Marker		Born	Died	Location	
Last Name	First Name			Sec. Row No.	
Russell	Charles E.	1856	1916	G 4 6	
Russell	James G.	1852		G 3 3	
Russell	Lauretta	1840	1910	G 4 5	
Russell	Lizzie	1836	1911	G 4 1	
Russell	Mary V.	1845	1933	G 3 1	
Russell	Romeo J.	1875	1912	G 4 7	
Russell	William A.	1838	1920	G 3 5	
Ryland	John	1795	1857	H 4 2	
Ryland	Rebecca Livens	1797	1866		
Johnson	Elizabeth R.	1864	1830		
Ryland	Matilda J.		1870		
Anderson	Eliza Ryland	1835	1869		
Ryland	Fanny				
Ryland	Anna				
Sehrwald	Apphia Allison	1854	1935	D 2 3	
Sensabaugh	L.P.	1836	1869	H 5 1	
Sensabaugh	Mary Leon	1868	1902	G 1 3	
Sensabaugh	Sue. D. Reeves	1835	1918	E 1 4	
Sevier	Dr. W.R.	1822	1886	A 1 7	
Sevier	James	1814	1888	C 4 1	
Sevier	Eva M.	1829	1890		
Sevier	Lucy Evans	1840	1903	A 1 6	
Sevier	Martha Ellen	1825	1862	A 1 8	
Sevier	Samuel Dayton	1846	1862	A 1 9	
Sherfy	Jessee J.		1818	H 9 1	
Shiple	Carrie	1856	1882	B 7 1	
Shiple	James Edward	1852	1872	D 9 1	
Simpson	Caroline S.	1817	1892	M 1 8	
Simpson	James			I 8 2	
Simpson	John W.	1800	1887	M 1 9	
Simpson	Mary C.	1813	1860	M 1 10	

Name(s) on Marker		Born	Died	Location	
Last Name	First Name			Sec. Row No.	
Slemons	Alice Graham	1850	1939	H 8 7	
Slemons	Lillie	1883	1884	C 6 3	
Slemons	Lucile			C 6 2	
Slemons	Maria Dosser	1825	1912	H 8 6	
Slemons	R.M.	1864	1911	H 8 4	
Slemons	William G.	1815	1887	H 8 5	
Smith	Caroline Rebecca Wild	1853	1937	F 1 2	
Smith	George L.	1851	1920	F 1 3	
Smith	Richard M.	1818	1857	G 3 4	
Smith	Tommie Lee	1894	1895	F 6 6	
Sparks				K 5 1	
Sparks	Augustus R. (M.D.)	1820	1870	M 2 5	
Sparks	Gus L.	1875	1903	M 2 4	
Sparks	Horace H.	1859	1859	J 8 1	
Sparks	Mary Broyles	1844	1922	H 7 2	
Sparks	William A.	1849	1877	H 7 3	
Squibb	Mary E.	1861	1877	D 3 4	
Stuart	Samuel Decatur	1866	1893	L 2 1	
Stuart	Mary Fain	1868	1894		
Stuart	Samuel D.	1894	1893		
Tadlock?	Little Bettie	1861		I 1 5	
Taylor	Walter	1861	1865	D 3 1	
Thomas	Angeline S. Burson	1822	1885	M 6 2	
Thomas	Joel B.	1825	1890	M 6 1	
Trusler	Robert F.	1888	1965	F 2 1	
Trusler	Laura Barner	1862	1946		
Andrew	Trusler	1939	1861		
Trusler	Ada Maie	1885	1905		
Unknown					
Unknown				A 1 11	



Old Jonesborough Cemetery

Name(s) on Marker		Born	Died	Location	
Last Name	First Name			Sec.	Row No.
Unknown				A 2	1
Unknown				A 2	2
Unknown				A 2	3
Unknown				A 2	4
Unknown				D 3	3
Unknown				K 8	2
Unknown				L 6	3
Unknown				M 5	1
Unknown				B 3	1
Unknown		1870		D 6	1
Unknown				A 3	4
Unknown				G 1	5
Unknown				G 4	4
Unknown				H 10	1
Unknown				I 4	2
Unknown				I 5	3
Unknown				I 6	2
Unknown				I 6	5
Unknown	?			K 7	2
Ward	infant daughter		1917	F 3	3
Watson	?			G 1	4
Watson	Jessey Hamett		1883	G 3	6
Wells	(infant daughter)	1851	1851	D 8	1
Wells	(twin sons)	1856	1856	D 8	2
Wells	Sarah Ann	1847	1853	D 8	3
Wells	Thomas Belden	1846	1846	D 8	4

Name(s) on Marker		Born	Died	Location	
Last Name	First Name			Sec.	Row No.
West	Leah M.	1813	1835	K 8	1
White	Mary Blair	1851	1852	I 6	4
Whitlock	John Wesley	1847	1886	A 3	3
Wild	John A.	1801	1883	C 9	2
Willet	George W.	1808	1856	I 7	1
Willet	Eliza M.	1815	1886		
Willet	William F.	1848	1835		
Willet	Zed T.	1838	1862		
Willet	Sam A.	1844	1863		
Frost	Mary A.	1838	1899		
Willet	William F.	1835	1848	I 8	1
Williams	Joseph	1810	1898	E 3	2
Williams	Lina	1847	1873	B 1	4
Williams	Sarah L.	1814	1888	E 3	3

## African-American Section

The African-American section of the cemetery was roughly divided into sections N through T for cataloging. However, these sections are not as clearly defined as the main cemetery and contained numerous unmarked graves. Section N began at the bottom of the hill and continued upward through Section T. No attempt was made to include a drawing of these sections.

<u>Sec.</u>	<u>Row</u>	<u>No.</u>	<u>Name</u>		<u>Born</u>	<u>Died</u>	<u>Age</u>		
R	1	6							
R	2	4	?	William	1889	1952	63		
			?	Vertie	1888	1924	36		
P	4	1	Allison	Bertha E.	6/28	1884	12/31	1968	84
Q	3	5	Bailey	Jacob	1/31	1841	11/12	1895	54
P	3	3	Barnes	Rev. G. P.	1/14	1864	12/20	1934	70
Q	4	3	Bayless	Comodore	3/27	1849	5/18	1891	42
			Bayless	Amanda	12/28	1850	11/28	1936	85
Q	4	4	Bayless	J. Harrison		1889		1929	40
			Bayless	Mary E.		1888		1922	34
Q	4	5	Bayless	Julia	2/26	1885	9/16	1939	54
P	5	3	Birdwell						
P	5	4	Birdwell				12/29	1899	
Q	3	6	Blair	Sarah	11/30	1851	1/11	1913	61
N	3	1	Bridewill	Clarence W.		1921		1972	51

<u>Sec.</u>	<u>Row</u>	<u>No.</u>	<u>Name</u>		<u>Born</u>	<u>Died</u>	<u>Age</u>		
P	2	2	Bridwell	Fances J.	3/25	1884	3/27	1918	34
N	4	2	Bridwell	John Henry, Jr.		1935		1942	
N	1	1	Bridwell	James S.	2/25	1882	2/23	1961	79
N	4	3	Bridwell	Opie Blair	6/7	1891	6/20	1980	89
P	2	3	Bridwell	Mary F.	2/18	1908	2/6	1992	83
N	1	5	Brown	Melissa	?		?		?
N	1	5	Brown	Cornelius	?		?		?
Q	1	3	<u>Brown</u>	<u>Alfred &amp; Cordie</u>	<u>no dates</u>				
Q	1	6	Brown	Julia	?		?		
Q	1	4	Brown	Pearle E.	8/8	1904	8/5	1919	14
Q	1	5	Brown	William	7/30	1919	1/17	1922	2
Q	1	2	<u>Brown</u>	<u>Alfred</u>	<u>12/25</u>	<u>1858</u>	<u>4/22</u>	<u>1925</u>	<u>66</u>
N	1	4	Brown	Luella	11/19	1890	2/17	1940	49



<u>Sec.</u>	<u>Row</u>	<u>No.</u>	<u>Name</u>		<u>Born</u>	<u>Died</u>	<u>Age</u>		
Q	4	6	Brown	Ethel	11/8	1908	5/16	1971	62
			Brown	Lizzie	11/16	1882	1/2	1971	88
O	1	5	Brown	L.D., Sr.		1906		1987	81
			Brown	Lucile Birdwell		1910		1955	44
			Brown	L.D., Jr.		1934		1935	1
R	2	9	Burdell	Landon		1878	5/18	1891	12
P	5	5	Cannon	Louise	3/17	1922	12/15	1922	9
Q	2	2	Cecil	Julia Ann	about	1834	2/13	1894	
Q	2	3	Cecil	William	9/4	1868	8/9	1927	
Q	2	4	Cecil	Nancy Grimes	9/11	1872	3/19	1948	
P	5	11	Crawford	Etta	11/7	1891	1/22	1918	26
P	5	10	Crawford	Charles C., Jr.	2/24	1905	9/27	1919	14
P	4	8	D.Y.	initials only					
N	4	4	Dean	Agnes	12/25	1883	6/11	1959	75
			Dean	Arthur	4/14	1855	2/14	1934	77
R	1	2	Edwards	Jerry		no dates			

Sec.	Row	No.	Name	Born	Died	Age
S	1	10	Evans Kenneth	11/26 1939	1/28 1995	55
S	1	11	/Fitzgerald Genry James	9/5 1911	10/10 1994	83
P	5	9	Ford Johanna	1880	12/23 1899	79
P	4	9	Ford Spencer C.	3/4 1883	12/24 1906	23
P	5	8	Ford Lugina	12/25 1853	3/5 1906	52
P	5	6	Freeze Ella Ford	12/25 1880	4/13 1944	63
P	5	7	Freeze Edna	12/25 1910	6/30 1995	85
O	1	3	Gay Samuel M.	1883	1950	67
			Gay Augusta W.	1895	1941	46
O	1	2	Gay George Hurdle	1914	1979	65
Q	2	5	Gott Anthony	1844	1918	74
			Gott Jane	1851	1901	50
R	2	8	Greenlee Nellie	1881	1897	16
N	2	1	Greenlee William Arie	1916	1971	55
S	1	2	Greenlee Roaer M.	1910	1988	

Sec.	Row	No.	Name	Born	Died	Age
P	1	1	Grigg Fannie S	1/26 1885	6/11 1932	47
Q	1	9	Grimes Sarah Ann	8/3 1839	8/9 1893	54
Q	1	11	Grimes Allen	1824	4/1 1902	78
Q	1	10	Grimes James	about 1836	11/10 1913	77
Q			Grimes Harriet	about 1836	10/21 1916	80
Q	1	8	Grimes Eugenia S.	10/10 1876	5/26 1955	78
R	1	1	H., L. (initials only)			
Q	1	7	Hammer Charlie H.	7/8 1909	2/19 1911	1
S	1	4	Horton Orville M., Sr.	1906	1977	71
S	1	5	Horton Arthur C.	1909	1977	68
O	1	6	Howard Rev. Thomas	1880	11/28 1928	48
			Howard Hattie Helen	5/18 1885	12/5 1973	88
S	1	9	Howard Mary Bunis	1971	1994	23
N	1	3	Hughes Bessie K.	1904	1936	32

Sec.	Row	No.	Name	Born	Died	Age
Q	2	8	Hunt Samuel	1832	1886	54
R	1	3	Irvin Alfred			
R	1	4	Irvin (family marker)			
R	1	5	Irvin Mary	7/6 1861	2/20 1914	52
R	2	6	Jackson Lucinda	9/26 1843	6/27 1898	54
N	4	5	Johnson Robert M.	9/14 1915	12/12 1954	39
P	4	2	Johnson Lena W. Johnson Monroe A.	5/26 1886 1888	12/27 1955 ?	69 ?
S	1	6	Jones Margaret E.	8/21 1924	11/29 1979	55
N	1	2	Keebler Margaret	1897	1936	39
P	2	4	Lee Katie	1881	1957	
Q	4	2	Marshall Winfield	no dates		
P	4	7	Marshall Charles D.	4/4 1880	2/26 1930	49
N	3	2	Marshall Andrew J.	9/29 1882	1931	47



Sec.	Row	No.	Name	Born	Died	Age
Q	1	1	Martin Rev. W.P.	18	1925	?
Q	2	6	Miller Jerry	3/16 1842	9/10 1913	71
Q	2	7	Miller Cornelius	1883	1941	58
O	4	1	Pearson Sandy W.	?	?	
P	4	4	Perry Dock	12/16 188	4/6 1917	
Q	1	14	Ray (infant)	7/25 1903	7/27 1903	2
Q	1	12	Ray Liet. A.M.	1867	1917	50
R	1	8	Rhea William Alfred	12/6 1896	1/12 1898	2
R	1	7	Rhea John	5 1887	7/18 1928	41
S	1	7	Rhea Mildred	1908	1993	85
S	1	8	Rhea C. Douglas	1915	1994	79
Q	1	13	Russell Wincy Price Maude	no dates no dates		
P	4	6	Russell Carrie Perry	4/12 1886	2/22 1984	97

Sec.	Row	No.	Name		Born	Died	Age		
S	1	3	Rutledge	James Paul	6/2	1910	1/14	1991	80
			Rutledge	Kathleen Gay	1/14	1912	3/10	1989	
S	1	1	Rutledge	Donald A.		1936		1995	59
P	2	1	Ryans	Charles W.	2/14	1875	9/7	1954	79
			Pearson	Mamie V.	8/16	1898	4/3	1971	72
Q	3	2	S., G.M.	(initials only)					
Q	1	16	Sliger	Rebecca	about	1815	7/9	1890	75
R	2	5	Smith	Eliza		1858		1916	58
O	2	2	Snow	Brewer		1861		1905	44
			Johnson	Mary E.		1856		1943	
N	4	1	Stephen	Rect.?	?			1930	?
Q	3	4	Stephenz	David			1/17	1918	
Q	3	3	Stevenz	Ed	?		11/11	1938	
Q	3	1	Stuart	Andy		1811		1894	83
Q	2	1	Stuart	Georgia May	5/3	1883	5/11	1906	23

Sec.	Row	No.	Name		Born	Died	Age		
R	2	7	Stuart	Edward		1852		1914	62
			Stuart	Lettie		1862			
R	2	1	Taylor	John M.	2/18	1845	9/27	1909	64
			Taylor	Martha A.	3/17	1850	12/6	1911	61
O	1	1	Unknown						
O	1	4	Unknown						
O	2	1	Unknown						
O	3	1	Unknown						
O	3	2	Unknown						
P	3	1	Unknown						
P	3	2	Unknown						
P	4	5	Unknown						
P	5	1	Unknown						
P	5	2	Unknown						
Q	1	15	unknown						

Sec.	Row	No.	Name	Born	Died	Age		
Q	4	1	unknown					
Q	4	8	unknown					
R	2	2	unknown					
R	2	3	unknown					
P	4	3	Vaught Vaught	Henry C. Martha V.	3/23 6/24	1894 1884	11/28 1963	77
Q	2	9	Walker Walker	Lewis M. Mary E.	1868 1852	19 1933	0 81	
Q	4	7	William	Howell Yancey	2/15	1867	1/5 1927	59
P	3	4	Young Bayles	Deana Maary	1835 1849	1896 1913	60 64	

