

N

old road  
back to  
the road

Back to  
Lynn & August

60 acres

N

E

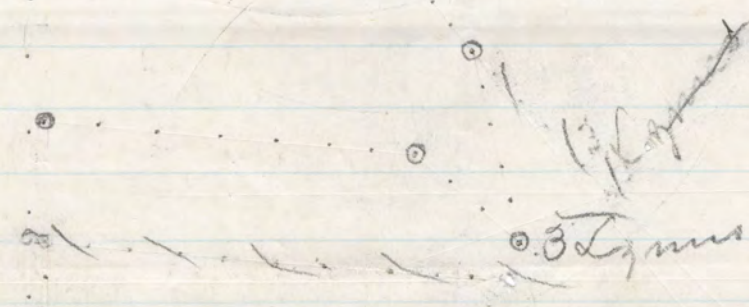

Henry's road

elm

Beginning at an Elm (Morgan's line) then  
 N 28 E 292 poles to Stake (at old road over  
 a meadow corner) then S 62 E 69 to Buckeye Elm  
 Lynn & August (near Fall Creek) then  
 S 30 E 216 to Stake in Branch then S 44 W  
 then S 32 E 28 then S 57 E 41 poles to  
 3 Lynns (in little meadow) then N 45  
 W 28 to Stake then N 82 W 96 poles  
 to Henry's line containing 60 acres  
 & 18 poles Exclusion of the road -  
 Surveyed 24th Jan 1881

G. M. Murrell

S

George Vincent surveyed for Thomas  
Fitzworth Oct 13<sup>th</sup> 1780 Beginning John Mullens  
corner by a oak on a branch. Then on a dividing line  
between said Fitzworth and said Mullens. N. 6  
West 130 P. crossing the creek twice to a pine  
then on a dividing line between said Fitzworth  
and said Mullens. South 49 West 19 P. to  
white oak thence on Isaac Fitzworth's line  
thence on said line south 17 east 68 P.  
to said Fitzworth's corner white oak thence the  
same course 68 P. to a hickory thence on said  
dividing line south 49 East 32 P. to a road  
Oak thence East 18 P. to a white oak  
thence North 100 P. to a Poplar thence on  
a dividing line between said Thomas and said Isaac  
East 69 P. to a <sup>thence said Isaac</sup> ~~branch~~ <sup>which is a dividing line between</sup>  
said Thomas & John Mullens

Oct 10<sup>th</sup> 1780 George Vincent surveyed for  
John Mullens Beginning at an old corner  
Beach tree on a hill side thence on a dividing  
line between said Mullens & Thomas Fitzworth  
North 69 W. 30 to a sugar tree thence  
on a dividing line between said Mullens and  
Thomas Fitzworth south 25 W. 46 P. crossing the  
creek & a fall to a dogwood & sawwood on a  
hill side thence on a dividing line between  
said Mullens and said Fitzworth south 65 E  
270 P. to a lymas tree on the side of fall Branch  
thence to the Beginning

Courses of the Old Mullens deed to

Beginning on the South side of Walkerfork  
South 25° to a dogwood & sowerwood then  
on a line between the 3<sup>d</sup> Mullins & Thomas  
Settsworth South 65° East 270 poles crossing horse  
break & lin tree of fall branch then North  
7° East 130 poles to an old corner Beach tree on  
Chill side then on a dividing line between  
the 3<sup>d</sup> Mullins & Thos Settsworth North 65°  
West to Walkerfork then up Walkerfork  
Creek to the Beginning - 175 Acres

H. Sturam

Book 2 Page 158

Courses of Thomas  
Settsworth 400 acres  
Grant of J. Mullens as  
found in the field  
notes of George Yinson



Aceres  
44.84

72.245 Aceres

W

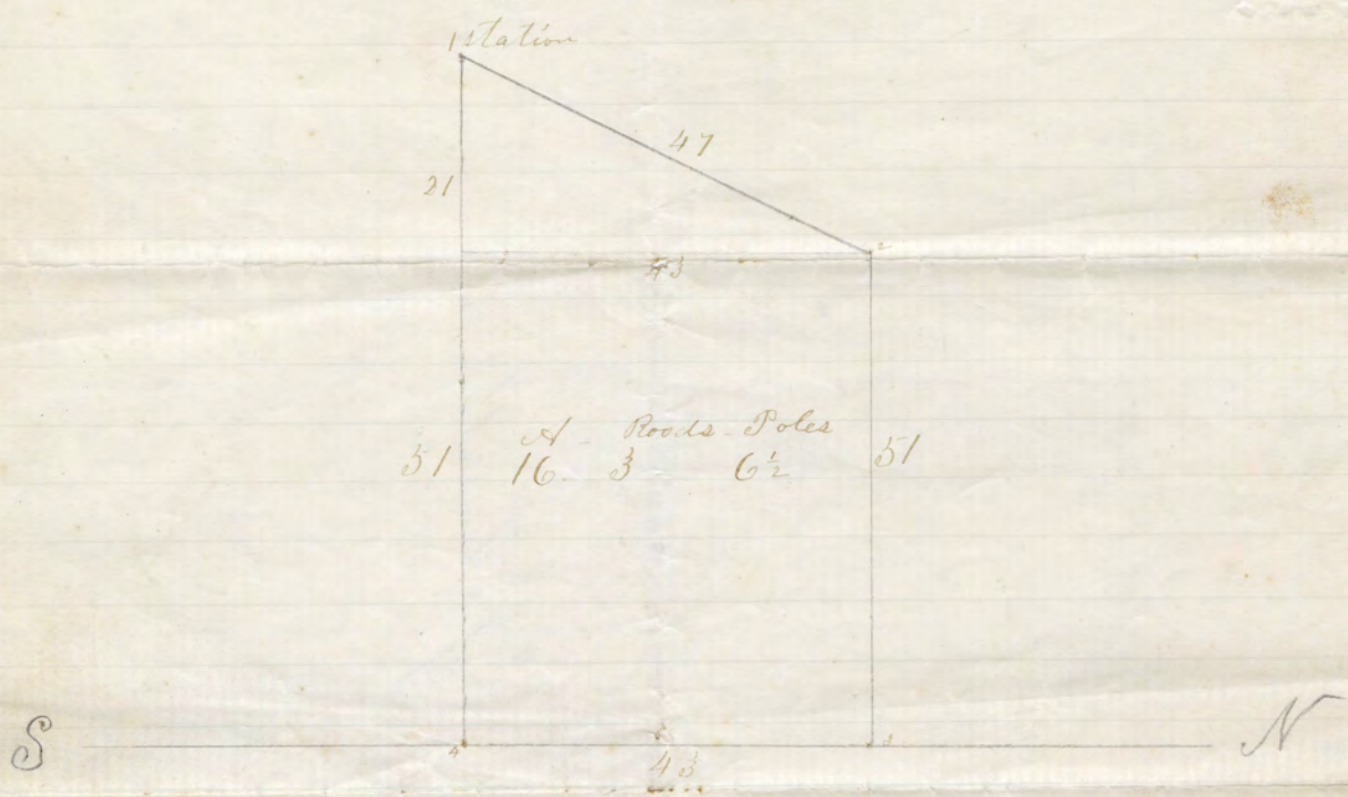

E

I ~~have~~ made a mistake in calculating the above,  
 the true area is  $16A - 3B - 3\frac{1}{2}P$

I D Smith

We got the north & south line p Rod too long;  
 you recollect, we commenced <sup>measuring</sup> a little below the bush, selected,  
 at the 3<sup>d</sup> station, as the corner, we should have commenced  
 about 3 ft above, which is the true place for the 3<sup>d</sup> corner,  
 you see the north & south line at the east end must equal the  
 line from station 2 across to the ~~the~~ long line,



$43$   
 $\frac{450}{0.21\frac{1}{2}}$   
 $4.0 \overline{) 45.1\frac{1}{2}}$   
 $44 \quad 11 - 11\frac{1}{2}$   
 $2 - 3 - 11\frac{1}{2}$

$5-1$   
 $48$   
 $15-3$   
 $304$   
 $4.0 \overline{) 219.3}$   
 $4154 - 33$   
 $13 - 2 - 33$   
 $2 - 3 - 11\frac{1}{2}$   
 $16 - 2 - 8\frac{1}{2}$



This Plat. is the form of a Tract of Land  
 Survey'd for Frederick Titsworth agreeable  
 to the last will and Testament of Thomas  
 Titsworth Deceased Beginning at a white  
 oak corner of the original Tract of 400 acres  
 granted to said Thomas Titsworth thence  
 with the lines thereof North sixty eight  
 poles to a Stake and black walnut thence  
 East Eighty two poles crossing a branch  
 to a Buckeye thence down said branch

North Sixteen Degrees West one hundred and ninety  
 five poles to a Spruce the Beginning corner of the original  
 Grant, then with the first line thereof North sixty five  
 Degrees West fifty four poles to a white oak Spanish  
 oak & Iron wood among some rocks thence with a  
 dividing line thro' the Tract South thirty Degrees  
 west twenty four poles to a white oak thence with  
 said line South one Degree and thirty minutes East  
 two hundred and fifty eight poles to a Elm and  
 sugar Sapling thence East thirty six poles to the  
 Beginning containing one hundred and twenty  
 five acres,

Survey'd May the 1<sup>st</sup> 1813

By Nathane Shipleigh D<sup>y</sup> of the 6 Dist

Fred. Tilsworth,

Platt

25 acw.

*[Decorative flourish]*

130  
65  
65



Courses of Gabriel Morgan's grant on  
Leiches Branch

Beginning at a white oak on Goads line  
 thence North twenty <sup>there is a mistake for it is 100 and 1/2 poles</sup> degrees East thirty four poles  
 to two white oaks on Wm Pickins line thence North  
 forty poles to a white oak thence south <sup>60 west</sup> one hundred  
 and twenty two poles to a hickory and post oak  
 thence south twenty eight poles to a small black oak  
 thence west one hundred and fifty six poles to a  
 white oak thence south eighty poles to two white  
 oaks thence East one hundred and thirty six poles  
 to a black oak Goads corner thence North fifty  
 five poles to a walnut and post oak thence East  
 forty four poles to a stake thence south forty  
 four poles to a stake On Goads old line thence  
 with the same East to the beginning  
 Surveyed 29<sup>th</sup> day of July 1824

Grant obtained 29<sup>th</sup> October 1824

119:24     57.3  
 24  
 144.6  
 28.6  
 14.3  
 119) 158.5 ( 1.3  
 119  
 39.5  
 28.7

Courses of Gabriel  
Morgan Grant  
or - Lynch's Bran  
ch

104  
40



State of Tennessee Sullivan County  
 I have surveyed for Richard Murrell  
 seventy six acres of land in said County  
 on Walkers farm of horse creek by

Virtue of Entry No 696 Beginning date the 20<sup>th</sup>  
 day of November 1832 Beginning at a white oak  
 on David Braggs line thence south with William  
 Pichens line sixty poles to two white oaks Morgans  
 corner thence with his line south sixty Degrees west  
 one hundred and twenty poles to a hickory and  
 Post oak thence with Pearces line North one hund  
 - red and forty poles to two white oaks thence with  
 David Braggs line East one hundred poles to a stake  
 thence a straight line to the Beginning surveyed  
 this 10<sup>th</sup> day of December 1832

R. H. Murrell } C  
 T. J. Murrell } C  
 Abraham Gregg  
 D. S. S. C.

Recorded in Book A, page 118

Lab D Rhea S.S. Co



Return of Survey  
Richard Murrell  
76 acres



I have surveyed Two hundred & fifty eight  
 acres of Land for S. J. Murrell on the South  
 side of Holston River on Horse Creek  
 Beginning at a Black Oak of Sourwood on a  
 Cliff thence with Morgans line  $S 25^{\circ} W 28$  poles to  
 a fallen Sugar tree of Planted rocks on the bank  
 of Horse Creek thence with his line  $S 45^{\circ} W 43 \frac{1}{2}$  po  
 les to a Planted rock thence with his line  $S 22^{\circ} W$   
 $14$  poles to a Planted <sup>rock</sup> thence with a conditional line made this day between  
 G. Morgan & said Murrell  $S 67^{\circ} W 35$  poles to a White Oak of Gum thence with  
 the same  $S 44 \frac{1}{2} W 14 \frac{1}{2}$  poles to a White Oak thence with the same  $S 76 \frac{1}{2} W 22$   
 poles to a White Oak thence with the same  $S 79^{\circ} W 22$  poles to a Spanish Oak of Dogwood at  
 a road thence with his line  $S 69^{\circ} E 9$  poles to a White Oak, <sup>to a White Oak of Point distance of G. Morgans line  $S 30^{\circ} E$</sup>   
 thence  $S 51^{\circ} E 110$  poles to a Planted rock in a field thence with Lewis, Hales  
 line  $S 42^{\circ} E 84$  poles to a White Oak thence with Braggs old line  $S 38^{\circ} E 98$  poles  
 to a Pine thence with his old line crossing Horse Creek  $S 65^{\circ} E 65$  poles  
 to two Hornbeams thence  $S 12^{\circ} E 90$  poles to two Elms near two large Buckw  
 thence with an old conditional line  $S 84^{\circ} W 79$  poles to a Small Hickory  
 in Morgans field near a fence thence with a conditional <sup>line</sup>  $S 48^{\circ} W 57$  poles to  
 Black Oak thence with G. Morgans line  $S 35^{\circ} W 20$  poles to a White Oak  
 Stump thence with his line  $S 21^{\circ} E 40$  poles to a Planted rock thence with  
 an old dividing line  $S 68^{\circ} W 35$  poles to the Beginning

I surveyed the first mentioned line for the 4th of September 1849  
 Tho' S. Murrell  
 and Isaac McCalib son of Tho' } Chain Carrier  
 Henry Anderson Co

J. S. Murrell's  
Survey of 258 Acres

---

100 poles to an inch

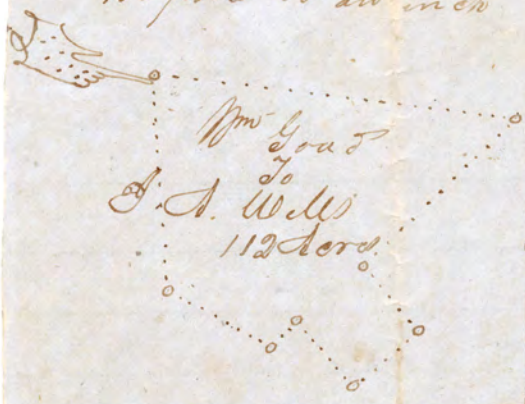

Wm Goad To J A Wells

Beginning at a Hickory on a  
hill on John Vincents line  
thence with the same S 22 W 19 1/2

poles to a Stake on a line of the  
old Grant near a White Oak Pointer thence with said  
old line S 87 E 111 poles to a large Black Oak thence  
North 45 1/2 poles to a Walnut at a road thence S 89 E 40  
poles to a Black Oak Stump thence S 46 poles  
to a White Oak on said old line thence with  
the same S 87 E 18 poles to a Stake near a Black  
Oak bush thence S 20 E 69 poles to a Pine thence  
with Peter Goads line S 35 W 100 poles to the  
Beginning containing 112 Acres

Henry Anderson Esq  
Sept the 6th 1849

My Dear Sir

J. A. Wells

112 N. 2nd St.



Pursuant to the last will of Gabriel Morgan D<sup>d</sup>  
I have surveyed for Gabriel Morgan Jr all the land  
given to him by his Father except a part that is claimed  
by John Vincent situated in Sullivan County Tennessee  
on the South side of Holston river from the North side of  
Horse Creek Beginning at a fallen Bucke top Sugar tree  
& Planted rock on the North bank of Horse Creek corner  
to S J Murrell thence with Mary Morgans line which is  
the meanders of said creek S 77° W 27 poles to a Sugar tree  
at the mouth of same thence S 72° W 5 poles to a Stake in a  
ditch thence up said Ditch S 52° W 9 poles to a Stake  
thence up said ditch with her line S 74° W 27 poles to a  
Stake in said ditch on Goads line thence with the  
same S 39° W 28 1/2 poles to a White Oak on a hill thence  
with his line S 64° W 75 poles to a Gum Sapling on a hill  
side thence with his line S 79° W 21 poles to a White Oak thence  
with his line of Wells line S 83° W 36 poles to a White Oak  
thence with said Wells line North forty six poles to a Black  
Oak stump thence with his line S 89° W 46 poles to a Walnut  
at a road thence with his line South 45 1/2 poles to a Black  
Oak thence with said Wells line S 88° W 80 poles to a  
Stake near two White Oaks with a cross for Dogwood John  
Vincents corner thence with his line S 83° E 88 poles to a  
White Oak at a fence thence with Piarces line East 100  
poles to a White Oak on the top of a ridge thence with  
his line S 81° E 29 poles to a Hickory fallen Post Oak of  
Pointers thence with Murrells line S 86° E 123 poles to a  
White Oak on a hill side near a hollow thence with  
Mullins line S 42 poles to two White Oaks on Pichins  
line thence with a line of a 130 acre Grant S 25° W 34  
poles to a Spanish Oak of Dogwood at a road on a  
ridge thence with several of S J Murrells lines S 20° W  
43 poles to a White Oak of Pointers thence S 37° E 21 poles  
to a Spanish Oak thence S 79° E 27 poles to a White Oak  
thence S 76 1/2° E 22 poles to a White Oak thence S 44 1/2° E 14 1/2

poles to a White Oak & Gum thence  $S 67^{\circ} E 35$  poles  
to a Planted rock thence  $S 42^{\circ} E 14$  poles to a Planted  
rock thence  $S 44^{\circ} E 43\frac{1}{2}$  poles to the Beginning

Surveyed the 8th day of March 1850 containing one  
hundred & ninety acres

Wm  
Henry Anderson C.S.  
of Sullivan County Tenn

Gabriel Morgan's  
Survey of 190 Acres

---

Sullivan County

---

Plot of Heals <sup>N</sup> Land Next E. A. Young



A      P  
101-    129

N



Begining at a 3 Lynns then S 11 E 11 1/2 poles  
to a large poplar then N 80 E 42 poles  
to a beech then S 84 E 20 poles to W oak  
then S 74 poles to double White oak  
then N 83 W 140 <sup>78</sup> poles to Walnut stump  
then S 35 poles to planted rock near W. Oak  
then N 85 W 35 p to small double gum  
then N 1/2 W 129 poles to stake Widon  
Keens corner then S 82 E 96 poles to  
stake then then S 43 E 28 poles to  
begining containing one hundred  
and one acres & 129 poles -

Surveyed the 24<sup>th</sup> of Jan 1881

Plat. of  
Titeworth track

---

Beginning at a planted rock on Horse Creek S. J. Mur-  
rell's sugartree corner then with his line North 44 West  
41 Poles to a planted rock then with the same South 42 West  
12 Poles to a planted rock then North 67 West 38 Poles to a  
white oak & gum then North 44 West 14 1/2 Poles to a white oak then  
North 76 West 21 1/2 Poles to a white oak then North 78 1/2 West  
22 1/2 Poles to a spanish oak then North 36 1/2 West 21 Poles to a  
white oak stump & pointers then North 20 East 78 Poles to a white oak  
on Pichen's old line then with the same North 41 1/2 Poles to ~~two~~  
~~with~~ a white oak on a hillside then with Murrell's line South 60  
West 124 Poles to a hickory, fallen post oak & pointers then with  
P Goad's line South 1 West 29 Poles to a white oak on the top  
of a ridge then West 48 Poles to a planted rock Noble Carr's  
line then with his line South 35 East 41 Poles to dead black  
walnut at a road, <sup>then</sup> S 1/4 West 18 Poles to a stake then with James  
A Wells' line North 73 East 52 Poles to a white oak his corner  
then with his line South 19 East 44 1/2 Poles to a black oak Hunt &  
Wells' corner on Goad's old line, <sup>then</sup> with the same North 84 East 18 Poles  
to a white oak then South 78 East 21 Poles to a gum on a hillside then  
South 64 East 75 Poles to a white oak Goad's corner then with his line  
South 38 1/2 East 28 1/2 Poles to a stake in a ditch, <sup>on</sup> Goad's old line then  
with Mary Morgan's line North 70 East 27 Poles to a stake in  
58 ditch then North 52 East 9 Poles, <sup>to</sup> a stake in a road then  
South 72 East 5 Poles to a sugar tree on the bank of Horse  
Creek then down the same with its several meanders North  
30 East 26 Poles to the Beginning

Survey of 117 acs

By Henry Stud

in Sulivan County