



AREA

FORM NO.

TP	88-24
----	-------

Town Lowell

Address 157 Dartmouth Street

Historic Name _____

Use: Present single family dwelling

Original single family dwelling

DESCRIPTION

Date 1896

Source water records

Style Colonial Revival

Architect _____

Exterior Wall Fabric clapboards

Outbuildings _____

Major Alterations (with dates) none

Condition fair

Moved _____ Date _____

Acreage 6,364 sq. ft.

Setting Faces east on tree-shaded side
street.

Recorded by Architectural Preservation Assoc.

Organization Tyler Park Neighborhood Assoc.

Date December, 1986

Sketch Map: Draw map showing property's location in relation to nearest cross streets and/or geographical features. Indicate all buildings between inventoried property and nearest intersection(s). Indicate north

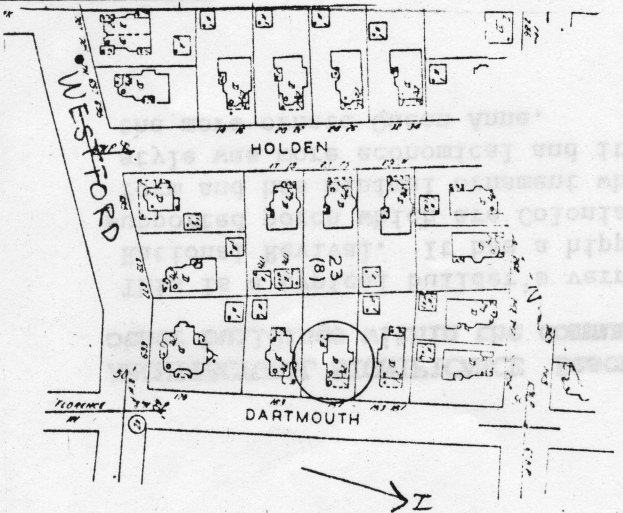

UTM REFERENCE _____

USGS QUADRANGLE _____

SCALE _____

NATIONAL REGISTER CRITERIA STATEMENT (if applicable)

This house is an integral part of the proposed Tyler Park Historic District.

ARCHITECTURAL SIGNIFICANCE Describe important architectural features and evaluate in terms of other buildings within the community.

This is a typical builder's vernacular Colonial Revival house which is transitional to Rational Revival. It has a hipped roof with hipped dormers, dentilled cornice and column supported porch which are Colonial Revival decorative devices. Yet the house is boxy in form and has minimal ornament which make it transitional to Rational Revival. The latter style was more economical and its volumetric and decorative simplicity were a reaction against the more ornate Queen Anne.

HISTORICAL SIGNIFICANCE Explain the role owners played in local or state history and how the building relates to the development of the community.

Dartmouth Street was laid out across land which had belonged to the Sayles family from 1873/1874. Sayles were one of the last farm families in the area which had remained farm and open pasture land until the beginning of the 1880s. Speculation on land development increased significantly during the 1880s as Lowell's mills continued to expand to meet their textile producing competition and the increased work forces required housing. Tyler Park was developed in response to this need aiming for the upper middle and middle class home owner whose new homes on the Tyler Park lands were required to have slate roofs and have a consistent street set back, among other things. Albert and Clare Green the probable first owners of the house in 1896 were typical of the area, as he was a yard foreman with the B & M Railroad in Lowell.

BIBLIOGRAPHY and/or REFERENCES

WATER RECORDS

Clare Green, 1896

ATLASES

1879 - land of Sayles

1896 - lot, but no house

1906 - C.S. Green

1924 - Green

1936 - John Ward, et ux.

DIRECTORIES

1878 - Albert W. Sayles, contractor Lowell Machine Shop

1896 - a. Albert H. Green, draughtsman
b. Albert P. Green, clerk, Gas Co.

1933 - John M. Ward, yard foreman, B&M