

FORM A - AREA

MASSACHUSETTS HISTORICAL COMMISSION  
294 Washington Street, Boston, MA. 02108

Form numbers in this area	Area letter
	BP



XII-22

Lowell

of area (if any) Belvidere Park

al date or period 1909

Sketch map. Draw a general map of the area indicating properties within it. Number each property for which individual inventory forms have been completed. Label streets (including route numbers, if any) and indicate north. (Attach a separate sheet if space here is not sufficient)

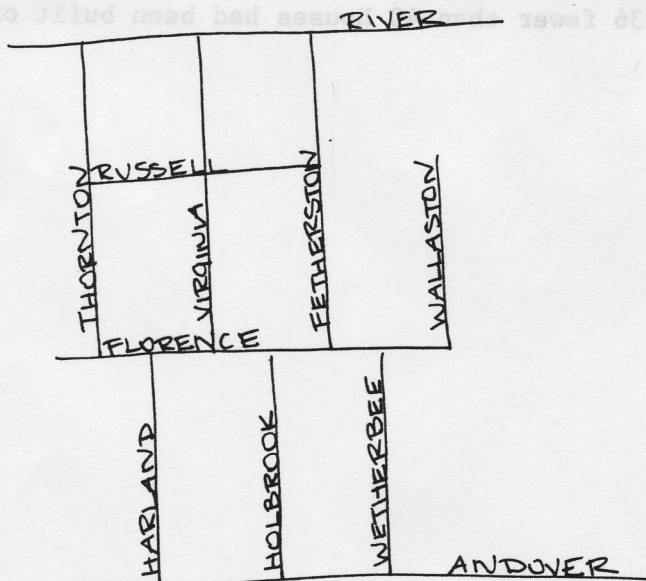

Recorded by Elizabeth Durfee Hengen

Organization DPD Architectural Survey

Date 12/80

(Staple additional sheets here)

ARCHITECTURAL SIGNIFICANCE of area. (Describe physical setting, general character, and architecturally significant structures).

The houses built in Belvidere Park were, despite the splendid associations of its name, small two story frame dwellings of no architectural distinction.

HISTORICAL SIGNIFICANCE of area. (Explain development of area, what caused it, and how it affected community; be specific).

In 1909 Belvidere Park was subdivided by the Park Land Company on land previously owned by the Daniels family and, until 1906, part of Tewksbury. The nine streets, which were laid out in a grid pattern, constituted the first subdivision north of Andover Street east of East Merrimack Street and the first of any size east of Nesmith Street. Streetcars along Andover Street made the distance of 1 1/2 miles from downtown no obstacle. Although the area was advertised as "unquestionably the finest part of the city...clean, healthy, picturesque and respectable," few of the lots were sold. Indeed, by 1936 fewer than 40 houses had been built on over 350 available lots.

#### BIBLIOGRAPHY and/or REFERENCES

Belvidere Park Plan

Atlas: 1906