

# Massachusetts Cultural Resource Information System

## Scanned Record Cover Page

<b>Inventory No:</b>	GRN.96
<b>Historic Name:</b>	Noble House
<b>Common Name:</b>	
<b>Address:</b>	186 South Ln
<b>City/Town:</b>	Granville
<b>Village/Neighborhood:</b>	
<b>Local No:</b>	
<b>Year Constructed:</b>	1860
<b>Architect(s):</b>	
<b>Architectural Style(s):</b>	Greek Revival
<b>Use(s):</b>	Single Family Dwelling House
<b>Significance:</b>	Architecture
<b>Area(s):</b>	
<b>Designation(s):</b>	
<b>Building Materials(s):</b>	Wall: Wood Clapboard



The Massachusetts Historical Commission (MHC) has converted this paper record to digital format as part of ongoing projects to scan records of the Inventory of Historic Assets of the Commonwealth and National Register of Historic Places nominations for Massachusetts. Efforts are ongoing and not all inventory or National Register records related to this resource may be available in digital format at this time.

The MACRIS database and scanned files are highly dynamic; new information is added daily and both database records and related scanned files may be updated as new information is incorporated into MHC files. Users should note that there may be a considerable lag time between the receipt of new or updated records by MHC and the appearance of related information in MACRIS. Users should also note that not all source materials for the MACRIS database are made available as scanned images. Users may consult the records, files and maps available in MHC's public research area at its offices at the State Archives Building, 220 Morrissey Boulevard, Boston, open M-F, 9-5.

Users of this digital material acknowledge that they have read and understood the MACRIS Information and Disclaimer (<http://mhc-macris.net/macrisdisclaimer.htm>)

Data available via the MACRIS web interface, and associated scanned files are for information purposes only. THE ACT OF CHECKING THIS DATABASE AND ASSOCIATED SCANNED FILES DOES NOT SUBSTITUTE FOR COMPLIANCE WITH APPLICABLE LOCAL, STATE OR FEDERAL LAWS AND REGULATIONS. IF YOU ARE REPRESENTING A DEVELOPER AND/OR A PROPOSED PROJECT THAT WILL REQUIRE A PERMIT, LICENSE OR FUNDING FROM ANY STATE OR FEDERAL AGENCY YOU MUST SUBMIT A PROJECT NOTIFICATION FORM TO MHC FOR MHC'S REVIEW AND COMMENT. You can obtain a copy of a PNF through the MHC web site ([www.sec.state.ma.us/mhc](http://www.sec.state.ma.us/mhc)) under the subject heading "MHC Forms."

Commonwealth of Massachusetts  
Massachusetts Historical Commission  
220 Morrissey Boulevard, Boston, Massachusetts 02125  
[www.sec.state.ma.us/mhc](http://www.sec.state.ma.us/mhc)

This file was accessed on: Saturday, March 30, 2019 at 1:10: PM

FORM B - BUILDING

AREA	FORM NO.
	96

MASSACHUSETTS HISTORICAL COMMISSION  
 80 BOYLSTON STREET  
 BOSTON, MA 02116



Granville

Address 186 South Lane #1

Historic Name Noble House

Present Residence

Original Residence

Description 1860

Source Assessor's Records

Style Greek Revival

Architect Unknown

Sketch Map: Draw map showing property's location in relation to nearest cross streets and/or geographical features. Indicate all buildings between inventoried property and nearest intersection(s). Indicate north

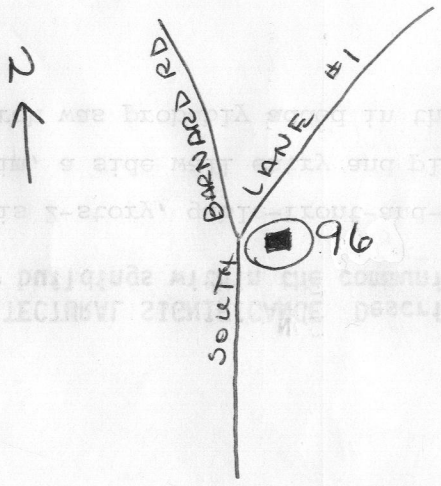

Exterior Wall Fabric Clapboard

Outbuildings Garage

Major Alterations (with dates) \_\_\_\_\_

Condition Good

Moved \_\_\_\_\_ Date \_\_\_\_\_

Acreage 5.50 acres

Setting Rural/Suburban

UTM REFERENCE \_\_\_\_\_

USGS QUADRANGLE Southwick

SCALE 1:25,000

Recorded by Joanne Keim - PVPC

Organization Granville Historic Commission

Date August 1987

NATIONAL REGISTER CRITERIA STATEMENT (if applicable)

ARCHITECTURAL SIGNIFICANCE Describe important architectural features and evaluate in terms of other buildings within the community.

This 2-story, gable-front-and-wing residence features wide eave overhangs, frieze board trim, a side hall entry and plain trim around the door and window. A 1-story enclosed porch was probably added in the early 1900's.

HISTORICAL SIGNIFICANCE Explain the role owners played in local or state history and how the building relates to the development of the community.

The residence was owned in 1855 by the Noble family. E.F. Roberts is shown as the owner from 1870-1912. He served as a Selectman from 1886-1890.

BIBLIOGRAPHY and/or REFERENCES

- Registry of Deeds - 3786/491
- Hampden County Atlas - 1855, 1870, 1894, 1912
- Wilson - History of Granville, p. 315
