

Massachusetts Cultural Resource Information System

Scanned Record Cover Page

Inventory No:	GRN.64
Historic Name:	Henry, Simon House
Common Name:	
Address:	530 Main Rd
City/Town:	Granville
Village/Neighborhood:	Granville
Local No:	
Year Constructed:	c 1860
Architect(s):	
Architectural Style(s):	Greek Revival
Use(s):	Single Family Dwelling House
Significance:	Architecture
Area(s):	GRN.D: Granville Village GRN.F: Granville Village Historic District
Designation(s):	Nat'l Register District (11/05/1991)
Building Materials(s):	Wall: Brick; Wood; Wood Clapboard



The Massachusetts Historical Commission (MHC) has converted this paper record to digital format as part of ongoing projects to scan records of the Inventory of Historic Assets of the Commonwealth and National Register of Historic Places nominations for Massachusetts. Efforts are ongoing and not all inventory or National Register records related to this resource may be available in digital format at this time.

The MACRIS database and scanned files are highly dynamic; new information is added daily and both database records and related scanned files may be updated as new information is incorporated into MHC files. Users should note that there may be a considerable lag time between the receipt of new or updated records by MHC and the appearance of related information in MACRIS. Users should also note that not all source materials for the MACRIS database are made available as scanned images. Users may consult the records, files and maps available in MHC's public research area at its offices at the State Archives Building, 220 Morrissey Boulevard, Boston, open M-F, 9-5.

Users of this digital material acknowledge that they have read and understood the MACRIS Information and Disclaimer (<http://mhc-macris.net/macrisdisclaimer.htm>)

Data available via the MACRIS web interface, and associated scanned files are for information purposes only. THE ACT OF CHECKING THIS DATABASE AND ASSOCIATED SCANNED FILES DOES NOT SUBSTITUTE FOR COMPLIANCE WITH APPLICABLE LOCAL, STATE OR FEDERAL LAWS AND REGULATIONS. IF YOU ARE REPRESENTING A DEVELOPER AND/OR A PROPOSED PROJECT THAT WILL REQUIRE A PERMIT, LICENSE OR FUNDING FROM ANY STATE OR FEDERAL AGENCY YOU MUST SUBMIT A PROJECT NOTIFICATION FORM TO MHC FOR MHC'S REVIEW AND COMMENT. You can obtain a copy of a PNF through the MHC web site (www.sec.state.ma.us/mhc) under the subject heading "MHC Forms."

Commonwealth of Massachusetts
Massachusetts Historical Commission
220 Morrissey Boulevard, Boston, Massachusetts 02125
www.sec.state.ma.us/mhc

This file was accessed on: Sunday, March 18, 2018 at 3:45: PM

FORM B - BUILDING

MASSACHUSETTS HISTORICAL COMMISSION
 80 BOYLSTON STREET
 BOSTON, MA 02116

NRD 13
 115791 GRN.64

AREA	FORM NO.
D.F.	64

PL-Granville



Location Granville
 Address 530 Main Street
 Historic Name Simon Henry House
 Present Residence
 Original Residence
 Description c.1860
 Perspective Visual
 Style Greek Revival
 Architect Unknown

Sketch Map: Draw map showing property's location in relation to nearest cross streets and/or geographical features. Indicate all buildings between inventoried property and nearest intersection(s). Indicate north

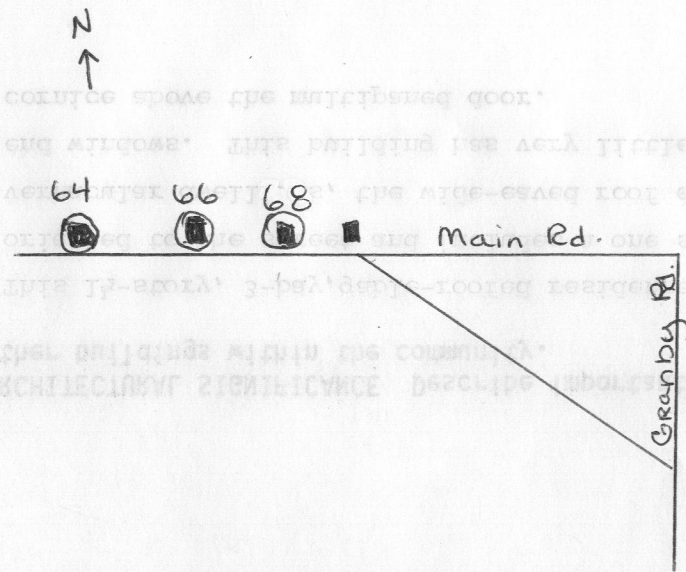

Exterior Wall Fabric Clapboard
 Outbuildings 2 Barns

Major Alterations (with dates) _____

Condition Good

Moved _____ Date _____

Acreage 2.25 acres

Setting Village

UTM REFERENCE _____

USGS QUADRANGLE Southwick

SCALE 1:25,000

Recorded by Joanne Keim - PVPC

Organization Granville Historic Commission

Date August 1987

PKM

NATIONAL REGISTER CRITERIA STATEMENT (if applicable)

ARCHITECTURAL SIGNIFICANCE Describe important architectural features and evaluate in terms of other buildings within the community.

This 1 1/2-story, 3-bay, gable-roofed residence in Granville in which the gable front is oriented to the street and includes a one story wing. In many of these mid-century vernacular dwellings, the wide-eaved roof ends at the mid-point of the 2nd floor gable end windows. This building has very little ornamentation other than the low peaked cornice above the multipaned door.

HISTORICAL SIGNIFICANCE Explain the role owners played in local or state history and how the building relates to the development of the community.

This residence was owned from 1870-1912 by Simon N. Henry. Henry was a wheelwright and made wagons in a shop on this property.

BIBLIOGRAPHY and/or REFERENCES

- Registry of Deeds - 4234/40
Hampden County Atlas - 1855, 1870, 1894, 1912
Wilson - History of Granville, p. 118

Form with fields for 'D', 'EV', 'VBEV', and 'EOWN NO.'