

# Massachusetts Cultural Resource Information System

## Scanned Record Cover Page

<b>Inventory No:</b>	GRN.83
<b>Historic Name:</b>	Rose, Miles J. House
<b>Common Name:</b>	
<b>Address:</b>	458 Main Rd
<b>City/Town:</b>	Granville
<b>Village/Neighborhood:</b>	Granville
<b>Local No:</b>	
<b>Year Constructed:</b>	c 1880
<b>Architect(s):</b>	
<b>Architectural Style(s):</b>	Italianate
<b>Use(s):</b>	Single Family Dwelling House
<b>Significance:</b>	Architecture
<b>Area(s):</b>	GRN.D: Granville Village GRN.F: Granville Village Historic District
<b>Designation(s):</b>	Nat'l Register District (11/05/1991)
<b>Building Materials(s):</b>	Wall: Wood; Wood Clapboard



The Massachusetts Historical Commission (MHC) has converted this paper record to digital format as part of ongoing projects to scan records of the Inventory of Historic Assets of the Commonwealth and National Register of Historic Places nominations for Massachusetts. Efforts are ongoing and not all inventory or National Register records related to this resource may be available in digital format at this time.

The MACRIS database and scanned files are highly dynamic; new information is added daily and both database records and related scanned files may be updated as new information is incorporated into MHC files. Users should note that there may be a considerable lag time between the receipt of new or updated records by MHC and the appearance of related information in MACRIS. Users should also note that not all source materials for the MACRIS database are made available as scanned images. Users may consult the records, files and maps available in MHC's public research area at its offices at the State Archives Building, 220 Morrissey Boulevard, Boston, open M-F, 9-5.

Users of this digital material acknowledge that they have read and understood the MACRIS Information and Disclaimer (<http://mhc-macris.net/macrisdisclaimer.htm>)

Data available via the MACRIS web interface, and associated scanned files are for information purposes only. THE ACT OF CHECKING THIS DATABASE AND ASSOCIATED SCANNED FILES DOES NOT SUBSTITUTE FOR COMPLIANCE WITH APPLICABLE LOCAL, STATE OR FEDERAL LAWS AND REGULATIONS. IF YOU ARE REPRESENTING A DEVELOPER AND/OR A PROPOSED PROJECT THAT WILL REQUIRE A PERMIT, LICENSE OR FUNDING FROM ANY STATE OR FEDERAL AGENCY YOU MUST SUBMIT A PROJECT NOTIFICATION FORM TO MHC FOR MHC'S REVIEW AND COMMENT. You can obtain a copy of a PNF through the MHC web site ([www.sec.state.ma.us/mhc](http://www.sec.state.ma.us/mhc)) under the subject heading "MHC Forms."

Commonwealth of Massachusetts  
Massachusetts Historical Commission  
220 Morrissey Boulevard, Boston, Massachusetts 02125  
[www.sec.state.ma.us/mhc](http://www.sec.state.ma.us/mhc)

This file was accessed on: Tuesday, February 20, 2018 at 8:35: AM

FORM B - BUILDING

NADIS 11/15/91  
GRN.83

MASSACHUSETTS HISTORICAL COMMISSION  
80 BOYLSTON STREET  
BOSTON, MA 02116

AREA	FORM NO.
D.F.	83

Pl-Granville



Granville  
 458 Main Road  
 Maple Street

Historic Name Miles J. Rose House

Present Residence

Original Residence

Description c.1880

Style Visual

Architecture Italianate

Architect Unknown

Sketch Map: Draw map showing property's location in relation to nearest cross streets and/or geographical features. Indicate all buildings between inventoried property and nearest intersection(s). Indicate north

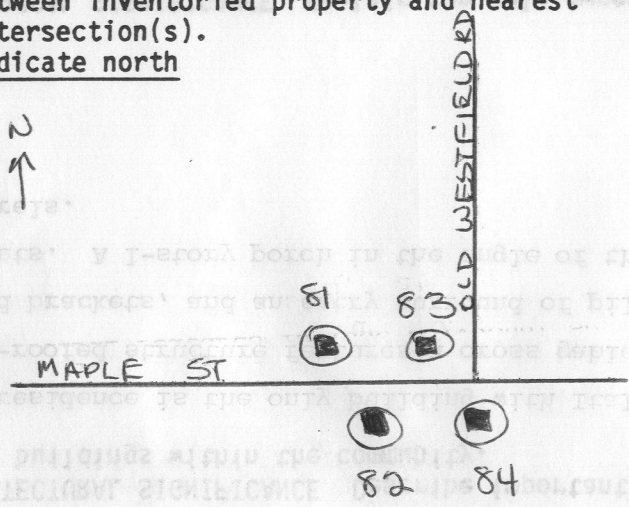

Exterior Wall Fabric Clapboard

Outbuildings Barn

Major Alterations (with dates) \_\_\_\_\_

Condition Good

Moved \_\_\_\_\_ Date \_\_\_\_\_

Acreage 18.00 acres

Setting Village

Recorded by Joanne Keim - PVPC

Organization Granville Historic Commission

Date August 1987

UTM REFERENCE \_\_\_\_\_

USGS QUADRANGLE Southwick

SCALE 1:25,000

(8583)

NATIONAL REGISTER CRITERIA STATEMENT (if applicable)

ARCHITECTURAL SIGNIFICANCE Describe important architectural features and evaluate in terms of other buildings within the community.

This residence is the only building with Italianate details in Granville. The 2-story, gable-roofed structure features a cross gable, a 1-story bay with a heavy cornice and paired brackets, and an entry surround of pilasters supporting a cornice with paired brackets. A 1-story porch in the angle of the "L" is elaborated by turned posts and spandrels.

HISTORICAL SIGNIFICANCE Explain the role owners played in local or state history and how the building relates to the development of the community.

David Rose, a descendent of Miles J. Rose built this house and lived in it until his death in 1915. He served as choir director of the Methodist Church and his wife was the organist. Rose was also elected a Selectman in 1893.

BIBLIOGRAPHY and/or REFERENCES

- Registry of Deeds - 3440/323
Hampden County Atlas - 1984, 1912
Wilson - History of Granville, p. 225, 315

Table with 2 columns: D, 33. Row 1: D, 33. Row 2: (blank), (blank).