

Massachusetts Cultural Resource Information System

Scanned Record Cover Page

Inventory No:	GRN.97
Historic Name:	Spelman, Eber House
Common Name:	
Address:	231 South Ln
City/Town:	Granville
Village/Neighborhood:	
Local No:	
Year Constructed:	c 1800
Architect(s):	
Architectural Style(s):	Georgian
Use(s):	Single Family Dwelling House
Significance:	Architecture
Area(s):	
Designation(s):	
Building Materials(s):	Wall: Aluminum Siding; Glass



The Massachusetts Historical Commission (MHC) has converted this paper record to digital format as part of ongoing projects to scan records of the Inventory of Historic Assets of the Commonwealth and National Register of Historic Places nominations for Massachusetts. Efforts are ongoing and not all inventory or National Register records related to this resource may be available in digital format at this time.

The MACRIS database and scanned files are highly dynamic; new information is added daily and both database records and related scanned files may be updated as new information is incorporated into MHC files. Users should note that there may be a considerable lag time between the receipt of new or updated records by MHC and the appearance of related information in MACRIS. Users should also note that not all source materials for the MACRIS database are made available as scanned images. Users may consult the records, files and maps available in MHC's public research area at its offices at the State Archives Building, 220 Morrissey Boulevard, Boston, open M-F, 9-5.

Users of this digital material acknowledge that they have read and understood the MACRIS Information and Disclaimer (<http://mhc-macris.net/macrisdisclaimer.htm>)

Data available via the MACRIS web interface, and associated scanned files are for information purposes only. THE ACT OF CHECKING THIS DATABASE AND ASSOCIATED SCANNED FILES DOES NOT SUBSTITUTE FOR COMPLIANCE WITH APPLICABLE LOCAL, STATE OR FEDERAL LAWS AND REGULATIONS. IF YOU ARE REPRESENTING A DEVELOPER AND/OR A PROPOSED PROJECT THAT WILL REQUIRE A PERMIT, LICENSE OR FUNDING FROM ANY STATE OR FEDERAL AGENCY YOU MUST SUBMIT A PROJECT NOTIFICATION FORM TO MHC FOR MHC'S REVIEW AND COMMENT. You can obtain a copy of a PNF through the MHC web site (www.sec.state.ma.us/mhc) under the subject heading "MHC Forms."

Commonwealth of Massachusetts
Massachusetts Historical Commission
220 Morrissey Boulevard, Boston, Massachusetts 02125
www.sec.state.ma.us/mhc

This file was accessed on: Saturday, March 30, 2019 at 1:11: PM

AREA	FORM NO.
	97



Granville

231
South Lane #1

me Eber Spelman House

nt Residence

nal Residence

c.1800

Visual

Georgian

Unknown

Sketch Map: Draw map showing property's location in relation to nearest cross streets and/or geographical features. Indicate all buildings between inventoried property and nearest intersection(s). Indicate north

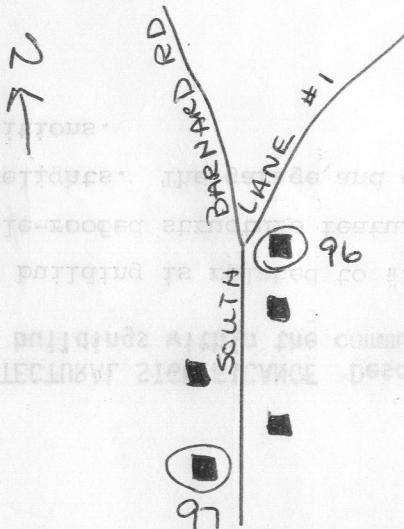

Exterior Wall Fabric Synthetic Siding

Outbuildings Barn

Major Alterations (with dates) _____

Condition Good

Moved _____ Date _____

Acreage Less than 1 acre

Setting Rural

UTM REFERENCE _____

USGS QUADRANGLE West Granville

SCALE 1:25,000

Recorded by Joanne Keim - PVPC

Organization Granville Historic Commission

Date August 1987

NATIONAL REGISTER CRITERIA STATEMENT (if applicable)

ARCHITECTURAL SIGNIFICANCE Describe important architectural features and evaluate in terms of other buildings within the community.

The building is related to #27, #35, #63, #104 because of the overhang. This 2-story, gable-roofed structure features a second story overhang and a center entry with 1/2 sidelights. The garage and enclosed porch on the north side are probably 20th century additions.

HISTORICAL SIGNIFICANCE Explain the role owners played in local or state history and how the building relates to the development of the community.

This property was in the Spelman family for a number of years. Eber Spelman is identified as the builder. From 1855 - 1894 W.H. Spelman resided on the property. The Spelmans were a local maker of whips and in 1855, a whip shop was shown to be located near the property. W. Woodard was the occupant in 1912.

BIBLIOGRAPHY and/or REFERENCES

- Registry of Deeds - 4353/366
Hampden County Atlas - 1855, 1870, 1894, 1912
Interview with - Wilhelmina Tryon, Granville, MA 1982