

Massachusetts Cultural Resource Information System

Scanned Record Cover Page

Inventory No:	GRN.48
Historic Name:	Root, Joel House
Common Name:	
Address:	687 Main Rd
City/Town:	Granville
Village/Neighborhood:	Granville Center
Local No:	32
Year Constructed:	1814
Architect(s):	
Architectural Style(s):	Federal
Use(s):	Single Family Dwelling House
Significance:	Architecture
Area(s):	GRN.C: Granville Center GRN.E: Granville Center Historic District
Designation(s):	Nat'l Register District (11/05/1991)
Building Materials(s):	Wall: Glass; Wood; Wood Clapboard Foundation: Stone, Uncut



The Massachusetts Historical Commission (MHC) has converted this paper record to digital format as part of ongoing projects to scan records of the Inventory of Historic Assets of the Commonwealth and National Register of Historic Places nominations for Massachusetts. Efforts are ongoing and not all inventory or National Register records related to this resource may be available in digital format at this time.

The MACRIS database and scanned files are highly dynamic; new information is added daily and both database records and related scanned files may be updated as new information is incorporated into MHC files. Users should note that there may be a considerable lag time between the receipt of new or updated records by MHC and the appearance of related information in MACRIS. Users should also note that not all source materials for the MACRIS database are made available as scanned images. Users may consult the records, files and maps available in MHC's public research area at its offices at the State Archives Building, 220 Morrissey Boulevard, Boston, open M-F, 9-5.

Users of this digital material acknowledge that they have read and understood the MACRIS Information and Disclaimer (<http://mhc-macris.net/macrisdisclaimer.htm>)

Data available via the MACRIS web interface, and associated scanned files are for information purposes only. THE ACT OF CHECKING THIS DATABASE AND ASSOCIATED SCANNED FILES DOES NOT SUBSTITUTE FOR COMPLIANCE WITH APPLICABLE LOCAL, STATE OR FEDERAL LAWS AND REGULATIONS. IF YOU ARE REPRESENTING A DEVELOPER AND/OR A PROPOSED PROJECT THAT WILL REQUIRE A PERMIT, LICENSE OR FUNDING FROM ANY STATE OR FEDERAL AGENCY YOU MUST SUBMIT A PROJECT NOTIFICATION FORM TO MHC FOR MHC'S REVIEW AND COMMENT. You can obtain a copy of a PNF through the MHC web site (www.sec.state.ma.us/mhc) under the subject heading "MHC Forms."

Commonwealth of Massachusetts
Massachusetts Historical Commission
220 Morrissey Boulevard, Boston, Massachusetts 02125
www.sec.state.ma.us/mhc

This file was accessed on: Sunday, March 11, 2018 at 1:33: PM

USGS W. Granville
 NRDL 115191
 GRN.48



AREA C E **FORM NO.** 48

Pl-Gran. Ent.

Granville
687
 Main Road

Name Joel Root

Present Residence

Original Residence

FUNCTION

Date 1814

Source "200th Anniversary Celebration Pamphlet"

Style Federal

Architect Unknown

Exterior Wall Fabric Clapboard

Outbuildings None

Major Alterations (with dates) _____

Condition Very Good

Moved _____ **Date** _____

Acreage 30.0 acres

Setting Village

Recorded by Joanne Keim - PVPC

Organization Granville Historic Commission

Date August 1987

Sketch Map: Draw map showing property's location in relation to nearest cross streets and/or geographical features. Indicate all buildings between inventoried property and nearest intersection(s). Indicate north

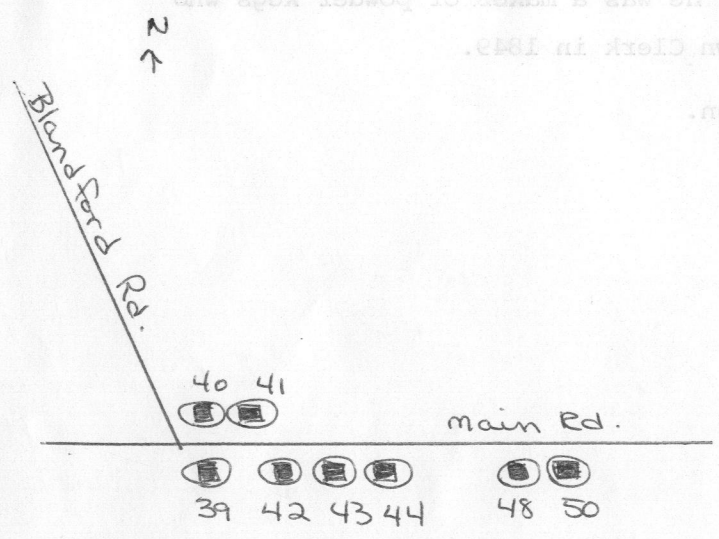

UTM REFERENCE _____

USGS QUADRANGLE West Granville

SCALE 1:25,000

NATIONAL REGISTER CRITERIA STATEMENT (if applicable)

ARCHITECTURAL SIGNIFICANCE Describe important architectural features and evaluate in terms of other buildings within the community.

This 2-story, 5 X 4 bay, gable-roofed structure with 2 interior chimneys displays an ambitious use of classical detail. That detail and the presence of 2-story pilasters relate it to a group of buildings with the same features (#18, #43, #45, #47). The symmetrical north facade features four fluted pilasters and a central door with leaded glass sidelights and pilasters supporting an entablature. The mutule blocks and stylized triglyphs (see #45 and #61) of the roof cornice are repeated on the entablature over the door and the first floor windows. The east facade also exhibits the same degree of ornamentation. Variations occur in the inclusion of a tripartid central 2nd floor window and a fanlight in the pedimented gable.

HISTORICAL SIGNIFICANCE Explain the role owners played in local or state history and how the building relates to the development of the community.

This residence was built for Joel Root a local shopkeeper. He served Granville as a Selectman in 1825, 1826 and 1831.

In 1870 to 1894 Eleazur Brown owned the property. He was a maker of powder kegs who served as a Selectman during the 1870's and as Town Clerk in 1849.

In 1912, the house was owned by Katherine Stevenson.

BIBLIOGRAPHY and/or REFERENCES

- Registry of Deeds - 2378/546
- Hampden County Atlas - 1855, 1870, 1894 and 1912
- "200th Anniversary Celebration Pamphlet" #12, Mrs. Joseph A. Duris, et al, Granville, MA 1954
- Wilson, History of Granville - p. 313, 314, 317



orig. photo on file Conn Valley Hist Mus.

GRN.48 I-32
48

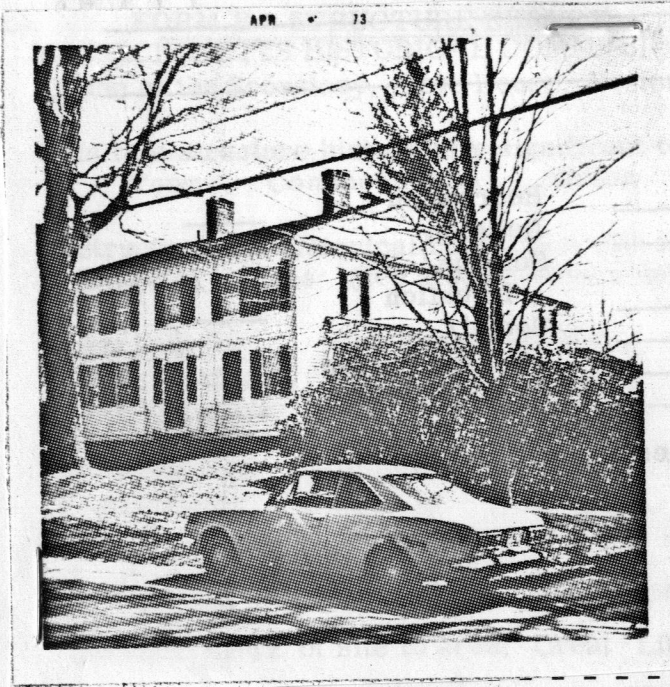

2. Town Granville

Street _____

Name Root, Joel, House

Original Use _____

Present Use _____

Present Owner _____

Date 1814 Style _____

Source of Date Conn. Valley Hist Mus. photo survey

ty Architect _____

riorated Moved Altered _____

le None SITE endangered by _____

4. DESCRIPTION

FOUNDATION/BASEMENT: High Regular Low Material: _____

WALL COVER: Wood _____ Brick Stone Other _____

STORIES: 1 2 3 4 CHIMNEYS: 1 2 3 4 Center End Cluster Elaborate Irregular

ATTACHMENTS: Wings Ell Shed Dependency _____ Simple/Complex

PORCHES: 1 2 3 4 Portico Balcony _____ Recessed _____

ROOF: Ridge Gambrel Flat Hip Mansard
Tower Cupola Dormer windows Balustrade Grillwork _____

FACADE: Gable End: Front/Side Symmetrical/Asymmetrical Simple/Complex Ornament

Entrance: Front/Side Centered Double Features: _____

Windows: Spacing: Regular/Irregular Identical/Varied _____

Corners: Plain Pilasters Quoins Obscured _____

OUTBUILDINGS _____ LANDSCAPING _____

5. Indicate location of structure on map below

6. Footage of structure from street _____
Property has _____ feet frontage on street

Recorder _____

For _____

Photo CVHM-I-14
70.3389

NOTE: Recorder should obtain written permission from Commission or sponsoring organization before using this form. (See Reverse Side)

6RN.48

FOR USE WITH IMPORTANT STRUCTURES (Indicate any interior features of note)

Fireplace

Stairway

Other

GIVE A BRIEF DESCRIPTION OF HISTORIC IMPORTANCE OF SITE (Refer and elaborate on theme circled on front of form)

The Jeel Root House with its two matching facades is unusually beautiful in its use of repeated decoration. Unquestionably designed by the same man as the later Parsons House in the Village, it is more elaborate, less monumental. The cornice motif is repeated over all the doorways + downstairs windows + completely encloses the house under the eaves. The two facades (one toward the church, the other toward the street) are only slightly varied in size + detail. The Root house is unusually handsome for rural New England + the "Granville" architect deserves investigation + recognition -

Ref: Conn. Valley Hist Mus photo-caption (1844)

BIBLIOGRAPHY

Footage of structure from street
Property has feet footage on street

Indicate location of structure on map below

Recorder

For

Photograph

Original Owner: _____
Deed Information: Book Number _____ Page _____

Registry of Deeds

(See Reverse Side)

NOTE: Recorder's Office has this form.