

Massachusetts Cultural Resource Information System

Scanned Record Cover Page

Inventory No:	GRN.37
Historic Name:	Rose, John and Ruth House
Common Name:	
Address:	944 Main Rd
City/Town:	Granville
Village/Neighborhood:	
Local No:	
Year Constructed:	c 1743
Architect(s):	
Architectural Style(s):	Georgian
Use(s):	Single Family Dwelling House; Agricultural
Significance:	Architecture; Exploration Settlement
Area(s):	
Designation(s):	Nat'l Register Individual Property (08/10/2018)
Building Materials(s):	Wall: Brick; Wood Clapboard



The Massachusetts Historical Commission (MHC) has converted this paper record to digital format as part of ongoing projects to scan records of the Inventory of Historic Assets of the Commonwealth and National Register of Historic Places nominations for Massachusetts. Efforts are ongoing and not all inventory or National Register records related to this resource may be available in digital format at this time.

The MACRIS database and scanned files are highly dynamic; new information is added daily and both database records and related scanned files may be updated as new information is incorporated into MHC files. Users should note that there may be a considerable lag time between the receipt of new or updated records by MHC and the appearance of related information in MACRIS. Users should also note that not all source materials for the MACRIS database are made available as scanned images. Users may consult the records, files and maps available in MHC's public research area at its offices at the State Archives Building, 220 Morrissey Boulevard, Boston, open M-F, 9-5.

Users of this digital material acknowledge that they have read and understood the MACRIS Information and Disclaimer (<http://mhc-macris.net/macrisdisclaimer.htm>)

Data available via the MACRIS web interface, and associated scanned files are for information purposes only. THE ACT OF CHECKING THIS DATABASE AND ASSOCIATED SCANNED FILES DOES NOT SUBSTITUTE FOR COMPLIANCE WITH APPLICABLE LOCAL, STATE OR FEDERAL LAWS AND REGULATIONS. IF YOU ARE REPRESENTING A DEVELOPER AND/OR A PROPOSED PROJECT THAT WILL REQUIRE A PERMIT, LICENSE OR FUNDING FROM ANY STATE OR FEDERAL AGENCY YOU MUST SUBMIT A PROJECT NOTIFICATION FORM TO MHC FOR MHC'S REVIEW AND COMMENT. You can obtain a copy of a PNF through the MHC web site (www.sec.state.ma.us/mhc) under the subject heading "MHC Forms."

Commonwealth of Massachusetts
Massachusetts Historical Commission
220 Morrissey Boulevard, Boston, Massachusetts 02125
www.sec.state.ma.us/mhc

This file was accessed on: Saturday, March 30, 2019 at 12:21 PM

USGS W. Granville
 sec B GRN.37

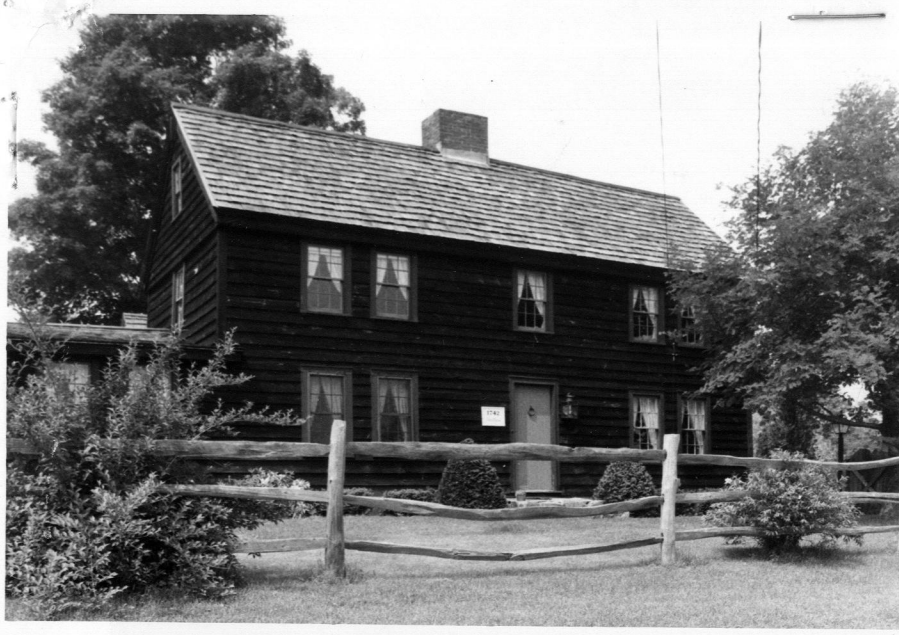

AREA	FORM NO.
	37

Granville

944 Main Road

Name John Rose House

Present Residence

Original Residence

Date 1742

Source Assessor's Records

Style Georgian

Architect Unknown

Exterior Wall Fabric Wide Clapboard

Outbuildings Attached Barn

Major Alterations (with dates)

Condition Good

Moved _____ Date _____

Acreage 4.5 acres

Setting Rural/Suburban

Recorded by Joanne Keim - PVPC

Organization Granville Historic Commission

Date August 1987

Sketch Map: Draw map showing property's location in relation to nearest cross streets and/or geographical features. Indicate all buildings between inventoried property and nearest intersection(s). Indicate north

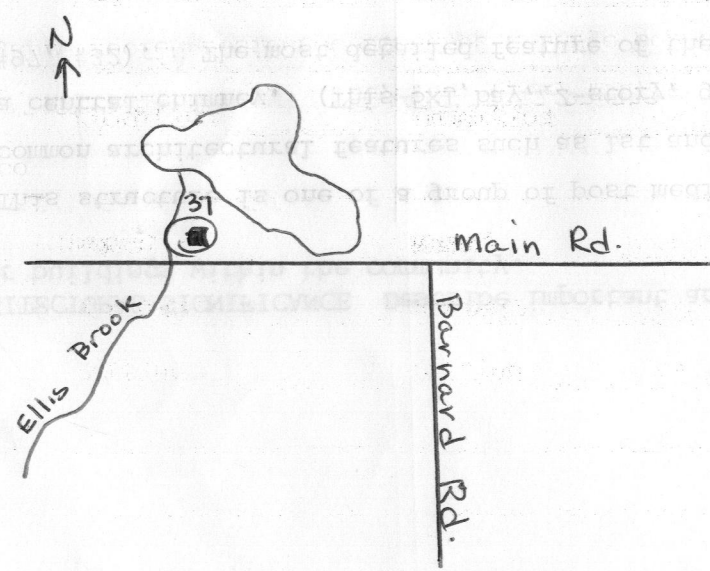

UTM REFERENCE _____

USGS QUADRANGLE West Granville

SCALE 1:25,000

NATIONAL REGISTER CRITERIA STATEMENT (if applicable)

ARCHITECTURAL SIGNIFICANCE Describe important architectural features and evaluate in terms of other buildings within the community.

This structure is one of a group of post medieval buildings in Granville which share common architectural features such as 1st and second story overhangs, corner boards and a central chimney. (#26, #35, #104, #93, #63, #30, #97, #32). This 2-story, 5-bay, gable-roofed residence features a large corbeled chimney.

HISTORICAL SIGNIFICANCE Explain the role owners played in local or state history and how the building relates to the development of the community.

John Rose was one of the first settlers of Granville in about 1750. He was involved in establishing the first church in Granville and also served as Selectman.

C.F. Bates is listed as the occupant in 1855 and was a representative to the General Court in 1849. L. Page was the resident in 1870 and A. Beckman in 1912.

BIBLIOGRAPHY and/or REFERENCES

- Registry of Deeds - 4342/356
- Hampden County Atlas - 1855, 1870, 1912
- Wilson - History of Granville, pg. 37, 170, 310, 318



MHC INVENTORY FORM CONTINUATION SHEET

MHC Inventory scanning project, 2008-2012

MACRIS No. GRN.37



Original yellow form: Eligibility file
 Copies: Inventory form
 Town file(w/corresp.)
 Macris
 NR director _____

Community: Granville

MHC OPINION: ELIGIBILITY FOR NATIONAL REGISTER

Date Received: Dec. 28, 2015

Date Reviewed: Jan. 6, 2016

Type: Individual District (Attach map indicating boundaries)

Name: John Rose House Inventory Form: GRN.37

Address: 944 Main Road, Granville, MA 01034

Requested by: Elizabeth Rairigh, PVPC, on behalf of owner, Thomas A. Jones

Action: Honor ITC Grant R & C Other:

Agency: Staff in charge of Review: Betsy Friedberg

INDIVIDUAL PROPERTIES

Eligible
 Eligible, also in district
 Eligible only in district
 Ineligible
 More information needed

DISTRICTS

Eligible
 Ineligible
 More information needed

CRITERIA: A B C D

LEVEL: Local State National

STATEMENT OF SIGNIFICANCE by T.A. Fortier

The John Rose House is a one of only two surviving buildings that have been dated to the initial settlement of Granville in the 1730s. Jonathan Rose was one of the original settlers who built his home in 1742 - a 2 ½-story, 5 bay, post and beam frame Georgian house with a cedar shingle side gable roof, center chimney, and gambrel-roofed rear ell. A narrow 1-story connector attaches a 2-story front gable barn to the west. There are three outbuildings on the property – two c1805 structures (a carriage barn and barn) relocated from Southwick, MA and a c1950 cottage.

In Jan. 2014, the property owner, Thomas Jones, submitted a letter and Form B requesting a review for eligibility for inclusion in the NR. In Feb. 2014, BF responded requesting additional information. In Feb. 2015, Elizabeth Rairigh, PVPC, submitted additional information on behalf of Mr. Jones which addressed some of BF's requests. TAF responded requesting additional information and in Jan. 2016, Elizabeth Rairigh submitted additional information. MHC reviewed this information and it is of the opinion of MHC that the John Rose House qualifies for individual listing with a local significance under National Register Criteria A and C.

The house meets Criterion A as representing the earliest settlement of Granville (then known as Bedford) and built by John Rose, who was among the original 27 families to settle this area.

Furthermore, two of John Rose's sons served in the Revolutionary War, as did Ebenezer Smith, the subsequent owner of the house. The house may also be significant for its association with Smith because he held a tavern keeper's license (it would be important to establish whether or not there is evidence to indicate that the house served as a tavern) and possibly for its association with Marie Shaughnessy, purportedly a Broadway actress (this, too, would need to be substantiated).

The house also meets National Register criterion C as a representative example of a 2 ½ story Georgian style house with mostly original features and some restored features including salvaged wood paneling in the kitchen (and connector?), reproduction windows throughout, a reconstructed front entry, outbuildings relocated from another site, and renovated outbuildings. The house appears to retain its original form, fenestration pattern, chimney, interior plan, wood paneling throughout much of the house, four fireplaces (one with a brick beehive oven), interior doors with butterfly hardware, a corner cupboard, kitchen shelving supports, and wood floors. It will be important to clearly identify those features on the interior and exterior of the house (and property at large) that are original to the John Rose House, those that were salvaged from other period buildings, and those that were reproduced.

Original yellow form: Eligibility file
Copies: Inventory form
Town file(w/corresp.)
Macris
NR director _____

Community: GRANVILLE

MHC OPINION: ELIGIBILITY FOR NATIONAL REGISTER

Date Received: 21 Jan 2014

Date Reviewed: 06 Feb 2014

Type: X Individual District (Attach map indicating boundaries)

Name: Jonathan Rose House Inventory Form: GRN.37

Address: 944 Main Road

Requested by: Owner/Mr. Thomas A. Jones

Action: X Honor ITC Grant R & C Other:

Agency: Staff in charge of Review: BF

INDIVIDUAL PROPERTIES

DISTRICTS

- Eligible
- Eligible, also in district
- Eligible only in district
- Ineligible
- X More information needed

- Eligible
- Ineligible
- More information needed

CRITERIA: A B C D

LEVEL: Local State National

STATEMENT OF SIGNIFICANCE by Barbara Kurze

Jonathan Rose was one of the original settlers in Granville (known as Bedford until 1754) and is believed to have built his home in 1742 on land acquired from the Bedford Proprietors Quincy, Wendell and Byles of Boston. He later sold the house to Ebenezer Smith who ran the “Smith Tavern” until 1782. The property has had a number of owners, including Marie Shaughnessy (1938), who may have been a Broadway actress. The Jonathan Rose House is currently a private residence.

The property is located in a rural setting south of Shaughnessy Pond. The 2 ½-story, 5 bay, post and beam frame Georgian house has a cedar shingle side gable roof and center chimney. Many of the interior architectural features appear to have survived, including fireplaces, interior doors and hardware, cupboards and paneling. The gambrel-roofed rear ell may pre-date the house as the construction date is noted as ca. 1738. A narrow 1-story connector attaches a 2-story front gable barn to the west side of the house. There are three outbuildings on the property. In 1985, two ca. 1805 structures – a barn and a carriage house - were moved to the site from Southwick, MA. There is also a ca. 1950 cottage on the grounds.

The Jonathan Rose House is a significant building from the initial settlement of Granville. However, more information is required in order for MHC staff to evaluate whether it meets the criteria for individual listing in the National Register. Specifically, we will need additional information as follows:

To better understand the land history of the original property, we need to know the size and use(s) of the original property, as well as any available information about historic buildings and structures that were on the property but no longer exist. Historic survey documents or maps, if they exist, should be included.

We will also need more information about the building history, specifically information about the 1738 rear ell and its relation to the site and the 1742 house, as well as dates and information about the attached barn and the connector. The building, including its interior features, would best be examined by an architectural historian with expertise in early Massachusetts building to determine whether the 1738 and 1742 dates are appropriate and to evaluate the integrity of the structure and interior architectural details.

Details are needed about the renovations (especially the bathrooms and kitchen) and the other interior changes and restoration work that have been done. Please provide, if they exist, photographs of the building prior to the changes and restoration work, as well as current photographs of all restored interior spaces. In addition to the interior photographs, we would also need photographs of all of the exterior elevations including the rear ell.

The site plan should include an index for the numbered outbuildings, so that their locations can be correctly identified. And the Parsons house should be identified as the Smith-Phelps house, which is the historical name used in the Inventory of Historic Assets of the Commonwealth and the MACRIS database.

Finally, we would need more information about the property ownership history: the names of all of the twelve subsequent owners, the dates they owned the property, and what they used the property for. If there are major changes to the property that can be attributed to specific owners, these should be noted. Some specific questions that should be answered, if possible, are: when was the property sold to Ebenezer Smith? Was this a farm for most of its later use? Was it ever used as a summer home? Is it possible to identify whether any of the restoration work was done during the Colonial Revival Movement of the late 19th or earlier 20th century? Did Marie Shaughnessy make any changes to the house when she owned the property?