

# Massachusetts Cultural Resource Information System

## Scanned Record Cover Page

<b>Inventory No:</b>	GRN.802
<b>Historic Name:</b>	West Granville Cemetery
<b>Common Name:</b>	
<b>Address:</b>	Main Rd
<b>City/Town:</b>	Granville
<b>Village/Neighborhood:</b>	West Granville
<b>Local No:</b>	
<b>Year Constructed:</b>	1770
<b>Architect(s):</b>	
<b>Architectural Style(s):</b>	
<b>Use(s):</b>	Burial Ground
<b>Significance:</b>	Landscape Architecture; Religion
<b>Area(s):</b>	GRN.B: West Granville GRN.G: West Granville Historic District
<b>Designation(s):</b>	Nat'l Register District (11/05/1991)
<b>Building Materials(s):</b>	



The Massachusetts Historical Commission (MHC) has converted this paper record to digital format as part of ongoing projects to scan records of the Inventory of Historic Assets of the Commonwealth and National Register of Historic Places nominations for Massachusetts. Efforts are ongoing and not all inventory or National Register records related to this resource may be available in digital format at this time.

The MACRIS database and scanned files are highly dynamic; new information is added daily and both database records and related scanned files may be updated as new information is incorporated into MHC files. Users should note that there may be a considerable lag time between the receipt of new or updated records by MHC and the appearance of related information in MACRIS. Users should also note that not all source materials for the MACRIS database are made available as scanned images. Users may consult the records, files and maps available in MHC's public research area at its offices at the State Archives Building, 220 Morrissey Boulevard, Boston, open M-F, 9-5.

Users of this digital material acknowledge that they have read and understood the MACRIS Information and Disclaimer (<http://mhc-macris.net/macrisdisclaimer.htm>)

Data available via the MACRIS web interface, and associated scanned files are for information purposes only. THE ACT OF CHECKING THIS DATABASE AND ASSOCIATED SCANNED FILES DOES NOT SUBSTITUTE FOR COMPLIANCE WITH APPLICABLE LOCAL, STATE OR FEDERAL LAWS AND REGULATIONS. IF YOU ARE REPRESENTING A DEVELOPER AND/OR A PROPOSED PROJECT THAT WILL REQUIRE A PERMIT, LICENSE OR FUNDING FROM ANY STATE OR FEDERAL AGENCY YOU MUST SUBMIT A PROJECT NOTIFICATION FORM TO MHC FOR MHC'S REVIEW AND COMMENT. You can obtain a copy of a PNF through the MHC web site ([www.sec.state.ma.us/mhc](http://www.sec.state.ma.us/mhc)) under the subject heading "MHC Forms."

Commonwealth of Massachusetts  
Massachusetts Historical Commission  
220 Morrissey Boulevard, Boston, Massachusetts 02125  
[www.sec.state.ma.us/mhc](http://www.sec.state.ma.us/mhc)

This file was accessed on: Sunday, March 31, 2019 at 10:00 AM

FORM E - BURIAL GROUND

USGS W. Granville  
Sec B

NO. 11511 GRN. 802

AREA	FORM NO.
B 15	802

MASSACHUSETTS HISTORICAL COMMISSION  
80 BOYLSTON STREET  
BOSTON, MA 02116

Pl - W. Gran



Granville

1520

Main Road

West Granville Cemetery

Ship: x Public

Private

ESTIMATION

Estimated number of stones 300

Earliest death date 1770

Latest death date Still in use 1987

Landscape Architect (if known)

Condition Good

Acreage 1 acre

Setting Rural/Suburban

Sketch Map: Draw map showing property's location in relation to nearest cross streets and other buildings and/or geographical features. Indicate all buildings between inventoried property and nearest intersection. Indicate north.

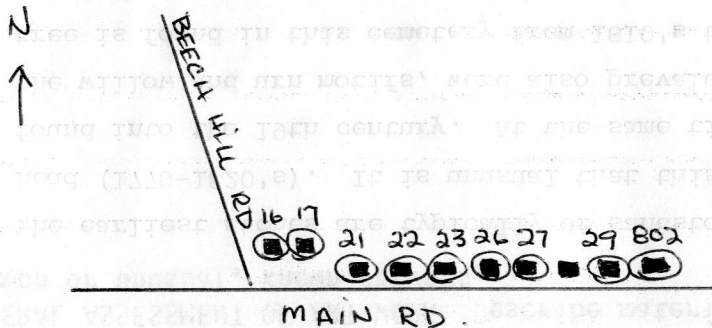

UTM REFERENCE \_\_\_\_\_

USGS QUADRANGLE West Granville

SCALE 1:25,000

Recorded by Joanne Keim - PVPC

Organization Granville Historic Commission

Date August 1987

NATIONAL REGISTER CRITERIA STATEMENT (if applicable)

GENERAL ASSESSMENT OF ART WORK Describe materials used, designs, motifs, symbols that are either common or unusual, known carvers.

The earliest stones are typically of sandstone either unadorned or carved with the death's head (1770-1820's). It is unusual that this medieval design would continue to be found into the 19th century. At the same time, more classical ornamentation, such as the willow and urn motifs, were also prevalent. An uncommon carving, the broken willow tree is found in this cemetery from 1810's to the 1830's. Obelisks of sandstone and granite are also prevalent from 1840-1890.

HISTORICAL SIGNIFICANCE Explain religious affiliations, major period of use and evaluate historical importance of burial ground within the community.

On March 27, 1787 Ezra Baldwin conveyed one acre of land to Middle Parish of Granville for £6. The deed specifies the land is to be used as a cemetery. Additional parcels were acquired in 1876, and 1884. In 1906, the West Granville Cemetery Association was formed for all matters relating to the cemetery. In 1825 the Town voted to purchase two hearses, one for East Parish and one for West Parish (which was the former Middle Parish).

BIBLIOGRAPHY and/or REFERENCES

- Registry of Deeds - 28/535
- Hampden County Atlas - 1912
- Wilson - History of Granville, p. 281

E	005
---	-----