

Massachusetts Cultural Resource Information System

Scanned Record Cover Page

| | |
|--------------------------------|--|
| Inventory No: | GRN.74 |
| Historic Name: | Barlow, R. House |
| Common Name: | |
| Address: | 488 Main Rd |
| City/Town: | Granville |
| Village/Neighborhood: | Granville |
| Local No: | |
| Year Constructed: | c 1840 |
| Architect(s): | |
| Architectural Style(s): | Greek Revival |
| Use(s): | Single Family Dwelling House |
| Significance: | Architecture |
| Area(s): | GRN.D: Granville Village GRN.F: Granville Village Historic District |
| Designation(s): | Nat'l Register District (11/05/1991) |
| Building Materials(s): | Wall: Glass; Wood; Wood Clapboard |



The Massachusetts Historical Commission (MHC) has converted this paper record to digital format as part of ongoing projects to scan records of the Inventory of Historic Assets of the Commonwealth and National Register of Historic Places nominations for Massachusetts. Efforts are ongoing and not all inventory or National Register records related to this resource may be available in digital format at this time.

The MACRIS database and scanned files are highly dynamic; new information is added daily and both database records and related scanned files may be updated as new information is incorporated into MHC files. Users should note that there may be a considerable lag time between the receipt of new or updated records by MHC and the appearance of related information in MACRIS. Users should also note that not all source materials for the MACRIS database are made available as scanned images. Users may consult the records, files and maps available in MHC's public research area at its offices at the State Archives Building, 220 Morrissey Boulevard, Boston, open M-F, 9-5.

Users of this digital material acknowledge that they have read and understood the MACRIS Information and Disclaimer (<http://mhc-macris.net/macrisdisclaimer.htm>)

Data available via the MACRIS web interface, and associated scanned files are for information purposes only. THE ACT OF CHECKING THIS DATABASE AND ASSOCIATED SCANNED FILES DOES NOT SUBSTITUTE FOR COMPLIANCE WITH APPLICABLE LOCAL, STATE OR FEDERAL LAWS AND REGULATIONS. IF YOU ARE REPRESENTING A DEVELOPER AND/OR A PROPOSED PROJECT THAT WILL REQUIRE A PERMIT, LICENSE OR FUNDING FROM ANY STATE OR FEDERAL AGENCY YOU MUST SUBMIT A PROJECT NOTIFICATION FORM TO MHC FOR MHC'S REVIEW AND COMMENT. You can obtain a copy of a PNF through the MHC web site (www.sec.state.ma.us/mhc) under the subject heading "MHC Forms."

Commonwealth of Massachusetts
Massachusetts Historical Commission
220 Morrissey Boulevard, Boston, Massachusetts 02125
www.sec.state.ma.us/mhc

This file was accessed on: Tuesday, February 20, 2018 at 5:37: PM

FORM B - BUILDING

MASSACHUSETTS HISTORICAL COMMISSION
80 BOYLSTON STREET
BOSTON, MA 02116

AREA DF FORM NO. 74

NADIS 115191 GRN.74

Pl-Granville



Granville
Address 488 Main Rd
Maple Street

Historic Name R. Barlow House

Present Residence

Original Residence

Description c.1840

View Visual

Style Greek Revival

Architect Unknown

Exterior Wall Fabric Clapboard

Outbuildings Attached Garage

Major Alterations (with dates) _____

Condition Good

Moved _____ Date _____

Acreage 3.0 acres

Setting Village

Sketch Map: Draw map showing property's location in relation to nearest cross streets and/or geographical features. Indicate all buildings between inventoried property and nearest intersection(s). Indicate north

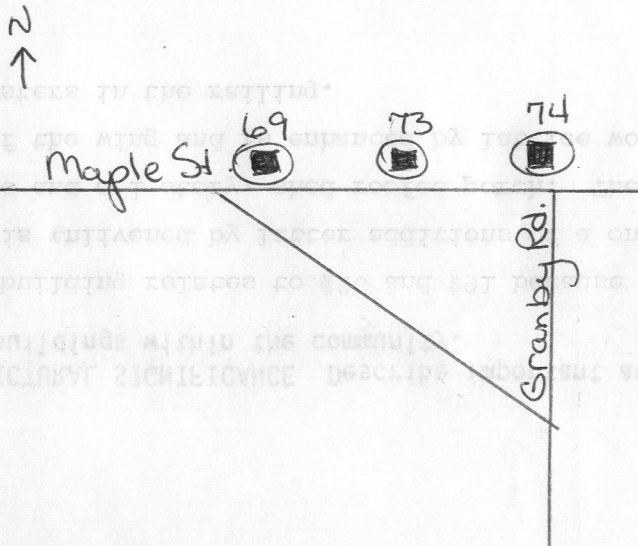

UTM REFERENCE _____

USGS QUADRANGLE Southwick

SCALE 1:25,000

Recorded by Joanne Keim - PVPC

Organization Granville Historic Commission

Date August 1987

PK-14

NATIONAL REGISTER CRITERIA STATEMENT (if applicable)

ARCHITECTURAL SIGNIFICANCE Describe important architectural features and evaluate in terms of other buildings within the community.

This building relates to #26 and #91 because of form. This 2-story gable-front-and-wing is enlivened by later additions of a one-story polygonal bay on the gable end facade and a 1-story, shed-roofed porch. The porch extends from east of the bay to the end of the wing and is enhanced by lattice work in the spindle valance and turned ballusters in the railing.

HISTORICAL SIGNIFICANCE Explain the role owners played in local or state history and how the building relates to the development of the community.

R. Barlow, a wealthy farmer was the occupant in 1855. He owned this property as well as #80 & #82 in 1855. A. Holcomb owned the property from 1870-1894.

BIBLIOGRAPHY and/or REFERENCES

Registry of Deeds - 2584/208
Hampden County Atlas - 1855, 1870, 1894, 1912

Table with 2 columns and 2 rows, containing faint text and numbers.