

Massachusetts Cultural Resource Information System

Scanned Record Cover Page

Inventory No:	GRN.C
Historic Name:	
Common Name:	Granville Center
Address:	
City/Town:	Granville
Village/Neighborhood:	Granville Center
Local No:	
Year Constructed:	
Architect(s):	
Architectural Style(s):	
Use(s):	Other Governmental or Civic; Residential District
Significance:	
Area(s):	
Designation(s):	
Building Materials(s):	

Digital Photo
Not Yet
Available

The Massachusetts Historical Commission (MHC) has converted this paper record to digital format as part of ongoing projects to scan records of the Inventory of Historic Assets of the Commonwealth and National Register of Historic Places nominations for Massachusetts. Efforts are ongoing and not all inventory or National Register records related to this resource may be available in digital format at this time.

The MACRIS database and scanned files are highly dynamic; new information is added daily and both database records and related scanned files may be updated as new information is incorporated into MHC files. Users should note that there may be a considerable lag time between the receipt of new or updated records by MHC and the appearance of related information in MACRIS. Users should also note that not all source materials for the MACRIS database are made available as scanned images. Users may consult the records, files and maps available in MHC's public research area at its offices at the State Archives Building, 220 Morrissey Boulevard, Boston, open M-F, 9-5.

Users of this digital material acknowledge that they have read and understood the MACRIS Information and Disclaimer (<http://mhc-macris.net/macrisdisclaimer.htm>)

Data available via the MACRIS web interface, and associated scanned files are for information purposes only. THE ACT OF CHECKING THIS DATABASE AND ASSOCIATED SCANNED FILES DOES NOT SUBSTITUTE FOR COMPLIANCE WITH APPLICABLE LOCAL, STATE OR FEDERAL LAWS AND REGULATIONS. IF YOU ARE REPRESENTING A DEVELOPER AND/OR A PROPOSED PROJECT THAT WILL REQUIRE A PERMIT, LICENSE OR FUNDING FROM ANY STATE OR FEDERAL AGENCY YOU MUST SUBMIT A PROJECT NOTIFICATION FORM TO MHC FOR MHC'S REVIEW AND COMMENT. You can obtain a copy of a PNF through the MHC web site (www.sec.state.ma.us/mhc) under the subject heading "MHC Forms."

Commonwealth of Massachusetts
Massachusetts Historical Commission
220 Morrissey Boulevard, Boston, Massachusetts 02125
www.sec.state.ma.us/mhc

This file was accessed on: Saturday, March 30, 2019 at 11:17 AM

Area Letter Form numbers in this Area

C	38 - 60, 803, 804, 905
---	------------------------

MASSACHUSETTS HISTORICAL COMMISSION
80 BOYLSTON STREET, BOSTON, MA 02116

"Jockey Corners"

Town Granville

Name of Area (if any) Blandford Rd.,
Trumble Place Granville
Center

Present Use Residential/Civic

Photos (3"x3" or 3"x5" black & white) Indicate on back of each photo street addresses for buildings shown. Staple to left side of form.

General Date or Period 1770 - 1930

General Condition Good

Acreage _____

Recorded by Joanne Keim - PVPC

Organization Granville Historic Commission

Date August 1987

Sketch Map. Draw a general map of the area indicating properties within it. Number each property for which individual inventory forms have been completed. Label streets including route numbers, if any. Indicate north. (Attach a separate sheet if space here is not sufficient).

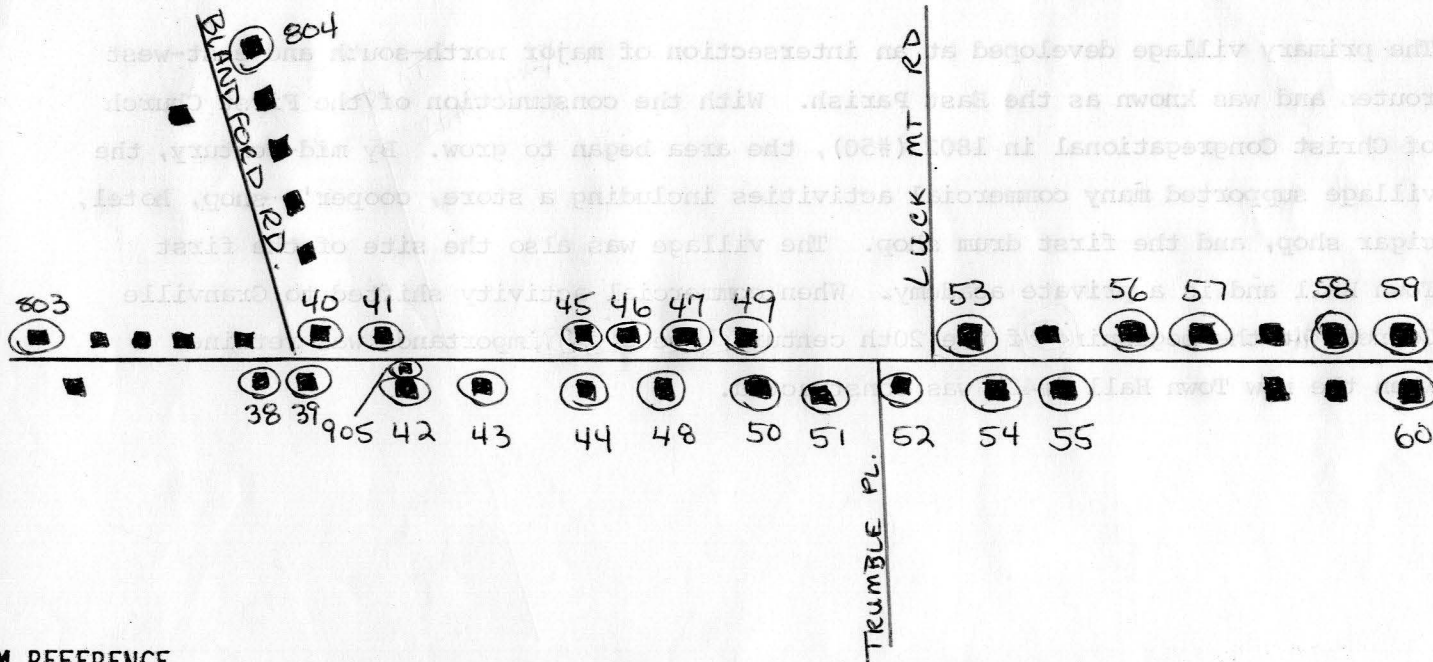

UTM REFERENCE _____

 USGS QUADRANGLE West Granville
 SCALE 1:25,000

NATIONAL REGISTER CRITERIA STATEMENT (if applicable)

ARCHITECTURAL SIGNIFICANCE Describe important architectural features and evaluate in terms of other areas within the community.

The Granville Center area is defined by a cluster of early 19th century residences and a Church many of which are the best examples of the Federal style in Granville (#43, #45, #47, #48, #50, #58). By 1850, conservative building plans had given way to the Greek Revival style (#41, #54, #55, #59). The Stowe House (#44), located here is the only example of a Gothic Cottage in Granville. Later infill consists of the Christopher Sauer House (#49) and two bungalows #38 and #40. The area retained its identity as the primary town center with the construction of the new town hall in 1927 (#42).

HISTORICAL SIGNIFICANCE Explain historical importance of area and how the area relates to the development of other areas of the community.

The primary village developed at an intersection of major north-south and east-west routes and was known as the East Parish. With the construction of the First Church of Christ Congregational in 1802 (#50), the area began to grow. By mid-century, the village supported many commercial activities including a store, cooper's shop, hotel, cigar shop, and the first drum shop. The village was also the site of the first Town Hall and a private academy. When commercial activity shifted to Granville village at the beginning of the 20th century, the area's importance was retained when the new Town Hall (#42) was constructed.

BIBLIOGRAPHY and/or REFERENCES

Wilson - History of Granville

FORM A - AREA AND SITE SURVEY
MASSACHUSETTS HISTORICAL COMMISSION
Office of the Secretary, State House, Boston

6. Please comment on the Historical or Architectural importance of this area:

- 1. Town Granville
- 2. Name of area or section Granville Center
- 3. General Date or Period Federal
- 4. Is the area uniform? _____
 In style no
 In condition yes
 In type of ownership yes
 In use (Explain) yes - largely residential
- 5. Is area potentially threatened? _____
 By Zoning no
 By Roads yes - Rte 57
 By Developers no
 By Deterioration no

7. Draw a general map of the area involved. Please indicate in red any known historic sites on which individual reports are contemplated on Form B. Indicate street boundaries of area and any route numbers.

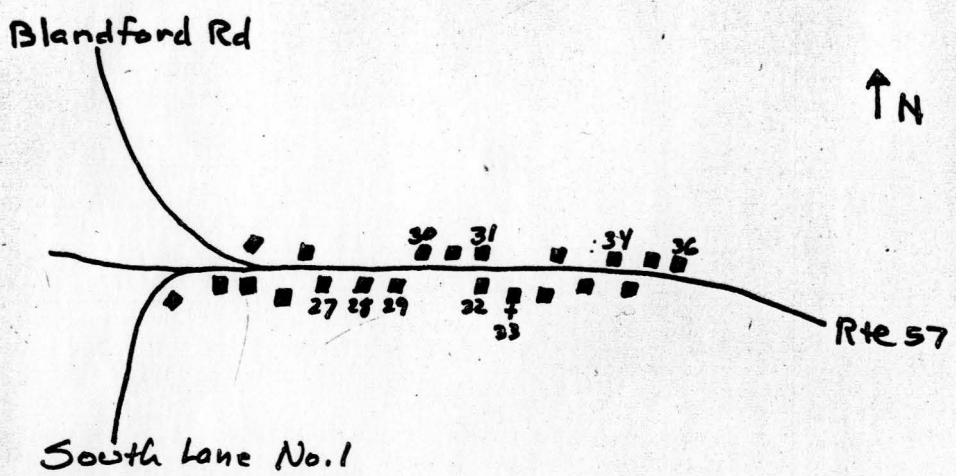

Recorder AMB

For LPVPPC
(Name of Organization)

--	--

NOTE: Recorder should obtain written permission from Commission or sponsoring organization before using this form.

USGS - W. Granville (163)