

Massachusetts Cultural Resource Information System

Scanned Record Cover Page

Inventory No:	GRN.3
Historic Name:	Robinson, K. C. House
Common Name:	
Address:	768 Beech Hill Rd
City/Town:	Granville
Village/Neighborhood:	
Local No:	
Year Constructed:	c 1830
Architect(s):	
Architectural Style(s):	Greek Revival
Use(s):	Single Family Dwelling House
Significance:	Architecture
Area(s):	GRN.A: Maple Corners
Designation(s):	
Building Materials(s):	Wall: Wood; Wood Clapboard



The Massachusetts Historical Commission (MHC) has converted this paper record to digital format as part of ongoing projects to scan records of the Inventory of Historic Assets of the Commonwealth and National Register of Historic Places nominations for Massachusetts. Efforts are ongoing and not all inventory or National Register records related to this resource may be available in digital format at this time.

The MACRIS database and scanned files are highly dynamic; new information is added daily and both database records and related scanned files may be updated as new information is incorporated into MHC files. Users should note that there may be a considerable lag time between the receipt of new or updated records by MHC and the appearance of related information in MACRIS. Users should also note that not all source materials for the MACRIS database are made available as scanned images. Users may consult the records, files and maps available in MHC's public research area at its offices at the State Archives Building, 220 Morrissey Boulevard, Boston, open M-F, 9-5.

Users of this digital material acknowledge that they have read and understood the MACRIS Information and Disclaimer (<http://mhc-macris.net/macrisdisclaimer.htm>)

Data available via the MACRIS web interface, and associated scanned files are for information purposes only. THE ACT OF CHECKING THIS DATABASE AND ASSOCIATED SCANNED FILES DOES NOT SUBSTITUTE FOR COMPLIANCE WITH APPLICABLE LOCAL, STATE OR FEDERAL LAWS AND REGULATIONS. IF YOU ARE REPRESENTING A DEVELOPER AND/OR A PROPOSED PROJECT THAT WILL REQUIRE A PERMIT, LICENSE OR FUNDING FROM ANY STATE OR FEDERAL AGENCY YOU MUST SUBMIT A PROJECT NOTIFICATION FORM TO MHC FOR MHC'S REVIEW AND COMMENT. You can obtain a copy of a PNF through the MHC web site (www.sec.state.ma.us/mhc) under the subject heading "MHC Forms."

Commonwealth of Massachusetts
Massachusetts Historical Commission
220 Morrissey Boulevard, Boston, Massachusetts 02125
www.sec.state.ma.us/mhc

This file was accessed on: Sunday, February 18, 2018 at 7:48: PM

FORM B - BUILDING

USGS Blanford

GRN.3

MASSACHUSETTS HISTORICAL COMMISSION
80 BOYLSTON STREET
BOSTON, MA 02116

AREA

FORM NO.

A	3
---	---



Granville
 768
 Beech Hill Rd
 Name K. C. Robinson
 House
 Present Residence
 Original Residence
 ION
 C. 1830
 Visual/Maps
 Greek Revival
 t Unknown

Sketch Map: Draw map showing property's location in relation to nearest cross streets and/or geographical features. Indicate all buildings between inventoried property and nearest intersection(s). Indicate north

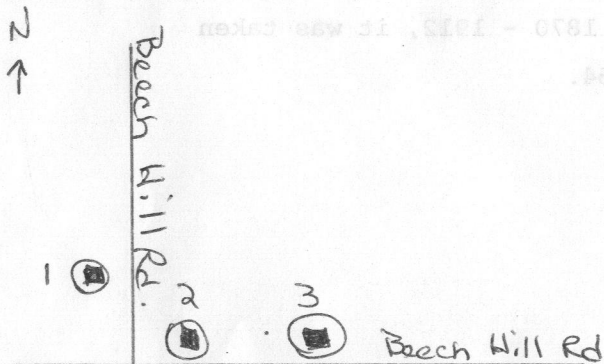

Exterior Wall Fabric Clapboard

Outbuildings 3 barns

Major Alterations (with dates)

Condition Good

Moved _____ Date _____

Acreeage 7.0 acres

Setting

Rural intact farm complex

UTM REFERENCE _____

USGS QUADRANGLE West Granville

SCALE 1:25,000

Recorded by Joanne Keim, PVPC

Organization Granville Historical Commission

Date August 1987

NATIONAL REGISTER CRITERIA STATEMENT (if applicable)

ARCHITECTURAL SIGNIFICANCE Describe important architectural features and evaluate in terms of other buildings within the community.

This 2-story, gable-front and wing building is related to buildings #23, #41 and #93 by design. Typically these houses were often expanded from a 1-story wing. Main block features include a door surround consisting of pilasters supporting a full entablature. The wing features a large central chimney and attic story windows mimicking frieze band windows on high style Greek Revival buildings.

HISTORICAL SIGNIFICANCE Explain the role owners played in local or state history and how the building relates to the development of the community.

This is another building in the small community that formed at the northern reaches of Granville on the road to Blandford in the Beech Hill area. In 1855, K. C. Robinson owned the property; from 1870 - 1912, it was taken over by J. A. Robinson who was a selectman in 1864.

BIBLIOGRAPHY and/or REFERENCES

- Registry of Deeds 2917/307
- Hampden County Atlas - 1855 and 1870, 1894 and 1912
- Wilson, History of Granville, pg 314