

# Historic Salem incorporated

7 CAMBRIDGE STREET SALEM, MASSACHUSETTS 01970 / PHONE (508) 745-0799

12 NORTHEY STREET

Built for

SAMUEL KEMP, sailmaker

circa 1845

Research by  
Northfields Preservation Associates  
June, 1989

12 NORTHEY STREET

BOOK 238 PAGE 242

DATE- October 7, 1825

CONSIDERATION- \$3,300

GRANTOR (seller)- George K. Smith, master mariner

GRANTEE (buyer)- Joseph Beadle, master mariner

DESCRIPTION- Lot of land at Bridge and Northey Streets  
(please see diagram)

CHAIN- Being the same land conveyed to Smith by  
four deeds: from Benjamin Cheever, October  
30, 1820, book 225, page 168; from Hannah  
Hale, June 16, 1823, book 232, page 154;  
from Hannah Hale, May 10, 1824, book 236,  
page 1; and from Asa Lamson, jr., June 14,  
1825, book 230, page 151.

BOOK 360 PAGE 55

DATE- October 28, 1845

CONSIDERATION- \$1,400

GRANTOR- Joseph Beadle, merchant

GRANTEE- Samuel Kemp, sailmaker

DESCRIPTION- A certain parcel of land (please see  
diagram) These are the current boundaries  
of 12 Northey Street.

CHAIN- none, but the lot is part of the larger  
conveyed above.

BOOK 403 PAGE 230

DATE- October 31, 1848

CONSIDERATION- \$2,500

GRANTOR- The heirs of Joseph Beadle, merchant

GRANTEE- Samuel Kemp

BOOK 403 PAGE 230 CONT'D

DESCRIPTION- The large lot originally conveyed from Smith to Beadle, "excepting the previous land transaction" recorded in book 360, page 55.

CHAIN- Being the same land conveyed by George to Joseph Beadle October 7, 1825 in book 238, page 242.

BOOK 417 PAGE 203

DATE- September 19, 1849

CONSIDERATION- \$2,475

GRANTOR- Samuel Kemp, sailmaker

GRANTEE- Joseph H. Millett

DESCRIPTION- Land, dwelling house and outbuildings with same boundaries as book 360, page 55.

CHAIN- none

BOOK 826 PAGE 111

DATE- May 8, 1871

CONSIDERATION- \$5,500

GRANTOR- Mary Millett, widow, Joseph H. Millett and Edward Millett

GRANTEE- Eliza Dole, widow

DESCRIPTION- same

CHAIN- Being the same premises conveyed by Samuel Kemp to Joseph H. Millett, deceased, husband of Mary, father of Joseph and Edward, in book 417, page 203.

BOOK 1171 PAGE 256

DATE- April 20, 1886

BOOK 1171 PAGE 256 CONT'D

CONSIDERATION- \$3,750  
GRANTOR- Hannah Dole  
GRANTEE- Howard Harris  
DESCRIPTION- same  
CHAIN- Being the same premises conveyed by Mary Millett et.al. to Eliza Dole in book 826, page 111.

BOOK 2374 PAGE 522

DATE- September 18, 1917  
CONSIDERATION- no amount specified  
GRANTOR- Howard Harris, widower, as heir of Edward Harris, his deceased son, and Carrie Harris, his deceased wife (Carrie had paid Howard's mortgage and received the title in her name in 1888; the remainder of the title's heirs sell their interest in the land in the same book, page 523).  
GRANTEE- James T. Mooney  
DESCRIPTION- same

BOOK 2610 PAGE 430

DATE- September 15, 1924  
CONSIDERATION- no amount specified  
GRANTOR- Mary E. Mooney (wife of James)  
GRANTEE- Albert C. and Mary F. Mooney  
DESCRIPTION- same

BOOK 2902 PAGE 427

DATE- November 13, 1931

BOOK 2902 PAGE 427 CONT'D

CONSIDERATION- no amount specified  
GRANTOR- Albert C. and Mary Mooney  
GRANTEE- Elizabeth G. Hannon  
DESCRIPTION- same

BOOK 3070 PAGE 440

DATE- April 24, 1936  
CONSIDERATION- \$1.00  
GRANTOR- Elizabeth Hannon  
GRANTEE- Mary E. Mooney  
DESCRIPTION- same

BOOK 3070 PAGE 441

DATE- April 24, 1931  
CONSIDERATION- \$1.00  
GRANTOR- Mary E. Mooney  
GRANTEE- Elizabeth Hannon and Mary Hyde, joint  
tenants  
DESCRIPTION- same

BOOK 3775 PAGE 36

DATE- October 6, 1950  
CONSIDERATION- no amount specified  
GRANTOR- Mary Hyde  
GRANTEE- Harold and Hannah Hodgdon  
DESCRIPTION- same

SAUNDERS ST.

ST.

ARAB

E. Hefferman  
Geo. Morse  
Geo. Doherty  
Mrs. Silvers  
Mrs. [unclear]  
Mrs. [unclear]  
Geo. J. Upton  
Upton  
Honeycomb & Upton

G. I. Streeter

Nelson

T. O. Leary  
Geo. Chase  
Jas. W. Clement  
Samuel S. Skinner  
J. A. Smiley  
Mrs. J. F. Bedee  
A. Story  
H. O. Upton  
Jos. Marden  
Jos. Foster

Heirs of W. B. & F. Johnson  
H. O. Upton  
G. Barton  
Charles Endicott  
Geo. D. Phippen  
Jos. H. Phippen

Tibbets

Jas. A. Smith  
Mrs. E. Shaw  
Mrs. E. Shaw  
B. McShane  
G. S. Light  
Salem Light Company  
Mrs. E. Shaw  
B. McShane  
B. McShane  
Wm. Murphy  
Mrs. S. E. Appleton  
Wm. Honeycomb  
Wm. H. Honeycomb  
Wm. H. Honeycomb  
Wm. H. Dodge

Heirs of W. B. & F. Johnson  
H. O. Upton  
G. Barton  
Charles Endicott  
Geo. D. Phippen  
Jos. H. Phippen

Hodgk

Jas. A. Smith  
Mrs. E. Shaw  
Mrs. E. Shaw  
B. McShane  
G. S. Light  
Salem Light Company  
Mrs. E. Shaw  
B. McShane  
B. McShane  
Wm. Murphy  
Mrs. S. E. Appleton  
Wm. Honeycomb  
Wm. H. Honeycomb  
Wm. H. Honeycomb  
Wm. H. Dodge

Heirs of W. B. & F. Johnson  
H. O. Upton  
G. Barton  
Charles Endicott  
Geo. D. Phippen  
Jos. H. Phippen

Hodgk

Jas. A. Smith  
Mrs. E. Shaw  
Mrs. E. Shaw  
B. McShane  
G. S. Light  
Salem Light Company  
Mrs. E. Shaw  
B. McShane  
B. McShane  
Wm. Murphy  
Mrs. S. E. Appleton  
Wm. Honeycomb  
Wm. H. Honeycomb  
Wm. H. Honeycomb  
Wm. H. Dodge

Heirs of W. B. & F. Johnson  
H. O. Upton  
G. Barton  
Charles Endicott  
Geo. D. Phippen  
Jos. H. Phippen

Hodgk

Jas. A. Smith  
Mrs. E. Shaw  
Mrs. E. Shaw  
B. McShane  
G. S. Light  
Salem Light Company  
Mrs. E. Shaw  
B. McShane  
B. McShane  
Wm. Murphy  
Mrs. S. E. Appleton  
Wm. Honeycomb  
Wm. H. Honeycomb  
Wm. H. Honeycomb  
Wm. H. Dodge

Heirs of W. B. & F. Johnson  
H. O. Upton  
G. Barton  
Charles Endicott  
Geo. D. Phippen  
Jos. H. Phippen

Hodgk

Jas. A. Smith  
Mrs. E. Shaw  
Mrs. E. Shaw  
B. McShane  
G. S. Light  
Salem Light Company  
Mrs. E. Shaw  
B. McShane  
B. McShane  
Wm. Murphy  
Mrs. S. E. Appleton  
Wm. Honeycomb  
Wm. H. Honeycomb  
Wm. H. Honeycomb  
Wm. H. Dodge

Heirs of W. B. & F. Johnson  
H. O. Upton  
G. Barton  
Charles Endicott  
Geo. D. Phippen  
Jos. H. Phippen

Hodgk

Jas. A. Smith  
Mrs. E. Shaw  
Mrs. E. Shaw  
B. McShane  
G. S. Light  
Salem Light Company  
Mrs. E. Shaw  
B. McShane  
B. McShane  
Wm. Murphy  
Mrs. S. E. Appleton  
Wm. Honeycomb  
Wm. H. Honeycomb  
Wm. H. Honeycomb  
Wm. H. Dodge

Heirs of W. B. & F. Johnson  
H. O. Upton  
G. Barton  
Charles Endicott  
Geo. D. Phippen  
Jos. H. Phippen

Hodgk

Jas. A. Smith  
Mrs. E. Shaw  
Mrs. E. Shaw  
B. McShane  
G. S. Light  
Salem Light Company  
Mrs. E. Shaw  
B. McShane  
B. McShane  
Wm. Murphy  
Mrs. S. E. Appleton  
Wm. Honeycomb  
Wm. H. Honeycomb  
Wm. H. Honeycomb  
Wm. H. Dodge

Heirs of W. B. & F. Johnson  
H. O. Upton  
G. Barton  
Charles Endicott  
Geo. D. Phippen  
Jos. H. Phippen

Hodgk

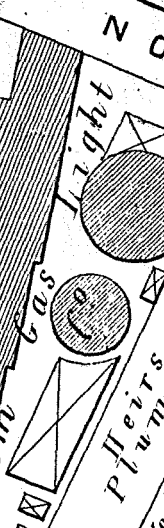
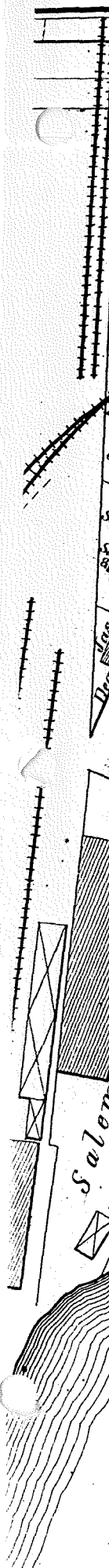

BOOK 6545 PAGE 323

DATE- December 4, 1978  
CONSIDERATION- \$41,000  
GRANTOR- Hannah Hodgdon  
GRANTEE- Robert and Nancy Murphy and Helen Connolly  
DESCRIPTION- 12 Northey Street  
CHAIN- Being the same premises conveyed by Mary Hyde to Harold Hodgdon in book 3775, page 36

BOOK 7525 PAGE 69

DATE- October 7, 1981  
CONSIDERATION- \$65,500  
GRANTOR- Robert and Nancy Murphy and Helen Connolly  
GRANTEE- Michael and Debra Beatty  
DESCRIPTION- 12 Northey Street  
CHAIN- Being the same premises conveyed by Hannah Hodgdon in book 6545, page 323

BOOK 7525 PAGE 70

DATE- September 17, 1984  
CONSIDERATION- \$97,500  
GRANTOR- Michael and Debra Beatty  
GRANTEE- Jeffrey and Carmen Pope  
DESCRIPTION- 12 Northey Street  
CHAIN- none

BOOK 9859 PAGE 46

DATE- January 13, 1989

BOOK 9859 PAGE 46 CONT'D

CONSIDERATION-	\$165,500
GRANTOR-	Jeffrey and Carmen Pope
GRANTEE-	Marc and Eileen Tishler
DESCRIPTION-	12 Northey Street
CHAIN-	Being the same premises conveyed by Michael and Debra Beatty in book 7525, page 70

TAX VALUATION RECORDS

1844- Samuel Kemp is not taxed for any real estate; his address is 5 Northey Street.

Joseph Beadle is taxed for one house (presumably his residence at 102 Bridge Street, now 126-8 Bridge Street), value \$2,000.

1845- Samuel Kemp is not taxed for any real estate; his address is 4 Northey Street.

1846- Samuel Kemp is taxed for a house, value \$1,600; his address is 4 1/2 Northey Street.



#### SUMMARY

Joseph Beadle owned a tract of land on Bridge and Northey Streets including one dwelling house, now 126-128 Bridge Street. Beadle sold the lot upon which 12 Northey Street now stands to Samuel Kemp in 1845, with mention of no house. The Milletts are listed as residents of Northey Street in the 1846 Salem directory; in 1849 they bought the house from Kemp. Therefore, the house was probably standing in 1846, and apparently was not in 1845. Samuel Kemp is first taxed for a house in 1846; the value of the house for which Kemp is taxed was \$1,600. Kemp's address at the time was 4 1/2 Northey Street, possibly this house.

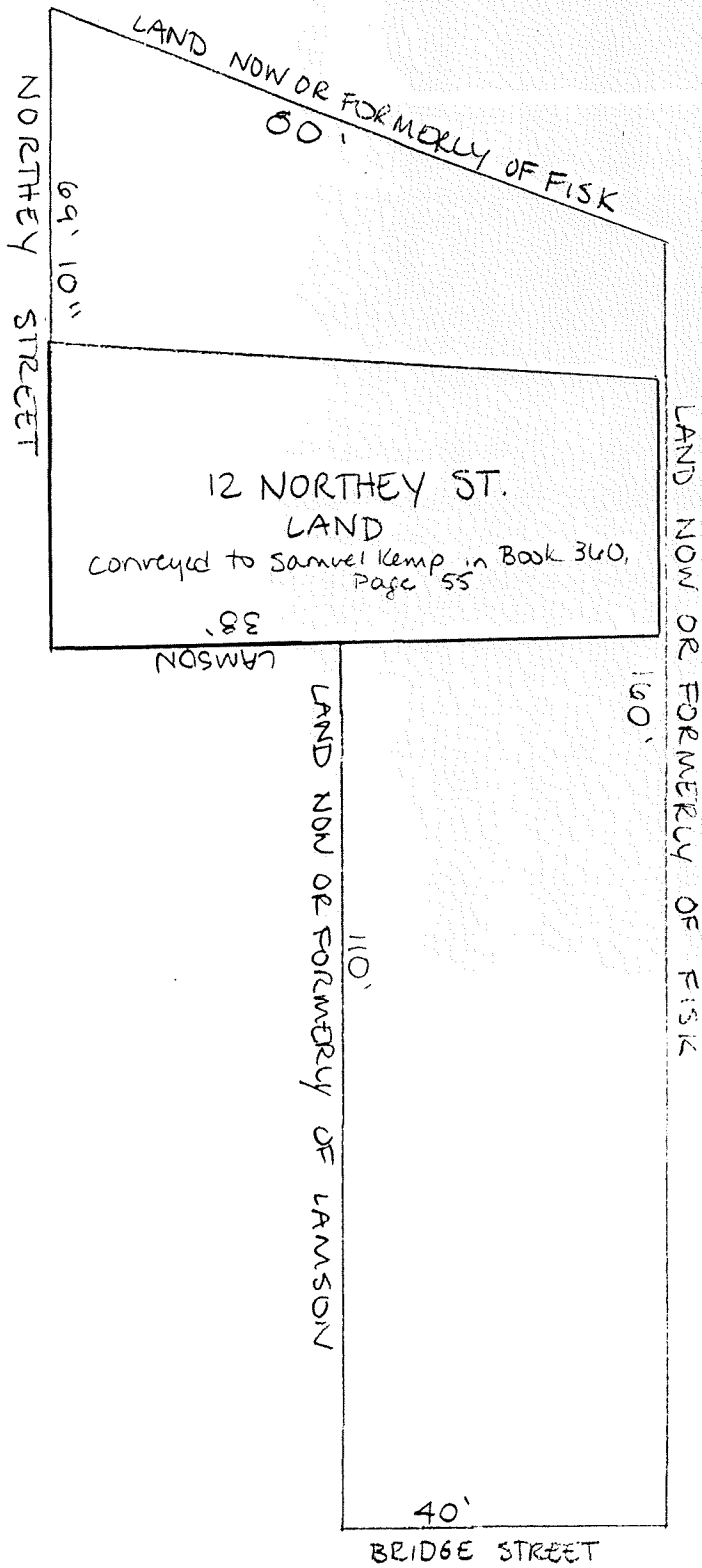

BOOK 238, PAGE 242  
conveyed to Joseph Beadle  
October 7, 1825

MASSACHUSETTS HISTORICAL COMMISSION  
80 BOYLSTON STREET  
BOSTON, MA 02116



City Salem

Address 12 Northey St.

Historic Name \_\_\_\_\_

Use: Present Residential

Original Residential

DESCRIPTION

Date By 1846

Source City Directories

Style Greek Revival

Architect \_\_\_\_\_

Exterior Wall Fabric Flushboarding, clapboards

Outbuildings \_\_\_\_\_

Major Alterations (with dates) \_\_\_\_\_

Condition Fair

Moved \_\_\_\_\_ Date \_\_\_\_\_

Acreage Under 1 acre

Setting Residential, urban

Recorded by Debra Hilbert & Kim Wit Brengle

Organization Salem Planning Dept.

Date April, 1987

Sketch Map: Draw map showing property's location in relation to nearest cross streets and/or geographical features. Indicate all buildings between inventoried property and nearest intersection(s). Indicate north

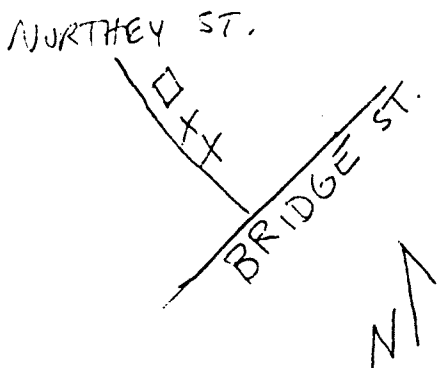

UTM REFERENCE \_\_\_\_\_

USGS QUADRANGLE \_\_\_\_\_

SCALE \_\_\_\_\_

## NATIONAL REGISTER CRITERIA STATEMENT (if applicable)

**ARCHITECTURAL SIGNIFICANCE** Describe important architectural features and evaluate in terms of other buildings within the community.

The sidehall Greek Revival house with gable end to the street was common in Salem in the 1840s and 1850s; 12 Northey Street is a well-preserved and handsomely-detailed example of this house type. The facade is sheathed in flush boards, while all other elevations are clapboarded. The entry is at the westernmost bay of the facade, and consists of a panelled door framed by sidelights and a transom, and sheltered by a shallow portico with fluted Tuscan columns. Above the entry is a second-story panelled bay. Window frames at the facade have corner blocks, with the exception of the segmental arched window in the pedimented gable end. A deep entablature encircles the house. Other features include a granite foundation and sill and corner boards.

**HISTORICAL SIGNIFICANCE** Explain the role owners played in local or state history and how the building relates to the development of the community.

Northey Street was laid out between Bridge Street and the North River in 1807 by Moses Hale and Abijah and Ezra Northey through land owned by the Northey family for many years. 12 Northey Street is representative of the numerous mid-sized Greek Revival houses of the mid-19th century. It is first listed in the Salem Directory of 1846, when it was occupied by Joseph H. Millett, captain, and Edward A. Millett, clerk at Webb's Wharf. In 1851 the house was owned by C.H. Millet, and in 1874, Mrs. E. Dole owned it.

## BIBLIOGRAPHY and/or REFERENCES

City Directories, 1837, 1842, 1846, 1851  
1851 Map  
1874 Atlas