

Historic Salem incorporated

OFFICE AT OLD TOWN HALL

POST OFFICE BOX 865 SALEM, MASSACHUSETTS 01970 / PHONE (617) 745-0799

11 OLIVER STREET

Built by

MILES SEARLE, housewright

circa 1810

Research by,
Joyce King
February 1987

*"to preserve Historic Sites, Buildings and objects,
and to work for the education of the community
in the true value of the same."*

11 - 13 OLIVER STREET

BOOK 186 PAGE 56

DATE - April 17, 1809

CONSIDERATION - \$500

GRANTOR (seller) - Isaac and Elizabeth Killam

GRANTEE (buyer) - Miles Searle, housewright

DESCRIPTION - Lot of land

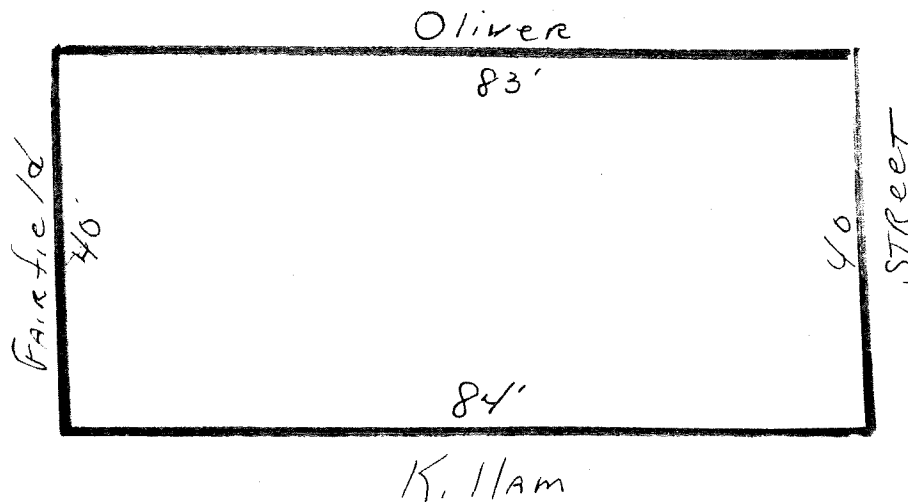

BOOK 194 PAGE 296

DATE - October 5, 1811
CONSIDERATION - \$1,700
GRANTOR (seller) - Miles Searl housewright
GRANTEE (buyer) - Thomas Lamson
DESCRIPTION - Lot of land with dwelling house and other buildings
PREVIOUS REFERENCE - The same conveyed in deed recorded in book 186 page 56.

BOOK 199 PAGE 142

DATE - February 27, 1813
CONSIDERATION - \$1,000
GRANTOR (seller) - Thomas Lamson, merchant
GRANTEE (buyer) - Benjamin Swett
DESCRIPTION - Lot and land, dwelling house and other buildings
PREVIOUS REFERENCE - "The same I purchased of Miles Searle" as recorded in book 194 page 296.

BOOK 234 PAGE 206

DATE - November 29, 1823
CONSIDERATION - \$200
GRANTOR (seller) - Thomas Lamson late of Salem, now of Boston, trader
GRANTEE (buyer) - John Burley late of Beverly, now of Salem
DESCRIPTION - Land and dwelling house
PREVIOUS REFERENCE - The same Benjamin Swett by bond reconveyed to me and premises are now subject to payment.

BOOK 234 PAGE 206

DATE - January 15, 1824

CONSIDERATION - \$1,000

GRANTOR (seller) - Sarah Swett of Andover, widow of Benjamin Swett late of Andover

GRANTEE (buyer) - John Burley

DESCRIPTION - Land and dwelling house

PREVIOUS REFERENCE - The same Thomas Lamson conveyed to Benjamin Swett on February 27, 1813. Benjamin bequeathed by will to Sarah.

BOOK 255 PAGE 215

DATE - February 19, 1830

CONSIDERATION - \$250

GRANTOR (seller) - John Burley Esq.

GRANTEE (buyer) - Proprietors of the Tabernacle Church

DESCRIPTION - Messuage on Oliver Street

PREVIOUS REFERENCE - Being all the land conveyed by deed of Sarah Swett on January 15, 1824 and from Thomas Lamson on November 29, 1823. Also by Ezekiel Savage, guardian of Peter Oliver on January 15, 1824. Except so much as taken into street.

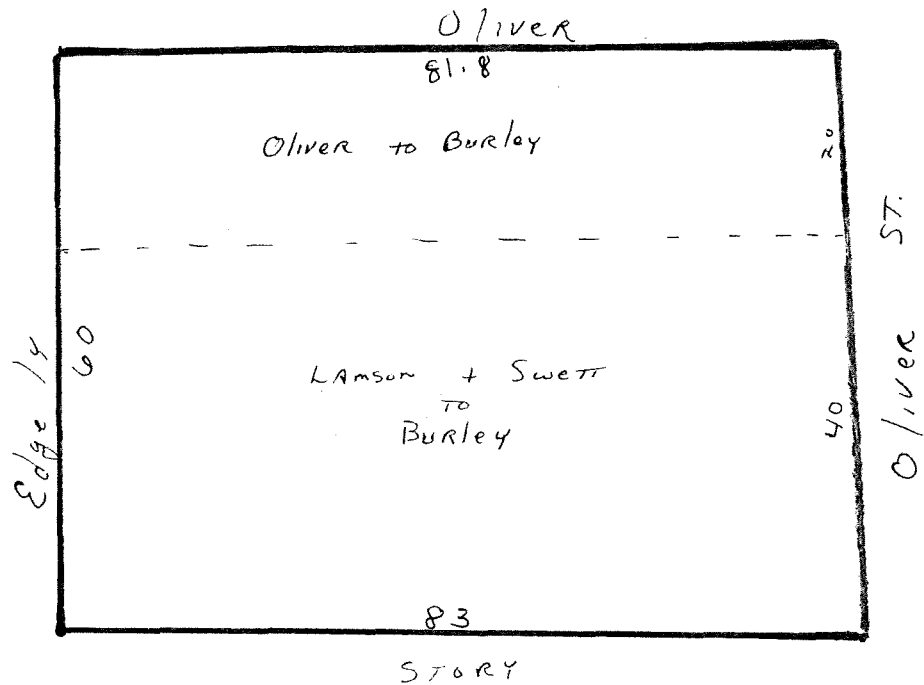

BOOK 255 PAGE 217

DATE - February 20, 1830

CONSIDERATION - \$2,200

GRANTOR (seller) - Proprietors of the Tabernacle Church

GRANTEE (buyer) - Hannah Brown widow

DESCRIPTION - Messuage

PREVIOUS REFERENCE - The same we have purchased of John Burley land, dwelling house and other buildings. Except so much as taken into street.

BOOK 821 PAGE 99

DATE - April 22, 1871
CONSIDERATION - \$3,475
GRANTOR (seller) - Francis Brown
GRANTEE (buyer) - Frances Fielden
DESCRIPTION - Land, dwelling house 11 Oliver St.
PREVIOUS REFERENCE - Being the same estate conveyed by the proprietors of the Tabernacle to my mother Hannah Brown, now deceased, and of whose estate I am sole heir.

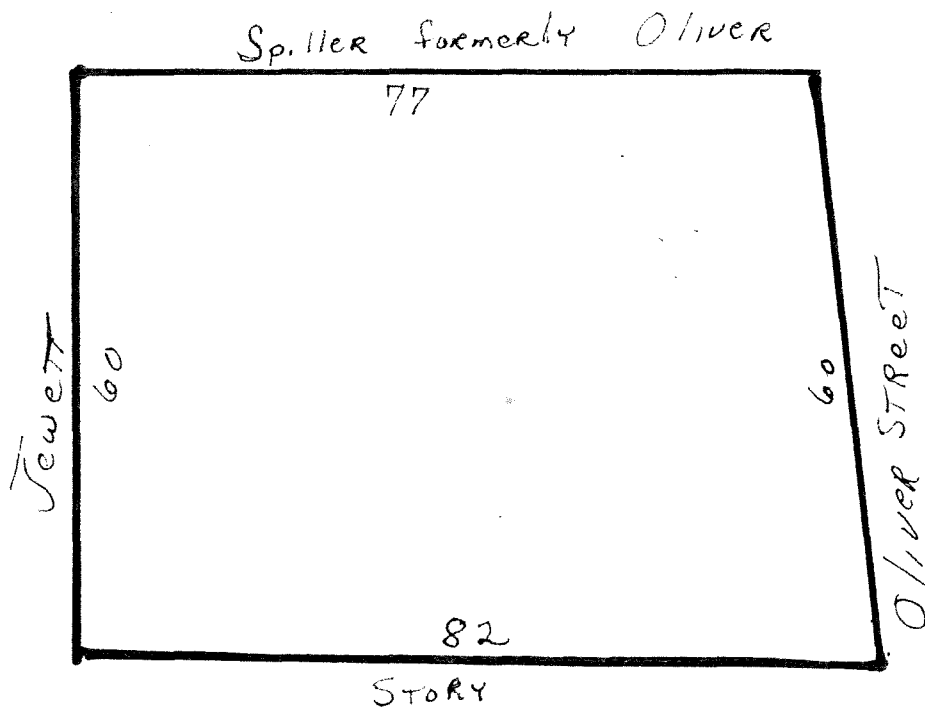

BOOK 1275 PAGE 66

DATE - April 12, 1890
CONSIDERATION - None given
GRANTOR (seller) - Frances Fielden of Methuen
GRANTEE (buyer) - Clara W. Burnham
DESCRIPTION - Land and dwelling house
PREVIOUS REFERENCE - Being the same conveyed by deed of Francis Brown on April 22, 1871

BOOK 1312 PAGE 246

DATE - June 9, 1891
CONSIDERATION - \$1 and other valuable consideration
GRANTOR (seller) - Horace and Clara Burnham
GRANTEE (buyer) - Margaret Fielden
DESCRIPTION - Land and dwelling house
PREVIOUS REFERENCE - Being the estate conveyed by Frances Fielden on April 12, 1890

BOOK 1635 PAGE 494

DATE - March 11, 1901
CONSIDERATION - \$3,200
GRANTOR (seller) - Margaret H. Fielden of Methuen
GRANTEE (buyer) - The Essex County Homeopathic Hospital
DESCRIPTION - Land and buildings
PREVIOUS REFERENCE - Being the same premises conveyed to Margaret by Clara W. Burnham et ux on June 9, 1891.

BOOK 1790 PAGE 42

DATE - August 15, 1905
CONSIDERATION - \$2892.50
GRANTOR (seller) - Essex County Homeopathic Hospital
GRANTEE (buyer) - Harry Albert
DESCRIPTION - Land and buildings at 11 Oliver St.
PREVIOUS REFERENCE - Being the same premises conveyed by Margaret Fielden on March 11, 1901.

BOOK 2845 PAGE 141

DATE - May 23, 1930
CONSIDERATION - None given
GRANTOR (seller) - Harry and Tina Albert
GRANTEE (buyer) - Anna L Russell
DESCRIPTION - Land and buildings at 11 Oliver St.
PREVIOUS REFERENCE - Being the same premises conveyed by deed of the Essex County Homeopathic Hospital on August 15, 1905.

BOOK 4616 PAGE 313

DATE - November 2, 1959
CONSIDERATION - Less than \$100
GRANTOR (seller) - Anna Louise Russell widow of Henry
GRANTEE (buyer) - Ann Louise Russell and Jane R. Brown
DESCRIPTION - Land and buildings
PREVIOUS REFERENCE - Being the same premises conveyed by deed of Harry Albert on May 23, 1930.

BOOK 5717 PAGE 220

DATE - October 2, 1970
CONSIDERATION - Nominal
GRANTOR (seller) - Anna Louise Russell and Jane R. Brown
GRANTEE (buyer) - Anna Louise Russell
DESCRIPTION - Land and buildings
PREVIOUS REFERENCE - Being the same premises conveyed to the within grantors by deed of Anna Louise Russell on November 2, 1959.

BOOK 6066 PAGE 87

DATE - May 15, 1974
CONSIDERATION - \$36,000
GRANTOR (seller) - Anna Louise Russell
GRANTEE (buyer) - Richard A. and Sue Ann Clemens
DESCRIPTION - Land and buildings
PREVIOUS REFERENCE - The same premises conveyed by Anna Louise Russell and Jane R. Brown of Riverside, CT., also known as Jane Russell Brown, on October 2, 1970.

BOOK 6178 PAGE 143

DATE - September 4, 1975
CONSIDERATION - None given
GRANTOR (seller) - Richard A. and Sue Ann Clemens
GRANTEE (buyer) - Richard A. Clemens of 11 Oliver St.
DESCRIPTION - Land and buildings
PREVIOUS REFERENCE - Being the same premises conveyed by deed of Anna Louise Russell on May 15, 1974.

BOOK 6580 358

DATE - March 8, 1979
CONSIDERATION - None given
GRANTOR (seller) - Richard Clemens
GRANTEE (buyer) - Richard Clemens trustee
DESCRIPTION - Land and buildings
PREVIOUS REFERENCE - Being the same premises conveyed by deed of Richard Clemens and Sue Ann Clemens on September 4, 1975.

BOOK 8690 PAGE 309

DATE - December 15, 1986
CONSIDERATION - \$305,000
GRANTOR - Richard Clemens trustee
GRANTEE - Joseph Jones
DESCRIPTION - Land and buildings
PREVIOUS REFERENCE - The same conveyed by deed of Richard Clemens on March 8, 1979.

Reference to book and page are deed books at the Registry of Deeds. Probate numbers are cases at Probate Court. Both offices are located in the same building on Federal St. All maps in this report are not meant to be exact, just for illustration purposes.

DATE DOCUMENTATION

11 - 13 OLIVER STREET

"This three-story plus hip roof, wooden house with its narrow end on the street has a Federal-period entrance in the yard at the south side of the house. The doorway is in the middle of the balanced five-bay facade and is trimmed with reeded pilasters and a pediment in which there is a semicircular fanlight, a favorite detail of the early 1800's. The heavy molded wooden cornice is also a Federal feature. Off the north side of the house there is a small two-story plus pitch roof ell. A brick sidewalk leads into the yard of this house; there is a cinder block garage beyond the house in the yard."
(Salem Historic District Study Committee Investigation)

Lacking a document with an exact date, circa 1810 has been assigned to this house. Since Mr. Searle purchased land in 1809 and sold land with a dwelling house in 1811, this seems most plausible. The tax records, which usually supply date documentation, are of no help in this case:

1807	no listing for Miles Searle
1808	Miles Searl unf(inished) h(ouse) Northey St.
1809	Miles Searl pt. h
1810	" " " "
1811	" " " "
1812	" " " "

Miles Searle, the son of Samuel and Mehitable (Burpe) Searle, was born, in Ipswich, on April 22, 1782. Mr. Searle was married to Sarah Stanley on June 4, 1808. He was involved in several real estate transactions - in Rowley for his parents' property and in Salem on Andrew, Northey and Oliver streets. The Searle family lived in the Northey St. house and subsequently moved to Newburgh, N.Y.

RIVER

1851

Eastern Rail Road

SKERRY

CONANT

PEARL

SAUNDERS

WILSON

CHURCH

BRIDG

WINTER

PICKNICK

ST. PETERS

BRIGGS

WASHINGTON SQUARE



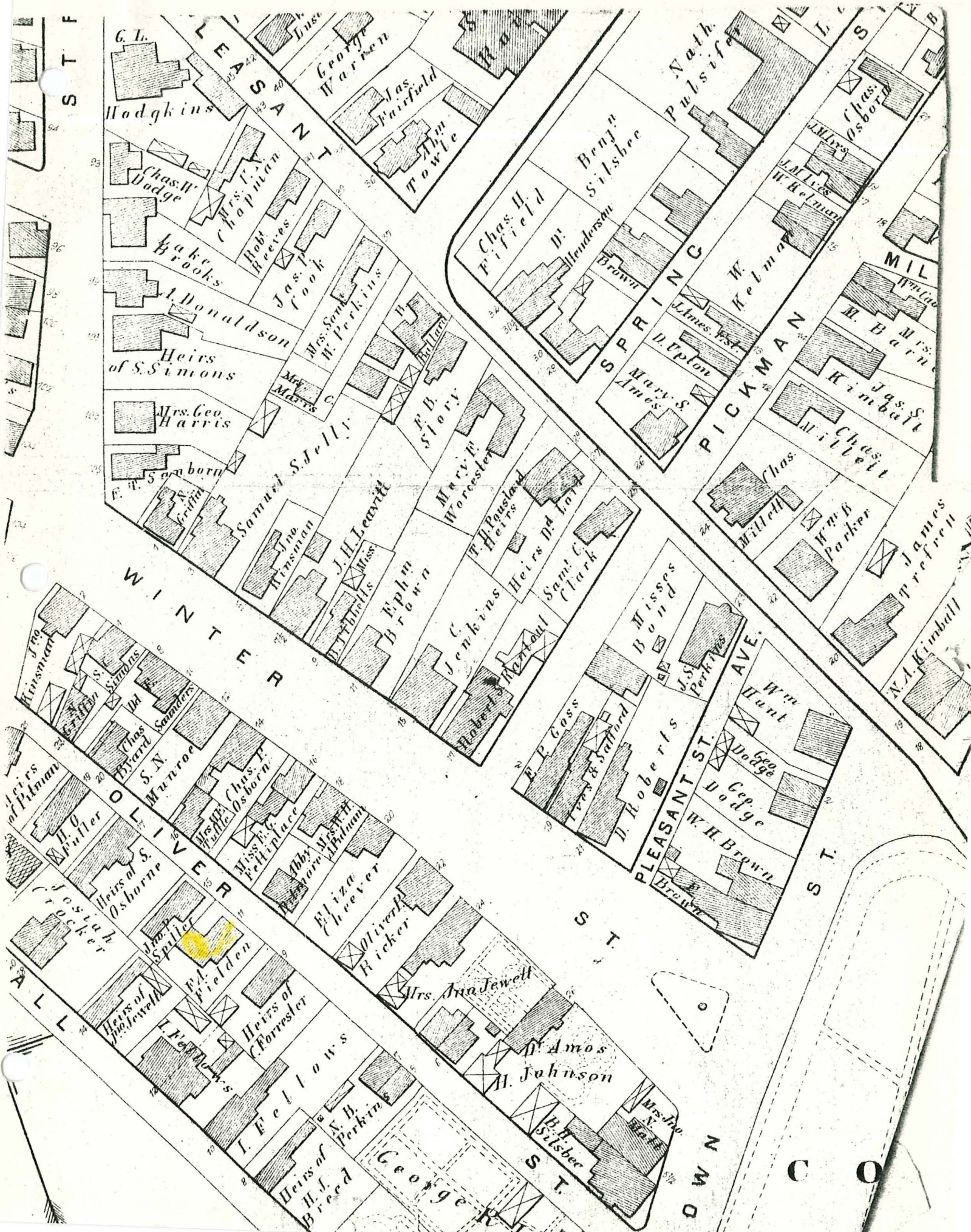

S T F

LEASANT

Hodgkins
Chas. W. Dodge
Mrs. I. Chapman
Robt. Reeves
Jas. P. Cook
A. Donaldson
Heirs of S. Simons
Mrs. Geo. Harris
F. W. Osborn

Samuel S. Jolly
Mrs. S. Perkins
Mrs. S. Perkins
Mrs. S. Perkins
Mrs. S. Perkins
Mrs. S. Perkins

WINTER

J. H. Leavitt
Miss J. H. Leavitt
J. H. Leavitt
J. H. Leavitt
J. H. Leavitt

OLIVER

Heirs of S. Osborn
Mrs. W. H. Osborn
Chas. P. Osborn
Miss F. C. Osborn
Abby W. Osborn
Elizabeth Osborn

Heirs of S. Osborn
Mrs. W. H. Osborn
Chas. P. Osborn
Miss F. C. Osborn
Abby W. Osborn
Elizabeth Osborn

Heirs of S. Osborn
Mrs. W. H. Osborn
Chas. P. Osborn
Miss F. C. Osborn
Abby W. Osborn
Elizabeth Osborn

Heirs of S. Osborn
Mrs. W. H. Osborn
Chas. P. Osborn
Miss F. C. Osborn
Abby W. Osborn
Elizabeth Osborn

Chas. H. Field
Benj. Silsbee
Dr. Andrews
Brown

Chas. H. Field
Benj. Silsbee
Dr. Andrews
Brown

Chas. H. Field
Benj. Silsbee
Dr. Andrews
Brown

Chas. H. Field
Benj. Silsbee
Dr. Andrews
Brown

Chas. H. Field
Benj. Silsbee
Dr. Andrews
Brown

Chas. H. Field
Benj. Silsbee
Dr. Andrews
Brown

Chas. H. Field
Benj. Silsbee
Dr. Andrews
Brown

Chas. H. Field
Benj. Silsbee
Dr. Andrews
Brown

Chas. H. Field
Benj. Silsbee
Dr. Andrews
Brown

Chas. H. Field
Benj. Silsbee
Dr. Andrews
Brown

MIL

MIL

MIL

MIL

MIL

MIL

MIL

MIL

MIL

MIL

PICKMAN

PICKMAN

PICKMAN

PICKMAN

PICKMAN

PICKMAN

PICKMAN

PICKMAN

PICKMAN

PICKMAN

PICKMAN

PLEASANT ST.

PLEASANT ST.

PLEASANT ST.

PLEASANT ST.

PLEASANT ST.

PLEASANT ST.

PLEASANT ST.

PLEASANT ST.

PLEASANT ST.

PLEASANT ST.

PLEASANT ST.

GEORGE ST.

GEORGE ST.

GEORGE ST.

GEORGE ST.

GEORGE ST.

GEORGE ST.

GEORGE ST.

GEORGE ST.

GEORGE ST.

GEORGE ST.

GEORGE ST.

BROWN

BROWN

BROWN

BROWN

BROWN

BROWN

BROWN

BROWN

BROWN

BROWN

BROWN



REFERENCES.

- BRICK BUILDING
- WOOD "
- BRICK & WOOD BUILDING

1897

7

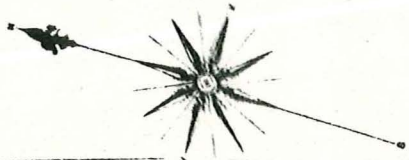

OLIVER

MALL

WILLIAMS

HOWARD

C e m e t e r y .

BRIDGE

13

BERTRAM HOME FOR AGED MEN

WASHINGTON

KIMBALL CT.

BROWN ST. CT.

"AREA" ESSEX COUNTY JAIL.

SALEM YOUNG WOMEN

ROOPER

IVES

PLEIK

