

Historic Salem incorporated

OFFICE AT OLD TOWN HALL

POST OFFICE BOX 865 SALEM, MASSACHUSETTS 01970 / PHONE (617) 745-0799

14 Winter Street

Built by,

THOMAS BROWNE, housewright

in 1781

Research by,

Joyce King - Oct. 1981

*"to preserve Historic Sites, Buildings and objects,
and to work for the education of the community
in the true value of the same."*

14 Winter Street

The house at 14 Winter Street has been described in the Salem Historic District Study as: "This simple two-story plus pitch roof clapboard house is interesting because its entrance is in the yard at the intersection of the main house and a similar pitch roof ell at right angles to the main house on the street. The doorway is in an enclosed pedimented portico. One detail which suggests that it dates from the pre-Federal period is the cornice under the eaves which protrudes over the second story windows, and which is echoed in the molded window sills of this same cornice of windows; the house also has a large square chimney, which is usually a characteristic of the pre-Federal period. A wooden fence in the Chinese Chippendale style encloses the side yard."

The history of Winter street as given in the Essex Antiquarian, vol. 8 pg. 66: "Winter street was an ancient road. It was called a lane or highway in 1668; Road leading to Beverly ferry, 1705; Highway leading from the training field to Beverly ferry, 1705; Highway leading from the training field to Beverly ferry, 1760; the way to the ferry, 1769; Road 1771; Way leading to ferry lane, 1771; the ferry lane leading to Beverly, 1779; Ferry Lane, 1780; Ferry lane or the way leading to Essex bridge, 1793; and Winter street, 1795."

Very early the entire west side of Winter street was owned by Jacob Pudeater, blacksmith. Mrs. Pudeater lived on this land until the summer of 1692, when she was condemned as a witch and

executed Sept. 22, 1692, being about seventy years of age. Later the land became the property of the Cheever family.

On Aug. 29, 1781 Benjamin and Ruth Cheever sold a lot of land to Thomas Browne of Salem, housewright:

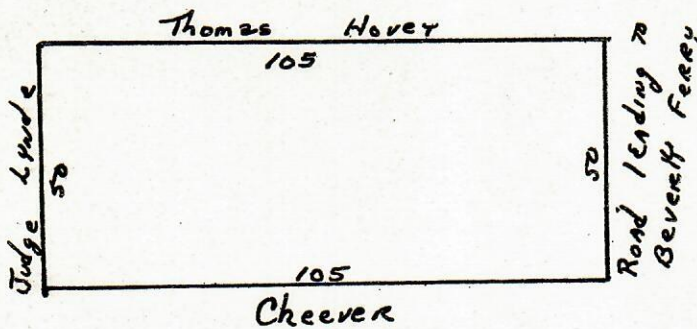

(book 145 page 94)

Mr. Browne immediately set to work building a new house for his family. The tax records show the progress of the house:

- 1781 Thomas Brown - 1/3 house, fac^y and stock, 4 common rights
- 1782 Thomas Brown - house

Thomas Browne died, on June 30, 1793, at the age of 46. An inventory of his estate (probate #3850) taken on Dec. 12, 1793 lists the contents of the house plus gives valuable information as to the simple implements used by the housewright when building the sturdy homes which survive today. (appendix A)

On Sept. 12, 1799 a committee was appointed to divide the property and award the widow Margaret (Skerry) Browne her dower rights*.

*This was an automatic 1/3 share of a husband's estate.

There may have been some disagreement with one of the other heirs as to who owned what. When a widow was assigned a certain room of a house she was not usually confined to just this part of the house but affirmed her rights that even if all the other heirs sold their shares of the estate she would retain the privilege to occupy the room or rooms as long as she lived. In this case Margaret was assigned "the front Lower Room, A Back room and Bed room, also the closet at the northerly side of the Kitchen, (that if Mrs. Brown sees fit to open a back door for an Entry) also the Western Garret, and at the North East Corner of the Cellar, a piece of Eight feet square, and one third part of the Arch under the Chimney, with the privilege at all times to use the front Door, Entries and stairs from the Cellar to the Garret, also the Outer Cellar Door and Steps, and a passage way of four feet wide to the North East part of the Cellar, and a way of three feet wide from the stairs round the Chimney to the Western Garret, Likewise to have a Right to Open the front Room Chimney the Southerly Oven, Now belonging to the Kitchen, for her own use and benefit at her cost, also one quarter part of the Pew in the Rev^d Dr. Barnards Meeting House." She was also awarded part of the barn, necessary house and well located in the rear of the house (appendix B).

When Margaret Brown died on Aug. 11, 1818 Rev. William Bentley made this notation in his diary: "Samuel Skerry & wife, death of his Sister, Widow Margaret Brown, aet. 69, in Winter street & goodness to him..... Mr. Skerry tells me his Sister married Thomas Brown.

The father of his Br. in Law (Thomas Browne) possessed the Farm in Wenham bought of him by J. Gardner whose widow of the Pickering family now lives upon it. Thomas Brown long since died." (Diary of William Bentley, vol. 4, pg. 540)

The probate of Margaret (Skerry) Brown lists the contents of the house at 14 Winter Street (appendix C.) and indicates that her only real estate holdings were the lots assigned to her as an heir of the Skerry family. Margaret had sold her rights in the Winter St. property to her daughter "Betsey Brown (now Osborn)" on March 2, 1813. (book 199 page 141)

The heirs of Margaret Brown were her children; Abraham Brown, Betsey Osborn and Hannah Brown; and grandchildren; Thomas Edwards, Margaret Southward, Abigail Hoyt, and Hannah Brown.

During the period from July 1822 to Feb. 1823 most of the heirs of Thomas and Margaret Browne had sold their shares in the Winter St. property described as house, land and barn, to Aaron Osborn husband of Betsey. (book 223 page 250, book 230 page 242 and book 237 page 184)

Aaron Osborn, housewright, built a house on the portion of the property which fronted on Oliver St. by 1830. The Osborns lived in the Oliver St. house until 1833 when they moved into the Winter St. house. The Salem Street Books indicate that 14 Winter St. was owned by John Edwards et al and valued at \$1,400, the occupants being John Edwards, John Bassett, and Brackley Peabody.

The 1836 directory shows the occupants at that time as Aaron Osborn, John Osborn and Lydia Richardson. Over the years Aaron Osborn shared tenancy:

- 1842 - Aaron Osborn, William Ashton
- 1845 - Aaron Osborn, Nathaniel B. Osborn, John Bridges, Joseph Ally
- 1848 - Aaron Osborn, Nathaniel B. Osborn, John H. Young
- 1849 - Aaron Osborn, N.B. Osborn, James Smith

The federal census of 1850 gives a close look at the Osborn household:

Aaron Osborn	age 65	carpenter	born Mass.
Susan	"	" 53	" "
2nd family			
John Frasier	age 33	mariner	born Scot.
Mary	"	" 33	" Mass.
Mary E.	"	4	" "

The Salem Street Book gives this notation in 1855:

14 Winter St.

Aaron Osborn "died 5-10 at noon suddenly"
George W. Crosby

The probate of Aaron Osborn (#48783) includes his will which specifies the widow Susan's share:

"To my wife Susan the use of the front room, side room and Bed room in my house on Winter St. on the lower floor of said house with the little cellar under the same, also privilege of entry to and out of the back door, with all the west attic in said house, with a privilege to and from the same, with 1/3 of the woodhouse, back houses and yard. Also privilege to and from the street to pass in and out front door. Also use of the furniture in the house during her life, at her decease to my grand daughter Margaret Elizabeth Osborne

or her heirs and assigns. The rest to my two sons John and Nathaniel B.
(appendix D & E)

The 1860 census gives the occupants as:

Charles Osborn	age 33	tinsmith	born Mass.
Jane "	" 33		" Maine
Charles "	" 7		" Mass.
2nd family			
William Duzout	" 40	cabinet maker	" France
Victoria "	" 40		" "
Leon "	" 8		" "
Mary "	" 6		" "
3rd family			
Samuel Lefavour	" 40	master mariner	" Mass.
Lucy "	" 39		" Maine
Lucy "	" 7		" Mass.

The 1865 taxes:

14 Winter

Charles P. Osborn	age 38	owners - 1/3 Mrs. A. Osborn
Stephen Roberts	" 42	1/3 Nathaniel Osborn
Samuel Lefavour	" 40	1/3 Lydia Foster of Bridgton, Maine

On Dec. 22, 1869 Lydia Foster, of Bridgton, Maine, sold for \$500 to Sarah B. Osborn of Lynn, 1/3 the land and building on Winter St. "derived to me by my late husband Nathaniel Brown. Provided they pay Judith Perley of Methuen \$50." (book 802 page 156)

The tax records for 1870:

Marcus Knowlton	owner - estate of A. Osborn
Charles P. Osborn	house \$1,000
	land 900

The 1870 census shows the change in occupants:

Charles Osborn	age 42	tinplate	born Mass..
Jane F.	" 43	keeps house	" "
Charles	" 17	clerk in apothecary	" "
Carrie	" 9	at school	" "
Agge	" 4	at home	" Canada
2nd family			
Marcus Knowlton	" 24	cabinetmaker	" Mass.
Mary	" 24	keeps house	" "
Marcus	" 2	at home	" "
Elmer	" 3	at home	" "
3rd family			
Mary Ferguson	" 22	keeps house	" Mass.
Mary E.	" 1	at home	" "

On Feb. 21, 1871 Joseph Faulkner and Margarett E. his wife in her right, and Sarah B. Osborn, widow of Nathaniel B., in right of dower sold to Charles P. Osborn the land and buildings 14 Winter St., subject to the life estate of Susan Osborn and of Lydia P. Foster:

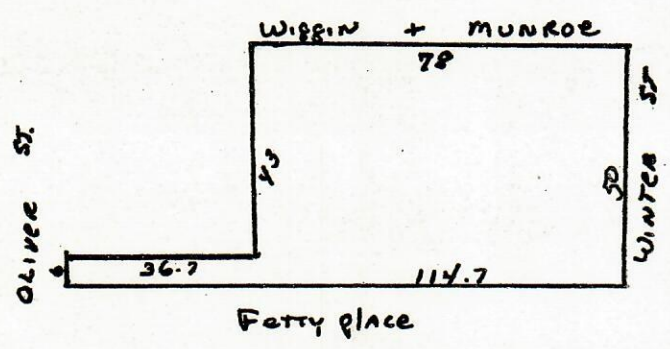

(book 816 page 156)

The 1875 taxes reflect this change:

14 Winter St.
 Charles P. Osborn age 46 owner - Charles Osborn 2/3
 Eleazer Steele " 22 house \$700, land \$600
 widow Aaron Osborn
 untaxed

By 1880 Charles P. Osborn is listed as the sole owner of 14 Winter St. but had moved to his new residence 21 Pickman St. The tenants were:

14 Winter St.
 Horace Osborne age 47 owner - Charles P. Osborn
 Eleazer Steele " 27 house \$1,000
 land 800

The 1880 census gives additional information:

Sabrina Steele	age 59	keeps house	born Vermont
Eleazer "	" 23	son - dry goods	" "
2nd family			
Horace Osborn	" 55	currier	" Mass.
Louise "	" 64	sister - keeps house	" "
Mary P. "	" 45	sister -	" "
Alice H. "	" 14	daughter - at home	" "

On Oct. 4, 1890 Charles P. Osborne sold for \$1 and other valuable consideration to Agnes M. Osborne the land and buildings 14 Winter St. The same conveyed in the deed of Joseph Faulkner. (book 1291 page 113)

Five days later, Oct. 9, 1890, Agnes M. Osborne sold the same property to Jane F. Osborne for \$1. (book 1291 page 114)

Charles P. Osborn died on Jan. 9, 1900. A simple obituary notice appeared in the Salem News:

"Charles P. Osborn died at the age of 73 years, 2 months, 27 days.
 Funeral at residence 21 Pickman St."

On Oct. 1, 1910 James F. Osborne, widow, sold to Thomas F. Cronan the land and buildings, 14 Winter St.. The same premises conveyed by deed of Agnes M. Osborne. (book 2045 page 288)

Oct. 27, 1910 Thomas F. Cronan sold to Nellie A. Heagney wife of William F. the land and dwelling house "being the same premises conveyed to me by deed of Jane F. Osborne on Oct. 1, 1910." (book 2047 page 170)

Nellie Heagney died on Jan. 17, 1911. Her only heir was a daughter Helen M. Heagney. (probate #110127). Mrs. Heagney's real estate holdings were:

House and land on Winter St.	\$3,500
House and land on Juniper Point	1,600
Lot of land on Main St., Clinton, Mass.	500

On Sept. 8, 1911 James F. Fielding, of Oil City, Pa., administer of the estate of Nellie A. Heagney sold to Edwin H. Dodge the land and buildings at 14 Winter St., for the sum of \$4,000. The same premises conveyed to Nellie Heagney by deed of Thomas F. Cronan. (book 2100 page 218)

Jan. 5, 1912 Edwin H. Dodge sold to Arthur Derby the same estate conveyed by James F. Fielding. (book 2122 page 368)

Jan. 5, 1912 Arthur Derby of Salem, sold to Frances E. Dodge the land and buildings, 14 Winter St., The same conveyed by Edwin H. Dodge. (book 2122 page 369)

Sept. 14, 1939 Frances E. Dodge, widow, sold to Martha B. Greenough the same property conveyed by deed of Arthur Derby. (book 3193 page 278)

Oct. 29, 1947 Martha B. Greenough, of Beverly, unmarried, sold to Mary Louise Woodward, of Peabody, the same premises conveyed by Frances Dodge. (book 3534 page 554)

Mary Louise Woodward then sold to Annie J. McKenna of Kings Park Long Island, N.Y., the land and buildings conveyed by deed of Martha B. Greenough on Oct. 9, 1947. See also deed of Frances E. Dodge to Martha B. Greenough, Sept. 14, 1939. (book 3574 page 459)

Notes: The Essex Institute has in its photo collection two photos of this house when it was "Crashed by a Truck."

Reference to book and page are deed books at the Registry of Deeds. Probate numbers are cases at Probate Court. Both offices are located in the same building on Federal St. All maps in this report are not meant to be exact, just for illustration purposes.

An Inventory of the Estate of Thomas Browne
 late of Salem Housewright De^d as appraised
 by us the subscribers Commissioners appointed
 by the Hon^{ble} Benjamin Greenleaf Judge of
 Probate &c. —

The mansion house together with the
 out houses (with the land under and
 adjoining cont^y about Twenty poles — } 275.0.0

George Batchelders Note of hand dated
 July 4th 1793 ————— for } 3.9.9

Miles Ward Jr Note of hand, dated April
 9th 1793 ————— for } 9.0.0

287.9.9

Miles Ward Jun^r Note of hand dated August
 25th 1793 ————— for 180. — —

Miles Ward Jun^r Note of hand dated Oct^r
 6th 1793 ————— for } 15. — —

Joseph Richards Note hand dated 24 Dec^r 1793 —
 for } 30. — —

John Fisk Esq^r his Note hand dated ————— 225.0.0
 June 15th 1793 ————— for } 151.19.10

Cash on hand ————— 40.0.0

Cash given to Tho^s Browne ————— 30. — —

Silver Watch 48) ————— 2. 8 —

half p^{er} in the Meeting^h where the Rev^d
 Tho^s Barnard officiates } 5. — —

1 Silver shoe & shoe buckles 6/ Stock buckle 3/ — 9 —

1 Silver shoe & shoe buckles 6/ 1 small 6/ — 12 —

Am't brought over

1752.13.1

1 round Chair 6/	2 Green d ^o 8/	Looking Glass 3/	17.0
1 Hand Irons 12/	1 small Arm 15/	2 Chests 6/	1-13-
1 Birch Desk 15/	3 feet Table 9/	1 small d ^o 4/	1-8-
5 old Chairs 5/	1/2 brass candlesticks 6/	1/2 Tin d ^o 1/6	12.0
Tin ware 12/	Glass & delph d ^o 17/		1-9-
China Bowl 5/	Case & bottles 6/	China Cups & Saucers 5/	16-
1/2 Hand Irons 5/	Shovel & Tongs 6/		11-
Tinder hooks	Hammer	Scissors 7/6	braff Kettle 20/
Small d ^o 3/			1-10.0
Iron pot 6/	Tea Kettle 3/	Crepper 1/6	10.6
Dripping pan 3/	Frying pan 1/	warming pan 7/6	11.0
Spit 1/6	Grid iron 3/	Scales d ^o 9/	13.6
Meal Chest 6/	Cloutier Horse 4/6	Hove 3/	13.6
30 th Paster = 10 th	Crop Cut Saw 9/		1.14-
Quind stone 4/	5 Small saws 12/		16-
Iron Spade 2/6	Spade 3/	2 broad Axes 10/	15.6
Augers 10/	bench screws & fetts 10/		1-
Jointers 7/6	2 Foreplains 2/	2 Shavers 4/6	14-
3 Foreplains 6/	board Rule 4/6		10.6
Iron Square 1/6	3 wooden d ^o 1/6	2 smothering plains 2/	5-
2 shingling Hammers 1/6	2 Claw d ^o 1/6		3-
21 Chisels & Gages 7/	Saw Combs	Saw set	Gimbs & Gouges 1/
			8-
1 Plough 2/6	panel Plain 4/6	29 Creese plains 15/	1-2.0
1 Chest 4/6	Case blk Walnut Drawers 48/		2-12.0
Spinning wheel 6/	Grooving plain 5/	Book 5/	16-
writing Desk 7/6	Case low Drawers 3/		10.6
braff Kettle 10/	Iron ware 6/		16-
Spinning wheel 3/	Wool chest 9/	Table 2/6	Sett
Majors 2/			16.6
old Chest 3/	braff saddle 1/6	3 Chairs a 9 th	6.9
3 flat Irons a 1/	Case with bottles 6/		9-
whulbarrow 3/	wood Axe 3/	Candlestick 1/	7-
1/2 brass Scales 4/			11-
1 Feather Bed	Bobster	pillows wt. 50 = 1/6	3-15-
1 d ^o d ^o	d ^o d ^o	wt 40 = 1/	2-
1 d ^o d ^o	d ^o d ^o	" 26 = 1/	1.0-

172

189

8.5

Amos, brought Over

1792.14.10

5 ¹ / ₂ Pillow Cases a 2 ¹ / ₂ pair Sheets a 8 ¹ / ₂	1. 0	
2 Napkins a 6 ¹ / ₂ 3 ¹ / ₂ Pillow Cases a 2 ¹ / ₂	" 9	
Green Curtains a 12 ¹ / ₂ 2 Hooks of Bedsteads a 4 ¹ / ₂		
Coverlid 4 ¹ / ₂ 3 Blankets of		10
2 bedsteads with Cord, a 9 ¹ / ₂ 2 do a 4 ¹ / ₂ 6	1. 7	
Green Lint, 24 ¹ / ₂ Counterpane 9 ¹ / ₂ Lint 5 ¹ / ₂ 1. 18.		
2 Coverlids a 2 ¹ / ₂ box & Cabin 1 ¹ / ₂		5
3 yards Broad Cloth 60 ¹ / ₂ 2 yd do. a 12 ¹ / ₂		3. 12
1 Cow 48 ¹ / ₂ Wearing apparel £ 5. 15. 6	8. 3. 6	18. 14. 6
304 Square Yards		2. 10
		<hr/>
		£ 813. 19. 4
Curtains Rods		3. 8
		<hr/>
		£ 814. 3. "

Bern^d Herrick
 Edw^d Norris
 Jites Ward

Appraisers
 sworn

Salem Dec. 12. 1793

Wm Brown

of the County of Essex

December 14th 1794. The Mrs Margaret
 presented the above written and made
 contained a true and perfect Inventory of
 Thomas Brown late of Salem deceased
 and so far as has come to her hands or know
 that if any thing further shall hereafter
 be will cause it to be added

To the Honbleth Samuel Stollon Esq^r Judge of Probate
for the County of Essex

Pursuant to the Warrant Hereunto Annexed, Appointing us the
Subscribers a Commission to divide and sett off by meters and bounds
the Being duly sworn. Have carefully viewed the Real Estate in-
cluded in the Inventory of the said deceased, and have given Mr.
Margaret Brown Notice, of the time & place of our meeting, and who
was present. Have attended that service, and have accordingly sett
off unto the said Margaret Brown, as her Right of Dower in said
Estate, as follows. viz part of the Dwelling House, to wit, The front Room
Room, a Bath room & Bed room, also the Closet at the north side
of the Kitchen, (that if Mr. Brown see fit to Open a back door for
an Entry) also the Western Garret, and at the North East Corner of
the Cellar, a piece of Eight feet square, and one third part of the Arch
under the Chimney, with the privilege at all times to Use the front
Door, Entries & stairs from the Cellar to the Garret, also the Outer
Cellar Door Steps, and a passage way of four feet wide to the North
East part of the Cellar, and a way of three feet wide from the stairs
round the Chimney to the Western Garret, Likewise to have a Right
to Open in the front Room Chimney the Southly Oven, which be-
longing to the Kitchen, for her own Use and benefit at her cost, also
one Quarter part of the Pew in the Pew^d D^r Barnards Meeting House,
and part of the Barn, to wit twelve feet in the lower part from the
Westerly End, with the Land under & adjoining, beginning at twelve
feet from the North West Corner of s^d Barn, then running Westerly to the
South East Corner of the Necessary house, on a straight line to s^d Oliver
Land, then Southly to Land of B. Leaver, then Easterly to a marker
twelve feet East of the s^d West Corner of s^d Barn, then North to the bound
first mentioned, also the privilege to Use and take Water from the
Well at all times, and to have a privilege of passing and repairing
to & from the Necessary House in a way of four feet wide, and to make
Use of the Necessary House at all times in common with the proprietors
of the other part of said House, The Yard Southward and Westward
of said House to be in common, to be Used by said Margaret &
her assigns, with the other proprietors, and is bounded as follows
beginning on Winter Street fourteen feet Southly from the South
Eastly Corner of said House, then running westerly to the N. E. Corner

Nov.
1818

(C)

Inventory of the Real and Personal Estate belonging to the late Margaret Brown deceased appraised by the Subscribers. Salem 31st August 1818.

Lot nos - A piece of Land on Lemon Street a Smith, low	100	-
2 - a piece of land - on same street	200	-
3 - a piece of land on Bridge Street	500	-
<hr/>		
A Note of hand signed by Lydia & Daniel Malden of Pew, being No. in the North Meeting house	1127	75
<hr/>		
6 Linens 4.50 - 12 Handkerchiefs 1.50 - 3 Shawls 3. -	9	1125
2 Silk Pelices 10. - 4 Silk Gowns 10. - 8 Chintz do 8. -	28.	
4 Aprons 1. - 8 flannel Coats 1. - 1 Broad Cloth Cloak 3. -	5.	
1 Table Muff & Fippett .50 1 Table Fippett 3. -	3.50	
7 pair Stockings 1. - 1 Bombazet Gown 2.25. -	3.25	
2 Bonnets .60 3 flannel Waistcoats .25. -	3.	
1 silk & 1 Crape Mantle		52 50
5 Sheets 5. - 9 Pillow Cases 1.50 - 3 Table cloths 2. -		8 50
9 Towels 2.25 - 1 set Bed Curtains 2. - 4 Bed Quilts 8. -		12 25
1 Bed Rugg .50 - 2 Blankets 1. - 1 Strip Carpet 1.50		3. -
2 Feather Beds, 2 Pillows & 1 Bolster 12.50 1 Matt .50		13 -
1 Straw Bed Tick .25 1 Oil cloth .25		50
1 Pair Brass Candelsticks 1. - 1 Large Bible 2. - 1 Looking Glass .50		3 50
1 Pr Bellows & 1/2 hand saws & Tongs 1. - 10 painter plates 1. -		2 -
4 Painter Cashes 1. - 1 Pr Brass Scales & 7 Wweights 1. -		2 -
1 Brass Table .25 1 Pr 1 Skillet & 1 Dist kettle 1. -		1 25
2 Brass Kettles 5. 1 Warming Pan 1.50 1 Mahogany Desk 6. -		12 50
9 Chair 6. 1 Chest of Drawers .25 1 Marguerite trunk .50		6 75
5 Small Chests 1.50 1 Small Trunk .75 1 Basket & Cont .50		2 75
Crockery in closet 3.50 Sundry Articles in pantry 2. -		5 50
2 Bedsteads 1. - 2 Spinning Wheels .50 1 Bread tray .25		1 75
1 Small Chest and contents .25 1 Cradle 00		25
2 Mahog 7 Tables 2. - 2 Breakfast Table .50 1 Case Pills .75		3 25
1 Bracket and contents 00 - 1 Handker Pin .50		50
<hr/>		
		5 50

48783

(D)

ESTATE OF Aaron Osborn Late of Salem Dec'd.

Schedule B.
PERSONAL ESTATE.

in the front room one Sappa flr Card Table \$3	13.00
one air tight Stone \$3 Mahogany work Table \$2	5.00
4 chairs at 25 cent each rocking do \$1 each Bed room \$3 10.	13.50
2 yard Carpet at 35 c per y seven yards Stair Carpet at 25 cent	10.50
Looking glass \$6 Tea Tray 75 cent two flower Vases 50 each	7.75
one window Curtains & Fixtures \$1	50.75
Contents of the Side Room	
one chair & book Case flr Cook Stove \$5	11.00
wooden table & Contence \$1.50 work table 75 cent pin set 15 cent	3.00
4 chairs at 15 c 3 rocking do at 50 each Looking glass \$2	4.10
one wooden clock \$3 seven samplers at 25 cent Carpet \$2	6.75
bread & veg 35 cent 50 c Silver Knives & forks \$1 per set	2.35
Contents of a Closet \$4 5/8 C3 Silver at \$1 per lb one Silver watch \$2	17.50
one Cotton dress	\$34.20
	0.50
Contents of bed room Bedstead \$2 Down Bed & Straw do \$15	
5 quilts \$4 four blankets \$3 Soring trunk 75 cent window Curtains	8.00
Carpet & mat 25 cent table linen 5 table cloth 60 cent each	3.05
one napkins at 25 cent each Bed linen 25 each pillow 12 cent	4.12
Contents of the Entry Closet \$6 Contents of pantry \$4 1/2	10.25
Contents of attic one easy Chair \$3 one Est' Lamp \$1	4.00
one bedstead with bed Solow do & 4 bolster pillows	12.00
one Bat tub \$1.50 one do 50 cent wash stand & ewer \$1	3.00
three chairs at 15 cent each one Chest \$2 Brass kettle \$1.50	22.87
Contents of Shop one box & Contence \$1.35 wood Saw rack	7.25
bread ax \$1 one Bench & sundries on Bench 50 cent	1.50
one Horse \$1 Saddle \$1 Green wax winder & park \$1	3.00
one	8.75

ESTATE OF *Aaron Osborn Late of Salem, Decedent*

Schedule A.

REAL ESTATE.

An undivided part of Dwelling House No 14 on
Winter Street with Land under and Adjoining in Salem
and out Buildings Valued at one thousand dollars \$1,000
A Lot of Land in Cross Street in said Salem
and Valued One Two Mortgages to
John Howard at One hundred Dollars \$ 100
\$ 1100

M O C

R O W N S T

G E O R G E S T

M Johnson

Mrs Madenell

Heirs of
H. J. Perkins
N. B. Perkins
I. F. L. O. W. S.

Heirs of
C. Horsley
T. Fielden
J. Fielden

Heirs of
J. Osburn
S. N. Osburn

Heirs of
S. N. Osburn
S. N. Osburn

PLEASANT ST
W. H. Brown
D. G. G. G.
D. G. G. G.
W. H. Brown
D. G. G. G.

PICKMAN AVE
D. Roberts
D. P. Goss
W. B. Goss

Heirs of
S. H. Clark
S. H. Clark

Heirs of
S. H. Clark
S. H. Clark

Heirs of
S. H. Clark
S. H. Clark

Heirs of
S. H. Clark
S. H. Clark

Heirs of
S. H. Clark
S. H. Clark

Heirs of
S. H. Clark
S. H. Clark

W. A. Kimball
J. James
W. B. Parker
Chas. M. L. L. L.

W. A. Kimball
J. James
W. B. Parker
Chas. M. L. L. L.

W. A. Kimball
J. James
W. B. Parker
Chas. M. L. L. L.

W. A. Kimball
J. James
W. B. Parker
Chas. M. L. L. L.

W. A. Kimball
J. James
W. B. Parker
Chas. M. L. L. L.

W. A. Kimball
J. James
W. B. Parker
Chas. M. L. L. L.

W. A. Kimball
J. James
W. B. Parker
Chas. M. L. L. L.

W. A. Kimball
J. James
W. B. Parker
Chas. M. L. L. L.

W. A. Kimball
J. James
W. B. Parker
Chas. M. L. L. L.

M. B. M. B. M. B.
M. B. M. B. M. B.
M. B. M. B. M. B.
M. B. M. B. M. B.

M. B. M. B. M. B.
M. B. M. B. M. B.
M. B. M. B. M. B.
M. B. M. B. M. B.

M. B. M. B. M. B.
M. B. M. B. M. B.
M. B. M. B. M. B.
M. B. M. B. M. B.

M. B. M. B. M. B.
M. B. M. B. M. B.
M. B. M. B. M. B.
M. B. M. B. M. B.

M. B. M. B. M. B.
M. B. M. B. M. B.
M. B. M. B. M. B.
M. B. M. B. M. B.

M. B. M. B. M. B.
M. B. M. B. M. B.
M. B. M. B. M. B.
M. B. M. B. M. B.

M. B. M. B. M. B.
M. B. M. B. M. B.
M. B. M. B. M. B.
M. B. M. B. M. B.

M. B. M. B. M. B.
M. B. M. B. M. B.
M. B. M. B. M. B.
M. B. M. B. M. B.

M. B. M. B. M. B.
M. B. M. B. M. B.
M. B. M. B. M. B.
M. B. M. B. M. B.

M. B. M. B. M. B.
M. B. M. B. M. B.
M. B. M. B. M. B.
M. B. M. B. M. B.

M. B. M. B. M. B.
M. B. M. B. M. B.
M. B. M. B. M. B.
M. B. M. B. M. B.

M. B. M. B. M. B.
M. B. M. B. M. B.
M. B. M. B. M. B.
M. B. M. B. M. B.

M. B. M. B. M. B.
M. B. M. B. M. B.
M. B. M. B. M. B.
M. B. M. B. M. B.

M. B. M. B. M. B.
M. B. M. B. M. B.
M. B. M. B. M. B.
M. B. M. B. M. B.

M. B. M. B. M. B.
M. B. M. B. M. B.
M. B. M. B. M. B.
M. B. M. B. M. B.

M. B. M. B. M. B.
M. B. M. B. M. B.
M. B. M. B. M. B.
M. B. M. B. M. B.

M. B. M. B. M. B.
M. B. M. B. M. B.
M. B. M. B. M. B.
M. B. M. B. M. B.

M. B. M. B. M. B.
M. B. M. B. M. B.
M. B. M. B. M. B.
M. B. M. B. M. B.

S