

41 Essex Street
Salem, Mass.

DOCUMENTATION

Deeds

Book page

5161 226 April 8, 1964

John F. Hale and wife Conjetta N. Hale mortgage for \$6600 to the Salem Cooperative Bank land and buildings described: beginning on Essex St. at land now or late of Berry, running N.E. by Essex St. 41.9' to land now or late of Berry; then running S.E. by said land 45' to a corner; then S.W. by said Berry land 4.7' to a corner; then S.E. by said land 6.3' to land now or late of Weston; then running S.W. by said Weston land 36' to land now or late of Berry; then running N.W. by said land 49' to beginning.

Being same premises conveyed to us by deed Book 4000 page 586.

4000 585 and 586 August 13, 1953

John F. Hale, George A. Bragel and Elizabeth Bragel to Ruth I. O'Leary who in turn grants to John F. Hale and wife Conjetta N. Hale land and buildings (same description as above).

3677 208 July 14, 1949

Jean Gastonguay and his wife Annie L. Gastonguay formerly Annie L. Hale grant to John F. Hale and Elizabeth Bragel both of Salem my right and title being one undivided third of property in Salem (same description) Being property conveyed to Annie T. Hale by deed of Francis T. Berry Book 2254 page 173. See will of Annie Hale Probate #213800 and deed from Arthur C. Hale to Annie Hale Book 3437 page 251.

3437 251 January 10, 1946

Arthur C. Hale grants to Annie L. Hale, John F. Hale, and Elizabeth Bragel one undivided quarter of the property (described above) Meaning to convey all my interest as heir of my mother Annie T. Hale, dec. of Salem. (wife Mary releases Dower rights)

2254 173 June 5, 1923

Francis T. Berry of Salem for consideration paid grants to Annie T. Hale of Salem a parcel of land with the buildings thereon (same description).

Probate #110399 John M. Berry of Salem dec. intestate February 21, 1911

He left considerable property; his only heir was his brother Francis T. Berry

Probate # 86878 Lydia W. Berry dec. intestate October 22, 1900

(she was the widow of George E. Berry) (She left as heirs two sons) John M. Berry, the elder son was appointed administrator

Inventory of real estate:

1. 43 Essex St. house and land val. \$1200
2. 41 Essex St. house and land val. \$1600
3. 39 Essex St. house and land val. \$1400
4. 25 Essex St. house and land val. \$1600
5. 11 Turner St. house and land val. \$1400
6. 110 and 112 Derby St. house and land val. 2300
7. 131 Derby St. house and land val. 1900
2 barns val. 400

The probate of Lydia W. Berry resulted in the division of her real estate holdings between her two sons.
John M. Berry the older son received #1, #2, #6, and 31 Turner St.
Francis T. Berry the younger son received #3, #4, #5, and #7.

Book page
 1664 408 December 26, 1901
Partition of the Berry Estate
 Metcalf and Ashton surveyors map (portion) March 1901

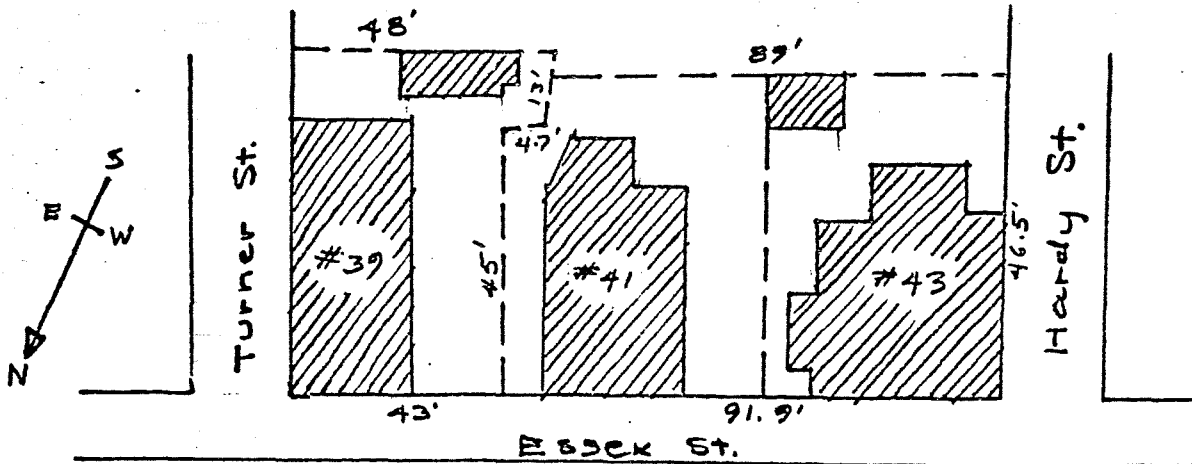

449 299 August 5, 1851
William P. Goodhue and Alice his wife, Joseph Gomez and Mary Ann P.
 his wife, Nathaniel Horton and Martha his wife, and Nathaniel Very
 All of Salem, each in his or her own right, for \$800 sell to George
E. Berry of Salem 7 undivided parts of the following message,
 bounded: N.W. by Essex St. 91'
 S.W. by Hardy St. 47.2'
 N.E. by land of Vincent 51'
 S.E. by land of Eliza Weston 91'
 (this was mortgaged for \$400, paid off in 1853)

487 225 December 15, 1853
Harriet Very and John W. Felt of Salem for \$400 sell to George E.
Berry 2 undivided 9th parts of the following message (same as above)

487 225 December 15, 1853
George E. Berry mortgages for \$400 the message with buildings on Essex
 St. bounded: N.W. on Essex St. 51'
 S.W. on Hardy St. 47.2'
 N.E. by land of Berry 51'
 S.E. by land of Weston 51' (this is #43 Essex St.)
 Mortgage paid off in 1855

Information from City of Salem Tax Records

Ward 1	1859	George E. Berry (real estate)	tax	28.80
	1857	" " "	"	27.72
	1855	" " "	house 9 Turner St. 1100	house and land 43 Essex St. 800
			house and shop on land 3 Carlton St. 600	new house 41 Essex St. 800
			total val. 2700	tax 21.60
	1854	" " "	house 9 Turner St. 1100	house and land 43 Essex St. 800
			house and shop on land 3 Carlton St. 600	

Information from City Directories:

1859 George E. Berry owned and lived at #41 Essex St.

SUMMARY

#41 Essex St. is a handsome well-kept typical mid-19th Century Salem home that has been fortunate in that it has changed hands very few times. George E. Berry, whose real estate holdings at the time of his death were fairly large, bought the tract of land on Essex St. and the house (now gone) that was #43. In 1851 he bought 7 undivided ninth parts from heirs, and in 1853 he bought up the remaining 2 undivided ninth parts. He already owned three houses on Turner, Carlton and #43 Essex St. with this transaction. Tax records for 1855 show the additional notation of "new house 41 Essex St." This gives us the definitive year for the house.

After the death of first George E. Berry, and in 1900 his widow Lydia, the property passed to his older son John. After John's death in 1911, the younger son Francis took possession. And in 1923 the property came into possession of the Hale Family, who own it to this day.

Sally Dee, researcher June 7, 1975



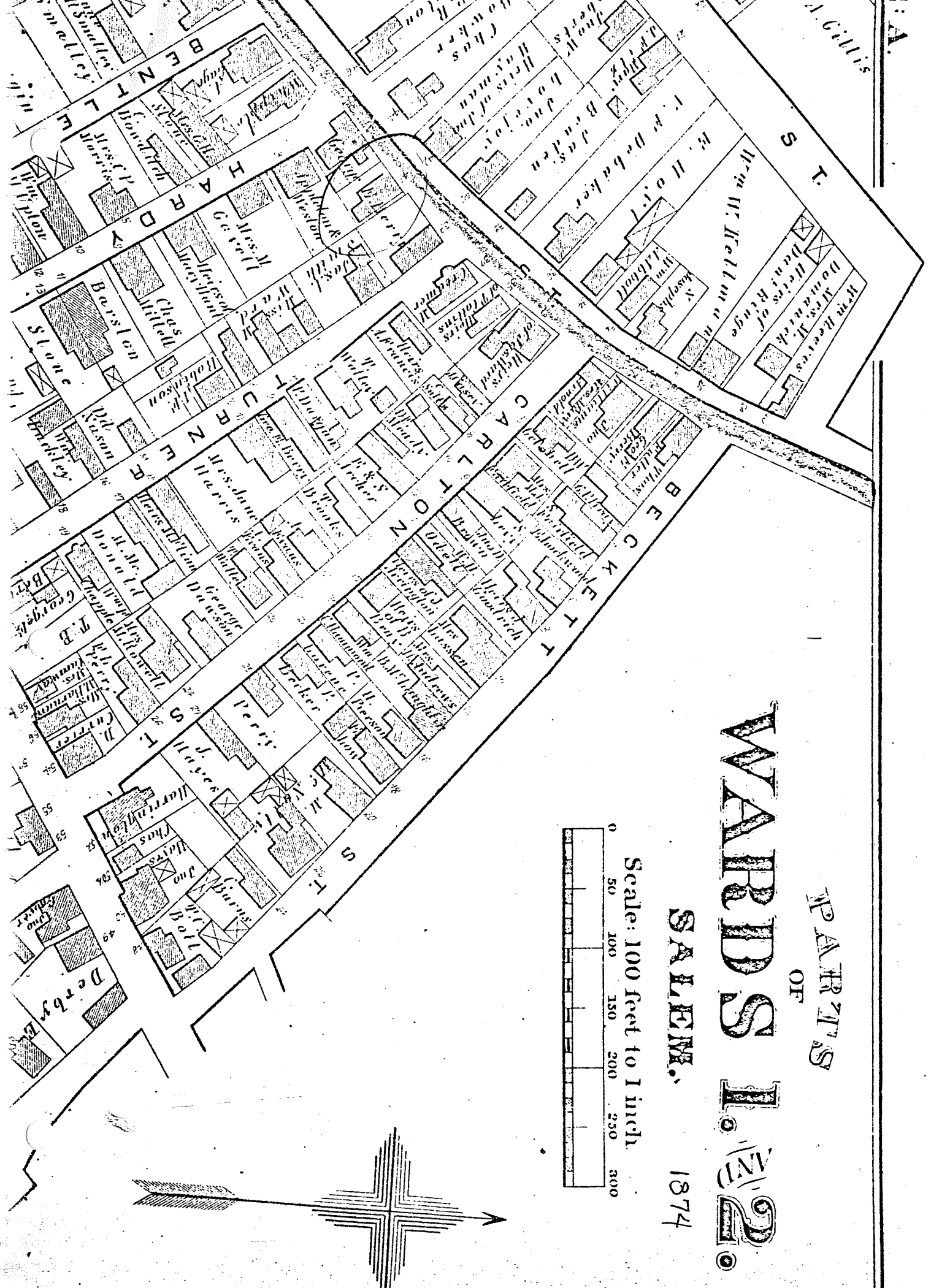

WARDS 1, 2, 3

PAPER MAPS
OF

SALEM, 1874

