

SHERMAN CEMETERY

June 7, 1832 – SEPTEMBER 9, 2001

This list has been compiled by an on site recording of all visible stones with additional data from Rochester Vital Record Books volumes # 1 and # 2 records to 1850 and from the Historical Society/Judy Gurney book of records to 1910 published year 2000 and the master copy of records 1911 to 1980 that Judy is working on and from the Rochester Town Clerk's records to 1999 and newspaper obituaries for September 2001.

Information on Capt. Charles R. Bryant taken from the article by Charles Mendall 1967, printed in the Presto Press, Mattapoisett, Massachusetts 1967.

Abbreviations used: ft. – foot stone, DOB – date of birth, DOD – date of death, y – year, m – month, d – days, dau. – daughter, hus. – husband, FD – member fire department





#244

#245

Section "B" 3rd Row



#246

#247

Section "C" 3rd Row

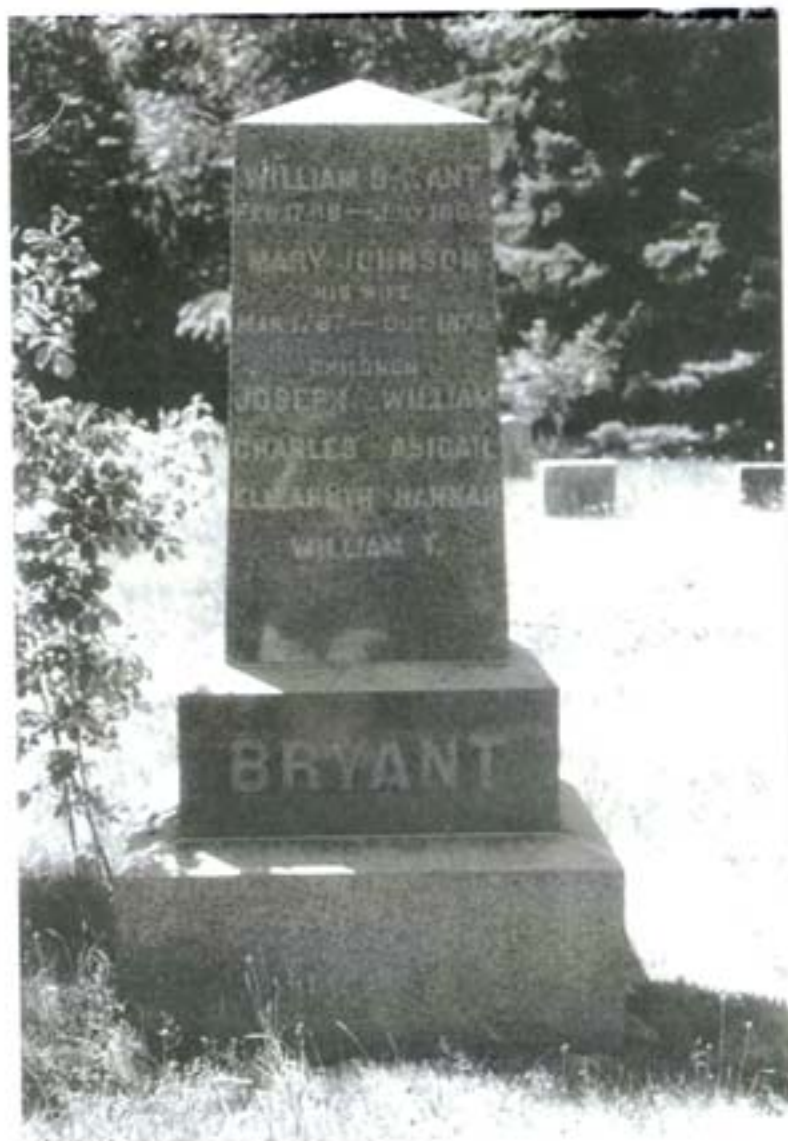

230

*Capt. Charles R. Bryant
is listed on right side.*

Section "A" 3rd Row



51 A
Rounseville
Section "B" 1st Row

302 B
Ryder obelisk
Looking north
Section "A" 4th Row





77
Section "D" 1st Row



113
Section "A" 2nd Row



#126
Section "A" 2nd Row



#139
Section "B" 2nd Row



214
Section 'A' 3rd Row



232
Section 'A' 3rd Row



Pine Street



*# 56
Section "B" 1st Row*



South end looking northwest
209 Joseph H. Kelley
Section "A" 3rd Row

left side
311 A Shaw
Section "A" 4th Row

315
Barnabas C. Ryder
Section "A" 4th Row





#303 #304
Mr. Samuel Jenney Mrs. Sarah Jenney
Section "A" 4th Row



#326 resting against #328 ft
Philip Wilber
Section "A" 4th Row



#337 #338
William Gammons Jr. Mary G. Gammons
Section "B" 4th Row



#339
Mary and Andrew J. Ashley
age 7 weeks
Section "B" 4th Row



#348
Nellie T. Sears
Section "B" 4th Row



#364
Section "D" 4th Row



North side looking south
First stone # 96 Section "D" 1st Row
Now flat on ground



woods

woods

WEST

woods

Stones 413 to 424+441

Stones 425 to 440

Section "G"

Section "H"

Stones 397 to 407

Stones 408 to 412

Section "E"
Stones 376 to 386

Section "F"
Stones 387 to 396

Driveway

Stones 287 to 328

Stones 329 to 349

Stones 350 to 360

Stones 361 to 375

Section "A"

Section "B"

Section "C"

Section "D"
Large Shrub

Stones 201 to 232

Stones 233 to 245

Stones 246 to 268

Stones 269 to 286

Large Shrub

Large Shrub

Pathway

Pathway

Pathway

Covers Pathway

Stones 99 to 138

Stones 139 to 164

Stones 165 to 185

Stones 186 to 200

Section "A"

Section "B"

Section "C"

Section "D"

Forsythia

Stones 1 to 34

Stones 35 to 57

Stones 58 to 76

Stones 77 to 98

Grass

Grass

"Pump"

Grass

Grass

Stone wall

Stone wall

"EAST"

S = sign entrance
Town of Rochester
Sherman Cemetery

PINE STREET

PINE STREET

"SOUTH"

Fence

Driveway

Pathway

RS
Sherman Cemetery

Pathway

Driveway

Fence

"NORTH"

Driveway

"west"

Section A

Driveway

"west"

Fence

"SOUTH"

Fence

"SOUTH"

Fence

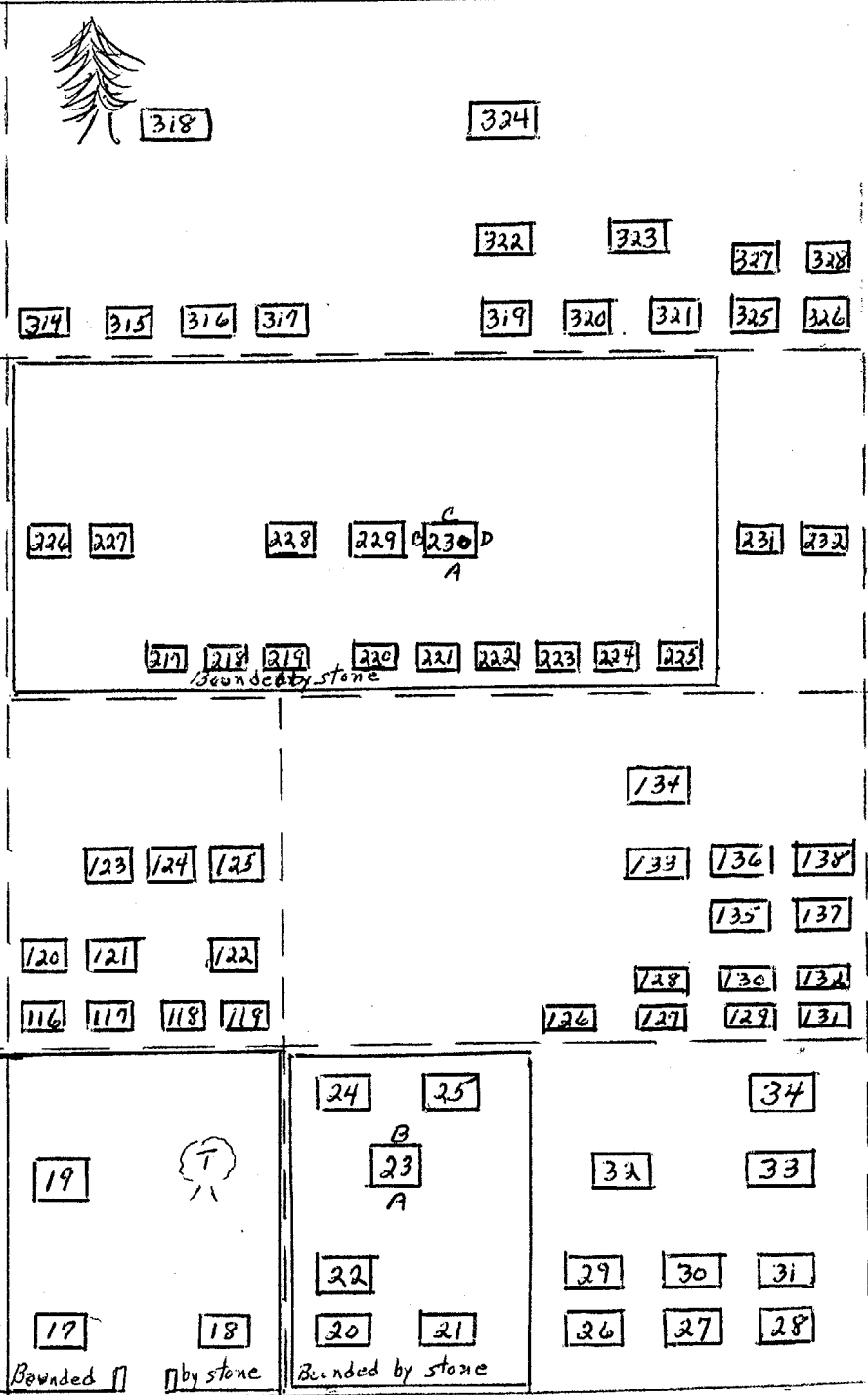
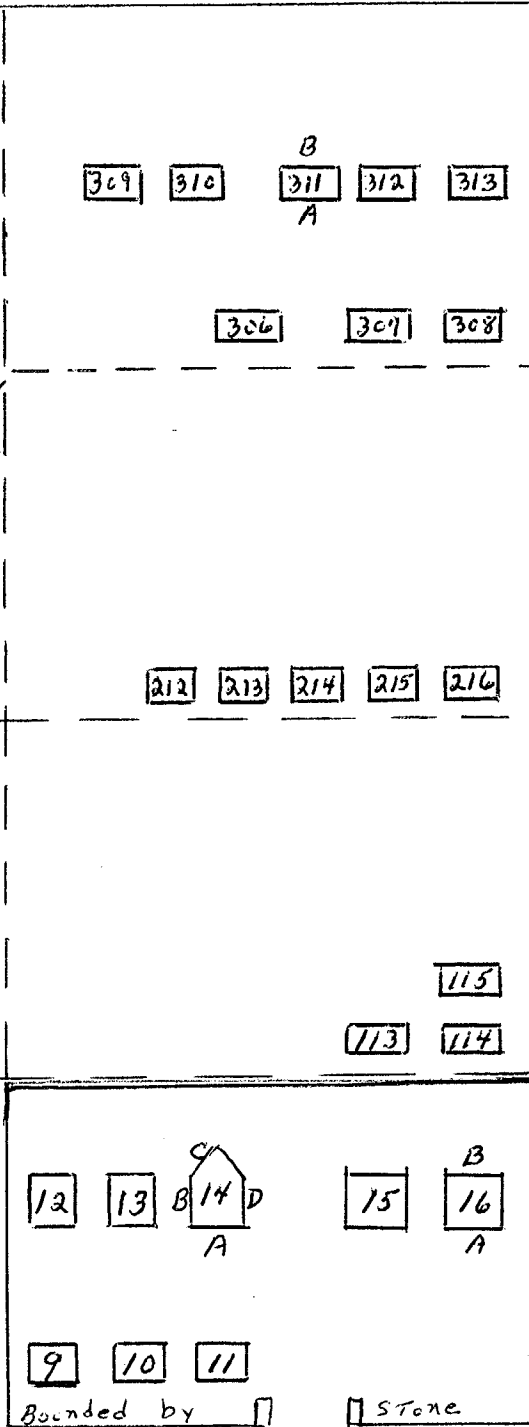
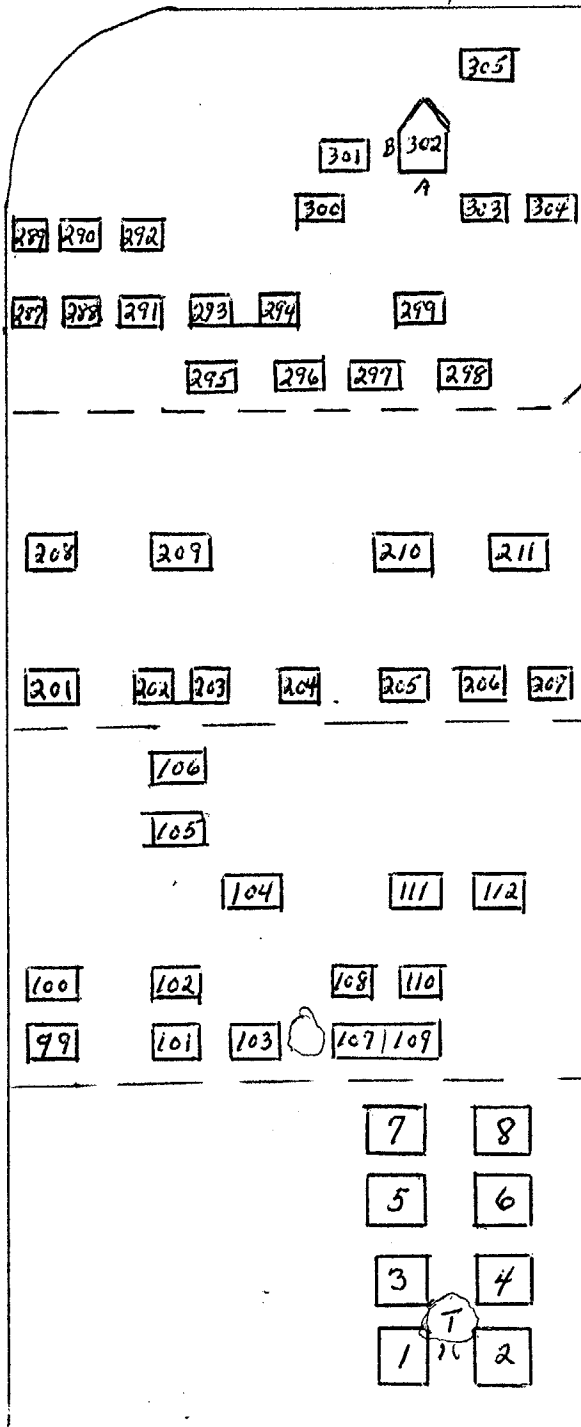

Grass Broken line — — — denotes pathway

Grass Wall oooooo

"Pine Street" "EAST" "EAST"

Driveway

"west"

Section B

"west"

Driveway

335

336

334

339

340

346

347

348

332

B
333
A

337

338

329

330

331

341

342

343

B
344
A

345

349

236

Bush

233

234

235

240

242

237

239

c
B 238 D
A

241

243

244

245

140

141

142

143

147

148

149

150

155

B
156
A

162

c
B 161 D
A

163

164

139

144

145

146

151

152

153

154

157

158

159

160

46

43

44

45

52

53

54

39

40

41

42

c
B 51 D
A

57

35

36

37

38

47

48

49

50

55

56

Pathway to Gate

Grass

(CS) - Corner Stone

wall

Broken line --- denotes pathway

Grass

"EAST"

"Pine Street"

"EAST"

Bound by stone

West

Section "C"

West

Driveway

Driveway

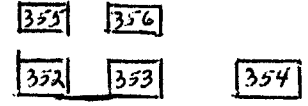
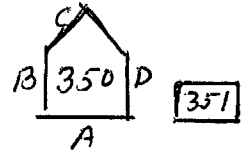

Pathway to Gate

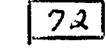
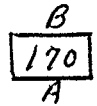
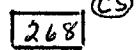
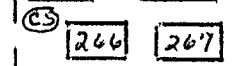
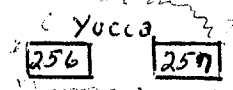
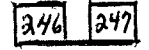
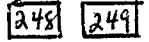
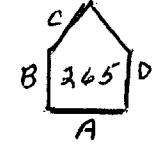
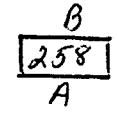
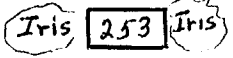

Grass Broken line --- denotes pathway Pump (CS) corner stone Grass
 "EAST" "Pine Street" "EAST"

Driveway

"West"

Section "D"

"West"

Driveway

Fence

Driveway

"North"

Fence

Driveway

"North"

Fence

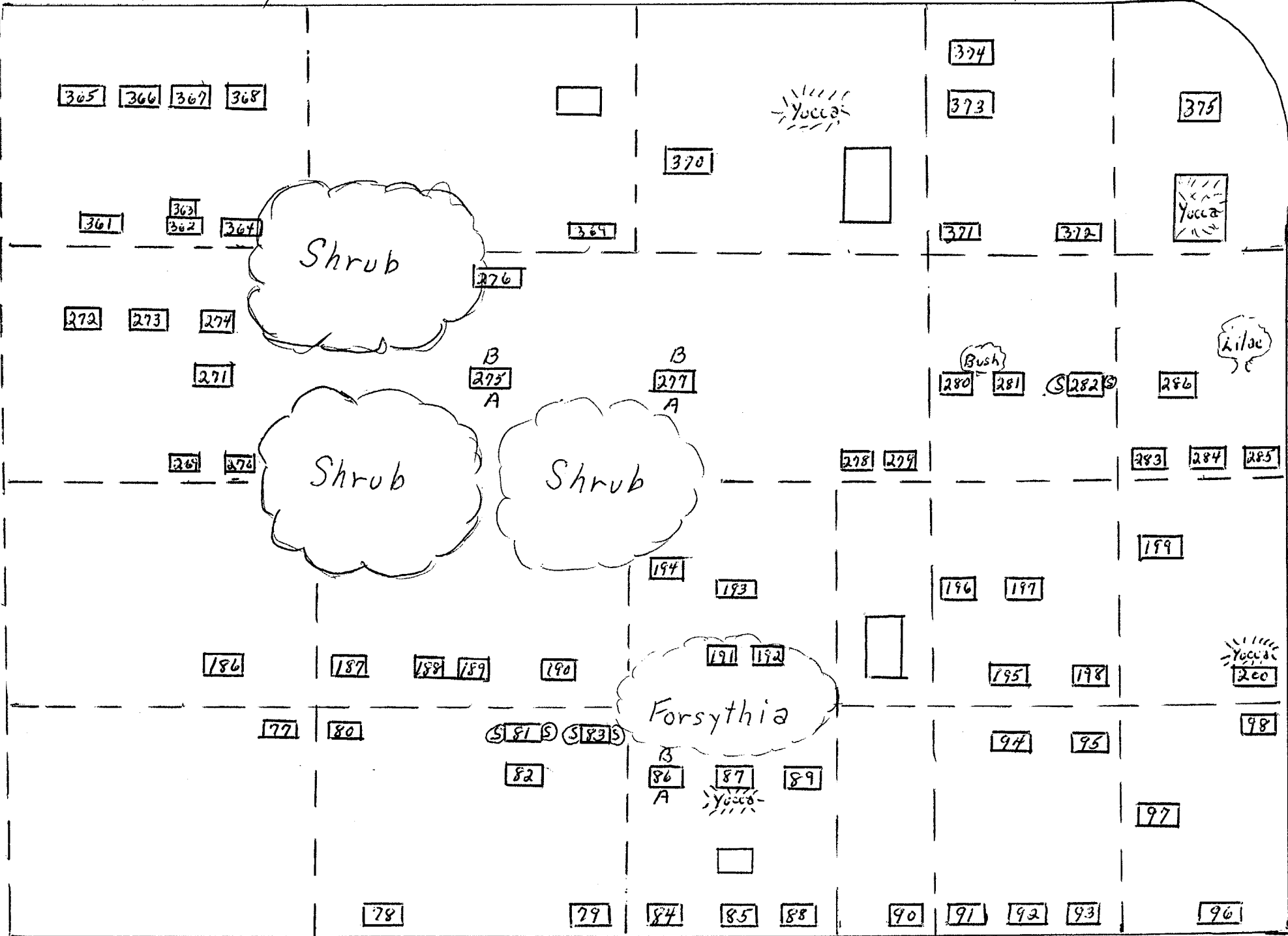

Grass Broken line --- denotes pathway ⊙ Shrub
 Wall "Pine Street" Wall "EAST"

"WEST"

Section F
west of section B

WEST

woods

woods

387

388

389

390

391

393

392

395

394

396

Driveway

"EAST"

"EAST"

Woods

"WEST"

Section "E"
west of section A

"WEST"

woods

woods



377

B

376

A

378

379

380

381

382

383

B

386

A

385

384



Blue
Spruce

Driveway

"EAST"

"EAST"

Fence = ||

"WEST"

Section H
west of section D

"WEST"

woods

woods

A 425 A

428 430

426 427 429

408 409 410

435 436 438

432 433

431 437 437

411 412

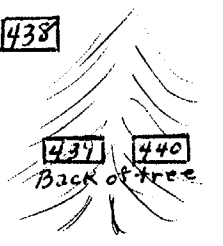

Fence

Driveway

"EAST"

"EAST"

"WEST"

woods

Section "G"
west of section C

woods

"WEST"

416
+

413 414 415 418 419

417

401 402 420

400

399 403
B
A

397 398

421 423 441 424

422

405

404

B
406
A

B
407
A

Driveway

"EAST"

"EAST"

STONE #	NAME	DOB	DOD	AGE	OTHER INFORMATION
55	Allen, George F.	1853	2, Mar. 1934	81y 1m 6d	hus. Sarah E. (Dunham), son James M. & Harriet (Drew)
177	Allen, Rhoda A. (Mrs. Bradford)		12, Aug. 1888	49y 11m 24d	wife William Bliss
55	Allen, Sarah E. (Dunham)	1852	14, June 1925	73y 4d	wife George F., dau. Rufus & Hannah (Westgate) Dunham
176	Allen, William Bliss		8, Feb. 1902	80y 7m 19d	hus. Rhoda A. (Mrs. Bradford)
386 A	ASHLEY				
339	Ashley, Andrew J.			7 wks	children of, son Andrew J. & Mary J., dbl. heart stone
385	Ashley, Elton Allen	14, April 1921	4, Jan. 1999		BM2 U.S. Navy WW 2
386 B	Ashley, Elton A.	1921	1999		hus. Susan H., son Allen C. & Ada W. (Snell)
339	Ashley, Mary			7 wks	children of, dau. Andrew J. & Mary J. Ashley, dbl. heart stone
340	Ashley, Maurice Joy		25, May 1882	11y 5m 7d	son Andrew J. & Mary J.. Stone broken flat on ground
386 B	Ashley, Susan H.	1927			wife Elton A.
384	Ashley, Susan H.	13, July 1927			wife Elton A.
83	Bassett, Arthur E.	25, Sept. 1916	5, Sept. 1991	74y	hus. Florence H. (Bumpus), son Arthur A. & Nellie (Benson)
83	Bassett, Florence H. (Bumpus)	12, June 1916			wife Arthur E., dau. George & Lilly (Sherman) Bumpus
81	Bassett, Robert W. "Bean"	1939	1994		In Loving Memory. In the Wind.
82	Bassett, Robert W.	11, Sept. 1939	9, Oct. 1994	55y	A2C U.S. Air Force, peacetime, son Arthur E. & Florence H. (Bumpus)
258 B	Bennett, Joseph	1779	2, July 1856	77y	hus. Patience (Nye)
258 B	Bennett, Joseph Jr.	10, May 1818	7, June 1832	14y 28d	son Joseph & Patience (Nye)
258 B	Bennett, Patience	1, April 1813	21, July 1835		dau. Joseph & Patience (Nye) Bennett
258 B	Bennett, Patience (Nye)	14, June 1777	1857		wife Joseph
259	Bennett, Richard	7, Feb. 1822	8, May 1892	70y	carpenter, son Joseph & Patience (Nye)
369	Besse, Catherine M.	1915	1961		
369	Besse, Mary A.	1880	1963		wife Thomas H.
369	Besse, Mary E. (Roberts)	1855	10, April 1906	51y 10m 12d	wife Lewis N., dau. Solomon & Mary E. (Flower) Roberts
369	Besse, Thomas H.	1887	1941		hus. Mary A.
361	Bettencourt, Antone J.	1867	7, Jan. 1928	59y 5m 21d	hus. Lena (Silva/Sylvia), son Sebastia & Mary
364	Baby				
408	Bettencourt, George F.	18, March 1908	17, Oct. 1962	54y 6m 29d	FD, hus. Hazel E. (Geggatt), son Antone J. & Lena (Silva/Sylvia)
408	Bettencourt, Hazel E. (Geggatt)	1921	14, June 1982	60y	wife George F., 2nd Arthur L. Kenney
282	Bettencourt, Ila E. (Holmes)	1906	1985		wife John J.
367	Bettencourt, Joaquim J.	1, July 1896	3, April 1955		hus. Josephine

282	Bettencourt, John J.	6, June 1903	1950		hus. Ila E. (Holmes), son Antone & Lena (Silva/Sylvia)
368	Bettencourt, Jokie J.	1, July 1896	3, April 1955		Massachusetts Pvt. 7 Co 151 Depot Brigade WW1
367	Bettencourt, Josephine	20, May 1909	31, March 1961		wife Joaquim J.
361	Bettencourt, Lena (Silva/Sylvia)	1867	27, Dec. 1948	81y 3m	wife Antone J., dau. Manuel Silva/Sylvia
361	Bettencourt, Lewis	3, April 1905	14, Feb. 1906	10m 11d	son Antone J. & Lena (Silva/Sylvia)
362	Bettencourt, Mary Lena	7, Feb. 1892	28, May 1965	73y 3m 21d	dau. Antone J. & Lena (Silva/Sylvia) Bettencourt
363	Mary L.				in back of 362
17	Blackmer, Charles M.	1821	10, Dec. 1868	47y	Father, hus. Emily M. (Sears)
17	Blackmer, Edward L.	14, Nov. 1847	8, Aug. 1862	14y	son Charles M. & Emily M. (Sears)
19	Edward (Blackmer)				Killed by lightning.
17	Blackmer, Emily M. (Sears)	1828	1889		Mother, wife Charles M.
131	Blackwell, Elizabeth		1, June 1851	86y 8m	wife Caleb
132 ft	E. B.				
2	Bolles, Lucinda T.		31, Jan. 1872	53y	wife William N.
4 ft	L. T. B.				
5	Bolles, Myra		21, April 1863	6y 3m	dau. William N. & Lucinda T. Bolles, stone flat on ground
7 ft	M. B.				
6	Bolles, Nellie		5, April 1863	9y 2m	dau. William N. & Lucinda T. Bolles
8 ft	N. B.				
1	Bolles, William N.		1, April 1863	55y	hus. Lucinda T.
3 ft	W. N. B.				under tree in back of trunk
413	Boulay, Rose (Renault) (Daley)	1902	2, Aug. 1976	74y	dau. Joseph & Josephine (Poulin) Renault
323	Bradford, Daisy (Parker)	1897	1918		wife Joseph E.
322	Bradford, George H.		25, April 1857	2y 2m 23d	son Henry C. & Rhoda A. (Taber)
324 ft	G. H. B.				
319	Bradford, Harvey	1809	6, Oct. 1841	32y	hus. Wealthy C. (Hathaway), son Samuel & Lucy (Churchill)
179	Bradford, Joseph R. W.	20, Nov. 1867	18, Nov. 1946	78y 11m 28d	hus. Lottie (Collins), son Henry C. & Rhoda A. (Taber)
323	Bradford, Joseph W.	19, Dec. 1917	1918		son Joseph E. & Daisy (Parker)
200	Bradford, Lottie M. (Collins)	1890	23, July 1962	72y 6m 14d	wife Joseph R. W.
321	Bradford, Olive A. (Collins)	1864	9, Sept. 1926	62y 6m 6d	wife Walter B., dau. John & Patience (Wordell) Collins
321	Bradford, Walter B.	1858	30, Nov. 1927	69y 11m 26d	hus. Olive A. (Collins), son Henry C. & Rhoda A. (Taber)
320	Bradford, Wealthy C. (Hathaway)		11, April 1863	53y 11m 12d	wife Harvey, dau. Joseph & Experience (Cowing) Hathaway
252	Braley, Hannah M. (Hall)	1829	7, May 1905	76y 9m 26d	wife Capt. Jason L., dau. Allen & Almira (Mendall) Hall
252	Braley, Jason L., Capt.	4, Oct. 1824	11, Oct. 1904	80y 7d	hus. Hannah M. (Hall), son Elisha K. & Delia (Sherman)
230	BRYANT obelisk				
222	Abigail (Bryant)				

223	Charles (Bryant)				
221	Elizabeth (Bryant)				
217	Father (Bryant)				
224	Hannah (Bryant)				
220	Mary (Bryant)				
218	Mother (Bryant)				
219	William (Bryant)				
230 A	Abigail				dau. William (Billa 2nd) & Mary (Marcy) (Johnson) Bryant
230 D	Bryant, Abigail	30, Aug. 1822	April 1902		
230 A	Charles				son. William (Billa 2nd) & Mary (Marcy) (Johnson)
230 D	Bryant, Charles R., Capt.	9, May 1820	2, July 1903	83y	hus. Hannah (Eldridge). 1st Governor of Alaska. Washington Senator Sumner stated that "next to myself, you owe it to Captain Bryant that we were successful in purchasing so valuable a territory" upon purchase of Alaska from Russia. He was appointed as Special Treasury Agent to govern Alaska in 1868. In 1869 Alaska was made a reservation and he was placed in complete charge. He served nearly eight years.
230 B	Bryant, Charles W.	June 1858	6, April 1859		son Joseph & Susan A. (Staples)
227	Charles		6, April 1859	9m 10d	son Joseph & Susan A. (Staples)
230 B	Bryant, Charles W. 2nd	June 1866			son Joseph & Susan A. (Staples)
230 B	Bryant, Eliza R. T.	April 1850	May 1852		dau. Joseph & Susan A. (Staples) Bryant
226	Eliza		6, May 1852	1y 20d	dau. Joseph & Susan A. (Staples) Bryant
230 A	Elizabeth				dau. William (Billa 2nd) & Mary (Marcy) (Johnson) Bryant
230 D	Bryant, Elizabeth	Aug. 1825	Jan. 1893		
230 A	Hannah				dau. William (Billa 2nd) & Mary (Marcy) (Johnson) Bryant
230 D	Bryant, Hannah (Eldridge)	July 1822	Feb. 1897		wife Charles R., Capt.
230 A	Joseph				son William (Billa 2nd) & Mary (Marcy) (Johnson)
230 B	Bryant, Joseph	22, March 1815	June 1875		hus. Susan A. (Staples)
230 B	Bryant, Joseph H.	17, Feb. 1849	May 1878		son Joseph & Susan A. (Staples)
230 B	Bryant, Lydia H. T.	Nov. 1846	Aug. 1874		dau. Joseph & Susan A. (Staples) Bryant
230 A	Bryant, Mary (Marcy) (Johnson)	28, Mar. 1787	6, Oct. 1875	88y 6m 8d	wife William (Billa 2nd)
230 C	Bryant, Ruel	3, July 1807	20, April 1896	87y	son Billa & Abigail
228	Ruel				
230 B	Bryant, Susan A. (Staples)	1, Sept. 1822			wife Joseph
230 A	Bryant, William (Billa 2nd)	8, Feb. 1789	6, July 1863	74y	hus. Mary (Marcy) (Johnson), son William (Billa) & Abby
230 A	William				son William (Billa 2nd) & Mary (Marcy) (Johnson)

230 A	William T.				son William (Billa 2nd) & Mary (Marcy) (Johnson)
230 C	Bryant, William T.	27, Aug. 1830	29, Sept. 1863	33y	Co D 28 Reg. Mass, Civil War soldier, who died at Barton Rouge, LA
230 C	Bryant, Zilpha	24, Sept. 1787	Jan. 1857		dau. Billa & Abigail Bryant
229	Zilpha				
90	Bugbee, Cynthia A. (Ellis)	1857	13, Oct. 1927	71y 5m 25d	wife Charles W., dau. Judah Ellis
350	BUMPUS obelisk				
188	Bumpus, Allen	1800	1887		Father, hus. Lucy S. (Morton)
187	Bumpus, Ansel M.	7, Aug. 1823	23, May, 1882	58y 9m 19d	son Allen & Lucy S. (Morton)
79	Bumpus, Bartlett M.	8, Sept. 1867	21, Mar. 1942	74 y	hus. Bessie (Sherman) Howard, son Elisha M. & Sophia A. (Hudson)
90	Bumpus, Charles Elisha	20, Aug. 1860	1, Nov. 1934	74y	son Elisha M. & Sophia A. (Hudson)
350 A	Bumpus, Elisha M.	20, Oct. 1835	27, Feb. 1900	64y 4m 7d	Grand Army of the Republic, Ass't Engineer U.S.S. "Tyler" Civil War Navy, blacksmith, hus. Sophia A. (Hudson), 2nd Susan B. (Lawrence), son Allen & Lucy S. (Morton)
350 C	Bumpus, Frederick	18, Aug. 1868	18, Oct. 1868	2m	son Elisha M. & Sophia A. (Hudson)
78	Bumpus, George W.	1865	20, Nov. 1942	77y	hus. Lillie M. (Sherman), son Elisha M. & Sophia A. (Hudson)
350 C	Bumpus, James H.	22, Oct. 1862	1, July 1913		son Elisha M. & Sophia A. (Hudson)
351	J. H. B.				
190	Bumpus, Jeremiah	10, Feb. 1830	1906		hus. Susan Davis (Alden), son Allen & Lucy S. (Morton)
78	Bumpus, Lillie M. (Sherman)	6, April 1879	3, May 1936	57y 1m	wife George W., dau. John W. & Nellie (Ellen Braley) Sherman
189	Bumpus, Lucy S. (Morton)	1804	31, Mar. 1892	'88y	Mother, wife Allen
350 B	Bumpus, Sophia A. (Hudson)	5, Feb. 1837	3, June 1870	33y	wife Elisha M.
350 D	Bumpus, Susan B. (Lawrence)	19, Jan. 1839	25, May 1900	61y 4m 6d	wife Elisha M., dau. Elisha H. & Sylvia (Ashley) Lawrence
190	Bumpus, Susan Davis (Alden)	1852	1937		wife Jeremiah
350 C	Bumpus, William F.	11, Aug. 1868	11, Oct. 1868	2m	son Elisha M. & Sophia A. (Hudson)
253	Burke, Andrew H.	1880	10, May 1966	86y 4m 9d	hus. Julia L. (Sherman), son Matthew & Annie (Clark)
253	Burke, Julia L. (Sherman)	1883	17, July 1972	89y 1m 9d	wife Andrew H., dau. John W. & Ellen (Braley) Sherman
414	Burke, Robert A. Sr.	22, Sept. 1908	25, Jan. 1989	80y	hus. Yvonne A. (Bourbeau), son Andrew H. & Julia L. (Sherman)
415	Burke, Robert A. Jr.	30, Oct. 1928	9, June 1998		PFC U.S. Army Korea, son Robert A., Sr. & Yvonne A. (Bourbeau)
416	Burke, Robert A. 3rd	9, June 1966	11, Aug. 1999		son Robert A. Jr.
414	Burke, Yvonne A. (Bourbeau)	5, Oct. 1908	9, May 1988	79y	wife Robert A. Sr., dau. Jean B. & Marie (Samson) Bourbeau
96	Burris, Oliver P.	1849	1912		hus. Sarah. M. (Healy), stone flat on ground
96	Burris, Sarah M. (Healy)	5, Mar. 1868	1935		wife Oliver, dau. George F. & Sarah (Gammons) Healy
89	Callahan, Edith	1881	1920		In memory of

62	Cannon, Charles E.	1827	1913		hus. Lucy C.
62	Cannon, Lucy C.	1825	1917		wife Charles E.
282	Carr, Hazel B.	1924	1998		wife Francis A.
282	Carr, Francis A.	1924	2001		hus. Hazel B.
275 B	Caswell, Gladys W. (West)	14, May 1898	2, Feb. 1970		dau. Charles G. & Harriet E. (Wilson) West
434	Caswell, Warren H.	14, Nov. 1920	29, Mar. 1995		Sgt. U.S. Army WW 2
422	Chadwick, Arnold	7, Feb. 1918	11, Nov. 1994		Tec 4 U.S. Army WW 2
423	Chadwick, Arnold	1918	1994	76y	FD, hus. Edna F. (Harder), son Arnold & Emma (Greenfield)
423	Chadwick, Edna F. (Harder)	1917			wife Arnold
178	Chase, Flora A. (Bradford)	13, May 1871	13, June 1950	79y 1m	wife Henry D., dau. Henry C. & Rhoda A. (Taber) Bradford
178	Chase, Henry D.	23, Aug. 1868	5, Feb. 1936	67y 5m 12d	hus. Flora A. (Bradford), son Nathan & Maryetta (Covell)
341	Coleman, Susan B.		22, Mar. 1888	67y 1m 6d	wife Thomas H.
435	Coles, Albina I. (Repsys)	26, July 1923	22, Dec. 1993	70y	wife Rudolph H., dau. Felix J. & Elizabeth (White) Repsys
435	Coles, Rudolph H.	1923			hus. Albina I. (Repsys)
200	Collins, Ellen M. (Soule/Sowle)	1868	14, April 1924	55y 4m 21d	(Nellie Marie) wife John, dau. Frederick & Mary (Cornell) Soule/ Sowle
241	Cook, Susan E. (Bryant)		22, Oct. 1865	22y 23d	wife Edward B., dau. Joseph & Susan A. (Staples) Bryant
242 ft	S. E. C.				
332	Corey, Jared Miles		20, July 1973	new born	Next to # 333 WEST
127	Crapo, Alice		16, May 1880	82y	dau. Nicholas & Meribah (Cook) Crapo
128 ft	A. C.				
238 A	Crapo, Augusta H.	1822	11, Dec. 1876	54y 3m 13d	Mother, wife Humphrey R. C.
294	Crapo, Deborah H. (Sherman)		20, Dec. 1890	79y 11m 20d	wife Luther C., dau. John Sherman
129	Crapo, Earl		15, Nov. 1839	32y	hus. Laura
137	Crapo, Elizabeth H.		1, Aug. 1842	1y 11m	dau. Nicholas & Phebe Crapo
138 ft	E. H. C.				
238 C	Crapo, Henry C.	1850	1853		son Humphrey R. C. & Augusta H.
240	Crapo, Henry Clarence	6, July 1850	28, Dec. 1853	3y 5m 22d	son Humphrey R. C. & Augusta H.
238 A	Crapo, Humphrey R. C.	1820	19, Mar. 1903	82y 9m 24d	Father, hus. Augusta H., 2nd. Louisa (Wood) (Demoranville), son Humphrey & Susan (Baker)
56	Crapo, John A.	3, June 1799	10, Jan. 1892	92y	hus. Lydia B. (Taber), son John & Linda
129	Crapo, Laura (Crapo)		4, May 1871	65y 10m	wife Earl, dau. Nicholas & Meribah (Cook) Crapo
130 ft	L. C.				
238 C	Crapo, Lillie F. H.	1853	1917		dau. Humphrey R.C. & Augusta H. Crapo
238 B	Crapo, Louisa (Wood) (Demoranville)	1840	1906		wife Humphrey R. C., dau Josiah & Louisa (Downing) Wood
237	L. C.				

293	Crapo, Luther C.	3, June 1802	18, Dec. 1890	88y 6m 16d	hus. Sally H. (Omans), 2nd Deborah H. (Sherman), son John & Linda (Bisbee), stone broken
56	Crapo, Lydia B. (Taber)	1800	1867		wife John A.
133	Crapo, Nicholas		8, April 1865	46y	died in Fall River, MA
134 ft	N. C.				
126	Crapo, Philip	1796	3, Feb. 1874	77y 9m 27d	hus. Sally H. (Blackwell)
126	Crapo, Sally H. (Blackwell)	29, Oct. 1794	30, Jan. 1864		wife Philip, dau. Caleb & Elizabeth Blackwell
291	Crapo, Sally H. (Omans)	8, Aug. 1804	19, Mar. 1856	51y	wife Luther C., dau. Job Omans & Sally
292 ft	S. H. C.				
135	Crapo, Sarah F.		29, Sept. 1839	6m	dau. Nicholas & Phebe Crapo
136 ft	S. F. C.				flat on ground and upside down
126	Crapo, Sarah H.	6, May 1824	1902		dau. Philip & Sally H. (Blackwell) Crapo
238 C	Crapo, Sarah T.	1846	1917		dau. Humphrey R. C. & Augusta H. Crapo
238 C	Crapo, Susan R.	1844	1929		dau. Humphrey R. C. & Augusta H. Crapo
238 D	Blank				
354	Cromwell, Jane M. (Sherman)	19, Jan. 1835	22, Jan. 1902		wife Joseph H., dau. Thomas & Jane W. (Bonney) Sherman
354	Cromwell, Joseph H.		1, April 1858		Civil War Navy, lost at sea, hus. Jane M. (Sherman).
139	Cushing, Elizabeth (Parlow)	12, July 1818	1891		wife Joab, dau. Jesse & Sally Parlow
149	Cushing, Fannie				
150	Cushing, George				
139	Cushing, George W.	1857	1860		son Joab & Elizabeth (Parlow)
142	G. W. C.				
139	Cushing, Isaac T.	1847	1869		son Joab & Elizabeth (Parlow)
141	I. T. C.				
146	Cushing, James				
148	Cushing, Jane				
145	Cushing, Jeremiah T.	6, Aug. 1811	1, July 1850	41y	hus. Mary Ann (Sherman). In memory of
139	Cushing, Joab	1814	4, Feb. 1892	78y	hus. Elizabeth (Parlow), son Elijah & Mary
139	Cushing, Joseph W.	1848	1876		son Joab & Elizabeth (Parlow)
140	J. W. C.				
139	Cushing, Lemuel W.	1853	1860	7y	son Joab & Elizabeth (Parlow)
143	L. W. C.				
147	Cushing, Lydia				
145	Cushing, Mary Ann (Sherman)				wife Jeremiah T. In memory of
144	Mother				
60	Cushman, Dorcas P.	14, May 1830	21, April 1913		wife Jesse M.

58	Cushman, Gilson H.	26, Aug. 1800	13, Feb. 1858	57y 5m 17d	hus. Susan H. (Purrington), son Ezekiel & Abigail
60	Cushman, Jesse Martin	27, Nov. 1826	17, May 1902	75y 5m 20d	hus. Dorcas P., son Gilson H. & Susan H. (Purrington)
59	Cushman, Susan H. (Purrington)	13, Mar. 1805	3, Dec. 1875	70y 8m 20 d	wife Gilson H.
14	DAMON obelisk				
14 D	Blank				
14 B	Damon, Charles B.	24, Nov. 1857	19, April 1865		son Charles H. & Phebe N. (Douglass)
9	C. B. D.				
14 A	Damon, Charles H.	13, Aug. 1826	5, Dec. 1889		hus. Phebe N. (Douglass)
11	C. H. D.				
14 C	Damon, Harriet E. (Pierce)		1869	1968	wife Louzon A.
12	H. E. D.				
14 C	Damon, Louzon A.	2, Feb. 1868	2, Mar. 1903		hus. Harriet E. (Pierce)
13	L. A. D.				
14 A	Damon, Phebe N. (Douglass)	18, May 1832	16, Feb. 1903		wife Charles H., dau. Barnabas N. & Phebe N. (Swift) Douglass
10	P. N. D.				
243	Davenport, Andrew B. C.	2, May 1849	15, April 1907		hus. Hattie R.
243	Davenport, Hattie R.	16, Feb. 1856	4, Feb. 1945		wife Andrew B. C.
360	Davis, George F.		1890		Father
359	Davis, John F.		1910		Grandfather
32	Dexter, Ebenezer, Capt.		1, Jan. 1854	35y 8m 22d	Erected to the memory of Capt. Ebenezer Dexter of the barque Oscar of Mattapoisett, who was killed by a whale in Margarita Bay. hus. Jane C. (Shaw), son Ebenezer & Desire
335	Dexter, Leatha L. West		1917	1975	
101	Dougall, Bessie Sherman (Corse)	9, Jan. 1908	17, July 1990	82y	wife James R., dau. Samuel L. & Melissa F. (Sherman) Corse
101	Dougall, James Reid		1905	1984	hus. Bessie Sherman (Corse)
102	J. R. D.				
16 A	Douglass, Barnabas Nye	11, Nov. 1791	9, Mar. 1873	81y	GAR, hus. Phebe N. (Swift), son George & Patience (Savory)
15	Douglass, Charles A.	26, Oct. 1853	19, Aug. 1930	76y 9m 24d	hus. Ella C. (Hoagland), son Barnabas N. & Phebe N. (Swift)
15	Douglass, Ella C. (Hoagland)	19, Dec. 1856	2, July 1911	55y 6m 13 d	wife Charles A., dau. Elijah & Emeline (Whitlock) Hoagland
18	Douglass, Emma E. (Blackmer)	4, Sept. 1850	1, Mar. 1880	29y 6m	wife James O., dau. Charles M. & Emily M. (Sears) Blackmer
16 A	Douglass, George	20, May 1834	1836		son Barnabas N. & Phebe N. (Swift)
16 B	Douglass, George	1763	10, Mar. 1843	80y	hus. Patience (Savory)
16 B	Douglass, Patience (Savory)	22, Mar. 1772	1, Dec. 1863	91y	wife George, dau. Joseph Savory
16 A	Douglass, Phebe N. (Swift)	1809	11, Oct. 1886	77y 6m	wife Barnabas N.
424	Dziewit, Eugenia B.	1914	1982		A proud woman. A gentle smile.
406 A	Dziewit, Eugene J.	1914	2001		hus. Johanna (Bobrowiecki)

406 A	Dziewit, Johanna (Bobrowiecki)	1910	1977		wife Eugene J.
208	Eddleston, Gladys W. (Sylvia)	1908			wife Herbert
208	Eddleston, Herbert	1903	10, Sept. 1977	73y 9m 17d	hus. Gladys W. (Sylvia), son Edward & Mary (Proctor)
417	Eddleston, Neal E.	1, April 1937	11, April 1993		EM 2 U. S. Navy, Korea
418	Eddleston, Neal E.	1937	1993	56y	son Herbert & Gladys (Sylvia)
425	Edison, Mary E. (Cosman)	1914			wife Thomas A. E.
425	Edison, Thomas A. E.	10, Nov. 1913	25, Aug. 1984		hus. Mary E. (Cosman), son Thomas & Susan (Spencer)
225	Eldridge, Hannah	June 1796	Jan. 1890		Mother, widow of Phineas
35 B	Ellis, Ella C. (Vaughan)	1856	1913		dau. Leonard & Amelia C. Vaughan
427	Ferreira, Joseph J.	26, Dec. 1921	2, Mar. 1995		Cpl. U. S. Army Air Corps WW 2
428	Ferreira, Joseph J.	26, Dec. 1921	2, Mar. 1995	73y	hus. Roberta (Reynolds), son John & Virginia (Jesus)
428	Ferreira, Roberta (Reynolds)	20, Aug. 1926	23, Aug. 1997	71y	wife Joseph J., dau. James & Grace Reynolds
185	FLETCHER obelisk				
185	B - C - D - Blank				
185 A	Fletcher, Charles E.	1857	29, June 1883	26y 3m 22d	son Daniel & Mary
182	C. E. F.				
185 A	Fletcher, Daniel	1822	11, Sept. 1898	76y	hus. Mary
184	D. F.				
185 A	Fletcher, Mary	1818	13, Aug. 1898	79y 11m	wife Daniel
183	M. F.				
405	Foley, Joan (Dziewit)	1933	10, Aug. 2001	67y	wife John P., dau. Eugene J. & Johanna R. (Bobrowiecki) Dziewit
404	Foley, John F.	14, Sept. 1920	14, Oct. 1981	61y	CS 1 U. S. Navy WW 2 & Korea
405	Foley, John P.	1920	1981		hus. Joan (Dziewit)
156 A	Freeman, Abbie F. (Sears)	5, Mar. 1837	23, July 1919	82y 4m 18d	wife 1st Charles A. Howland 1856, 2nd George W. Palmer 1870, 3rd George H. Waterman 1880, 4th Charles S. Freeman 1885, dau. Nathaniel & Abbie (Thatcher) Sears
151	A. F. F.				
161 A	GAMMONS obelisk				
161 C	Blank				
161 D	Gammons, Benjamin	1832	15, July 1903	71y 5m 3d	Civil War soldier, shoemaker, hus. Mary J. (Dieringer), son Noble B. & Roxanna (Swift)
164	BENJ				
193	Gammons, Franklin A.	12, Feb. 1844	18, May 1895		
191	Frank				In back of forsythia
193	Gammons, James C.	17, Oct. 1853	13, Oct. 1908		hus. Lydia J.

194	Father				
193	Gammons, Lydia J.	4, Dec. 1856	17, May 1941		wife James C.
338	Gammons, Mary G.		13, July 1896	82y 3m 21d	Mother, wife William Jr.
161 D	Gammons, Mary J. (Dieringer)	1842	29, Dec. 1897	55y 2m 19d	wife Benjamin
163	MAY.				
161 D	Gammons, Noble B.	1805	6, April 1887	81y 6m 2d	hus. Roxanna (Swift)
159	Father				
161 D	Gammons, Roxanna (Swift)	1803	28, May 1872	68y 5m 22d	wife Noble B.
160	Mother				
193	Gammons, Sarah P.	17, Aug. 1814	8, Dec. 1899		
192	Grandmother				In back of forsythia
337	Gammons, William Jr.		26, Aug. 1851	39y 10m	Father, hus. Mary G.
394	Garcia, Joseph A.	23, Jan. 1908	23, Aug. 1974		Tec 5 U. S. Army WW 2
395	Garcia, Joseph A.	1908	1974		hus. Virginia (Jackson)
395	Garcia, Virginia (Jackson)	1917			wife Joseph A.
95	Geggatt, Ethel R.	1894	1969		wife John S.
94	Geggatt, Florence M. (Sherman)	28, Dec. 1875	1957		wife John Jr., dau. John C. & Nancy W. (Taber) Sherman
94	Geggatt, John Jr.	1873	1955		hus. Florence M. (Sherman)
95	Geggatt, John S.	1896	1973		hus. Ethel R.
383	GILMORE				
382	Gilmore, Carolyn S. (Kirby)	1922			wife Stephen
381	Gilmore, Stephen	1923			hus. Carolyn S. (Kirby)
433	Gomes, Violet A. (Bariteau)	17, Nov. 1929	24, Mar. 1997		MOTHER, dau. Henry & Mary (Lafreniere) Bariteau
180	Gonet, Ella B. (Savaria)	1911	1998		wife Stanley W., dau. Charles & Olive (Bradford) Savaria
180	Gonet, Stanley W.	1910	1985		hus. Ella B. (Savaria)
429	Gray, George M.	25, Dec. 1918	10, April 1997		Pvt U. S. Army WW 2
430	Gray, George M.	1918	1997	78y	hus. Mary F. (Vaughan), son George & Ella (Macomber)
430	Gray Mary F. (Vaughan)	30, Nov. 1924			wife George M., dau. Harold G. & Lena (Bettencourt) Vaughan
349	Greenwood, Clara Bell			7m 13d	dau. James & Harriet Greenwood
349	Greenwood, Harriet (Holmes)		1, Jan. 1883	44y	not all readable, wife James, dau. David & Elizabeth Holmes
349	Greenwood, Richard	12, Mar. 1884	18, April 1884	1m 6d	son James & Alice (Law)
380	Gurney, Annie (Hartley)	15, Nov. 1902	1989		wife Ralph E., dau. James & Annie L. (Snell) Hartley
380	Gurney, Ralph E.	1899	1995		hus. Annie (Hartley)
57	Hall, Agnes D. (Allen)	1877	19, Dec. 1959	82y 17d	wife William T., dau. George F. & Sarah (Dunham) Allen
246	Hall, Allen	10, Feb. 1798	14, Oct. 1877	79y 8m	hus. Almira (Mendall), son George & Patience. Stone broken.
248 ft	A. H.				

247	Hall, Almira (Mendall)		19, Oct. 1878	76y 2m	wife Allen
249 ft	A. M. H.				
57	Hall, Margaret D.	1905	29, April 2000		dau. William T. & Agnes D. (Allen) Hall
57	Hall, William T.	1874	4, Jan. 1957	82y 5m	hus. Agnes D. (Allen), son Anthony & Mary (Soule)
265	HARTLEY obelisk				
265 D	Hartley, Ann (Emmett)	1828	5, Sept. 1906	77y 2m 25d	wife Greenwood, dau. Isaac & Esther (Haworth) Emmett
263	A. H.				
265 B	Hartley, Annie L. (Snell)	25, Aug. 1866	31, May 1961	94y 9m 6d	wife James, dau. Isaiah Hatch & Hannah T. (Bradford) Snell
261	A. L. H.				
265 C	Blank				
265 D	Hartley, Esther	1858	1870		dau. Greenwood & Ann (Emmett) Hartley
268	E. H.				
376 B	Hartley, Gladys M. (Rathfelder)	1921			wife J. Frazer
392	Hartley, Grace (Moncreiff)	12, April 1901	9, Mar. 1995		wife Henry B.
265 D	Hartley, Greenwood	1831	18, Aug. 1892	61y	hus. Ann (Emmett)
264	G. H.				
265 A	Hartley, Hannah E.	17, Jan. 1893	13, Feb. 1987	94y	dau. James & Annie L. (Snell) Hartley
262	H. E. H.				
392	Hartley, Henry B.	25, Jan. 1900	22, Jan. 1999		FD, hus. Grace (Moncreiff), son James & Annie L. (Snell)
393	Hartley, Herbert E.	2, Feb. 1918	21, Jan. 2000	81y	FD, Tec 5 U. S. Army WW 2, hus. Winifred B. (Schofield), son Daniel E. & Mary S. (Lawrence)
265 B	Hartley, Herbert T.	27, Aug. 1887	25, Nov. 1887	3m	son James & Annie L. (Snell)
267	H. T. H.				
376 B	Hartley, J. Frazer	1918	1986		hus. Gladys M. (Rathfelder), son James, Jr. & Marion M. (Frazer)
377	Hartley, J. Frazer	16, Feb. 1918	21, Nov. 1986		Ltjg U. S. Navy WW 2
265 B	Hartley, James	21, Jan. 1862	30, June 1918	56y 5m 9d	hus. Annie L. (Snell), son Greenwood & Ann (Emmett)
260	J. H.				
376 A	Hartley, James Jr.	14, Feb. 1891	1974		hus. Marion M. (Frazer), son James & Annie L. (Snell)
376 A	Hartley, Marion M. (Frazer)	1894	1982		wife James Jr.
265 B	Hartley, William	23, Sept. 1901	16, Nov. 1901	1m 24d	son James & Annie L. (Snell)
266	W. H.				
198 B	Higgins, Charles G.	1874	6, July 1954	80y 3m 16d	hus. Emily L. (Olson), son James E. & Susan
196	C. G. H.				
198 B	Higgins, Emily (Olson)	1877	13, Sept. 1939	61y	wife Charles G., dau. Olaf A. & Johanna (Peterson) Olson
197	E. O. H.				
195	Higgins, James E.	8, Dec. 1844	15, May 1920	75y 5m 7d	hus. Susan A., son Gideon & Ruth

195	Higgins, Susan A.	1845	1904	59y	wife James E.
104	Howard, Bessie B. (Sherman)	6, Jan. 1868	5, June 1936	68y	wife Preston, 2nd Bartlett M. Bumpus, dau. James G. B. & Lucina P. (Landers) Sherman
104	Howard, Preston	24, Oct. 1840	17, Mar. 1923	82y 4m 23d	hus. Bessie B. (Sherman), son Eliphalet & Sarah
156 B	Howland, James S.	1857	30, Nov. 1881	24y	Lost at sea, son Charles A. & Abbie F. (Sears)
76	Jackson, Abraham	1890	22, Sept. 1979	89y 3m 11d	hus. Lillian (Blower), son Abraham & Sarah (Brittle)
76	Jackson, Lillian (Blower)	1892	22, July 1978	86y 4m 5d	wife Abraham, dau. William & Mary Ann (Claighorn) Blower
358	Jenney, Charles A.	26, April 1911	27, Oct. 1982	71y	son Lewis A. & Florence E. (Davis)
358	Jenney, Florence E. (Davis)	1890	1976		wife Lewis A.
358	Jenney, Lewis A.	1888	1958		hus. Florence E. (Davis)
303	Jenney, Mr. Samuel		9, Mar. 1855	74th y	hus. Sarah (Perry), son Job & Hannah (Dexter)
305ft	S. J.				
304	Jenney, Mrs. Sarah (Perry)		24, Nov. 1851	69th y	wife Samuel, dau. Lemuel & Lydia (Babcock) Perry. Stone broken, flat on ground
209	Kelley, Joseph H.		25, July 1859	22y 2m	
426	Kenney, Arthur L.	28, July 1914	22, Feb. 1989	74y	hus. Alma (Rondelli), 2nd Hazel (Geggatt) Bettencourt, son Thomas & Della (Gregory)
387	Kirby, George A., 2nd	27, Aug. 1913	24, Aug. 1995	81y	hus. Ruth S. (Hartley), son Arthur C. & F. Mildred (Fearing)
387	Kirby, Ruth S. (Hartley)	30, Sept. 1914			wife George A., 2nd, dau. Daniel E. & Mary (Lawrence) Hartley
409	Kucharski, Arlene M. (Vaughan)	30, June 1929	22, June 1999		"Babe", dau. Harold G. & Lena (Bettencourt) Vaughan
99	Landers, Freeman		8, Mar. 1880	72y	
100 ft	F. L.				
232	LeBaron, James		8, Feb. 1858	53y	hus. Lucinda
231	LeBaron Lucinda		23, July 1856	51y 3m 15d	wife James
389	Lizotte, Edith I. (Reynolds)	1917			wife Leo N., dau. William A. & Nellie P. (Mosher) Reynolds
389	Lizotte, Leo N.	1916			hus. Edith I. (Reynolds) son Armand L. & Celina (Roy)
238 B	Luce, Violet L. (Crapo)	10, Sept. 1879	1967		wife George L., dau. Humphrey R. C. & Louisa (Wood) (Demoranville) Crapo
285	McCombe, F.		1900		
284	McCombe Janet (Ashworth)	1867	16, June 1935	67y 7m 3d	wife William, dau. Samuel & Mary (Sheard) Ashworth
286	McCombe, Marion (Sylvia)	1906	11, Feb. 1984		wife William Jr., dau. John L. & Cora B. (Gibbs) Sylvia
283	McCombe, William	1868	27, Aug. 1908	40y 4m 2d	hus. Janet (Ashworth), son James & Harriet (Sampson)
286	McCombe, William Jr.	9, Nov. 1908	21, May 1960	51y 6m 12d	hus. Marion (Sylvia), son William & Janet (Ashworth)
406 B	McIntyre, Nadia M. (Bobrowiecki)	14, Nov. 1904	2, June 1986	81y	wife William H., dau. Joseph & Salomea (Siwik) Bobrowiecki
406 B	McIntyre, William H.	1892	1974		hus. Nadia M. (Bobrowiecki)
433	Medeiros, Michael A.	27, April 1953	7, July 1995	42y	SON, son Antone & Violet (Bariteau)

299	Mendall, Hope W. (Rider)	1837	1859		wife Benjamin W., dau. Zachariah W. & Catherine (Clark) Rider
295	H. W. M.				
440	Morse, Alice E. M. (Bradford)	25, Oct. 1891	1971		wife Harold E., dau. Walter & Olive A. (Collins) Bradford
439	Morse, Harold E.	15, Oct. 1896	15, Jan. 1971		Massachusetts Pvt Co C 156 Dep Brig WW 1, hus. Alice E. M. (Bradford)
239	Norton, Elizabeth		5, Mar. 1861	64y	
378	Norton, Marie A. A. (Gosselin)	1912	13, April 1971	59y 2m 29d	wife Oscar L., dau. Fortunat & Mary-Ann (Caron) Gosselin
378	Norton, Oscar L.	2, Mar. 1905	18, Jan. 1990	84y	FD, hus. Marie A. A. (Gosselin), 2nd Shirley E. (Vaughan) Thompson, son Thomas & Irene (Phillips)
77	Nye, Abigail (Cole)	26, July 1797	29, May 1884	87y 10m	wife Ezekiel, dau. John & Rebecca Cole
288	Omans, Polly H.	1799	28, Feb. 1872	72y 3m 2d	dau. Job Omans
290 ft	P. H. O.				
287	Omans, Mrs. Sally		10, Jan. 1851	83y	wife Mr. Job Omans
289 ft	S. O.				
419	Ouellette, Arthur L. "Pee Wee"	22, Aug. 1934	12, Oct. 1999		hus. Joyce D., son Louis L. & Blanche (Willett)
403 B	Ouellette, Bernice E. (Lucas)	1932			wife Louis J.
419	Ouellette, Joyce D.	21, Feb. 1941			wife Arthur L.
441	Ouellette, Louis A.	21, Oct. 1952	9, Sept. 2001	48y	son Louis J. & Bernice E. (Lucas)
403 B	Ouellette, Louis J.	6, April 1931			hus. Bernice E. (Lucas), son Louis L. & Blanche (Willett)
403 A	Ouellette, Louis L.	8, Oct. 1904	1990		hus. M. Blanche, son Louis & Eugenia
403 A	Ouellette, M. Blanche (Willett)	19, Mar. 1908	10, Oct. 1987	79y	wife Louis L., dau. Mitchell & Delia (Ouellette) Willett
156 A	Palmer, George W.	1822	2, Mar. 1880	58y 7m	hus. Mary G., 2nd Abbie F. (Sears) (Howland)
152	G. W. P.				
156 A	Palmer, Mary G.	1821	14, June 1869	48y	wife George W.
153	M. G. P.				
38	Parsons, Sarah L. (Snell)	20, May 1841	1909		wife Louis J., dau. Otis H. & Mary Ann (Parker) Snell
63	Phillips, Addison H.	1854	1909		hus. Lizzie M. (Cannon)
63	Phillips, Lizzie M. (Cannon)	1855	1917		wife Addison H.
116	Pierce, Eliphalet		8 Feb. 1882	90y 4d	hus. Joanna
124	Pierce, Elizabeth F.	27, May 1859	3, Sept. 1863		dau. Josiah & Hannah (Bryant) Pierce
122	Pierce, Fannie W.	1869	1937		
125	Pierce, George A.	2, Mar. 1861	18, Aug. 1863	2y	son Josiah & Hannah (Bryant)
119	Pierce, Hannah (Bryant)	1, Mar. 1828	6, Nov. 1894		Mother, wife Josiah, dau. William (Billa 2nd) & Mary (Marcy) (Johnson) Bryant
123	Pierce, Infant son		27, Oct. 1865		
121	Pierce, J. Franklin		13, Oct. 1884	28y 11m	son Josiah & Hannah (Bryant)

117	Pierce, Joanna		13, May 1874	73y 1m	wife Eliphalet
119	Pierce, Josiah	4, July 1823	2, July 1903		Father, hus. Hannah (Bryant), son Eliphalet & Joanna
118	Pierce, Seabury B.	23, Sept. 1833	14, Feb. 1913		Co. G 149th Regt. P.A.V.M., son Eliphalet & Joanna
120	Pierce, William H.	17, April 1831	5, Nov. 1865	35y 6m 18d	GAR, son Eliphalet & Joanna
23	POPE obelisk (broken off)				
23 D	Blank				
21	Pope, Esther D. (Shaw)	10, Sept. 1820	4, Jan. 1907		wife Lewis S., dau. Lewis Shaw
23 C	Pope, Franklin West	15, July 1842	18, Aug. 1842	6wk 2d	only son Lewis S. & Esther D. (Shaw)
25	F. W. P.				
23 A	Pope, Jean M. C.	9, Oct. 1856	23, Dec. 1862	6y 2m 14d	youngest dau. of Lewis S. & Esther D. (Shaw) Pope went home
24	J. M. C. P.				
20	Pope, Lewis S.	16, Aug. 1812	20, June 1886		hus. Esther D. (Shaw)
22 ft	L. S. P.				
23 B	Pope (Unreadable)				
161 B	Porter, Helen (Rounseville)	24, Nov. 1904	2001		dau. Arthur & Harriet A. (Sherman) Rounseville
162	H. R. P.				
170 A	RANDALL				
170 B	Randall, Bernice C.	27, Mar. 1877	1879		dau. George H. & Harriet E. (LeBaron) (Ricketson) Randall
172	B. C. R.				
245	Randall, Betsey P. (Crapo)	12, June 1807	12, Jan. 1882	75y	wife Leander, dau. John & Linda M. (Bisbee) Crapo
170 B	Randall, E. Arthur	1918	1992		son Edgar F. & Fanny (Cudworth)
167	E. A. R.				
170 B	Randall, Edgar F.	10, April 1883	1982		hus. Fanny (Cudworth), son George H. & Harriet E. (LeBaron) (Ricketson)
169	E. F. R.				
170 B	Randall, Fanny (Cudworth)	1879	17, Nov. 1947	68y 1m 16d	wife Edgar F., dau. John & Sarah (Rounseville) Cudworth
168	F. C. R.				
279	Randall, George B.	4, Nov. 1894	13, June 1953		hus. Virginia C.
170 B	Randall, George C.	1915	12, Oct. 1955	39y 11m	FD, hus. Priscilla (Winterbottom), son Edgar F. & Fanny (Cudworth)
175	G. C. R.				
170 B	Randall, George F.	1939			hus. Irene (Bariteau), son George C. & Priscilla (Winterbottom)
171	G. F. R.				
170 B	Randall, George H.	23, July 1842	23, Dec. 1939	97y 5m	Civil War, hus> Mrs. Harriet E. (LeBaron) (Ricketson), son Leander & Betsey (Crapo)
165	Father				

170 B	Randall, Harriet E. (LeBaron)	11, Nov. 1842	6, April 1923	80y 4m 26d	wife George H., 1st James Ricketson, dau. James & Lucinda (Morton) LeBaron
166	Mother				
170 B	Randall, Irene (Bariteau)	15, Mar. 1932	6, Mar. 1995	62y	wife George F., dau. Homer & Lillian (Kilanowied) Bariteau
173	I. R.				
244	Randall, Leander	6, Oct. 1807	12, Sept. 1886	78y 11m 6d	hus. Betsey P. (Crapo), son Job & Marcia E. (Bates)
170 B	Randall, Priscilla (Winterbottom)	24, Sept. 1916	22, Oct. 1992	76y	wife George C., dau. Frederick & Nancy (Layland) Winterbottom
174	P. W. R.				
278	Randall, Virginia C.	13, Jan. 1883	16, Sept. 1969		wife George B.
371	Reed, Abram F.	1882	15, June 1961	78y 9m 16d	hus. Annie (Ennes), son Abram & Abbie (West)
373	Reed, Alice B. (Young)	1920			wife Arthur L.
371	Reed, Annie (Ennes)	1892	12, May 1957	65y 6m 24d	wife Abram F., dau. Manuel & Annie (Margarido) Ennes
373	Reed, Arthur L.	1920	1998	78y	FD, hus. Alice B. (Young), son Abram F. & Annie (Ennes)
374	Reed, Arthur L.	10, June 1920	10, Sept. 1998		Pvt U. S. Army WW 2
372	Reed, Florinda (Souza)	1919			wife Robert F.
372	Reed, Robert F.	8, Jan. 1919	1, Sept. 1955	36y 7m	FD, hus. Florinda (Souza), son Abram F. & Annie (Ennes)
156 B	Richards, Emilie (Emma) F.	1840	20, Aug. 1869	29y	dau. George W. & Mary G. Palmer
154	E. F. R.				
299	Rider, Catherine (Clark)	1799	1863		wife Zachariah W.
297	C. C. R.				
299	Rider, George M.	1830	20, Aug. 1849	19y 25d	son Zachariah W. & Catherine (Clark)
298	G. M. R.				
299	Rider, Zachariah W.	1800	1853		hus. Catherine (Clark)
296	Z. W. R.				
432	Rioux, Debra A. (Medeiros)	1954			wife Robert C., dau. Violet A. (Bariteau) (Medeiros) Gomes
432	Rioux, Robert C.	1941	1999	58y	hus. Debra A. (Medeiros), son Joseph & Lucienne (Levesque)
431	Rioux, Robert C.	23, Feb. 1941	11, Mar. 1999		SP4 U. S. Army
412	Robbins, Hilda (Pat) (Souza)	1924			wife James A., dau. Antonio M. & Diolinda R. Souza
412	Robbins, James A.	1922	1969		hus. Hilda (Pat) (Souza)
437	Robbins, James A.	25, Nov. 1922	10, Feb. 1969		PFC 107 Evac Hosp WW 2
438	Ross, Edwin J. Sr.	2, Sept. 1922	4, June 1980	57y	hus. Evelyn M. (Sleightholm), son Aleida & Anna (Krenmayer)
438	Ross, Evelyn (Sleightholm)	17, July 1924			wife Edwin J. Sr.
51	ROUNSEVILLE obelisk				
51 A	Rounseville, Alden	1797	7, Dec. 1881	83y	hus. Cornelia (Ashley)
47	A. R.				
51 C	Rounseville, Alden Jr.	10, April 1827	29, Oct. 1912	85y 6m 19d	hus. Roxanna (Gammons), son Alden & Cornelia (Ashley)

54	A. R. Jr.				
161 B	Rounseville, Arthur	17, May 1862	16, Sept. 1928	66y 3m 29d	hus. Harriet (Hattie) A. (Sherman), son Alden Jr. & Roxanna (Gammons)
157	A. R.				
51 B	Blank				
51 A	Rounseville, Cornelia (Ashley)	1802	1896		wife Alden
48	C. R.				
51 C	Rounseville, Ella	1864	21, April 1883	19y	dau. Alden Jr. & Roxanna (Gammons). She with her three cousins, Charles 8, Isabelle 10, Fanny 11, only children of Charles H. F. & Cornelia (Rounseville) Church and her friend Mary Phipps drowned in Snows Pond when their Mayflowering party boat overturned. Only her brother Albert made it to shore.
50	Ella				
161 B	Rounseville, Harriet A. (Sherman)	21, July 1865	21, Oct. 1963	98y 4m	wife Arthur, dau. Thomas A. & Lucy M. (Chase) Sherman
158	H. A. R.				
51 C	Rounseville, Horace	16, Apr. 1868	1940		son Alden Jr. & Roxanna (Gammons)
52	H. R.				
51 D	Rounseville, Horace A.	1830	1866		Civil War Navy, son Alden & Cornelia (Ashley)
51 D	Rounseville, Marcus M.	25, Feb. 1840	11, Feb. 1842		son Alden & Cornelia (Ashley)
51 D	Rounseville, Philena W.	1838	4, Feb. 1912	73y 8m 11d	dau. Alden & Cornelia (Ashley) Rounseville
49	P. W. R.				
51 C	Rounseville, Roxanna (Gammons)	17, Jan. 1836	18, Mar. 1920	84y 2m 1d	wife Alden, Jr., dau. Noble & Roxanna (Swift) Gammons
53	R. R.				
302	RYDER obelisk				
302 B	Ryder, Allen A.	17, Oct. 1846	21, Feb. 1864		Lost at sea, son Capt. Allen D. & Rebecca C. (Jenney)
302 A	Ryder, Allen D., Capt.	29, May 1815	6, Feb. 1890		hus. Rebecca C. (Jenney), son Zenas & Hepzebah
300	A. D. R.				
318	Ryder, Azuba H.	1833	1912		wife Barnabas C.
316	A. H. R.				
318	Ryder, Barnabas C.	1828	29, Oct. 1909	81y 10m 9d	Civil War, hus. Ruth B. (Crapo), 2nd Azuba H. , son Zachariah W. & Catherine (Clark) Rider
315	B. C. R.				
97	Ryder, Everett F.	23, July 1894	15, Nov. 1967		Massachusetts Pvt 5 Co 151 Depot Brig. WW 1
302 B	Ryder, George W.	15, Jan. 1843	28, Aug. 1861		Lost at sea, son Capt. Allen D. & Rebecca C. (Jenney)
318	Ryder, Mary Clark	17, July 1860	1863		dau. Barnabas C. & Azuba H. Ryder
317	M. C. R.				

302 A	Ryder, Rebecca C. (Jenney)	9, Aug. 1819	25, Aug. 1870	51y	wife Capt. Allen D.
301	R. C. R.				
318	Ryder, Ruth B. (Crapo)	1826	7, Aug. 1852	26y	wife Barnabas C., dau. Philip & Sally (Blackwell) Crapo
314	R. B. R.				
343	Sears, Abbie F. (Thatcher)		16, July 1878	80y 3m 15d	Mother, wife Nathaniel, dau. Lot & Abigail Thatcher
344 B	Sears, Eddie T.	1873	1873		son James H. & Helen E.
347	Eddie				
344 A	Sears, Helen E.	1841	1873		wife James H.
345	H. E. S.				
344 A	Sears, James H.	21, Mar. 1839	1912		Civil War Navy, hus, Helen E., 2nd Mary (Boyland), son Nathaniel & Abigail F. (Thatcher)
346	Sears, Lot F.	3, Oct. 1834	7, Feb. 1911		son Nathaniel & Abigail F. (Thatcher)
344 A	Sears, Mary (Boyland)	1854	1893		wife James H.
342	M. B. S.				
344 B	Sears, Nellie T..	1868	1869		dau. James H. & Helen E. Sears
348	Nellie				
28	Shaw, Abbie H. (Abigail)	15, Nov. 1822			dau. Lewis & Ruth (Crandon) Shaw, stone flat on ground
31 ft	A. H. S.				
311 A	Shaw, Carrie C.	1876	4, Mar. 1900	23y 6m	dau. Charles W. & Alice E. (Bessey) Shaw
306	Carrie				
311 A	Shaw, Charles W.	1842	26, July 1889	47y	GAR, hus. Alice E. (Bessey)
309	Father				
33	Shaw, John C.	10, June 1832	9 Dec. 1868	36y 6m	son Lewis & Ruth (Crandon), stone flat on ground
34 ft	J. C. S.				
26	Shaw, Lewis		22, April 1868	73y	hus. Ruth (Crandon), son Ambrose
29 ft	L. S.				
27	Shaw, Ruth (Crandon)		6, April 1878	77y 9m	wife Lewis
30 ft	R. S.				
105 A	Addie				
105 B	Sherman, Addie	4, June 1871	7, Sept. 1877	6y 3m	dau. James G. B. & Lucina P. (Landers) Sherman
106 ft	A. S.				
71	Sherman, Allen L.	9, Feb. 1873	5, Feb. 1939	65y 11m 26d	hus. Carrie E. (Sherman), son John W. & Ellen M. (Nellie M. Braley)
69	Father				
203	Sherman Anna		16, April 1885	80y 3m 23d	wife Leonard
311 B	Sherman, Annie H. (Shaw)	1879	1950		wife Charles E.

313	A. H. S.				
86 B	Sherman, Arthur E. (ARTIE)	10, July 1874	12, Feb. 1883	8y 7m	son George B. Jr. & Clara (Hathaway)
86 A	Arthur				
71	Sherman, Carrie E. (Sherman)	23, April 1875	8, Aug. 1955	79y 10m 15d	wife Allen L., dau. Thomas A. & Lucy M. (Chace) Sherman
70	Mother				
258 A	Sherman, Charles Carroll	1853	30, Jan. 1900		hus. Sarah W. (Hathaway), son Edward A. & Lois C. (Bennett)
257	Charles				
311 B	Sherman, Charles E.	1, Sept. 1867	16, July 1940	72y 10m 15d	hus. Annie H. (Shaw), son Thomas A. & Lucy M. (Chace)
312	C. E. S.				
103	Sherman, Charlotte C. (Sherman)	1, Jan. 1835	4, April 1892		wife Nathaniel B.
93	Sherman, Chester H.	23, April 1889	17, July 1948	60y 2m 24d	hus. Jessie (Anthony), son John C. & Nancy W. (Taber)
66	Sherman, Chester L.	1881	1881		son John W. & Nellie M. (Ellen M. Braley)
67 A	Little Chester				
67 B	Sherman, Chester L.	8, June 1881	30, Sept. 1881	3m 22d	son John W. & Nellie M. (Ellen M. Braley)
68	Baby				
85	Sherman, Clara W. (Hathaway)	1856	1930		Mother, wife George B. Jr.
45	Sherman, Clarence	12, Mar. 1862	30, Mar. 1862	19d	son William F. & Lydia J. (Snell)
46 ft	C. S.				
207	Sherman, Deborah	23, Feb. 1802	15, July 1850	49th y	In memory of, dau. Thomas & Deborah (Winslow) Sherman
254	Sherman, Edward A.	17, Oct. 1823	9, Dec. 1907	84y 1m 9d	mariner, hus. Lois C. (Bennett), son Humphrey
205	Sherman, Elbridge G.	26, June 1833	15, Sept. 1853	20y 2m 20d	son Leonard & Anna
66	Sherman, Elmer A.	23, Sept. 1887	24, Oct. 1887	1m	son John W. & Nellie M. (Ellen M. Braley)
113	Sherman, George Bonney, Capt.	3, Feb. 1824	17, Mar. 1877	53y	hus. Phebe A. (Pierce), son Zepheniah & Margaret. Broken
84	Sherman, George B. Jr.	25, Mar. 1852	16, Nov. 1911		Father, hus. Clara (Hathaway), son Capt. George B. & Phebe A. (Pierce)
41	Sherman, George W.	27, June 1858	10, June 1882	23y 11m	son William F. & Lydia J. (Snell)
44 ft	G. W. S.				
111	Sherman, James G. B.	9, Nov. 1840	1, Dec. 1893		hus. Lucina P. (Landers), son Otis & Rhoda (Shearman)
353	Sherman, Jane W. (Bonney)		25, May 1893	86y 2m 12d	wife Thomas
356 ft	J. W. S.				
92	Sherman, John C.	8, June 1850	3, Nov. 1932	82y	hus. Nancy W. (Taber), son Edward A. & Lois C. (Bennett)
66	Sherman, John W.	19, Mar. 1851	13, Jan. 1914	62y 9m 25d	hus. Nellie M. (Braley) (Ellen M. Braley)
64	Father				
204	Sherman, Joseph L.	30, July 1838	11, Dec. 1861	34y 4m 12d	shoemaker, son Leonard & Anna
379	Sherman, Katherine M. (Hamilton)	16, Feb. 1898	12, Dec. 1983	85y	wife Leonard A.
202	Sherman, Leonard	13, Feb. 1800	9, April 1871	71y 1m 26d	hus. Anna, son Thomas & Deborah

379	Sherman, Leonard A.	19, Dec. 1898	27, Dec. 1981		hus. Katherine M. (Hamilton), son Allen L. & Carrie E. (Sherman)
234	Sherman, Leslie		7, Sept. 1876	22m 10d	son Israel A. & Sarah (Crapo), died in Louiseville, KY
236 ft. L. S.					
210	Sherman, Levi W.	11, Jan. 1828	27, Dec. 1852	24y 11m 16d	hus. Mary W., son Leonard & Anna. Stone is broken on ground
255	Sherman, Lois C. (Bennett)	3, Aug. 1816	27, Aug. 1884	68y 24d	wife Edward A., dau. Joseph & Patience (Nye) Bennett
112	Sherman, Lucina P. (Landers)	22, Mar. 1841	9, Mar. 1907	65y 11m 15d	wife James G. B., dau. Freeman & Lucina (Perry) Landers
206	Sherman, Lucy Ann	28, May 1835	9, Mar. 1849	13y 9m 9d	dau. Leonard & Anna Sherman
357	Sherman, Lucy M. (Chase)	26, Nov. 1838	1, May 1926	87y 5m 5d	wife Thomas A., dau. Jerimiah & Chloe Chase
42	Sherman, Lydia J. (Snell)	31, May 1839	3, July 1915	76y 2m 2d	wife William F., dau. Otis H. & Mary Ann (Parker) Snell
211	Sherman, Mary W.		29, Sept. 1856	31y 7m 10 d	wife Levi W.
91	Sherman, Nancy W. (Taber)	26, Dec. 1855	4, Feb. 1912	56y 1m 9d	wife John C., dau. Jonathan & Sophia (Potter) Taber
103	Sherman, Nathaniel B.	23, Dec. 1836	10, Aug. 1911		hus. Charlotte Clark (Sherman)
66	Sherman, Nellie M. (Ellen Braley)	1851	20, June 1931	79y 10m 3d	wife John W., dau. Capt. Jason L. & Hannah (Hall) Braley
65	Mother				
107	Sherman, Otis	7, Jan. 1794	25, Oct. 1875	81y 9m 18d	hus. Rhoda (Shearman), son Thomas & Deborah (Winslow)
108 ft O. S.					
258 A	Sherman, Patience Josephine	30, Oct. 1855	1945		dau. Edward A. & Lois C. (Bennett) Sherman
114	Sherman, Phebe A. (Pierce)		29, April 1856	31y 26d	wife Capt. George B.
115 ft P. A. S.					
87	Sherman, Phebe E.	25, March 1876	12, Aug. 1904	28y 4m 18d	dau. George B. Jr. & Clara W. (Hathaway) Sherman
109	Sherman, Rhoda (Shearman)		10, April 1885	81y 4m 25d	wife Otis
110 ft R. S.					
235	S. T. J. S.	Probably the following, as listed being buried in Sherman Cemetery			
	Sherman, Sarah Thomas Josephine (Crapo)		17, May 1917	69y 11m 28d	wife Isreal, dau. Humphrey Crapo
258 A	Sherman, Sarah W. (Hathaway)	1858	1952		wife Charles Carroll
256	Sarah W.				
352	Sherman, Thomas	17, Jan. 1804	15, July 1885	81y 6m	hus. Jane W. (Bonney), son Thomas & Deborah (Winslow)
					Stone broken, flat on ground
355 ft T. S.					
357	Sherman, Thomas A.	12, Nov. 1832	1, Jan. 1918	85y 1m 19d	hus. Lucy M. (Chase), son Thomas & Jane W. (Bonney)
399	Silveira, Manuel G.	1858	12, Feb. 1942	83y 7m 18d	hus. Mary C. (Serpa), son Joseph & Rose (Iscochia)
398	Manuel G.				
399	Silveira, Mary C. (Serpa)	1875	7, April 1963	87y 5m 23d	wife Manuel G., dau. John & Anna (Silveira) Serpa
397	Mary C.				
98	Slocum, Henry Howland	27, July. 1905	28, June 1960		Massachusetts Pvt 1110 SVC Com'd Unit WW 2
88	Smith, Elizabeth A.	1879	1956		

421	Snell, Ada (Jepson)	14, Dec. 1912	18, Feb. 1995		wife Herbert Howland, dau. Frank & Theresa (Harrison) Jepson
186	Snell, Albert R.	24, Mar. 1876	28, Aug. 1938	62y	hus. Sarah D. (Briggs), son Albert F. & Lydia (Franklin)
311 A	Snell, Alice E. (Bessey) Shaw	1850	1935		wife 1st Charles W. Shaw, 2nd Isaiah Hatch
310	Mother				
411	Snell, Earl C.	1908	28, June 1974	66y	hus. Irene (Gonsalves), son Franklin & Lillian (Macomber)
271	Snell, Hannah Ellen	20, Dec. 1873	21, April 1889	15y 4m	dau. Isaiah Hatch & Hannah T. (Bradford) Snell
272	Nellie				
271	Snell, Hannah T. (Bradford)	3, Dec. 1838	24, Nov. 1889	50y 11m 21d	wife Isaiah Hatch, dau. Harvey & Wealthy C. (Hathaway) Bradford
269	Mother				
420	Snell, Herbert Howland	4, June 1916	2, Nov. 1994		T Sgt U. S. Army WW 2
421	Snell, Herbert Howland	4, June 1916	2, Nov. 1994	78y	hus. Ada (Jepson), son Isaiah Herbert & Lillian (Howland)
411	Snell, Irene (Gonsalves)	1911	7, Aug. 1976	65y	wife Earl C., dau. Fernando & Amelia (Alves) Gonsalves
271	Snell, Isaiah Hatch	5, April 1836	8, Dec. 1910	74y 8m 3d	Shoemaker, hus. Hannah T. (Bradford), 2nd Alice E. (Bessey) Shaw, son Otis H. & Mary Ann (Parker)
270	Father				
271	Snell, Mary Ann	3, Dec. 1871	8, Mar. 1890	18y 3m	dau. Isaiah Hatch & Hannan T. (Bradford) Snell
273	Minnie				
37	Snell, Mary Ann (Parker)	27, April 1810	22, Aug. 1895	85y 4m	wife Otis H., dau. Isaac Jr. & Prudence (Hatch) Parker
36	Snell, Otis H.	27, June 1802	11, Mar. 1889	86y 8m 12d	hus. Mary Ann (Parker)
271	Snell, Otis Harvey	15, July 1860	22, Mar. 1891	30y	son Isaiah Hatch & Hannah T. (Bradford)
274	Harvey				
40	Snell, Otis P,	1, July 1832	24, Jan. 1867	34y 6m	GAR Civil War Navy, lost with brig Trindale on her passage from Wilmington to New London, son Otis H. & Mary Ann (Parker)
39	Snell, Prudence H.	12, Dec. 1843	14, Oct. 1863	19y 10m 2d	dau. Otis H. & Mary Ann (Parker) Snell
43 ft	P. H. S.				
186	Snell, Sarah D. (Briggs)	11, Mar. 1876	1970		wife Albert R., dau. George L. & Lizzie (Alley) Briggs
412	Souza, Antonio M.	1893	1966		hus. Diolinda (Rocha)
412	Souza, Diolinda (Rocha)	1894	23, Feb. 1973	78y 11m 29d	wife Antonio M., dau. Thomas & Florinda Rocha
200	Soule/Sowle, Edward B.	1865	1906		might be brother of Ellen M. (Nellie M.) (Soule/Sowle) Collins & son Frederick
74	Staples, Ruth R.		16, Oct. 1894	79y 10m 19d	wife Samuel B.
75 ft	R. R. S.				
72	Staples, Samuel B.		13, Mar. 1890	88y 19d	hus. Ruth R., son Samuel & Hannah, inventor of log calipers, ran Hartley Mill as Staples Mill, sold to West, who sold to Hartley
73 ft	S. B. S.				
388	StAubin, N. Evelyn (Reynolds)	25, May 1910	23, Nov. 1993	83y	wife Victor A., dau. William A. & Nellie P. (Mosher) Reynolds

388	StAubin, Robert V.	27, Mar. 1941			son Victor A. & N. Evelyn (Reynolds)
388	StAubin, Victor A.	31, Jan. 1911	6, May 1988		hus. N. Evelyn (Reynolds), son Oliver & Albina (Chausse)
311 B	Sturtevant, Norris O.	10, Feb. 1874	1947		hus. Sarah B. (Shaw), son Charles Henry & Cordelia (Ellis)
307	N. O. S.				
311 B	Sturtevant, Sarah B. (Shaw)	1877	1949		wife Norris O.
308	S. B. S.				
399	Sylvaria, Alice W. (Higgins)	1901	3, Mar. 1975	73y 8m 17d	wife John G., dau. Charles G. & Emily (Olson) Higgins
401	Alice W.				
399	Sylvaria, John G.	1896	1988	92y	hus. Alice W. (Higgins), son Manuel G. & Mary (Serpa) Silveira
400	Sylvaria, John G.	15, Mar. 1896	2, April 1988		Pvt U. S. Army WW 1
402	John G.				
201	Sylvia, Cora Belle (Gibbs)	1882	8, Feb. 1970	87y 9m 16d	wife John L., dau. George F. & Lydia (Pittsley) Gibbs
201	Sylvia, John L.	1879	13, June 1952	73y 2m 14d	hus. Cora B. (Gibbs) son Lawrence P. & Mary (Vera)
214	Thatcher, Adelaide M.		18, Dec. 1851	17y 2m 5d	dau. Charles F. & Sylvia Thatcher
213	Thatcher, Ann M.		28, Oct. 1853	21y	dau. Charles F. & Sylvia Thatcher
215	Thatcher, Charles F.		28, Feb. 1872	85y 9m 24d	hus. Sylvia
212	Thatcher, Priscilla B.		2, Oct. 1862	25y 3m 20d	dau. Charles F. & Sylvia Thatcher
216	Thatcher, Sylvia		15, Nov. 1872	74y 8m 4d	wife Charles F.
277 B	Tripp, Caroline M. (Randall)	1836	2, Feb. 1908	72y 8m	wife Isaac, dau. Leander & Betsey P. (Crapo) Randall
277 A	Tripp, Clarence H.	16, Nov. 1876	1958		son Isaac & Caroline M. (Randall)
277 A	Tripp, Harry I.	1, July 1870	1870		son Isaac & Caroline M. (Randall)
277 B.	Tripp, Isaac	1826	16, Dec. 1897	71y 7m	hus. Caroline M. (Randall)
277 A	Tripp, Julia E.	29, April 1874	1874		dau. Isaac & Caroline M. (Randall) Tripp
35 A	Vaughan, Amelia C.	1833	1864		wife Leonard
409	Vaughan, Harold G.	1895	7, Dec. 1957	62y 10m 7d	hus. Lena (Bettencourt), son Leander Clifton & Mary (Gardener)
409	Vaughan, Lena (Bettencourt)	7, Mar. 1898	12, Dec. 1966	68y 9m 5d	wife Harold G., dau. Antone J. & Lena (Silva/Sylvia) Bettencourt
35 A	Vaughan, Leonard	8, May 1831	1913		hus. Amelia C., son Henry L. & Sophia
410	Vaughan, Lloyd A.	4, Nov. 1922	8, June 2000	77y	FD, hus. Lorraine E. (White), son Harold G. & Lena (Bettencourt)
410	Vaughan, Lorraine E. (White)	15, Oct. 1933			wife Lloyd A.
396	Vaughan Marion L. (Sylvaria)	23, May 1923	6, Aug. 1996		wife Harold G. Jr., dau. John G. & Alice W. (Higgins) Sylvaria
35 A	Vaughan, William A.	1862	1863		son Leonard & Amelia C.
390	Watling, Louise (Hartley)	9, July 1920			wife William David Sr., dau. Daniel E. & Mary (Lawrence) Hartley
390	Watling, William David Sr.	17, Oct. 1917	2, Oct. 1993	75y	FD, hus. Louise (Hartley)
391	Watling, William David Sr.	17, Oct. 1917	2, Oct. 1993		S. Sgt. U. S. Army Air Corps WW 2
365	Weigel, Albert J.		6, Jan. 1938		Massachusetts Corp 10 Field Sig. BN 7 Div. WW 1, hus. Isabel R. (Bettencourt)

407 B	Weigel, Clara (Bettencourt)	30, Dec. 1900	15, April 1979	78y 3m 15d	wife Julien R., dau. Antone & Lena (Silva/Sylvia) Bettencourt
366	Weigel, Isabel R. (Bettencourt)	9, Jan. 1894	18, Feb. 1959	65y 1m 9d	wife Albert J., dau. Antone J. & Lena (Silva/Sylvia) Bettencourt
407 B	Weigel, Julien R.	15, Feb. 1898	11, May 1985	87y	hus. Clara (Bettencourt), son Jean & Ann M. (Moritz)
407 A	Weigel, Julien - Clara				
198 A	Wellington, Frank E.	1863	1907	43y 5m	hus. Ida M.
198 A	Wellington, Ida M.	1868	1963		wife Frank E.
333 A	WEST				
333 B	WEST				
275 B.	West, C. Maynard	14, Feb. 1882	1938		son Charles G. Jr. & Harriet E. (Wilson)
275 A	West, Charles G., Jr.	1859	1917		hus. Harriet E. (Wilson)
329	West, H. Elizabeth	1914	1935		
275 A	West, Harriet E. (Wilson)	1859	1916		wife Charles G., Jr.
275 A	West, Hattie Ethel	15, Oct. 1896	8, June 1897	7m 23d	dau. Charles G., Jr. & Harriet E. (Wilson) West
336	West, Joan E.	1930	1981		
330	West, Nelson H.	2, Jan. 1885	1949		hus. Viola M. (Crandall), son Charles G., Jr. & Harriet E. (Wilson)
334	West, Nelson H. Jr.	9, June 1923	1990		Sgt. U. S. Army WW 2, son Nelson H. & Viola M. (Crandall)
331	West, Viola M. (Crandall)	1893	1973		wife Nelson H.
275 A	West, William N.	7, Nov. 1888	1920		son Charles G., Jr. & Harriet E. (Wilson)
375	White, Etta P.	15, Oct. 1878	25, Nov. 1908		wife Herbert A.
325	Wilber/ur, Hattie (Our Hattie)		15, Mar. 1856	4y 6m 8d	dau. Joseph F. & Mercy H. Wilber/ur
327 ft	H. M. W.				
326	Wilbur/er, Philip (Little Phillie)		18, Feb. 1861		son Joseph F. & Mercy H.
328 ft	P. W.				
233	Wills, Edna A. (Rounseville)	12, April 1889	1941		wife Robert H., dau. Arthur & Harriet A. (Sherman) Rounseville
233	Wills, Robert H.	1890	1977		hus. Edna A. (Rounseville)
436	Young, Cordelia Ann	1895	25, Feb. 1981		Mother, wife William H.
	On lot with #369, looks like a stone footing.				
370	Blank				
	Might have been stone next to #41 George W. Sherman				
	In middle of lot in back of stone # 85 Clara H. Sherman it looks like stone footing.				
	Mound on lot with # 370 could be grave.				
	Mound between #192 and #195 could be graves.				
61	Unreadable, in back of # 60 Cushman, looks like Gilson -----died ---14, 1-6-. aged -----				
80	Baby	This could be the following as listed as being buried in Sherman Cemetery			
	Bumpus, Lilly	5, Feb. 1912	7, Feb. 1912	3d	dau. George W. & Lilly (Sherman) Bumpus

181	Baby				
199	Broken, set in ground, unreadable on back edge but looks like Coles				
250	Baby				
251	Baby				
276	Lillian	1919	1944		under bush
281	J. H.	1882	1953		
280	M. C. E.	1899	1983		
Following listed in Rochester Town records as being buried in Sherman Cemetery but no stones found.					
	Bettencourt, Baby		8, Oct. 1941		
	Burke, Baby		11, Mar. 1917		
	Burke, Baby		6, July 1923		
	Caswell, Clarence S. Jr.		19, Feb. 1952	62y 5m 11d	hus. Minnie E. (Crampton), son Clarence S. & Evalina (Delano)
	Enos, Frank	25, June 1850	26, April 1917	66y 10m 1d	son Frank & Annie, Western Islands
Following four graves are on the back side of Palmer Lot, stone # 156 A & #156 B, per. daughter/granddaughter Florence (Snell) Taylor					
	Howland, Frank W.		16, Dec. 1944	84y 3m 8d	hus. Mary F. (Long), son Charles A. & Abbie F. (Sears)
	Howland, Mary Freeman (Long)		22, May 1927	62y 5m 19d	wife Frank W., dau. Elkanah & Matilda (Allen) Long
155	M. F. H.				
	Snell, Isaiah Herbert	19, May 1879	20, June 1944	65y 1m 1d	hus. Lillian (Howland), son Isaiah Hatch & Hannah T. (Bradford)
	Snell, Lillian F. (Howland)	22, Sept. 1891	10, June 1951	59y 8m 19d	wife Isiah Herbert, dau. Frank W. & Mary F. (Long) Howland
	Morse, Baby		19, Nov. 1918		
	Morse, Baby		16, Jan. 1923		
Following four Randall's might be on lot with stones # 244 & # 245					
	Randall, Calvin H.	16, Dec. 1834	23, June 1922	87 6m 7d	hus. Rebecca M. (Shurtleff), son Leander & Betsey (Crapo)
	Randall, Marcia E. (Bates)		12, July 1906	64y 2m 11d	wife of Job L., dau. Joshua & Ann M (---) Bates
	Randall, Rebecca M. (Shurtleff)		18, Dec. 1926	80y 3m 16d	wife Calvin H., dau. William & Lindy (Crapo) Shurtleff
	Randall, Walter E.		22, Nov. 1941	69y 1m 18d	son Job & Marcia (Bates)
	Randall, Laura (Boynton)		14, April 1940	68y	wife William H., dau. Daniel & Mary (Durgin) Boynton
	Savaria, Baby		18, Feb. 1951		
	Sherman, Baby		24, Oct. 1927		
	Sherman, Baby		8, Nov. 1927		

